

F.A.I. RTE.	SECTION	COUNTY	TOTAL SHEETS	SHEET NO.
55	99 (I&2) WRS-1	WILL.	227	23
STA.	667+00	TO STA.	697+00	
FED. ROAD DIST. NO. 1	ILLINOIS	FED. AID PROJECT	ALIGN-04 OF 13	

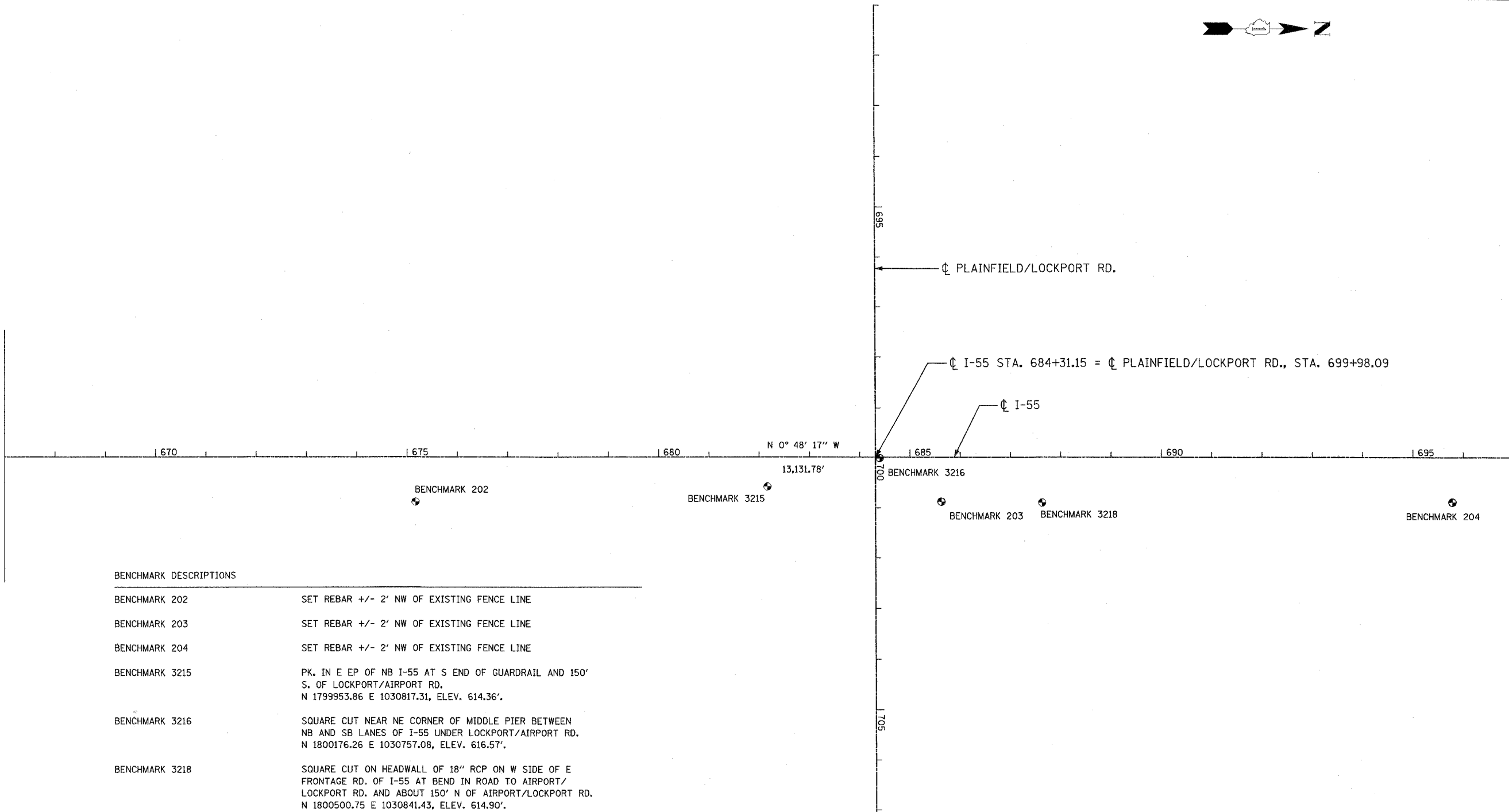

MATCHLINE STA. 667+00  
SEE ALIGN-03

MATCHLINE STA. 697+00  
SEE ALIGN-05



**BENCHMARK DESCRIPTIONS**

BENCHMARK 202	SET REBAR +/- 2' NW OF EXISTING FENCE LINE
BENCHMARK 203	SET REBAR +/- 2' NW OF EXISTING FENCE LINE
BENCHMARK 204	SET REBAR +/- 2' NW OF EXISTING FENCE LINE
BENCHMARK 3215	PK. IN E EP OF NB I-55 AT S END OF GUARDRAIL AND 150' S. OF LOCKPORT/AIRPORT RD. N 1799953.86 E 1030817.31, ELEV. 614.36'.
BENCHMARK 3216	SQUARE CUT NEAR NE CORNER OF MIDDLE PIER BETWEEN NB AND SB LANES OF I-55 UNDER LOCKPORT/AIRPORT RD. N 1800176.26 E 1030757.08, ELEV. 616.57'.
BENCHMARK 3218	SQUARE CUT ON HEADWALL OF 18" RCP ON W SIDE OF E FRONTAGE RD. OF I-55 AT BEND IN ROAD TO AIRPORT/LOCKPORT RD. AND ABOUT 150' N OF AIRPORT/LOCKPORT RD. N 1800500.75 E 1030841.43, ELEV. 614.90'.

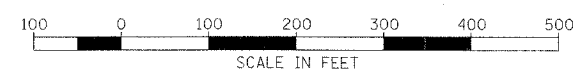

REVISIONS	
NAME	DATE

ILLINOIS DEPARTMENT OF TRANSPORTATION  
FAI ROUTE 55  
US 30 (PLAINFIELD ROAD) TO 143RD STREET

ALIGNMENT, TIES AND  
BENCHMARKS

SCALE: 1"=100'  
DATE: 02-23-07

DRAWN BY ALR  
CHECKED BY RH

FINAL