

F.A.I. RTE.	SECTION	COUNTY	TOTAL SHEETS	SHEET NO.
55	99 (1&2) WRS-1	WILL	227	71
STA. 1500+00/45+00 TO STA 1512+00/55+00				
FED. ROAD DIST. NO. ILLINOIS FED. AID PROJECT				
MOTII-06 OF 06				

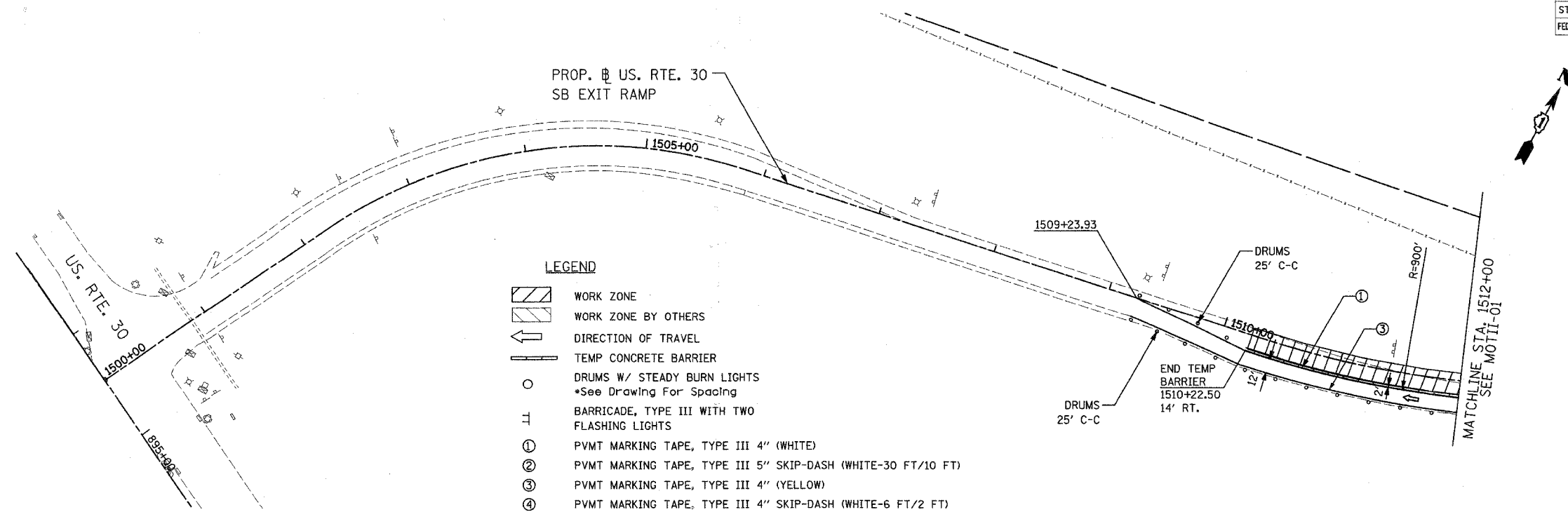

- LEGEND**
- WORK ZONE
 - WORK ZONE BY OTHERS
 - DIRECTION OF TRAVEL
 - TEMP CONCRETE BARRIER
 - DRUMS W/ STEADY BURN LIGHTS
*See Drawing For Spacing
 - BARRICADE, TYPE III WITH TWO FLASHING LIGHTS
 - PVMT MARKING TAPE, TYPE III 4" (WHITE)
 - PVMT MARKING TAPE, TYPE III 5" SKIP-DASH (WHITE-30 FT/10 FT)
 - PVMT MARKING TAPE, TYPE III 4" (YELLOW)
 - PVMT MARKING TAPE, TYPE III 4" SKIP-DASH (WHITE-6 FT/2 FT)

*STATIONS AND OFFSETS ARE DESCRIBED FROM RAMP B TO WHICH CALL OUTS ORIGINATE UNLESS NOTED OTHERWISE.

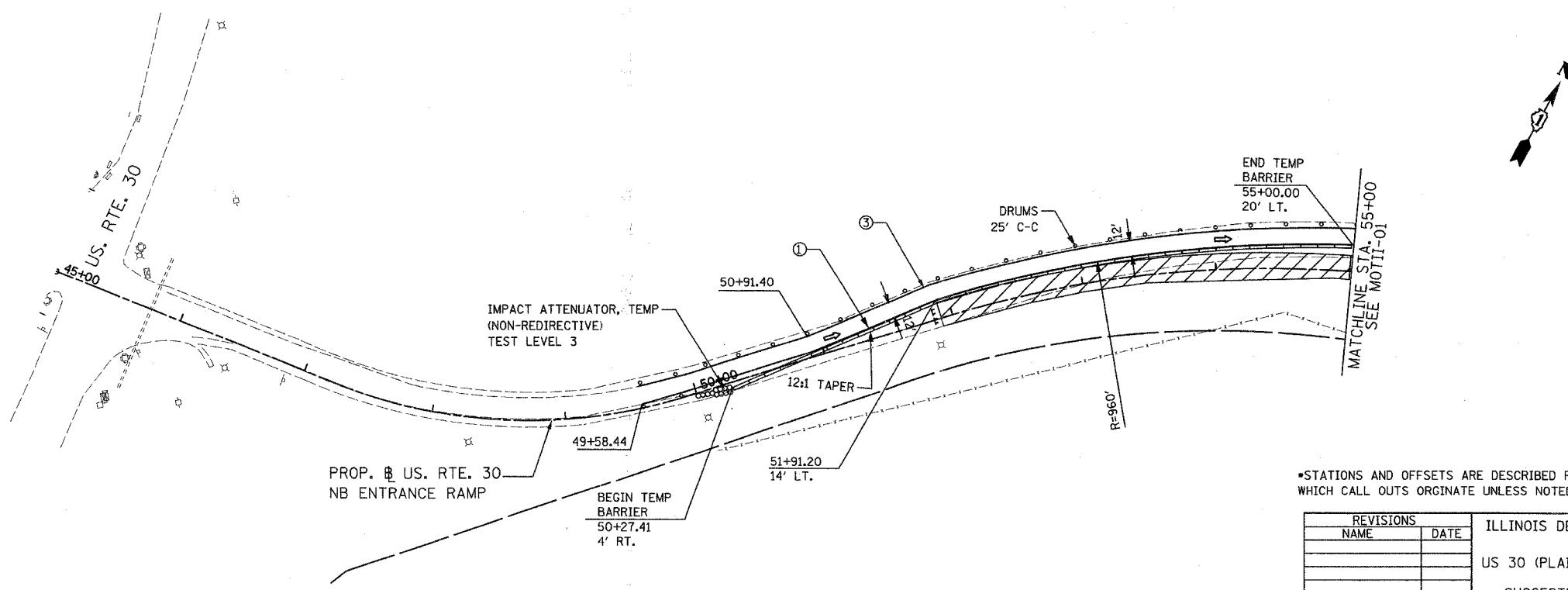

*STATIONS AND OFFSETS ARE DESCRIBED FROM RAMP B TO WHICH CALL OUTS ORIGINATE UNLESS NOTED OTHERWISE.

STAGE II

REVISIONS	
NAME	DATE

ILLINOIS DEPARTMENT OF TRANSPORTATION
 FAI ROUTE 55
 US 30 (PLAINFIELD ROAD) TO 143RD STREET
 SUGGESTED STAGES OF CONSTRUCTION
 AND TRAFFIC CONTROL
 SCALE: 1" = 50'
 DATE: 02-23-07
 DRAWN BY: TJR
 CHECKED BY: DM

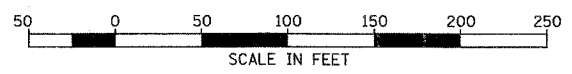

FINAL