

F.A. RTE.	SECTION	COUNTY	TOTAL SHEETS	SHEET NO.
55	99 (1&2) WRS-1	WILL	227	93
STA.	712+00	TO STA.	727+00	
FED. ROAD DIST. NO.	ILLINOIS	FED. AID PROJECT		

DRU-08 OF 10

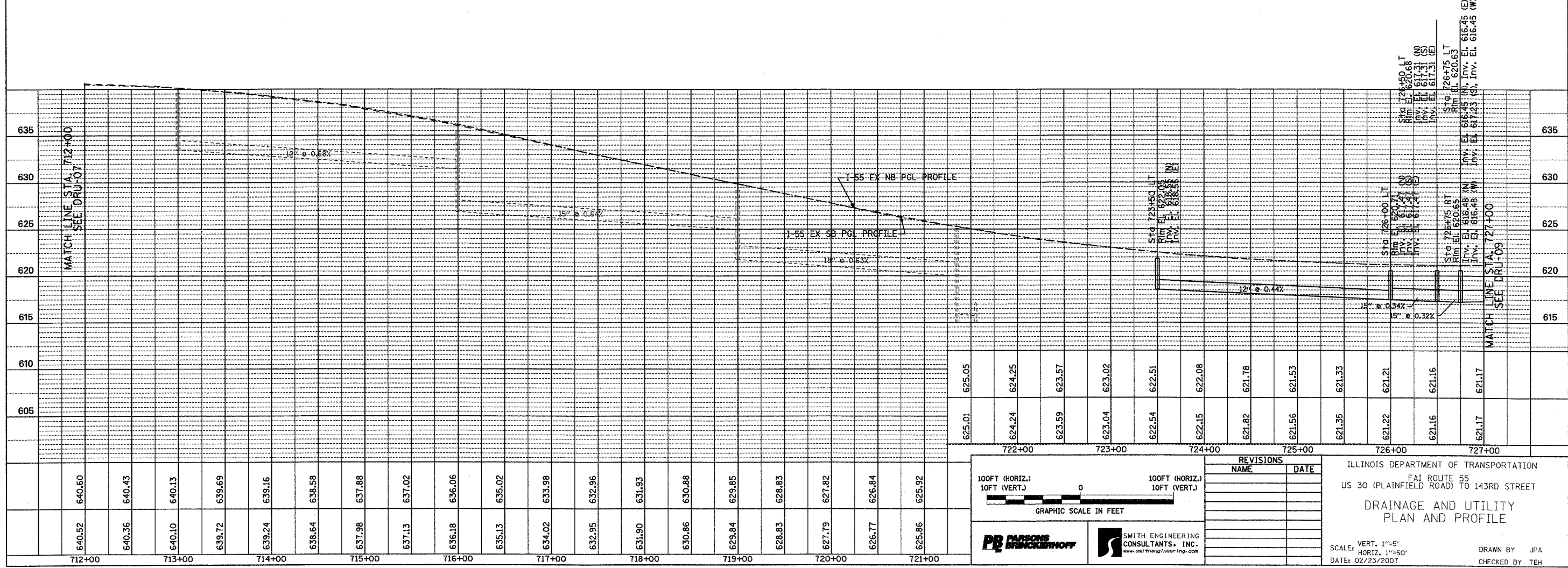
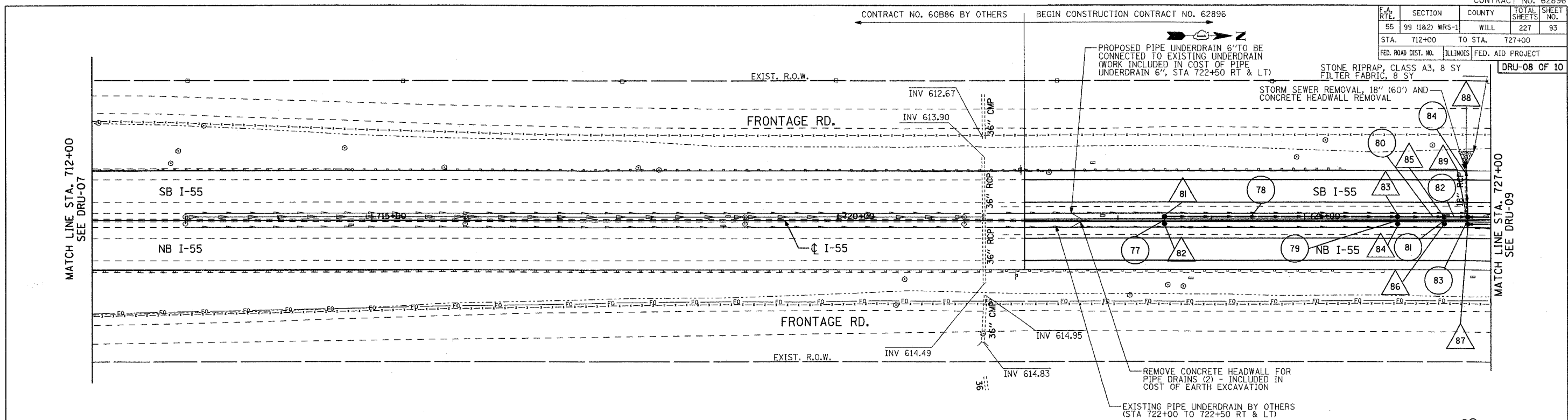

REVISIONS	
NAME	DATE

ILLINOIS DEPARTMENT OF TRANSPORTATION
FAI ROUTE 55
US 30 (PLAINFIELD ROAD) TO 143RD STREET

**DRAINAGE AND UTILITY
PLAN AND PROFILE**

SCALE: VERT. 1"=5'
HORIZ. 1"=50'
DATE: 02/23/2007

DRAWN BY: JPA
CHECKED BY: TEH

100FT (HORIZ.)
10FT (VERT.)

GRAPHIC SCALE IN FEET

SMITH ENGINEERING CONSULTANTS, INC.
www.smitheng.com

FINAL