

F.A.P. RTE.	SECTION	COUNTY	TOTAL SHEETS	SHEET NO.
55	100 (1&2) I-9	WILL	227	117
STA. 727+00		TO STA. 742+00		
FED. ROAD DIST. NO.		ILLINOIS FED. AID PROJECT		
PVMRK-9 OF 27				

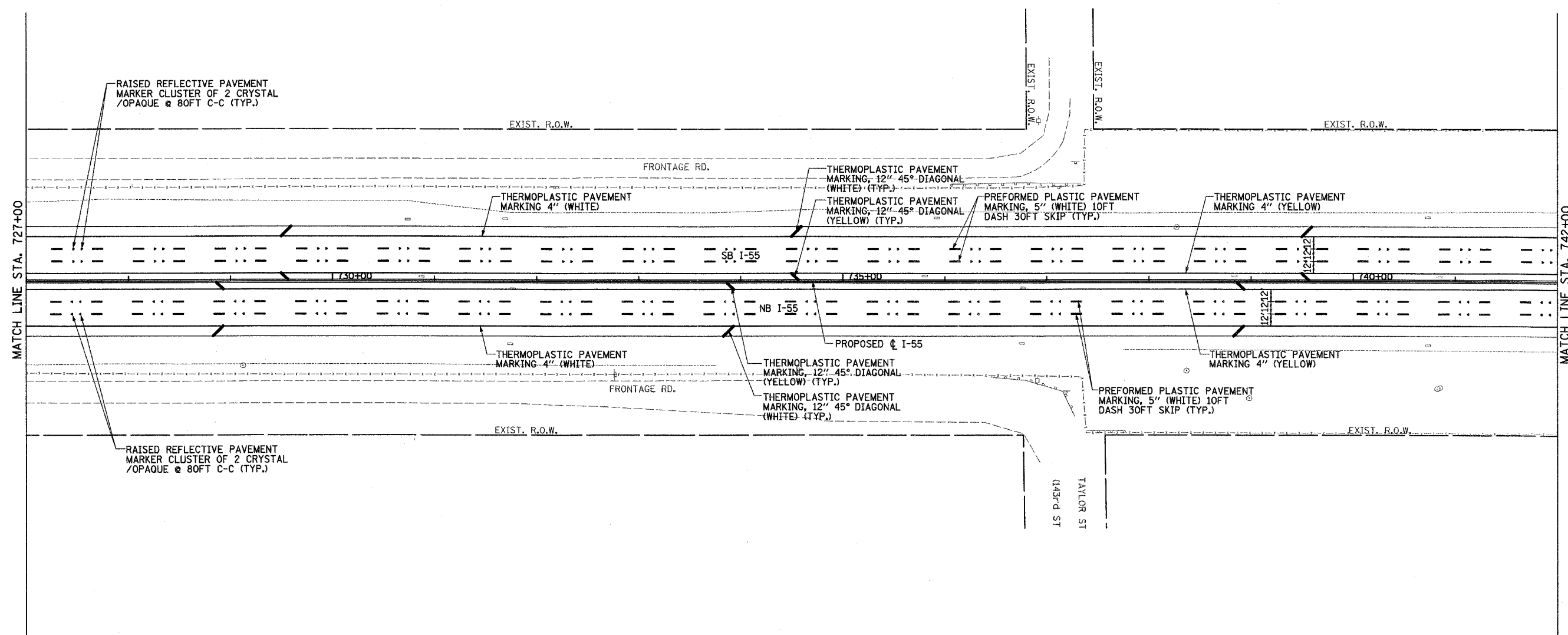

MATCH LINE STA. 727+00

MATCH LINE STA. 742+00

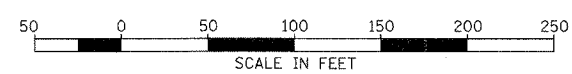

DAVID MASON & ASSOCIATES
Civil Engineering
Structural Engineering
Surveying
445 E. Illinois, Suite 640
Chicago, IL 60611
(312) 842-9600

PARSONS BRINCKERHOFF

REVISIONS	
NAME	DATE

ILLINOIS DEPARTMENT OF TRANSPORTATION
F.A.I. I-55
US RTE. 30 TO 143rd STREET

PAVEMENT MARKING
AND SIGNING PLANS

SCALE: 1" = 50'
DATE: FEBRUARY 23, 2007

DRAWN BY: JS, LC
CHECKED BY: SE