

F.A.P. RTE.	SECTION	COUNTY	TOTAL SHEETS	SHEET NO.
311	9 Y-N-2	COOK/DUPAGE	39	1

40

STATE OF ILLINOIS  
DEPARTMENT OF TRANSPORTATION  
DIVISION OF HIGHWAYS

**PROPOSED  
HIGHWAY PLANS**

F.A.P. 311: U.S. 34  
AT COUNTY LINE ROAD  
SECTION: 9 Y-N-2  
INTERSECTION IMPROVEMENT  
PROJECT: HSIP-0311 (032)  
DUPAGE AND COOK COUNTIES  
C-91-118-05

FOR INDEX OF SHEETS, SEE SHEET NO. 2

PROJECT LOCATED IN THE VILLAGE OF HINSDALE

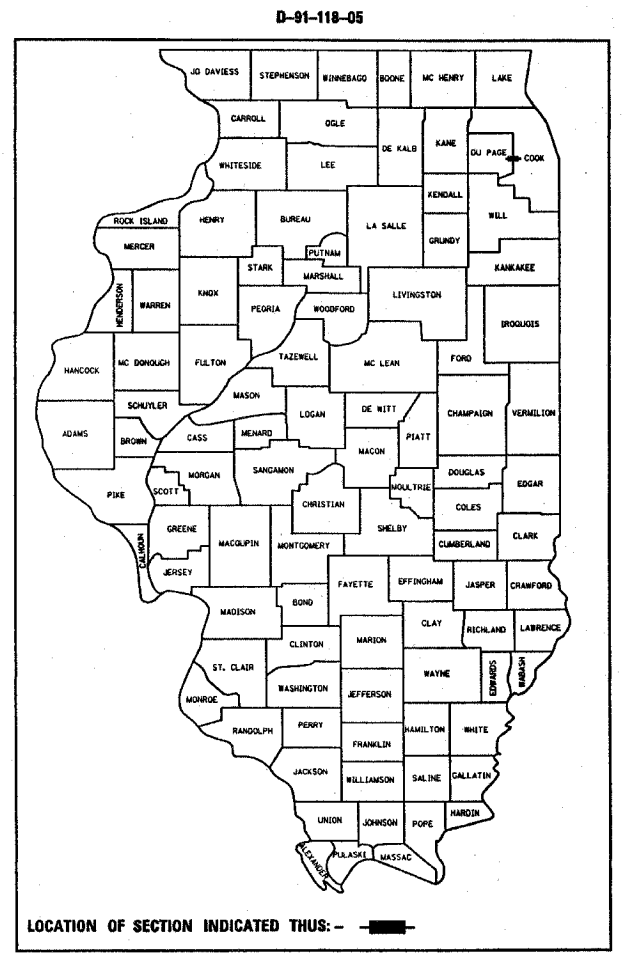

DISTRICT ONE - PLAN PREPARATION ENGINEER: KEN ENG / J.P. CHANG (847) 705-4432

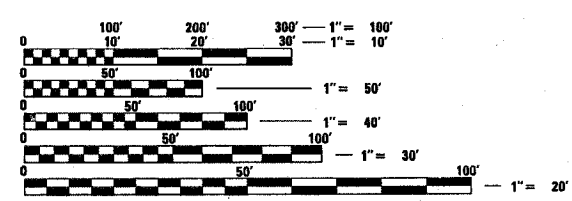

FULL SIZE PLANS HAVE BEEN PREPARED USING STANDARD ENGINEERING SCALES. REDUCED SIZED PLANS WILL NOT CONFORM TO STANDARD SCALES. IN MAKING MEASUREMENTS ON REDUCED PLANS, THE ABOVE SCALES MAY BE USED.

J.U.L.I.E.  
JOINT UTILITY LOCATION INFORMATION FOR EXCAVATION  
1-800-892-0123

CONTRACT NO. 62911

U.S. 34:  
PROJECT LIMIT  
STATION 93+69

COUNTY LINE RD.:  
PROJECT LIMIT  
STATION 19+00

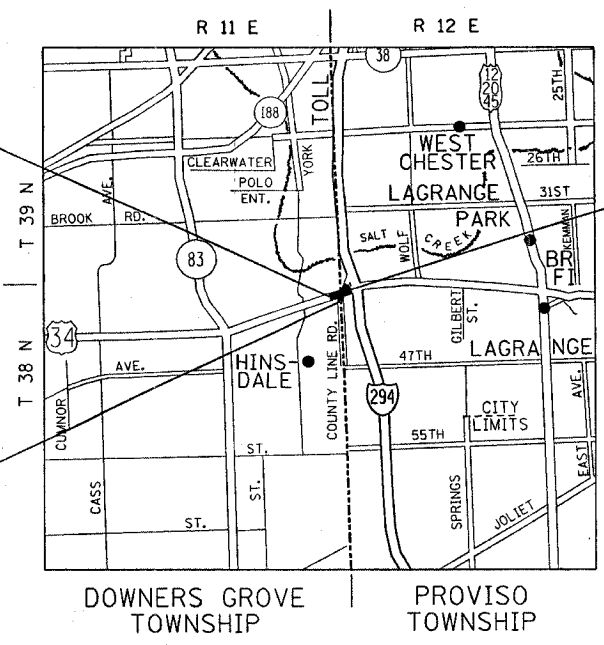

U.S. 34:  
PROJECT LIMIT  
STATION 106+00

TRAFFIC DATA  
US 34  
2004 ADT = 51,173  
SPEED LIMIT = 35 MPH  
COUNTY LINE ROAD  
2004 ADT = 6,625  
SPEED LIMIT = 25 MPH

SCALE: NONE

**LOCATION MAP**

US 34 GROSS AND NET LENGTH OF PROJECT = 1231 FEET (0.23 MILE)  
COUNTY LINE ROAD GROSS AND NET LENGTH OF PROJECT = 200 FEET (0.04 MILE)

STATE OF ILLINOIS  
DEPARTMENT OF TRANSPORTATION  
DIVISION OF HIGHWAYS

SUBMITTED Feb 7 2007

Dave Okie  
DEPUTY DIRECTOR OF HIGHWAYS, REGION ENGINEER

March 23 2007  
Eric E. Harant  
ENGINEER OF DESIGN AND ENVIRONMENT

March 23 2007  
Milton R. See, P.E.  
DIRECTOR OF HIGHWAYS, CHIEF ENGINEER

**PRINTED BY THE AUTHORITY  
OF THE STATE OF ILLINOIS**