

F.A.P. RTE.	SECTION	COUNTY	TOTAL SHEETS	SHEET NO.
**	**	CARROLL	548	97

STA. TO STA.  
 FED. ROAD DIST. NO. ILLINOIS FED. AID PROJECT  
 \* ROUTE 17 (US 52 / IL 64)  
 \*\* (1,2)RS & (3-1)RS-1

US RTE 52  
 EXIST. CURVE 300  
 PI STA. = 300+20.90  
 $\Delta = 5^{\circ} 07' 12''$  (LT)  
 $D = 0^{\circ} 24' 20''$   
 $R = 14,129.06'$   
 $T = 631.70'$   
 $L = 1,262.56'$   
 $E = 14.11'$   
 $\theta =$   
 $T.R. =$   
 $S.E. RUN =$   
 P.C. STA. = 293+89.20  
 P.T. STA. = 306+51.76

PROP. CURVE S300  
 PI STA. = 300+20.90  
 $\Delta = 5^{\circ} 07' 12''$  (LT)  
 $D = 0^{\circ} 24' 20''$   
 $R = 14,129.06'$   
 $T = 631.70'$   
 $L = 1,262.56'$   
 $E = 14.11'$   
 $\theta =$   
 $T.R. =$   
 $S.E. RUN =$   
 P.C. STA. = 293+89.20  
 P.T. STA. = 306+51.76

BARBARA J. DAUPHIN

JOHN ROSAUER JR.

DATE	BY	REVISION

PLAN SURVEYED  
 ALIGNED  
 RT. OF WAY CHECKED  
 NO. FILE NAME

DATE	BY	REVISION

PROFILE SURVEYED  
 GRADES CHECKED  
 NO. NOTED  
 STRUCTURE NOTATIONS OFF

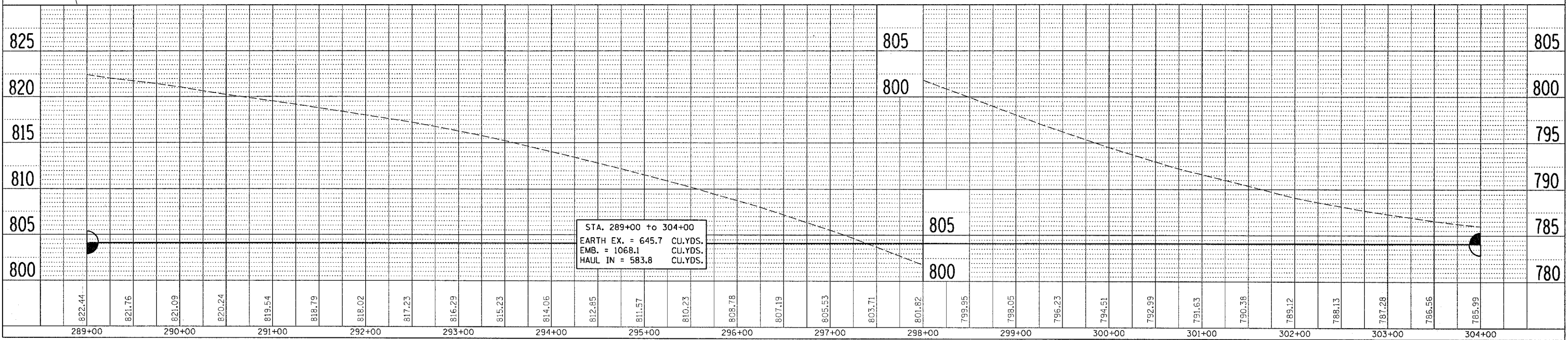
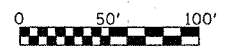
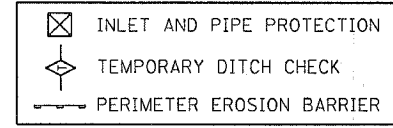
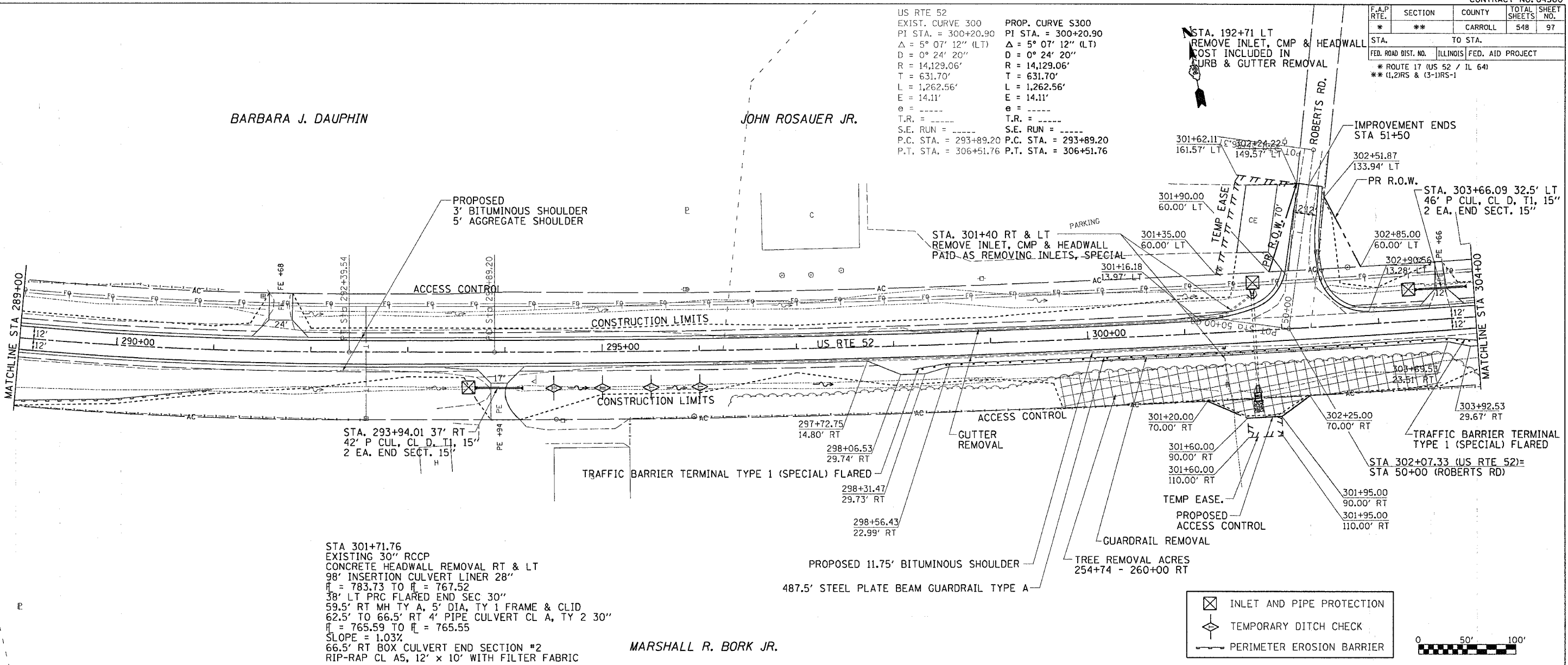

DATE TIME  
 REF SPEC  
 REF REF  
 REF REF