

F.A.P. RTE.	SECTION	COUNTY	TOTAL SHEETS	SHEET NO.
654	109 T	CARROLL	36	36

STA. 18+99.5929 TO STA. 19+50.0000  
 ILLINOIS FED. AID PROJECT

FINAL SURVEY NOTE BOOK NO. \_\_\_\_\_  
 DRAWINGS PLOTTED AREAS CHECKED  
 BY \_\_\_\_\_ DATE \_\_\_\_\_

ORIGINAL SURVEY NOTE BOOK NO. \_\_\_\_\_  
 DRAWINGS PLOTTED AREAS CHECKED  
 BY \_\_\_\_\_ DATE \_\_\_\_\_

PLOT DATE = Mon Mar 19 08:26:30 2007  
 FILE NAME = c:\projects\210366\10296.dwg  
 PLOT SCALE = 1/8" = 1' IN.  
 USER NAME = gpr/jj

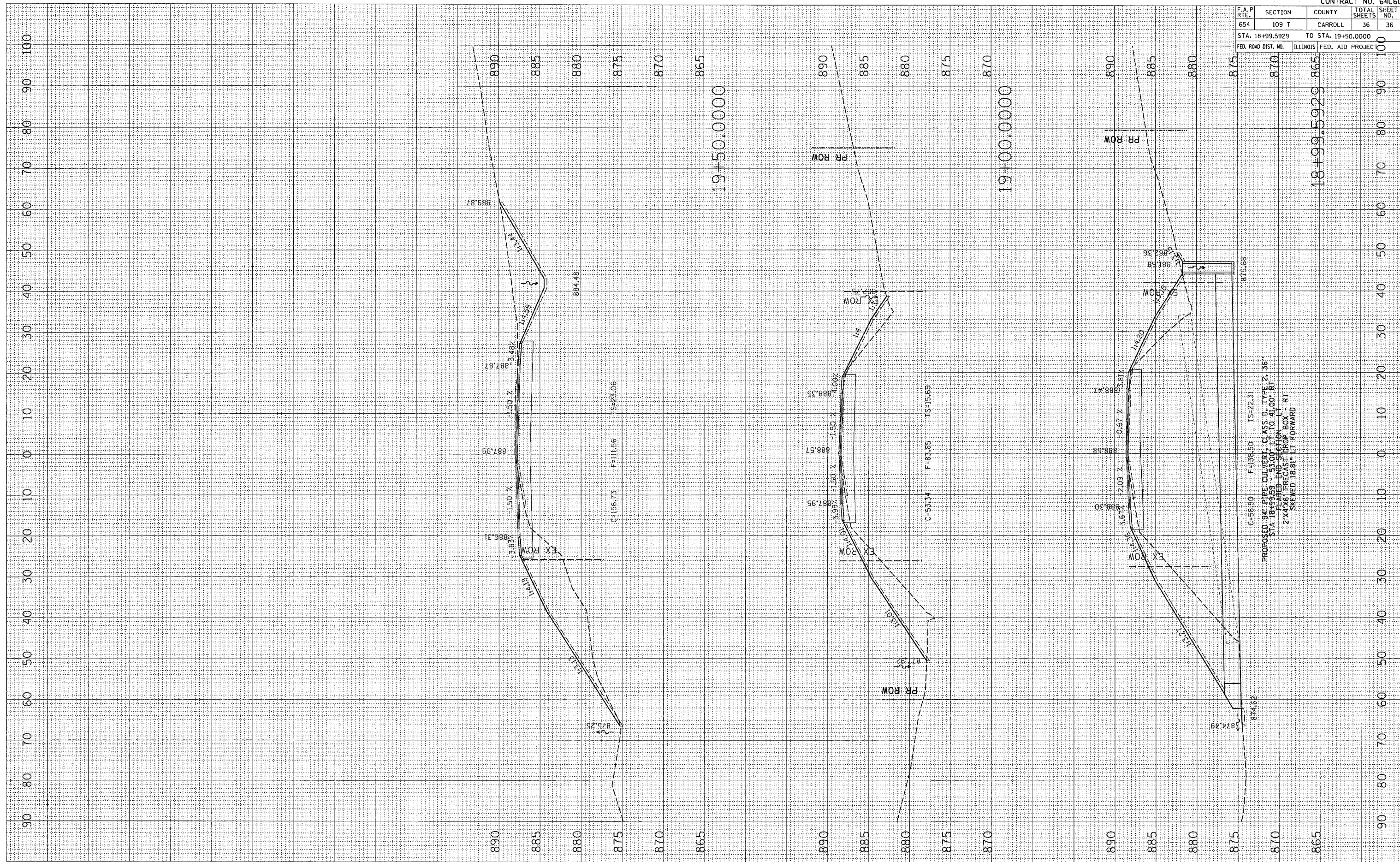

C=58.50 F=39.50 15+22.31  
 PROPOSED 94" PIPE CULVERT, CLASS D, TYPE 2, 36"  
 STA 18+99.59 - 53.00' LT TO 41.00' RT  
 FLARED END SECTION - LT  
 2'x4'x6' PRECAST DROP BOX - RT  
 SKEWED 18.81° LT FORWARD