

F.A.I. RTE.	SECTION	COUNTY	TOTAL SHEETS	SHEET NO.
55	(32-3)PATCHING	GRUNDY	9	1

STATE OF ILLINOIS
DEPARTMENT OF TRANSPORTATION
DIVISION OF HIGHWAYS

**PROPOSED
HIGHWAY PLANS**

FAI ROUTE 55 (I-55)
SECTION (32-3)PATCHING
PROJECT
GRUNDY COUNTY
C-93-046-07
CLASS "A" PAVEMENT PATCHING

INDEX OF SHEETS

1. COVER SHEET
2. GENERAL NOTES
3. SUMMARY OF QUANTITIES
4. TYPICAL SECTIONS
5. SCHEDULES - CLASS A PATCHING NB
6. SCHEDULES - CLASS A PATCHING SB
7. SCHEDULES - PAVEMENT MARKING
8. CLASS A PATCHING DETAILS
9. PAVEMENT MARKING DETAILS

STANDARDS

- 000001-04 STANDARD SYMBOLS, ABBREVIATIONS AND PATTERNS
- 001001-01 AREAS OF REINFORCEMENT BARS
- 001006 DECIMAL OF AN INCH AND OF A FOOT
- 420001-06 PAVEMENT JOINTS
- 421001-01 BAR REINFORCEMENT FOR CRC PAVEMENT
- 442001-03 CLASS A PATCHES
- 701101-01 OFF-ROAD OPERATIONS MULTILANE, 4.5 m (15') TO 600 mm (24") FROM PAVEMENT EDGE
- 701106-01 OFF-ROAD OPERATIONS, MULTILANE, MORE THAN 4.5 m (15') AWAY
- 701400-02 APPROACH TO LANE CLOSURE, FREEWAY/EXPRESSWAY
- 701401-03 LANE CLOSURE, FREEWAY/EXPRESSWAY
- 701411-03 LANE CLOSURE, MULTILANE, AT ENTRANCE OR EXIT RAMP FOR SPEEDS P 45 MPH
- 701426-02 LANE CLOSURE, MULTILANE INTERMITTENT OR MOVING OPERATION, FOR SPEEDS P 45 MPH
- 702001-06 TRAFFIC CONTROL DEVICES

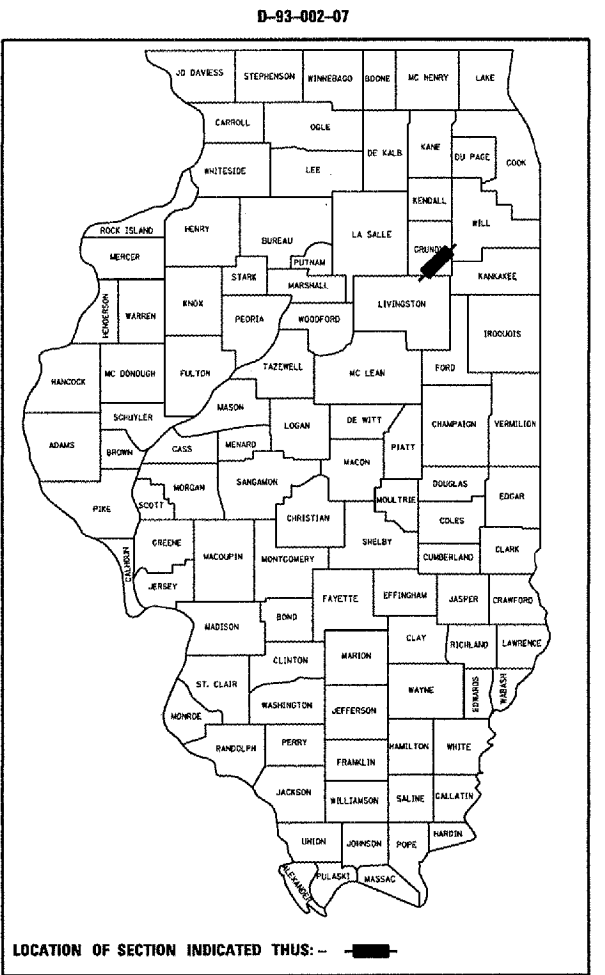

LOCATION OF SECTION INDICATED THIS: - [shaded area]

FUNCTIONAL CLASSIFICATION
RURAL - INTERSTATE
FAI ROUTE 55 (I-55)
2005 ADT = 20400
P.V = 69.1% M.U. = 26.5% S.U. = 4.4%

PROJECT BEGINS
LIVINGSTON COUNTY LINE
(M.P. 218.2)

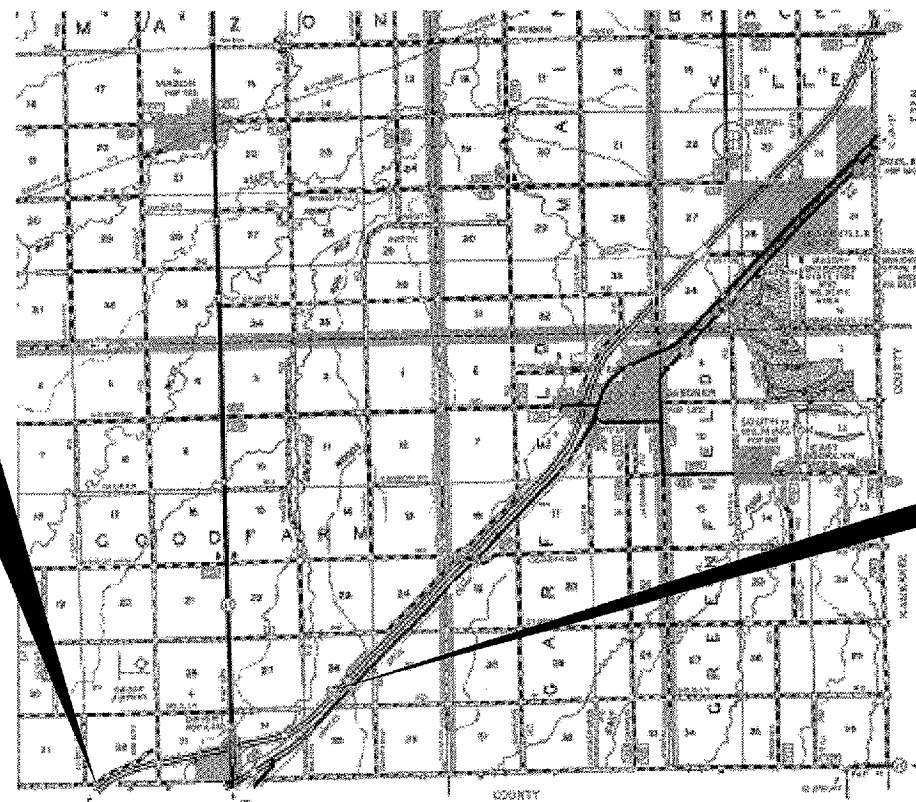

PROJECT ENDS
1.38 MILES NORTH
OF IL ROUTE 47
(M.P. 221.20)

STATE OF ILLINOIS
DEPARTMENT OF TRANSPORTATION
DIVISION OF HIGHWAYS

SUBMITTED *April 2 2007*
George Ryan
DEPUTY DIRECTOR OF HIGHWAYS, REGION ENGINEER

May 11 2007
Edie S. Harn
ENGINEER OF DESIGN AND ENVIRONMENT

May 11 2007
Melton R. Seay
DIRECTOR OF HIGHWAYS, CHIEF ENGINEER

**PRINTED BY THE AUTHORITY
OF THE STATE OF ILLINOIS**

LOCATION MAP
NOT TO SCALE
GROSS LENGTH = 15840 FT. = 3.00 MI.
NET LENGTH = 1615 FT. = 0.31 MI

MICROFILMED _____
REEL NUMBER _____
AWARDED _____
RESIDENT ENGINEER _____
AS BUILT CHANGES WERE MADE
ON THE FOLLOWING SHEETS _____

J.U.L.I.E.
JOINT UTILITY LOCATION INFORMATION FOR EXCAVATION
1-800-892-0123

DISTRICT 3 NO. (815) 434-6131
PROJECT ENGINEER: JOE KANNEL
UNIT CHIEF: RON WOODSHANK
TOWNSHIP: VARIOUS

CONTRACT NO. 66708

Date: March 2, 2007
c:/projects/main08/cm305/details.dgn