

F.A.U. RTE.	SECTION	COUNTY	TOTAL SHEETS	SHEET NO.
35RS-5,36RS-8	TAZEWELL	90	67	
STA.		TO STA.		
FED. ROAD DIST. NO.	ILLINOIS	FED. AID PROJECT		
*6717 (BUS 24) & 6713 (IL 8)				

PT STA. 263+54.32

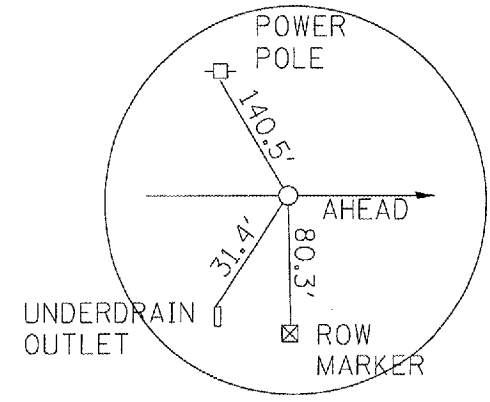

NE 1/4, SECTION 21  
T-26-N, R-3-W

STATION EQUATION

STA. 271+00, 23' LEFT STA. 272+52.16 (IL RTE. 8)  
STA. 10+00 (LEGION RD.)

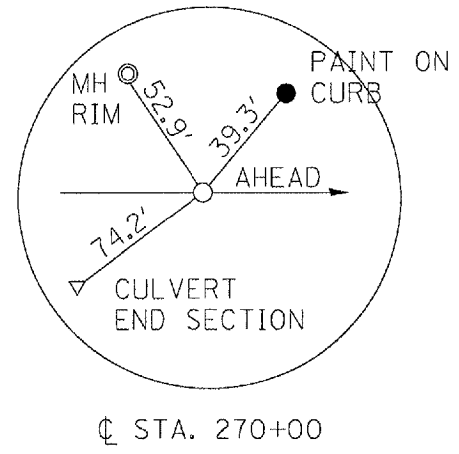
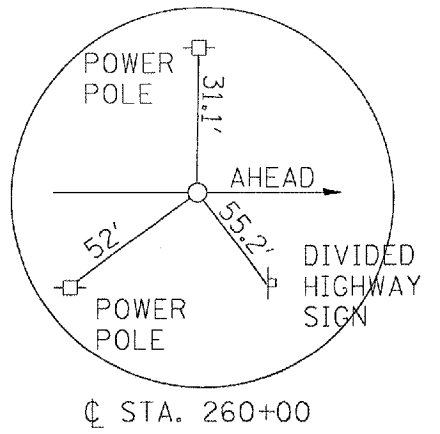
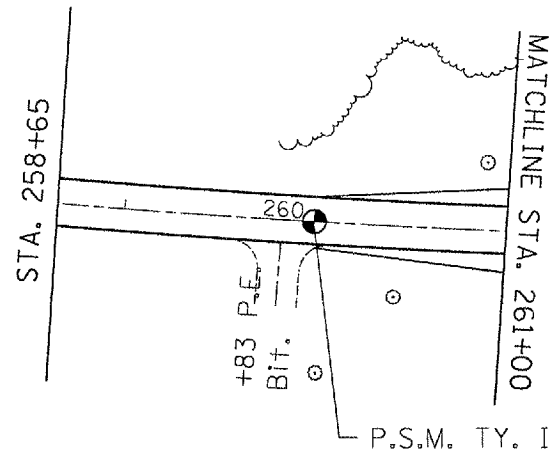
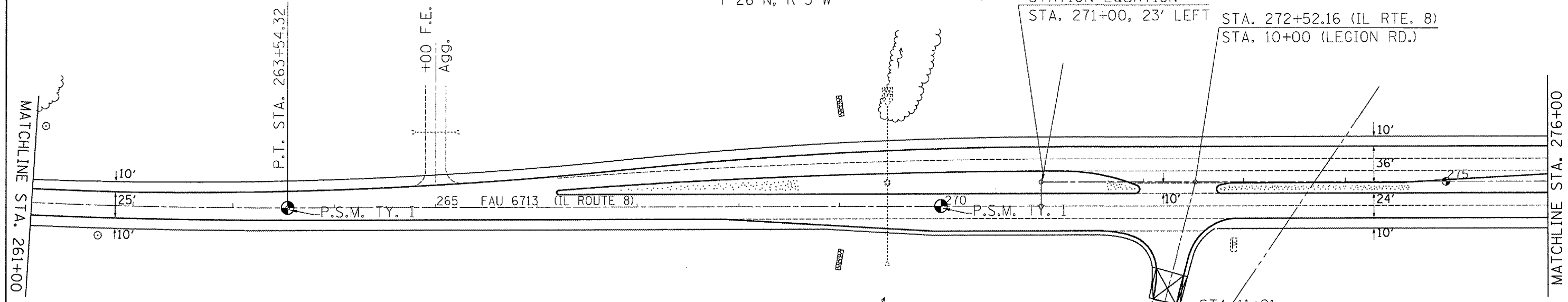

NE 1/4, SECTION 21  
T-26-N, R-3-W

E. LINE W. 1/2, NW. 1/4, SEC. 21  
STA. 273+69.61

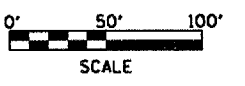

REVISIONS	
NAME	DATE

ILLINOIS DEPARTMENT OF TRANSPORTATION  
PROPOSED PLAN SHEET  
IL ROUTE 8  
STA. 258+65-276+00

SCALE: VERT.  
DATE:                      

DRAWN BY  
CHECKED BY

PLOT DATE = 4/1/2007  
FILE NAME = D:\Projects\2006\24\connect-upland.dgn  
PLOT SCALE = 1/8"=1'-0"  
USER NAME = bjlmeek