

F.A.U. RTE.	SECTION	COUNTY	TOTAL SHEETS	SHEET NO.
35RS-5,36RS-8	TAZEWELL	90	68	
STA.		TO STA.		
FED. ROAD DIST. NO.		ILLINOIS	FED. AID PROJECT	
+6717 (BUS 24) & 6713 (IL 8)				

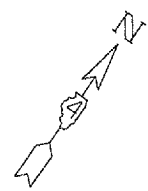

NE 1/4, SECTION 21
T-26-N, R-3-W

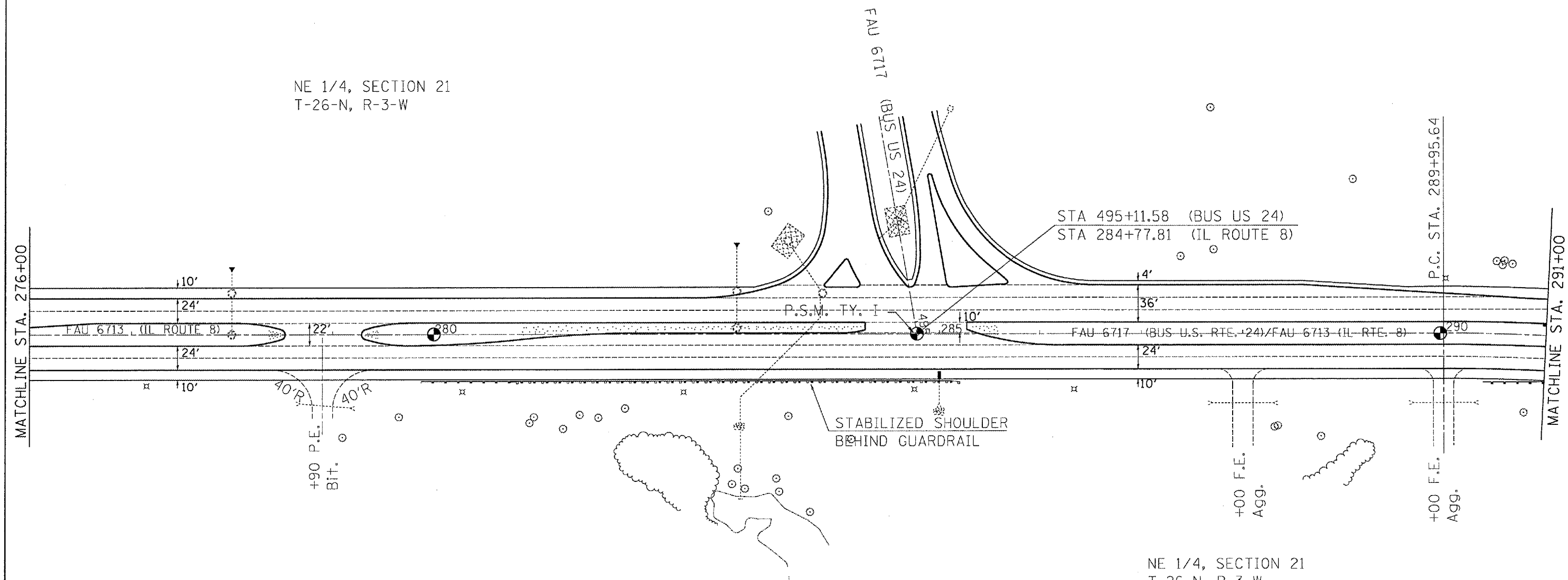

NE 1/4, SECTION 21
T-26-N, R-3-W

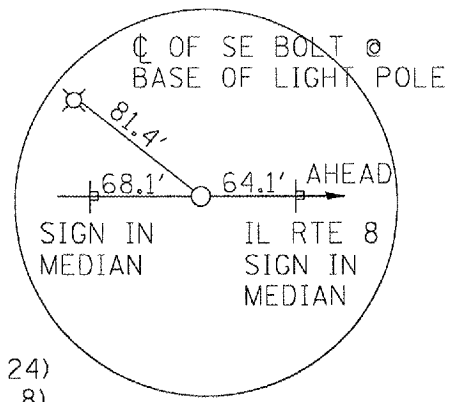

CL STA. 495+11.58 (BUS 24)
CL STA. 284+77.81 (RTE. 8)

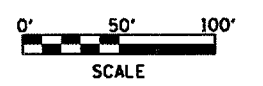

REVISIONS	
NAME	DATE

ILLINOIS DEPARTMENT OF TRANSPORTATION
PROPOSED PLAN SHEET
BUS 24/IL ROUTE 8
STA. 276+00-291+00

SCALE: VERT. DATE
HORIZ. CHECKED BY
DRAWN BY

PLOT DATE = 4/4/2007
FILE NAME = c:\pco\secta\bus24\normal\plan.dgn
PLOT SCALE = 1/8"=1'-0"
USER NAME = kulmank