

F.A.U. RTE.	SECTION	COUNTY	TOTAL SHEETS	SHEET NO.
35RS-5.3GRS-8	TAZEWELL	90	78	
STA.		TO STA.		
FED. ROAD DIST. NO.	ILLINOIS	FED. AID PROJECT		
*6717 (BUS 24) & 6713 (IL 8)				

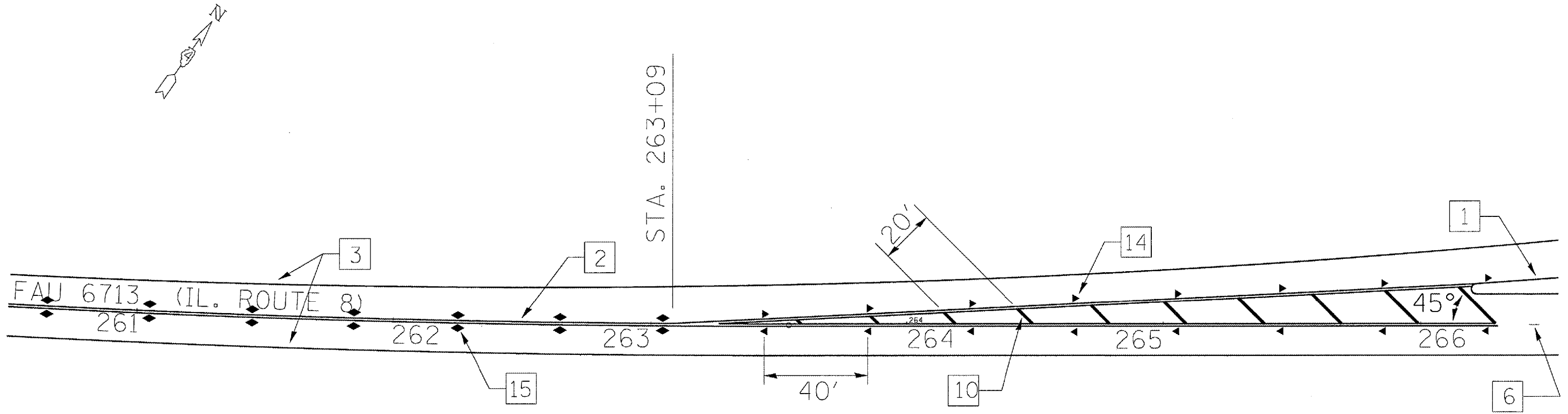

PAVEMENT MARKING LEGEND

- |                                  |   |
|----------------------------------|---|
| [1] 4" YELLOW SOLID              | [12] TURN ARROWS WHITE                                |
| [2] 4" DOUBLE YELLOW SOLID       | [13] RAISED REFLECTIVE PAV'T. MARKER, ONE-WAY CRYSTAL |
| [3] 4" WHITE SOLID               | [14] RAISED REFLECTIVE PAV'T. MARKER, ONE-WAY AMBER   |
| [4] 4" WHITE DASH (10'-30'-10')  | [15] RAISED REFLECTIVE PAV'T. MARKER, TWO-WAY AMBER   |
| [5] 4" YELLOW DASH (10'-30'-10') | [ ] DELINEATOR W/CRYSTAL REFLECTOR                    |
| [6] 6" WHITE DASH (10'-30'-10')  | [ ] DELINEATOR W/AMBER REFLECTOR                      |
| [7] 8" WHITE SOLID               |   |
| [8] 8" WHITE DASH (3'-6'-3')     |   |
| [9] 12" YELLOW SOLID             |   |
| [10] 12" WHITE SOLID             |   |
| [11] 24" WHITE SOLID             |   |

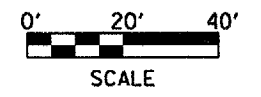

REVISIONS	
NAME	DATE

ILLINOIS DEPARTMENT OF TRANSPORTATION  
**IL ROUTE 8  
 STRIPING**

SCALE: VERT. \_\_\_\_\_  
 HORIZ. \_\_\_\_\_  
 DATE \_\_\_\_\_  
 DRAWN BY \_\_\_\_\_  
 CHECKED BY \_\_\_\_\_

PLOT DATE = 4/4/2007  
 FILE NAME = c:\projects\68351\plan\plan.dgn  
 PLOT SCALE = 48.0000 / IN.  
 USER NAME = h11merkk