

F.A.U. RTE.	SECTION	COUNTY	TOTAL SHEETS	SHEET NO.
*	35RS-5,36RS-8	TAZEWELL	90	83
STA.		TO STA.		
FED. ROAD DIST. NO.	ILLINOIS	FED. AID PROJECT		
*6717 (BUS 24) & 6713 (IL 8)				

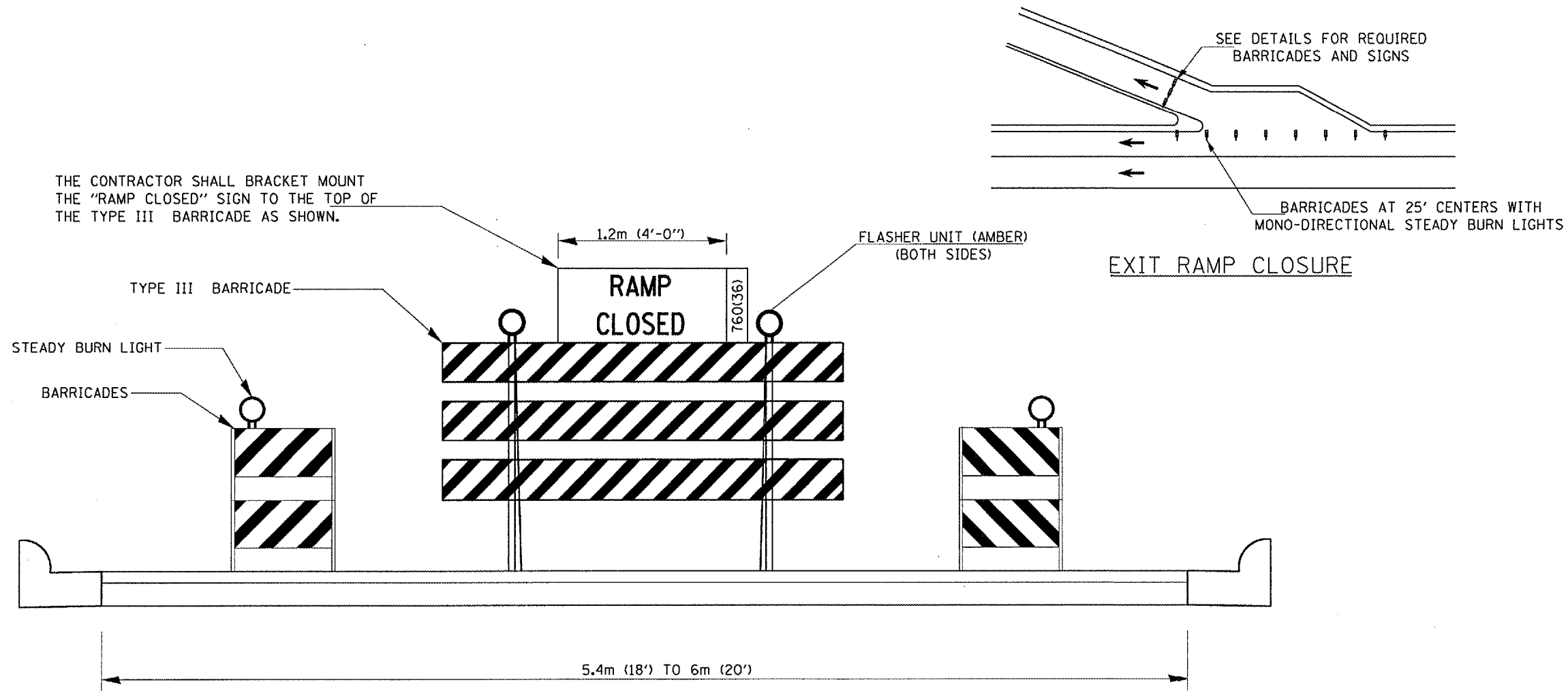

DETAIL FOR REQUIRED BARRICADES & SIGNS

NOTES:

1. CONES MAY BE SUBSTITUTED FOR TYPE II BARRICADES DURING DAY OPERATIONS. CONES SHALL BE A MINIMUM OF 700(28) IN HEIGHT
2. STEADY BURN LIGHTS WILL NOT BE REQUIRED FOR DAY OPERATIONS.

REVISIONS	
NAME	DATE

ILLINOIS DEPARTMENT OF TRANSPORTATION

EXIT RAMP CLOSURE DETAIL

(STANDARD 701411 SPECIAL)

SCALE: VERT. NOT TO SCALE
 HORIZ. NOT TO SCALE

DATE **DATE**

DRAWN BY CADD
 CHECKED BY

DATE: 11/1/2007
 FILE NAME: 68351-53685-8-83-83.dgn
 PLOT SCALE: 1/8"=1'-0"
 PLOT DATE: 11/1/2007 10:00 AM