

INDEX OF SHEETS

- 1 COVER SHEET
- 2 GENERAL NOTES
- 3 SUMMARY OF QUANTITIES
- 4 TYPICAL SECTIONS
- 5 GENERAL SITE PLAN
- 6 RESURFACING DETAIL (BRIDGE APPROACH TAPERBUTT JOINT)
- 7-8 STAGE CONSTRUCTION PLANS
- 9 WIDE LOAD SIGN LOCATION
- 10-23 BRIDGE PLANS
- 24-33 SCOUR MITIGATION PLANS
- 33A-3D R&R SPBLR DETAIL

STANDARDS

- 420401-05
- 630001-07
- 630301-04
- 631031-06
- 631032-03
- 635006-02
- 635011-01
- 701306-01
- 701321-08
- 701326-02
- 702001-06
- 704001-03
- 780001-01
- 781001-02

COMMITMENTS

NONE

DESCRIPTION OF WORK

THE PROPOSED IMPROVEMENTS CONSIST OF SCOUR MITIGATION, REMOVAL OF THE EXISTING BRIDGE SUPERSTRUCTURE AND REPLACING WITH PRECAST, PRESTRESSED CONCRETE DECK BEAMS, BITUMINOUS CONCRETE WEARING SURFACE AND OTHER APPURTENANT ITEMS OF WORK. THE CONTRACTOR SHALL BE RESPONSIBLE FOR FURNISHING ALL LABOR, EQUIPMENT AND MATERIALS NECESSARY TO SATISFACTORILY CONSTRUCT THE PROJECT IN ACCORDANCE WITH THE PLANS, SPECIFICATIONS AND PROVISIONS STATED HEREIN.

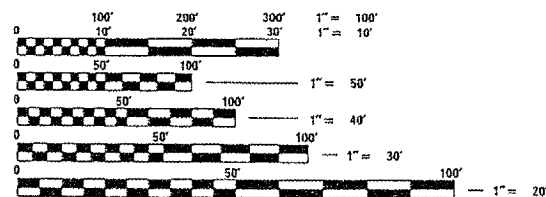

FULL SIZE PLANS HAVE BEEN PREPARED USING STANDARD ENGINEERING SCALES. REDUCED SIZED PLANS WILL NOT CONFORM TO STANDARD SCALES, IN MAKING MEASUREMENTS ON REDUCED PLANS, THE ABOVE SCALES MAY BE USED.

J.U.L.I.E.
JOINT UTILITY LOCATION INFORMATION FOR EXCAVATION
1-800-892-0123

CONTRACT NO. 68415

LENGTH OF PROJECT
GROSS LENGTH: 136 FT = 0.03 MILES
NET LENGTH: 136 FT = 0.03 MILES

STATE OF ILLINOIS
DEPARTMENT OF TRANSPORTATION
DIVISION OF HIGHWAYS

**PROPOSED
HIGHWAY PLANS**

FAP ROUTE 693 (IL RTE 9)
SECTION (119B-3)I
PROJECT NO. F-0693 (058)
TAZEWELL COUNTY
DECK BEAM REPLACEMENT

PLAN = 1" = 30'
PROFILE HORIZ. = 1" = 30'
PROFILE VERT. = 1" = 5'
CROSS SECTIONS = 1" = 10' HORIZ.
1" = 5' VERT.

SCALES

C-94-100-04

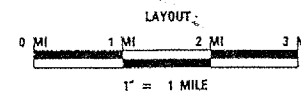
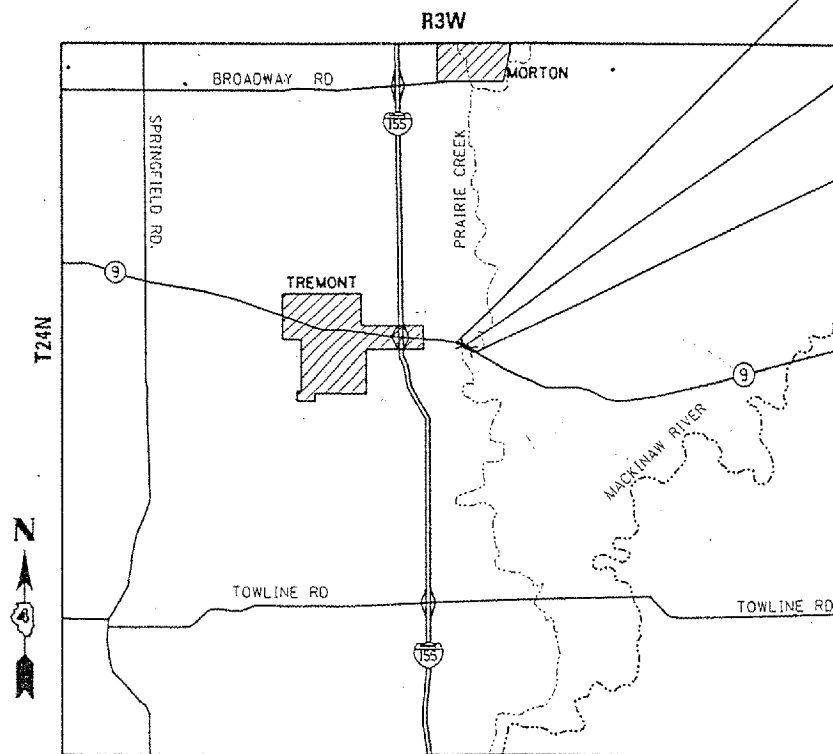

QA/QC BITUMINOUS SUPERPAVE PROJECT

FAP ROUTE	SECTION	COUNTY	TOTAL SHEETS	SHEET NO.
693	(119B-3)I	TAZEWELL	33	1
FED. ROAD DIST. NO.		ILLINOIS	FED. AID PROJECT	

CONTRACT NO. 68415
CATALOG NO. 032903-000
D-94-016-05

33+4=37
total sheets

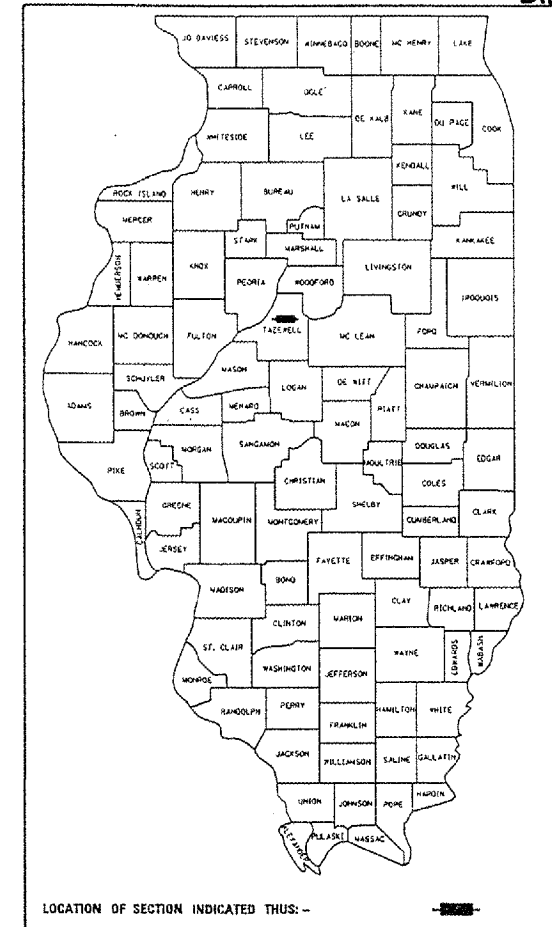

PROJECT BEGIN
STA. 504 + 51.87
LATITUDE 40°31'26" N
LONGITUDE 89°27'49" W

BRIDGE OVER PRAIRIE CREEK
STA. 504 + 88.50 TO STA. 505 + 51.50
S.N. 090-0061

PROJECT END
STA. 505 + 87.50
LATITUDE 40°31'25" N
LONGITUDE 89°27'48" W

2004 ADT = 3600
2024 ADT = 4500

STATE OF ILLINOIS
DEPARTMENT OF TRANSPORTATION
DIVISION OF HIGHWAYS

SUBMITTED *Marc 23 20 07*
DEPUTY DIRECTOR OF HIGHWAYS, REGION 5 ENGINEER
PASSED *Marc 11 20 07*
Eric E. Harms
ENGINEER OF DESIGN AND ENVIRONMENT
APPROVED *Marc 11 20 07*
Milton R. Boes, P.E.
DIRECTOR, DIVISION OF HIGHWAYS

PRINTED BY THE AUTHORITY
OF THE STATE OF ILLINOIS

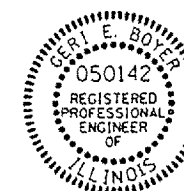

Geri E. Boyer 04/23/06
GERI E. BOYER, P.E.
LICENSE NO. 062-050142
DATE
EXPIRES 11-30-2007

PREPARED BY:
TWM
THOUVENOT, WADE & MOERCHEN, INC.

PROJECT ENGINEER: JAMES MILLER
SQUAD CONTACT: (309) 671-3451