

F.A.P. RTE.	SECTION	COUNTY	TOTAL SHEETS	SHEET NO.
317	(48B)	PEORIA	29	7
STA.		TO STA.		
FED. ROAD DIST. NO.		ILLINOIS FED. AID PROJECT		
D-94-062-05				

RELOCATE TEMPORARY CONCRETE BARRIER	
LOCATION	FOOT
EB U.S. 24 STA. 185+42 TO EB U.S. 24 STA. 187+50	208
EB U.S. 24 STA. 185+42 TO EB U.S. 24 STA. 186+17	75
WB U.S. 24 STA. 186+08 TO WB U.S. 24 STA. 187+50	142
TOTAL	425

TEMPORARY CONCRETE BARRIER	
LOCATION	FOOT
EB U.S. 24 STA. 186+17 TO EB U.S. 24 STA. 187+50	133
WB U.S. 24 STA. 186+08 TO WB U.S. 24 STA. 187+50	142
TOTAL	275

RELOCATE IMPACT ATTENUATORS, TEMPORARY (NON REDIRECTIVE) TEST LEVEL 2	
LOCATION	EACH
EB U.S. 24 STA. 185+22 AND STA. 185+42	1
TOTAL	1

PAVEMENT MARKING TAPE TYPE III 4" (WHITE)	
LOCATION	FOOT
WB CENTER STA. 186+14 TO WB CENTER STA. 184+50	164
WB RIGHT STA. 186+14 TO WB RIGHT STA. 183+15	299
TOTAL	463

PAVEMENT MARKING TAPE TYPE III 4" (SKIP-WHITE)	
LOCATION	FOOT
WB U.S. 24 LEFT STA. 185+30 TO WB U.S. 24 LEFT STA. 184+15	29
TOTAL	29

PAVEMENT MARKING TAPE TYPE III 4" (YELLOW)	
LOCATION	FOOT
EB U.S. 24 LEFT LANE RIGHT STA. 183+75 TO TO STA. 187+50	375
EB U.S. 24 RIGHT LANE LEFT STA. 183+75 TO STA. 187+50	375
WB U.S. 24 LEFT LANE RIGHT STA. 187+50 TO TO STA. 186+14	136
WB U.S. 24 RIGHT LANE LEFT STA. 187+50 TO STA. 186+14	136
TOTAL	1022

FLOW OF TRAFFIC:

U.S. RT. 24

E.B. - FROM STA.176+00 TO STA. 180+00, THE LEFT AND CENTER LANES SHALL BE THROUGH TRAFFIC, AS TRAFFIC CROSSES THE INTERSECTION WITH WASHINGTON, THESE TWO THROUGH LANES WILL SPLIT AS THEY APPROACH THE BRIDGE.

SEE SHEET 8 FOR W.B. FLOW OF TRAFFIC.

STANDARDS:

USE STANDARD 701601 OR 701426 DURING THE SETUP OF STAGE 2 TRAFFIC CONTROL.

STAGE 2 TRAFFIC CONTROL AND PROTECTION DEVICES SHALL BE AS SHOWN ON THESE PLANS AND PER STANDARD 701601.

ALL TRAFFIC CONTROL MEASURES SHOWN IN STANDARD 701601 AND ON THE STAGE 2 DIAGRAMS WILL BE PAID UNDER TRAFFIC CONTROL AND PROTECTION.

USE STANDARD 701601 DURING TEMPORARY LANE CLOSURES WHEN LOADING/UNLOADING TRUCKS.

NOTE:

1. ANY EQUIPMENT, SUCH AS CRANES OR EXCAVATORS, USED TO LOAD OR UNLOAD TRUCKS, SHALL REMAIN BEHIND THE TEMPORARY CONCRETE BARRIERS AT ALL TIMES.

2. EXISTING PAVEMENT MARKINGS THAT CONFLICT WITH STAGING PAVEMENT SHALL BE REMOVED. THIS SHALL BE PAID FOR AS WORK ZONE PAVEMENT MARKING REMOVAL.

3. STANDARD 701601 MAY BE USED DAILY IN EACH DIRECTION ACCORDING TO THE FOLLOWING SCHEDULE:

E.B. 8:30 AM TO 3:30 PM
W.B. REMOVED BY 3:30 PM

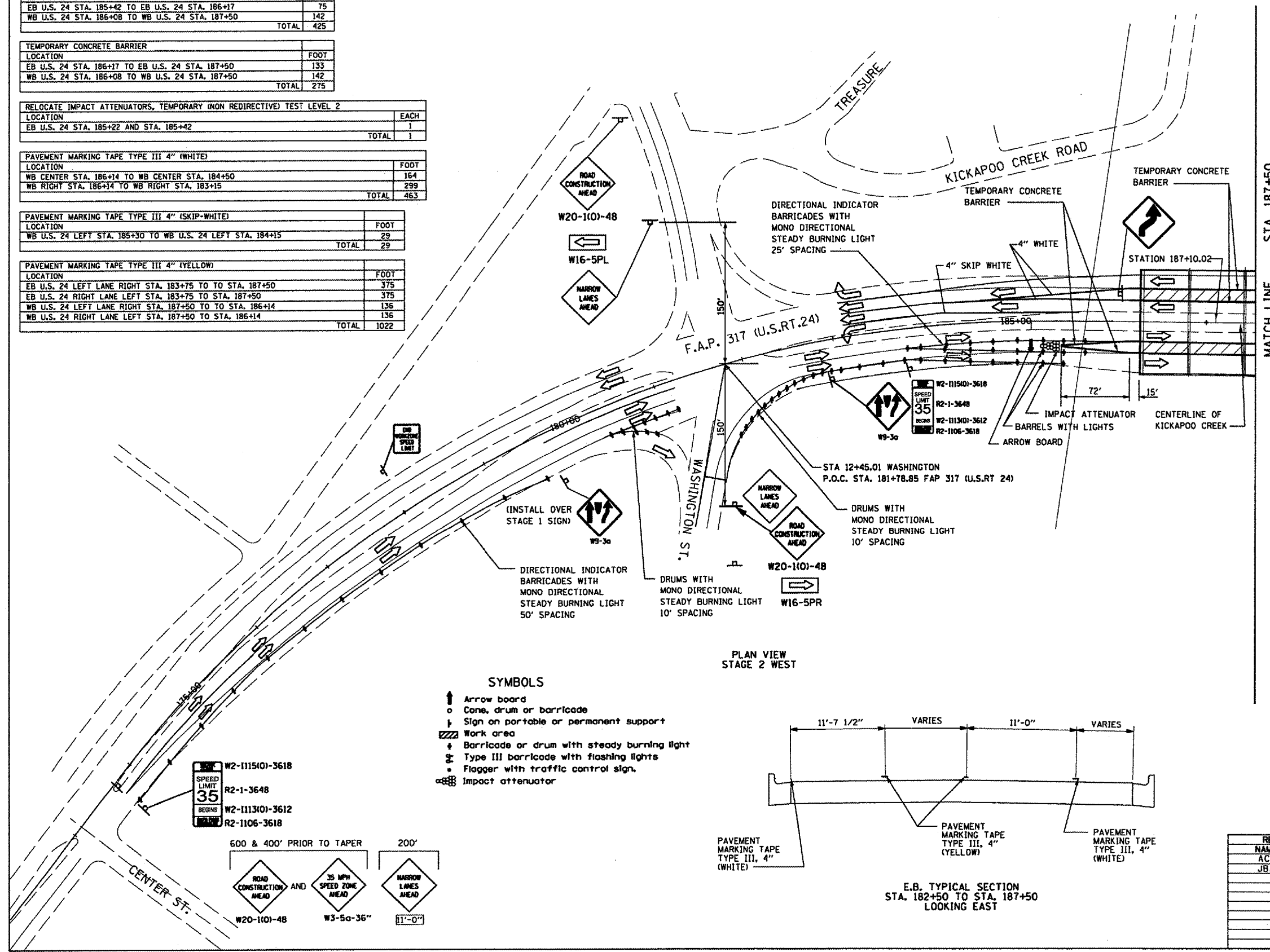

PLAN VIEW
STAGE 2 WEST

- SYMBOLS**
- ↑ Arrow board
 - Cone, drum or barricade
 - ⊥ Sign on portable or permanent support
 - ▨ Work area
 - ⊕ Barricade or drum with steady burning light
 - ⊗ Type III barricade with flashing lights
 - ⊙ Flagger with traffic control sign
 - ⊞ Impact attenuator

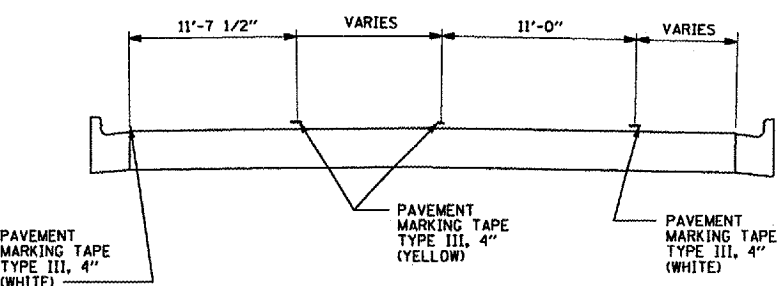

E.B. TYPICAL SECTION
STA. 182+50 TO STA. 187+50
LOOKING EAST

REVISIONS	
NAME	DATE
ACJ	6/30/06
JBA	11/14/06

ILLINOIS DEPARTMENT OF TRANSPORTATION
MAINTENANCE OF TRAFFIC STAGE 2
F.A.P. 317 (U.S. RTE. 24)
STRUCTURE 072-0134
PEORIA COUNTY, ILLINOIS
STATION 187+10.02

SCALE: VERT. _____
HORIZ. _____
DATE _____

DRAWN BY JLP
CHECKED BY JRG/JFS