

STATE OF ILLINOIS
DEPARTMENT OF TRANSPORTATION

ROUTE NO. F.A.P. 317	SECTION (48B)1	COUNTY PEORIA	SHEETS 29	DATE 14	SHEET NO. 2 16 SHEETS
FED. ROAD DIST. NO. 7		ILLINOIS	FED. AID PROJECT D-94-062-05		

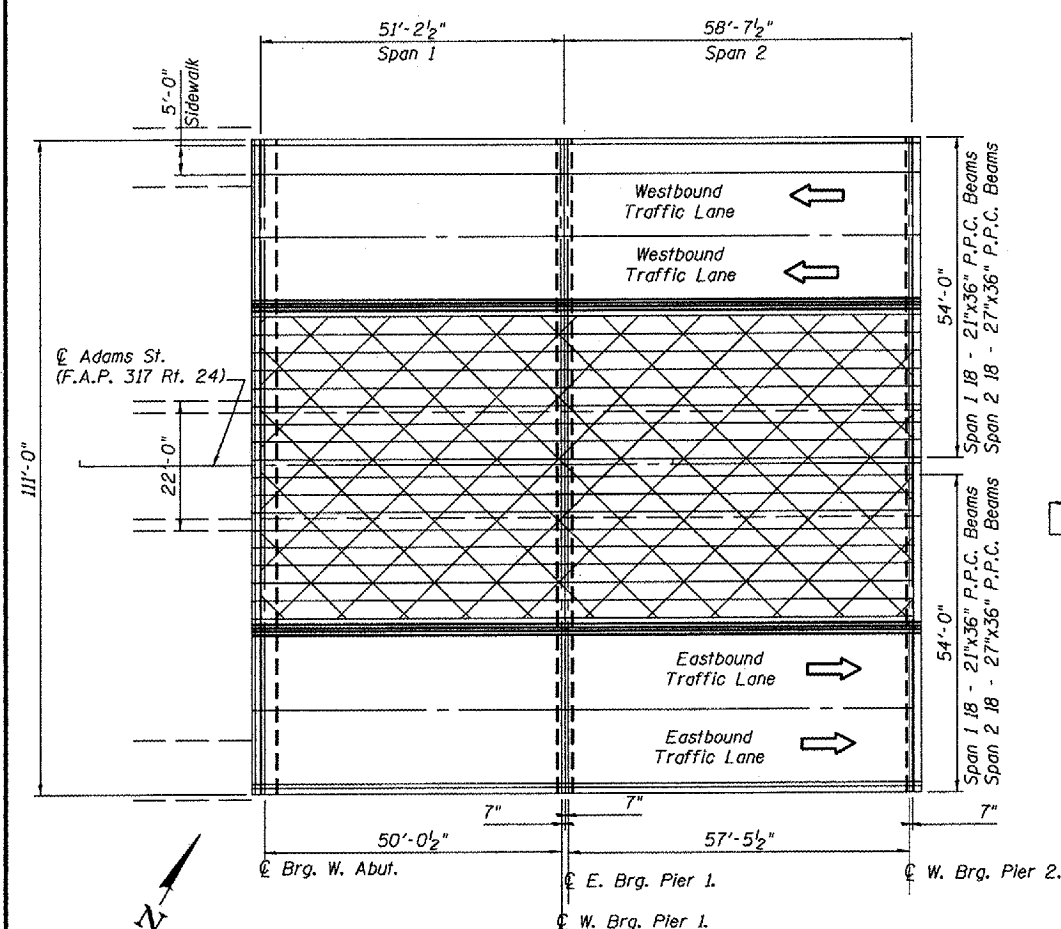

PARTIAL PLAN VIEW EXISTING SPAN 1 & SPAN 2

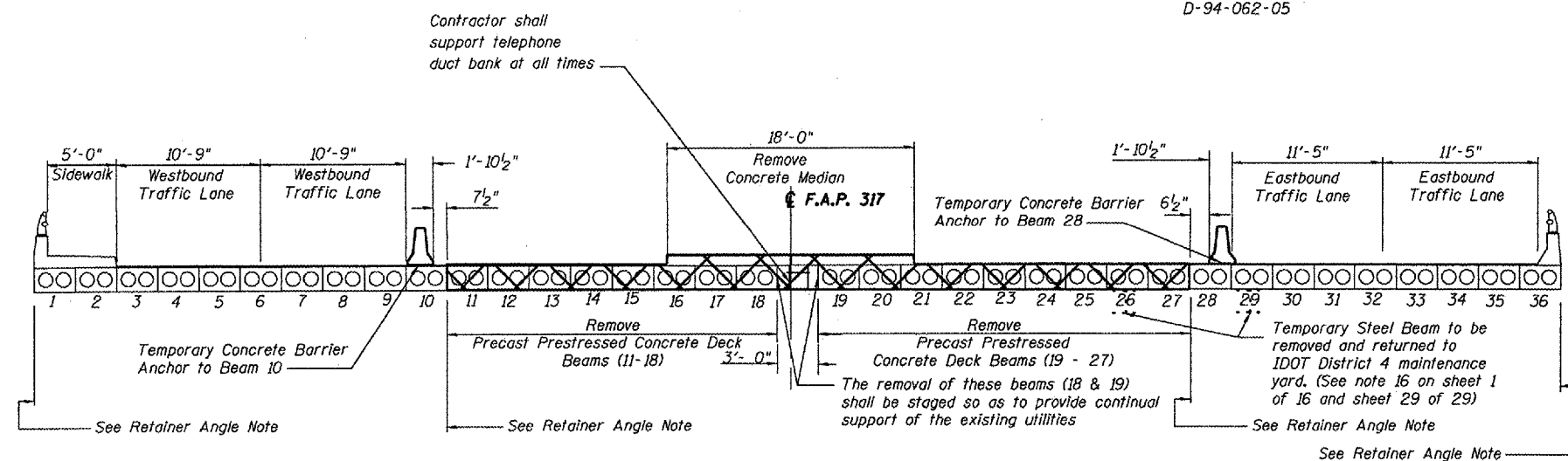

**REMOVAL
SPAN 1 SHOWN SPAN 2 SIMILAR
STAGE 1
LOOKING EAST**

NOTE:
At Pier 1, burn existing dowel rods flush with surface of existing pier cap. Grind existing dowel rods smooth and seal with epoxy prior to placement of Stage 1 PPC Deck Beams. Cost is included with Removal of Existing Superstructures.

Retainer Angle Note:
Retainer angles are required where shown at Abutment and Pier 2. See details on sheet 5.

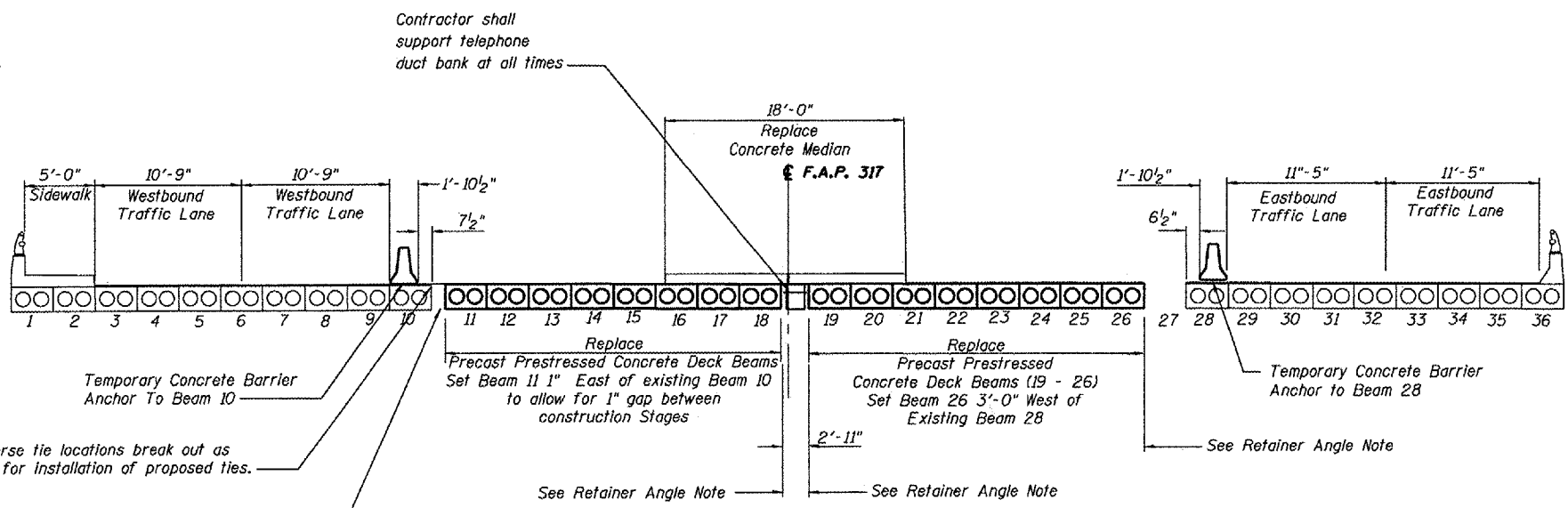

**PROPOSED CONSTRUCTION
SPAN 1 SHOWN SPAN 2 SIMILAR
STAGE 1
LOOKING EAST**

DESIGNED	- JRG
CHECKED	- JFS
DRAWN	- ACJ
CHECKED	- JRG/JFS

**STAGE 1 REMOVAL AND CONSTRUCTION
F.A.P. 317 (U.S. RTE. 24)
STRUCTURE 072-0134
PEORIA COUNTY, ILLINOIS
STATION 187+10.02**