

F.A.P. RTE.	SECTION	COUNTY	TOTAL SHEETS	SHEET NO.
310	87 RS-3	SCHUYLER	26	20
STA. 100+00		TO STA. 110+00		
FED. ROAD DIST. NO.	ILLINOIS	FED. AID PROJECT		
CONTRACT 72839				

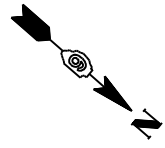
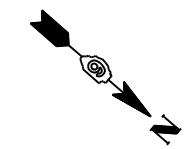
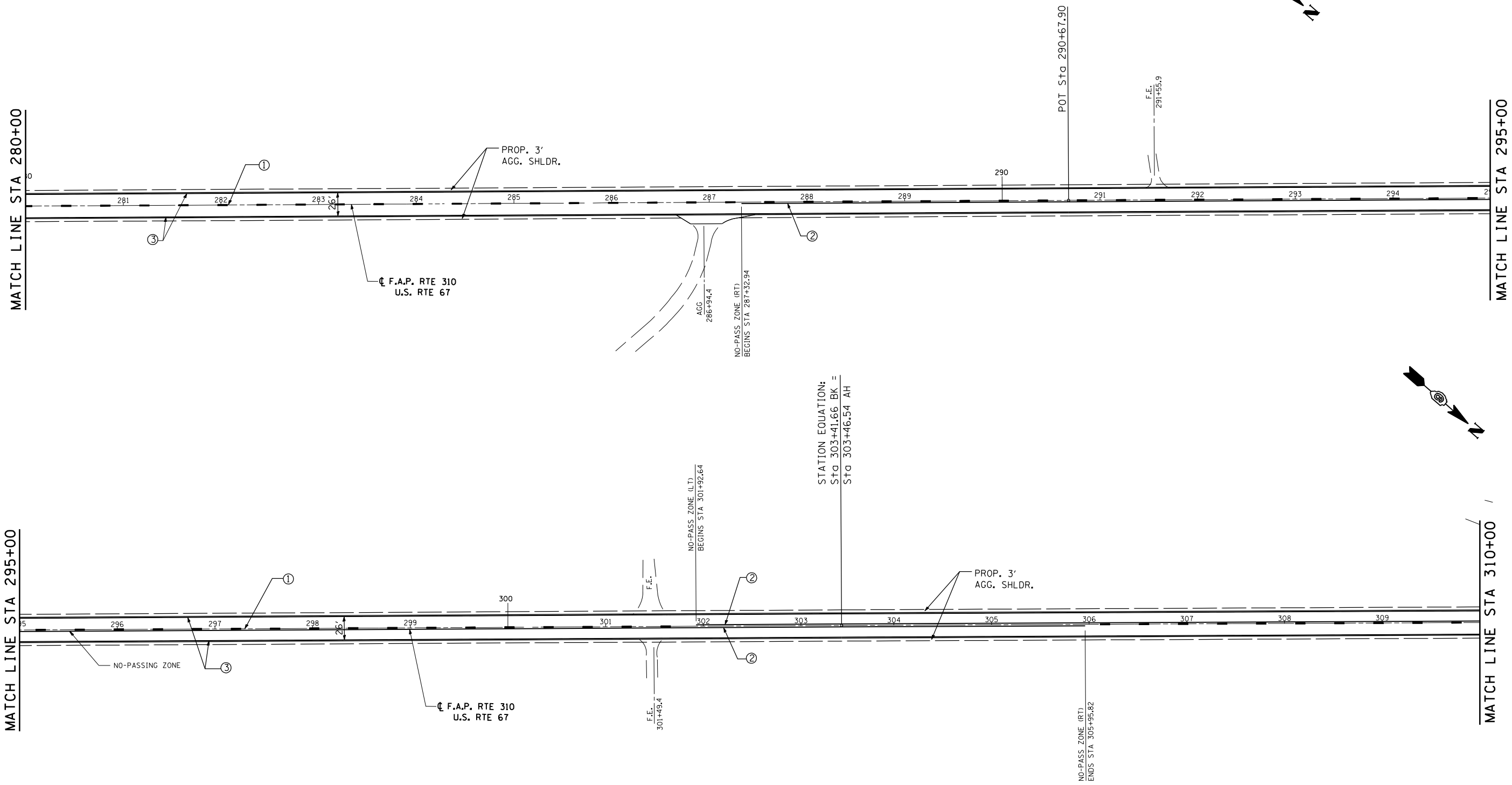

- ① PROPOSED PAINT PAVEMENT MARKING CENTERLINE 5" - SKIP DASH YELLOW
- ② PROPOSED PAINT PAVEMENT MARKING CENTERLINE 5" - SOLID YELLOW
- ③ PROPOSED PAINT PAVEMENT MARKING EDGELINE 5" - SOLID WHITE (12" EITHER SIDE OF CENTERLINE)

REVISIONS	
NAME	DATE

ILLINOIS DEPARTMENT OF TRANSPORTATION  
**ALIGNMENT SCHEMATIC**  
 F. A. P. ROUTE 310 (US 67)  
 SECTION 87 RS-3  
 SCHUYLER COUNTY

SCALE: NOT TO SCALE  
 DATE: NOV, 2003

DRAWN BY: AGG  
 CHECKED BY: MJS