

F.A.P. RTE.	SECTION	COUNTY	TOTAL SHEETS	SHEET NO.
320	(103, 22)(N,TS)	LOGAN	111	47
STA.		TO STA.		
FED. ROAD DIST. NO.	ILLINOIS	FED. AID PROJECT		

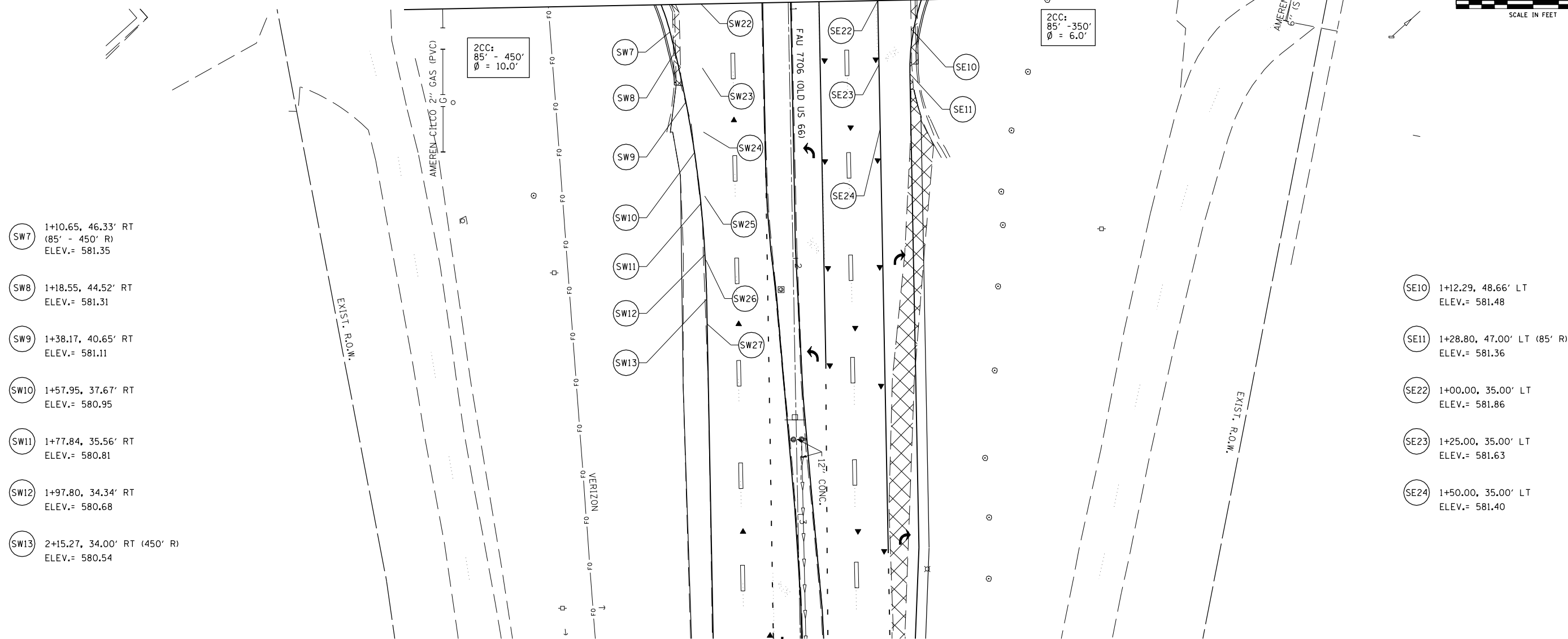

MATCH LINE STA. 1+00.00



- SW7 1+10.65, 46.33' RT (85' - 450' R) ELEV.= 581.35
- SW8 1+18.55, 44.52' RT ELEV.= 581.31
- SW9 1+38.17, 40.65' RT ELEV.= 581.11
- SW10 1+57.95, 37.67' RT ELEV.= 580.95
- SW11 1+77.84, 35.56' RT ELEV.= 580.81
- SW12 1+97.80, 34.34' RT ELEV.= 580.68
- SW13 2+15.27, 34.00' RT (450' R) ELEV.= 580.54

- SE10 1+12.29, 48.66' LT ELEV.= 581.48
- SE11 1+28.80, 47.00' LT (85' R) ELEV.= 581.36
- SE22 1+00.00, 35.00' LT ELEV.= 581.86
- SE23 1+25.00, 35.00' LT ELEV.= 581.63
- SE24 1+50.00, 35.00' LT ELEV.= 581.40

2CC: 85' - 450' Ø = 10.0'

2CC: 85' - 350' Ø = 6.0'

PLOT DATE : 3/26/2007
 FILE NAME : c:\projects\653380\shumdetail.dgn
 PLOT SCALE : 42,352% / IN.
 USER NAME : laughlin-1

REVISIONS	
NAME	DATE

ILLINOIS DEPARTMENT OF TRANSPORTATION
INTERSECTION DETAIL
 IL 10121/WOODLAWN AVE.
 SECTION 103 & 22(N,TS)
 LOGAN COUNTY
 LINCOLN, IL

SCALE: VERT. DATE 09-20-2005
 HORIZ.
 DRAWN BY TMJ
 CHECKED BY VTY