

F.A.P. RTE.	SECTION	COUNTY	TOTAL SHEETS	SHEET NO.
320	*	LOGAN	111	70
STA.		TO STA.		
FED. ROAD DIST. NO.	ILLINOIS	FED. AID PROJECT		

* (103,22)I,N,TS

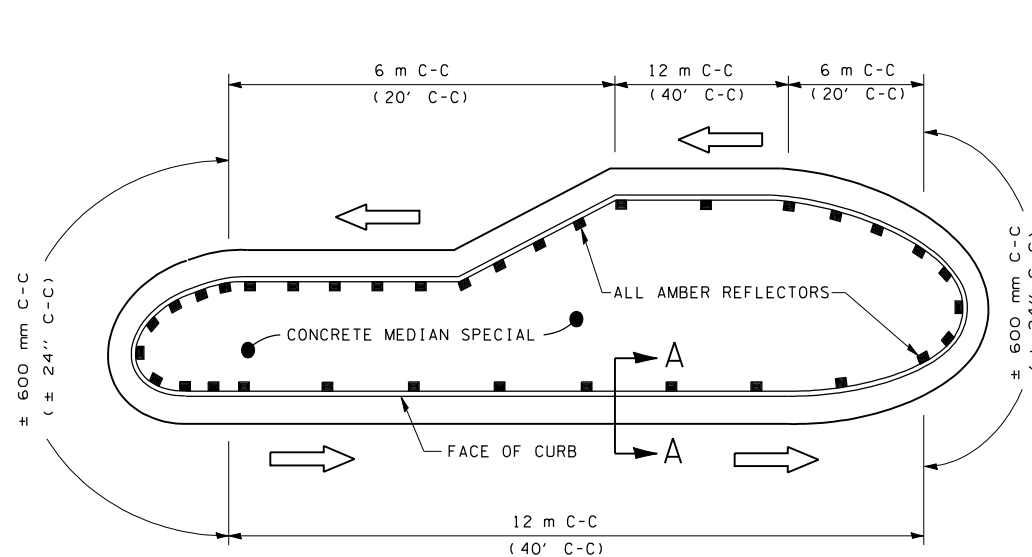

TYPICAL PLACEMENT OF PRISMATIC REFLECTORS ON RAISED MEDIAN

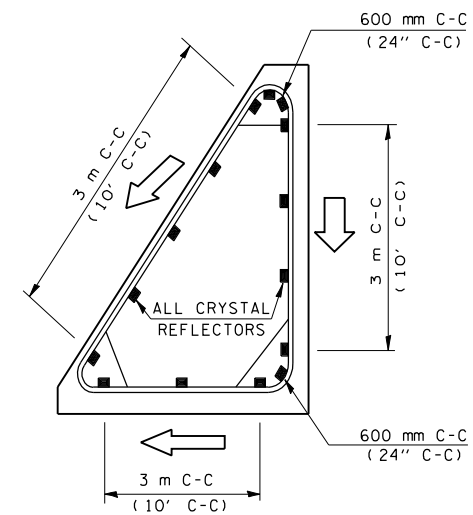

TYPICAL PLACEMENT OF PRISMATIC REFLECTORS ON CURBED CORNER ISLAND

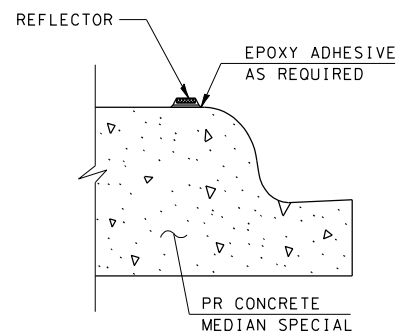

SECTION A-A

LEGEND

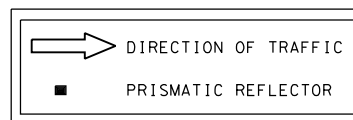

GENERAL NOTES

PRISMATIC REFLECTORS SHALL BE MONO-DIRECTIONAL UNITS AND THE REFLECTOR FACE SHALL BE POSITIONED TO FACE THE APPROACHING TRAFFIC.

PRISMATIC REFLECTORS SHALL BE SECURED IN PLACE WITH AN EPOXY ADHESIVE.

PRISMATIC REFLECTOR FACE SHALL BE EITHER AMBER OR CRYSTAL IN COLOR.

REFER TO SCHEDULES FOR PRISMATIC REFLECTOR QUANTITIES.

NOT TO SCALE

REVISIONS	
NAME	DATE
MWG	10-20-00

ILLINOIS DEPARTMENT OF TRANSPORTATION

PRISMATIC REFLECTOR DETAILS
FAP 320
LOGAN COUNTY
(PLACED ON CURB)

SCALE: VERT.
HORIZ.
DATE: MARCH 2, 1999

DRAWN BY
CHECKED BY