

| FAP RTE             | SECTION    | COUNTY          | TOTAL SHEETS     | SHEET NO. |
|---------------------|------------|-----------------|------------------|-----------|
| 328                 | (68R-2)B-1 | CLAY            | 61               | 9         |
| STA. 1506+00        |            | TO STA. 1512+00 |                  |           |
| FED. ROAD DIST. NO. |            | ILLINOIS        | FED. AID PROJECT |           |

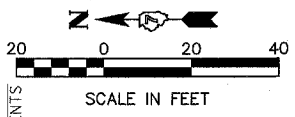

MATCH LINE STA 1506+00  
SEE SHT. 8 FOR CONT.

MATCH LINE STA 1512+00  
SEE SHT. 10 FOR CONT.

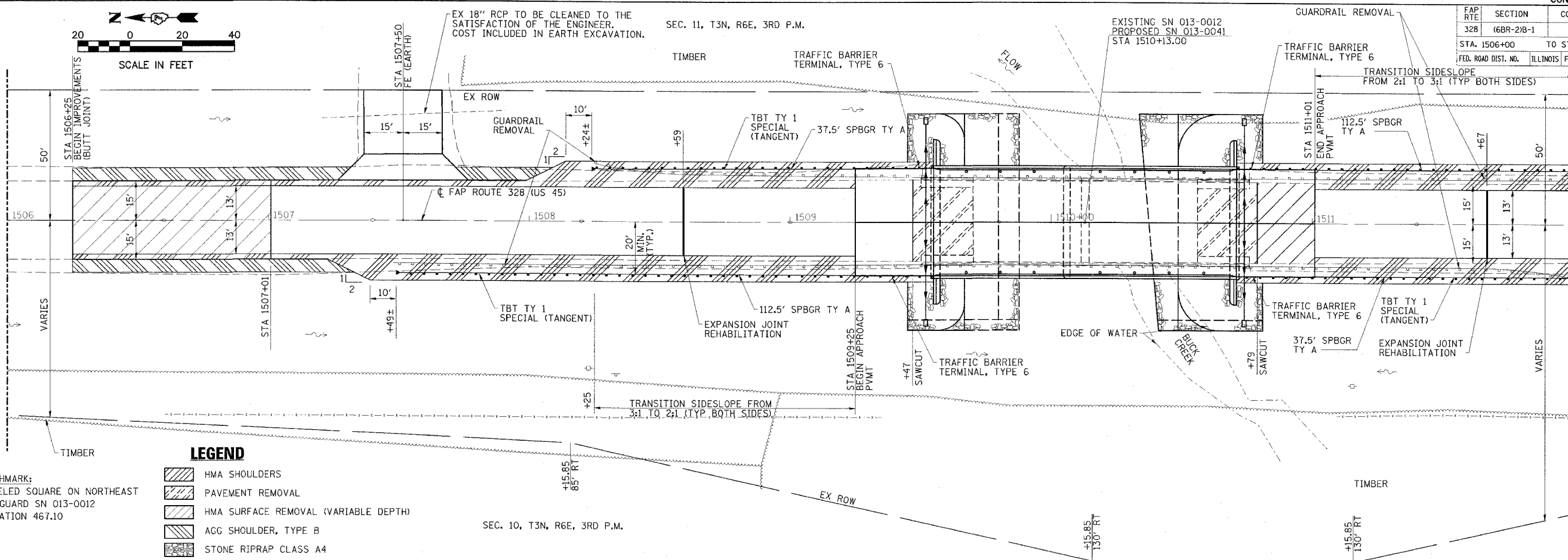

- LEGEND**
- HMA SHOULDERS
  - PAVEMENT REMOVAL
  - HMA SURFACE REMOVAL (VARIABLE DEPTH)
  - ACC SHOULDER, TYPE B
  - STONE RIPRAP CLASS A4
- BENCHMARK:  
CHISELED SQUARE ON NORTHEAST  
HUB GUARD SN 013-0012  
ELEVATION 467.10

|         |      |
|---------|------|
| PLAN    | DATE |
| BY      |      |
| CHECKED |      |
| DATE    |      |

|         |      |
|---------|------|
| PROFILE | DATE |
| BY      |      |
| CHECKED |      |
| DATE    |      |

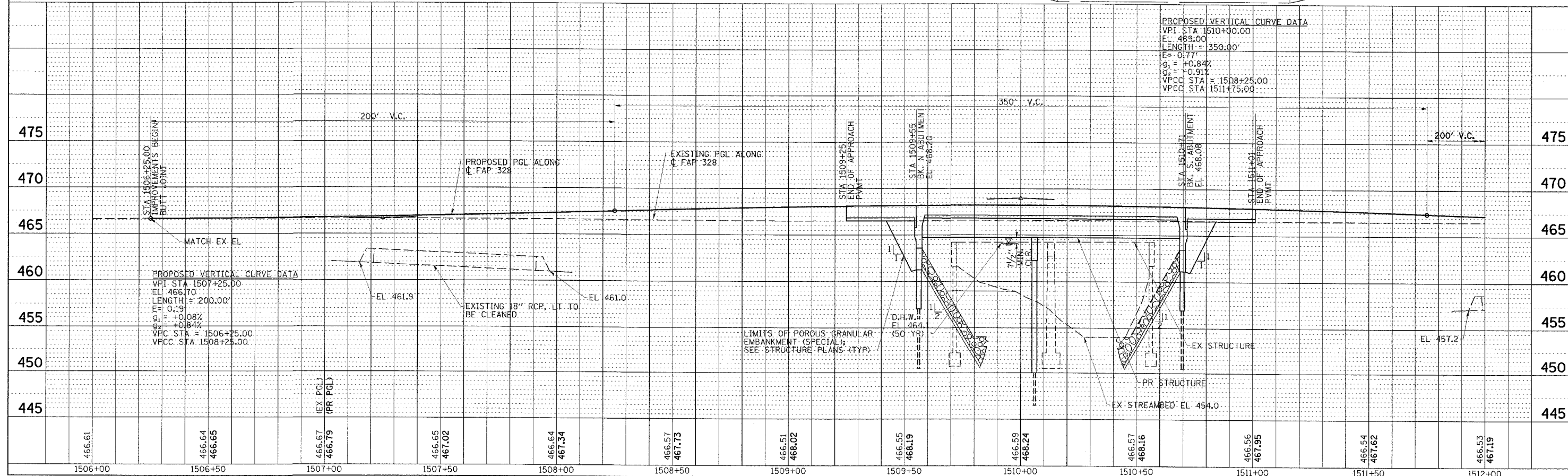

**PROPOSED VERTICAL CURVE DATA**  
 VPI STA 1510+00.00  
 EL 469.00  
 LENGTH = 350.00'  
 $E_1 = 0.77\%$   
 $E_2 = +0.84\%$   
 $E_3 = -0.91\%$   
 VPC STA = 1508+25.00  
 VPTC STA = 1511+75.00

**PROPOSED VERTICAL CURVE DATA**  
 VPI STA 1507+25.00  
 EL 466.70  
 LENGTH = 200.00'  
 $E_1 = +0.19\%$   
 $E_2 = +0.08\%$   
 $E_3 = +0.84\%$   
 VPC STA = 1506+25.00  
 VPTC STA = 1508+25.00

LIMITS OF POROUS GRANULAR EMBANKMENT (SPECIAL); SEE STRUCTURE PLANS (TYP)