

FAP RTE	SECTION	COUNTY	TOTAL SHEETS	SHEET NO.
328	6BR-2B-1	CLAY	61	10
STA. 1512+00		TO STA. 1516+00		
FED. ROAD DIST. NO.		ILLINOIS	FED. AID PROJECT	

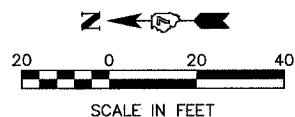

MATCH LINE STA 1512+00
SEE SHT. 9 FOR CONT.

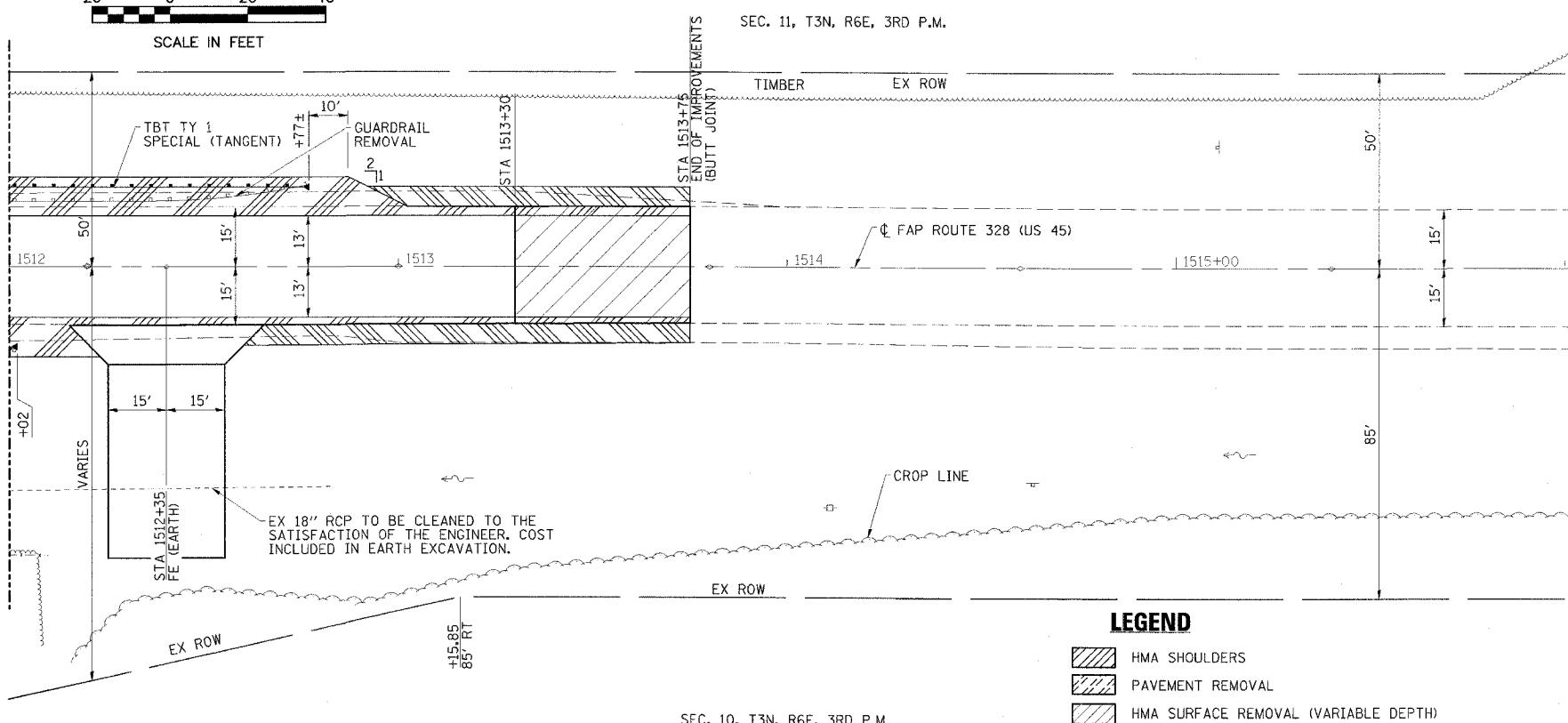

LEGEND

- HMA SHOULDERS
- PAVEMENT REMOVAL
- HMA SURFACE REMOVAL (VARIABLE DEPTH)
- AGG SHOULDER, TYPE B

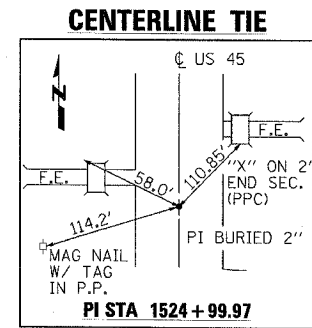

DATE	
BY	
DESIGNED	
CHECKED	
IN CHARGE	
NOTE BOOK NO.	
DATE FILED	
FILE NAME	

DATE	
BY	
DESIGNED	
CHECKED	
IN CHARGE	
NOTE BOOK NO.	
DATE FILED	
FILE NAME	

