

STATE OF ILLINOIS
DEPARTMENT OF TRANSPORTATION

ROUTE NO.	SECTION	COUNTY	JOINT NO.	SHEET NO.	SHEET NO. 5 26 SHEETS
FAP 328	*	CLAY	61	22	
FED. ROAD DIST. NO.		BILLING	FED. AID PROJECT - AID		
CONTRACT NO. 74037				*16BR-21B-1	

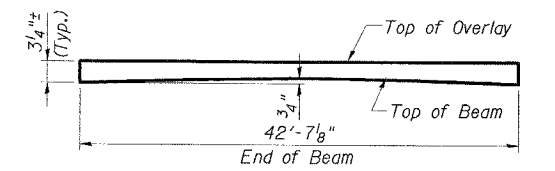

ANTICIPATED INITIAL CAMBER DIAGRAM

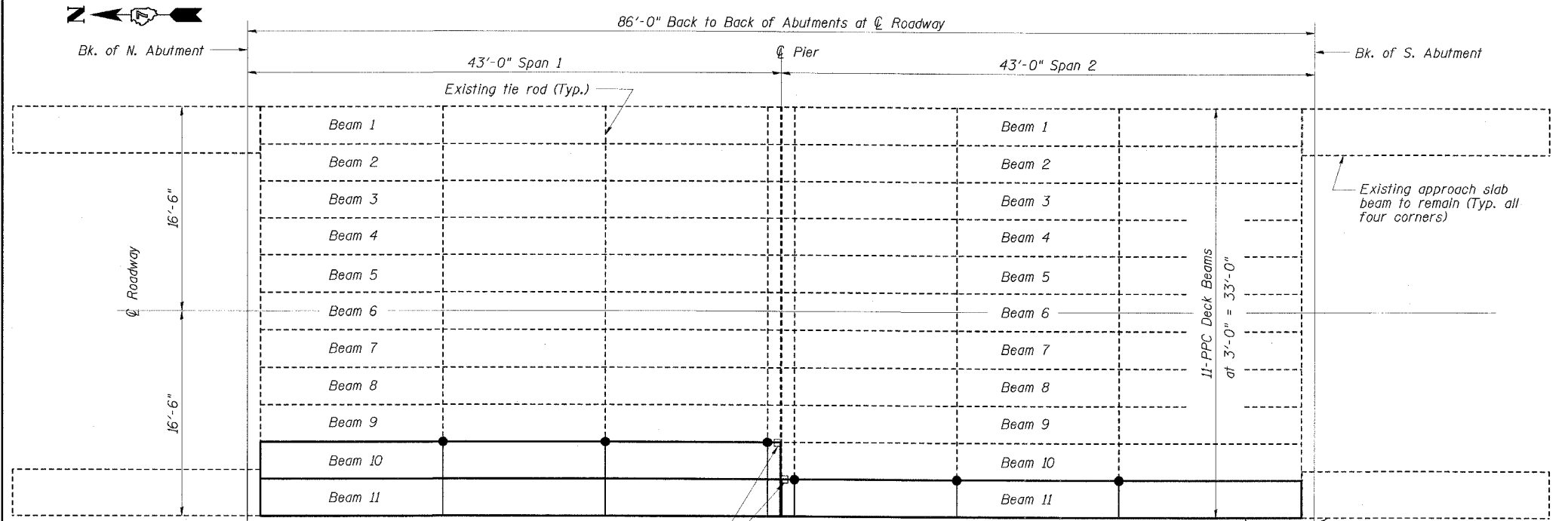
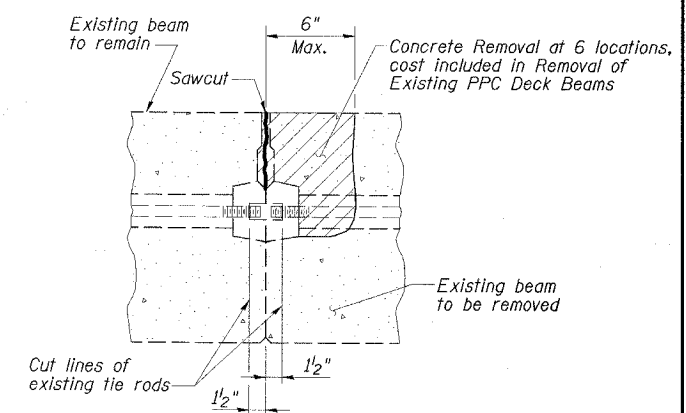

BEAM REMOVAL DETAIL AT TRANSVERSE TIES

Existing 3/4"x7" plate shall be sawcut prior to removal of existing deck beams. Also sawcut existing concrete expansion block and remove any existing reinforcement that interferes with the proposed replacement, cost included in Removal of Existing PPC Deck Beams.

DECK BEAM REPLACEMENT PLAN

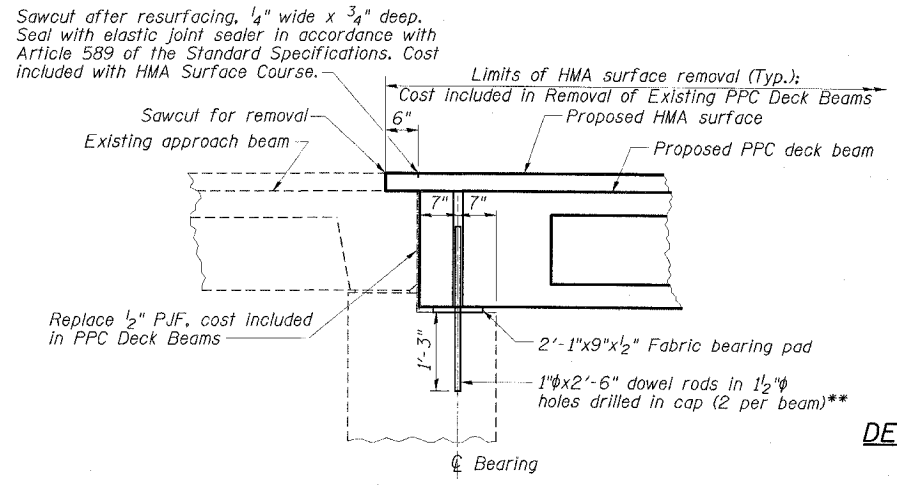

** Existing dowel rods are to be burned off and ground flush prior to placement of new beams. Cost included in Removal of Existing PPC Deck Beams. After beams have been erected holes shall be drilled into cap and dowel rods placed. Dowel holes shall be filled with non-shrink grout to top of beam and allowed to cure a minimum of 24 hours prior to grouting the shear keys, cost included in PPC Deck Beams.

TYPICAL SECTION AT ABUTMENTS

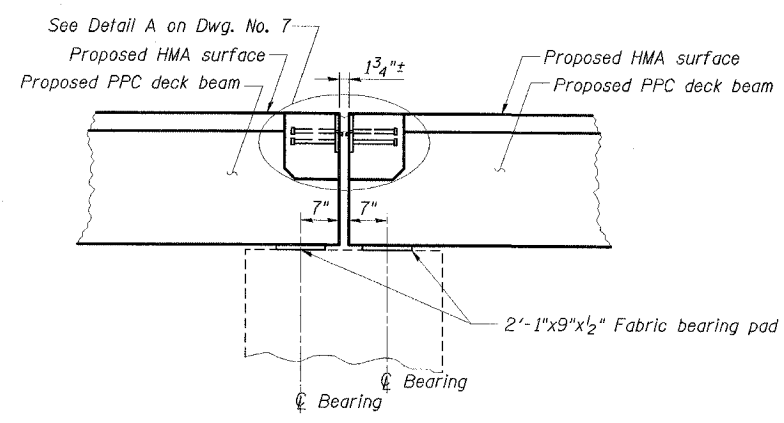

TYPICAL SECTION AT PIER

DESIGN STRESSES
PRECAST UNITS
f'c = 5,000 psi
f'ci = 4,000 psi
f's = 270,000 psi (1/2" low lax strands)
f'si = 201,960 psi (1/2" low lax strands)

DECK BEAM REPLACEMENT DETAILS
US ROUTE 45 OVER
BUCK CREEK
FAP RTE 328-SECTION (6BR-2)B-1
CLAY COUNTY
STATION 1510+13.00
STRUCTURE NO. 013-0041

ESCA
CONSULTANTS, INC.

DESIGNED BY:	ELH	01/07
DRAWN BY:	CJ	01/07
CHECKED BY:	ELH	04/07
APPROVED BY:	RDP	04/07