

STATE OF ILLINOIS
DEPARTMENT OF TRANSPORTATION

ROUTE NO.	SECTION	COUNTY	SHEET NO.	SHEET NO.
FAP 328	6	CLAY	61	28
FFG. ROAD DIST. NO.	ILLINOIS	FED. AID PROJECT - AID		
CONTRACT NO. 74037			* (6BR-2)B-1	

EAST CURB LINE

Location	Station	Offset (ft.)	Theoretical Grade Elevations
End N. Appr. Pav't.	1509+25.00	-20.42	467.76
a	1509+35.00	-20.42	467.79
b	1509+45.00	-20.42	467.82
Bk. N. Abutment	1509+55.00	-20.42	467.84

EAST EDGE OF PAVEMENT

Location	Station	Offset (ft.)	Theoretical Grade Elevations
End N. Appr. Pav't.	1509+25.00	-12.00	467.93
a	1509+35.00	-12.00	467.96
b	1509+45.00	-12.00	467.99
Bk. N. Abutment	1509+55.00	-12.00	468.01

Ø ROADWAY, PG. & STAGE CONSTRUCTION LINE

Location	Station	Offset (ft.)	Theoretical Grade Elevations
End N. Appr. Pav't.	1509+25.00	0.00	468.12
a	1509+35.00	0.00	468.15
b	1509+45.00	0.00	468.18
Bk. N. Abutment	1509+55.00	0.00	468.20

WEST EDGE OF PAVEMENT

Location	Station	Offset (ft.)	Theoretical Grade Elevations
End N. Appr. Pav't.	1509+25.00	12.00	467.93
a	1509+35.00	12.00	467.96
b	1509+45.00	12.00	467.99
Bk. N. Abutment	1509+55.00	12.00	468.01

WEST CURB LINE

Location	Station	Offset (ft.)	Theoretical Grade Elevations
End N. Appr. Pav't.	1509+25.00	20.42	467.76
a	1509+35.00	20.42	467.79
b	1509+45.00	20.42	467.82
Bk. N. Abutment	1509+55.00	20.42	467.84

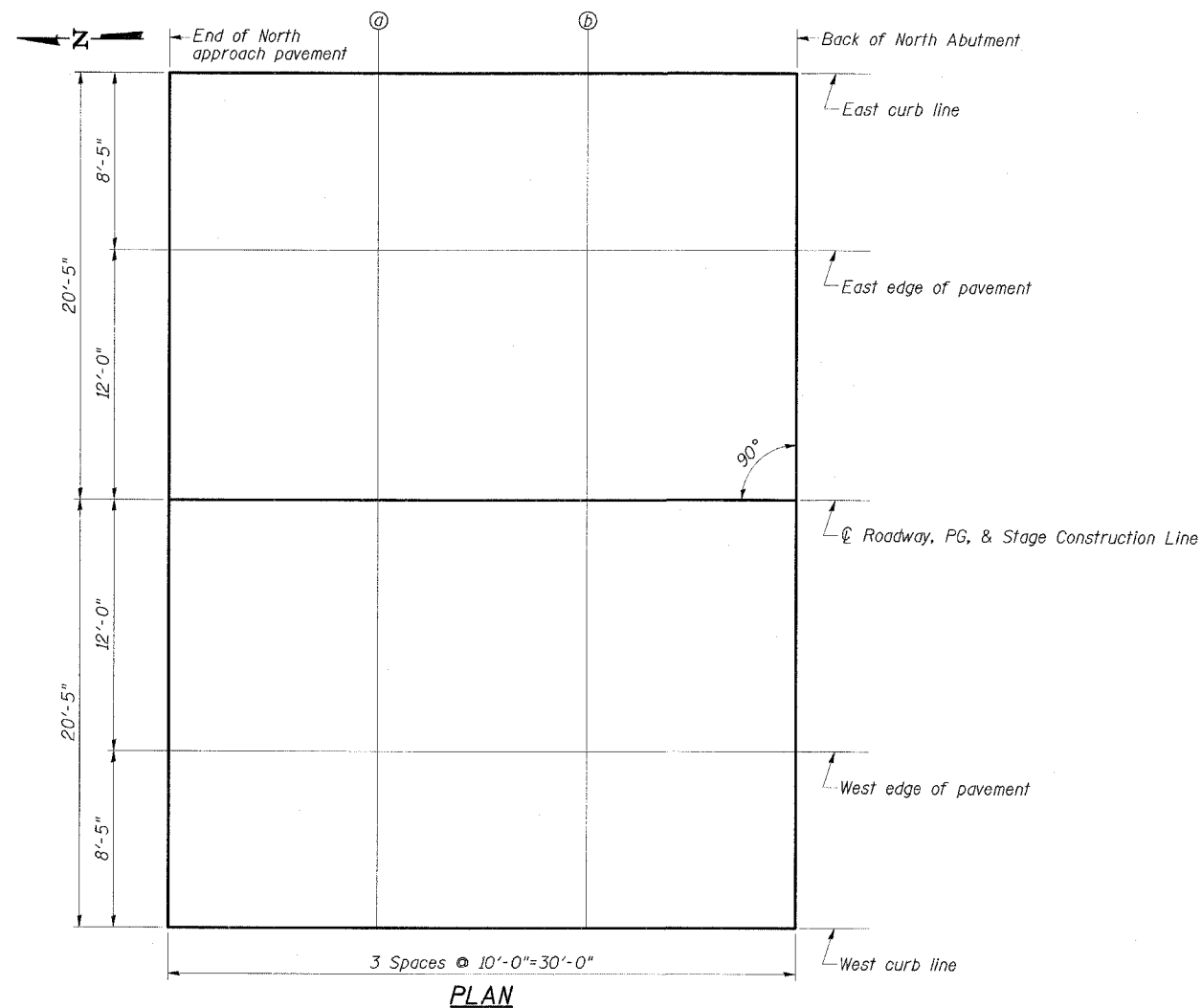

PLAN

TOP OF NORTH APPROACH
SLAB ELEVATIONS
US ROUTE 45 OVER
BUCK CREEK
FAP RTE 328-SECTION (6BR-2)B-1
CLAY COUNTY
STATION 1510+13.00
STRUCTURE NO. 013-0041

ESCA
CONSULTANTS, INC.
DESIGNED BY: ELH 01/07
DRAWN BY: CJ 01/07
CHECKED BY: ELH 01/07
APPROVED BY: RDP 01/07