

STATE OF ILLINOIS
DEPARTMENT OF TRANSPORTATION

ROUTE NO.	SECTION	COUNTY	LISTED SHEETS	SHEET NO.	SHEET NO. 12 26 SHEETS
FAP 328	*	CLAY	61	29	
FED. ROAD EST. NO. *		ILLINOIS PROJECT NO. *	CONTRACT NO. 74037		
				*16BR-2)B-1	

EAST CURB LINE

Location	Station	Offset (ft.)	Theoretical Grade Elevations
Bk. S. Abutment	1510+71.00	-20.42	467.72
a	1510+81.00	-20.42	467.68
b	1510+91.00	-20.42	467.63
End S. Appr. Pav't.	1511+01.00	-20.42	467.58

EAST EDGE OF PAVEMENT

Location	Station	Offset (ft.)	Theoretical Grade Elevations
Bk. S. Abutment	1510+71.00	-12.00	467.90
a	1510+81.00	-12.00	467.85
b	1510+91.00	-12.00	467.81
End S. Appr. Pav't.	1511+01.00	-12.00	467.76

☉ ROADWAY, PG. & STAGE CONSTRUCTION LINE

Location	Station	Offset (ft.)	Theoretical Grade Elevations
Bk. S. Abutment	1510+71.00	0.00	468.08
a	1510+81.00	0.00	468.04
b	1510+91.00	0.00	468.00
End S. Appr. Pav't.	1511+01.00	0.00	467.94

WEST EDGE OF PAVEMENT

Location	Station	Offset (ft.)	Theoretical Grade Elevations
Bk. S. Abutment	1510+71.00	12.00	467.90
a	1510+81.00	12.00	467.85
b	1510+91.00	12.00	467.81
End S. Appr. Pav't.	1511+01.00	12.00	467.76

WEST CURB LINE

Location	Station	Offset (ft.)	Theoretical Grade Elevations
Bk. S. Abutment	1510+71.00	20.42	467.72
a	1510+81.00	20.42	467.68
b	1510+91.00	20.42	467.63
End S. Appr. Pav't.	1511+01.00	20.42	467.58

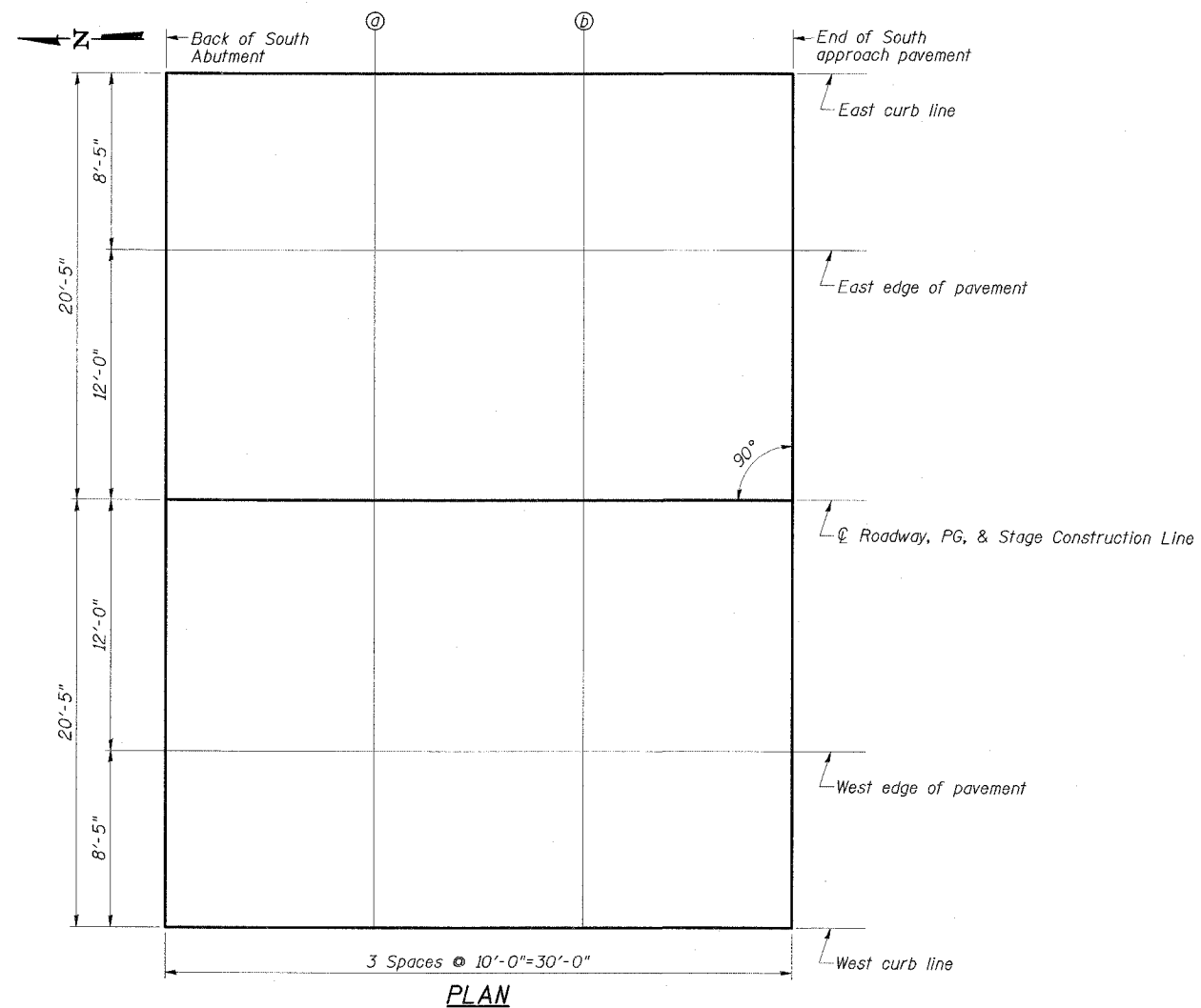

PLAN

TOP OF SOUTH APPROACH
SLAB ELEVATIONS
US ROUTE 45 OVER
BUCK CREEK
FAP RTE 328-SECTION (6BR-2)B-1
CLAY COUNTY
STATION 1510+13.00
STRUCTURE NO. 013-0041

ESCA
CONSULTANTS, INC.

DESIGNED BY:	ELH	01/07
DRAWN BY:	CJ	01/07
CHECKED BY:	ELH	01/07
APPROVED BY:	RDP	01/07