

FOR INFORMATION ONLY

ROUTE NO.	SECTION	COUNTY	SHEET NO.	SHEET NO. 1
FAP 328	*	CLAY	61	44
FED. ROAD DIST. NO.				ILLINOIS FED. ROAD PROJECT
CONTRACT NO. 74037				* 6BR-21B-1

EXISTING BRIDGE TO BE REMOVED AND REPLACED WITH PRECAST/PRESTRESSED CONCRETE BRIDGE. SUPERSTRUCTURE TO BE REMOVED AND REPLACED WITH PRECAST/PRESTRESSED CONCRETE BRIDGE. A TEMPORARY BRIDGE IS REQUIRED WITH A W.W.O. OF 155 TONS PER FOOT. PLANS BY CONTRACTOR. LOADING H550. NO SALVAGE OF EXISTING SUPERSTRUCTURES.

STATE OF ILLINOIS
DEPARTMENT OF PUBLIC WORKS & BUILDINGS

DATE	DESCRIPTION	BY	NO.	SHEET NO. 1
11/14/66	REVISED	J.M.R.	14	6
PROJECT NO. 74037				7 SHEETS

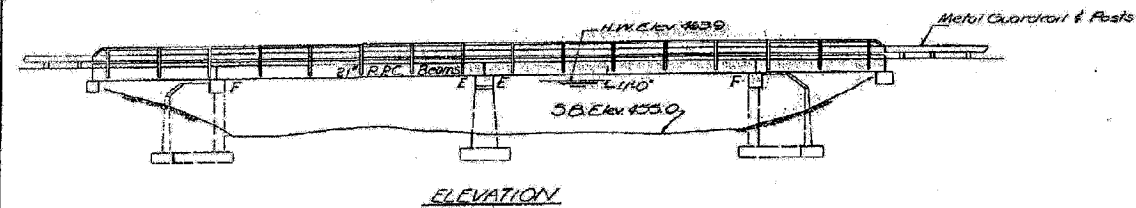

GENERAL NOTES

- All reinforcement bars shall be lapped 24 diameters unless otherwise shown.
- The Basic Lead Silico Chromate paint system shall be used for two coats of shop painting of structural steel.
- It shall be the responsibility of the Contractor to verify all dimensions and conditions existing in the field prior to construction and ordering of materials.
- An alternate strand pattern using Extra High Strength Prestressing strand (270 ksi) is permitted.
- Protective Coat shall not be applied to surfaces to which Deck Tar Interlayer Protective Coat is applied.
- Expansion bolts shall consist of self drilling expansion anchors and 3/4" x 12" hooked bolts.
- Shoulder transition to wingwall shall be shaped with broken concrete. Cost Incidental.

STATION 1510+00
REBUILD 197 BY
STATE OF ILLINOIS
F.A. RT. 26, SEC. 6BR-2
LOADING H550

NAME PLATE
See Std 213

TOTAL BILL OF MATERIAL

Item	Unit	Super	Sub.	Total
* Bituminous Concrete Surface Course Class 1	Sq Yds	50		50
Portland Cement Concrete Pavement (10")	Sq Yds	33		33
Pavement Fabric	Sq Yds	33		33
Concrete Removal	Cu Yds		10	10
Expansion Bolts (3/4")	Each	52	58	110
Class X Concrete	Cu Yds	10.3	20.0	30.3
Precast Concrete Bridge Slab	Sq Ft	299		299
Precast Prestressed Concrete Deck Beam	Sq Ft	2813		2813
Steel Milling, Type T	Lin Ft	251		251
Reinforcement Bars	Lbs	340	2580	2920
Pavement Removal PCC Replacement (See Std)	Sq Yds	10		10
Removal of Existing Superstructure	Each	1		1
Coat for Interlayer Protective Coat	Sq Yds	301		301
Name Plates	Each	1		1
Prefabricated Joint Sealer 2 1/2"	Lin Ft	33		33
Structural Steel	Lbs	870		870
Protective Coat	Sq Yds	42		42
Temporary Bridge Complete	Each		1	1

* Bituminous Concrete Surfacing quantity is from back to back of new abutment caps.

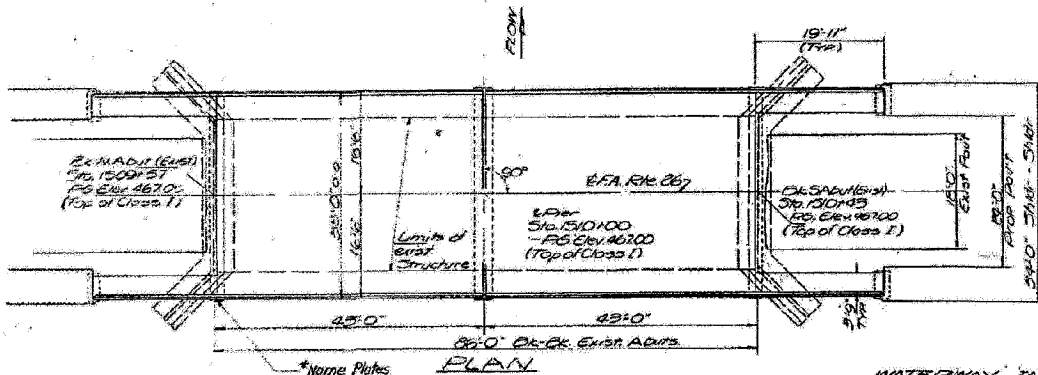

* Clean & place existing Name Plate below new Name Plates. Cost Incidental

DESIGN STRESSES
FIELD UNITS
16,400 psi (Sub-Curb)
15,000 psi (Abutmt)
17-10

PRECAST/PRESTRESSED UNITS
16,400 psi
16,400 psi
15,000 psi (Net Strands)
15,000 psi (Net Strands)

PRECAST UNITS
16,400 psi
16,400 psi
15,000 psi
17-8

Design Specifications 909AASND
(as applicable)
Flange NS allow 65% 30 FL
LOADING H550-44 (NEW 502214)

WATERWAY INFORMATION

Drainage Area: 16.73 Sq Miles
Character: rolling, cultivated
Present Opening: 537 30 FL
Road Opening: 537 30 FL
Proposed Opening: 537 30 FL
Clear: 4250 670

DESIGNED G.E. Ozurt
CHECKED J.M. Rife
DRAWN G.E.O.
CHECKED J.M.R.

EXAMINED
PREPARED
APPROVED

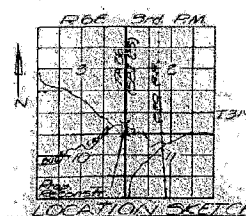

GENERAL PLAN & ELEVATION
FA 26 (SEC 6) OVER BUCK CREEK
FA RT 26, SEC 6BR-2
CLAY COUNTY
STA 1510+00