

F.A.P. RTE.	SECTION	COUNTY	TOTAL SHEETS	SHEET NO.
328	*	WAYNE	19	1

• (24-2,24Z)RS-1

D-97-036-04

STATE OF ILLINOIS
DEPARTMENT OF TRANSPORTATION
DIVISION OF HIGHWAYS

**PROPOSED
HIGHWAY PLANS**

FAP ROUTE 328 (IL 15)
SECTION (24-2,24Z)RS-1
PROJECT: F-0328(021)
WAYNE COUNTY

C-97-074-04

FOR INDEX OF SHEETS, SEE SHEET NO. 2



ADT = 7022 (2005)

PROJECT BEGINS
EB IL 15
STA 0+35

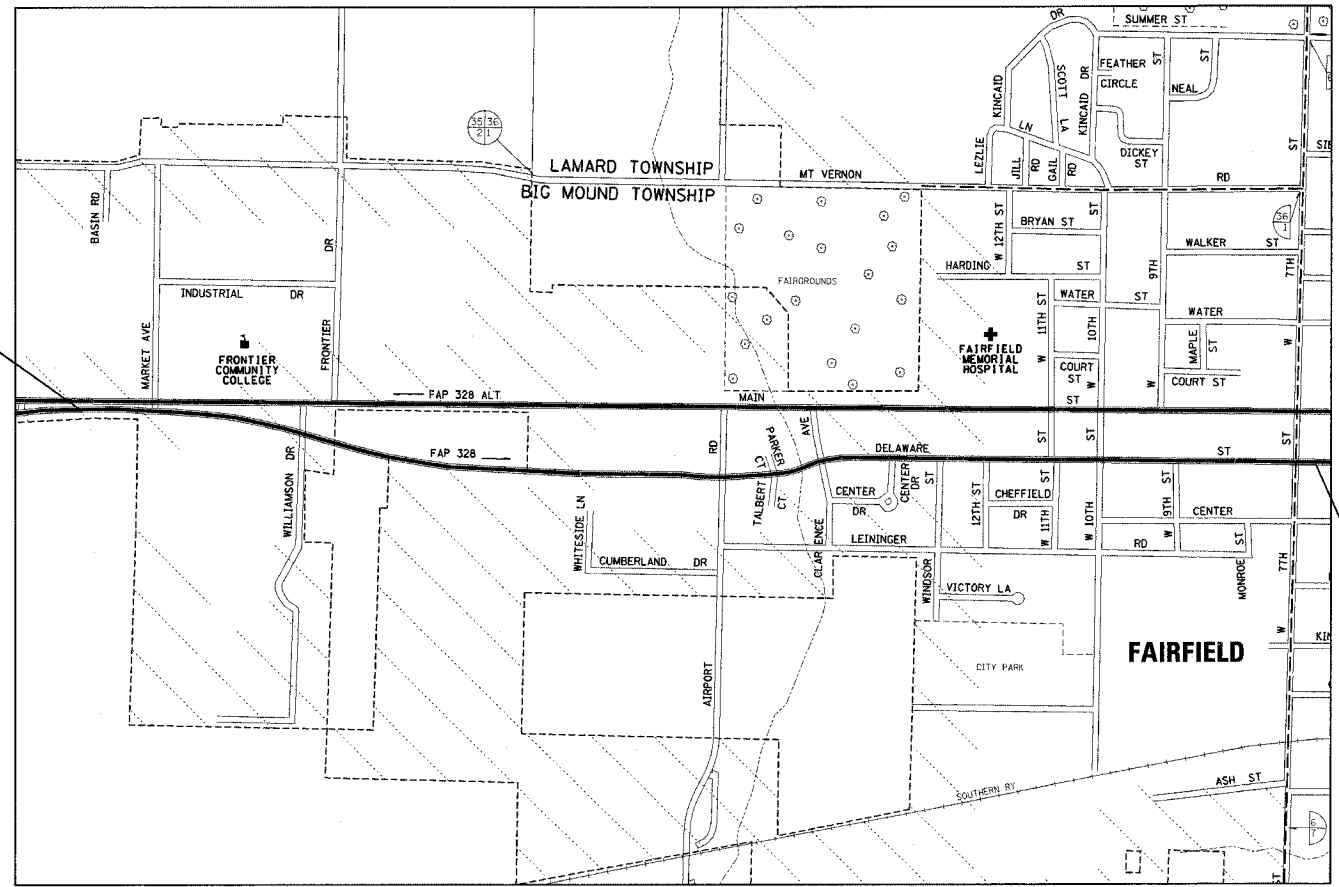

PROJECT ENDS
EB IL 15
STA 85+98

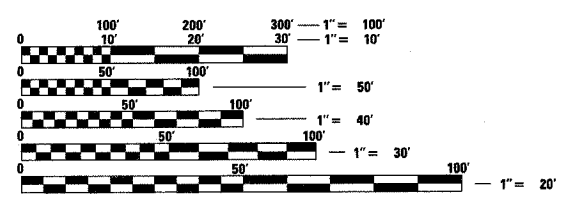

FULL SIZE PLANS HAVE BEEN PREPARED USING STANDARD ENGINEERING SCALES. REDUCED SIZED PLANS WILL NOT CONFORM TO STANDARD SCALES. IN MAKING MEASUREMENTS ON REDUCED PLANS, THE ABOVE SCALES MAY BE USED.

J.U.L.I.E.
JOINT UTILITY LOCATION INFORMATION FOR EXCAVATION
1-800-892-0123

GROSS LENGTH = 8563 FT = 1.62 MILES
NET LENGTH = 8563 FT = 1.62 MILES

STATE OF ILLINOIS
DEPARTMENT OF TRANSPORTATION
DIVISION OF HIGHWAYS

SUBMITTED March 23rd 2007

Christine M. Reed
DEPUTY DIRECTOR OF HIGHWAYS, REGION ENGINEER

May 11, 2007
Eric E. Harsh
INTERIM ENGINEER OF DESIGN AND ENVIRONMENT

May 11, 2007
Milton R. Sees, P.E.
DIRECTOR OF HIGHWAYS, CHIEF ENGINEER

**PRINTED BY THE AUTHORITY
OF THE STATE OF ILLINOIS**

F.A.P. RTE.	SECTION	COUNTY	TOTAL SHEETS	SHEET NO.
328	*	WAYNE	19	2
STA.		TO STA.		
FED. ROAD DIST. NO.	ILLINOIS	FED. AID PROJECT		

• (24-2,24)RS-1

GENERAL NOTES

PAVEMENT MARKING SHALL BE APPLIED IN ACCORDANCE WITH SECTION 780 OF THE STANDARD SPECIFICATIONS. SHORT TERM PAVEMENT MARKING SHALL BE APPLIED TO THE MILLED SURFACE, BITUMINOUS MATERIALS (PRIME COAT), LEVEL BINDER, AND BITUMINOUS SURFACE COURSE AS SPECIFIED IN SECTION 703 OF THE STANDARD SPECIFICATIONS. TEMPORARY TAPE SHALL BE USED ON THE BINDER AND SURFACE COURSE AND PAINT SHALL BE USED ON MILLED SURFACE.

THE TOTAL QUANTITY OF THERMOPLASTIC PAVEMENT MARKING-LINE 4 INCH CONSISTS OF 4183 FEET OF YELLOW AND 3963 FEET OF WHITE.

THE TOTAL QUANTITY OF THERMOPLASTIC PAVEMENT MARKING-LINE 6 INCH CONSISTS OF 2745 FEET OF WHITE.

THE TOTAL QUANTITY OF THERMOPLASTIC PAVEMENT MARKING-LINE 8 INCH CONSISTS OF 112 FEET OF WHITE.

THE TOTAL QUANTITY OF THERMOPLASTIC PAVEMENT MARKING-LINE 12 INCH CONSISTS OF 65 FEET OF WHITE.

THE TOTAL QUANTITY OF THERMOPLASTIC PAVEMENT MARKING-LINE 24 INCH CONSISTS OF 142 FEET OF WHITE.

THE TOTAL QUANTITY OF THERMOPLASTIC PAVEMENT MARKING-LETTERS AND SYMBOLS CONSISTS OF 140 SQUARE FEET OF WHITE.

THE TOTAL QUANTITY OF RAISED REFLECTIVE PAVEMENT MARKERS IS 122 ONE WAY CRYSTAL.

THE MATERIAL USED FOR AGGREGATE SHOULDERS, TYPE B SHALL BE CRUSHED STONE, CRUSHED CONCRETE OR RAP.

THE MATERIAL USED FOR AGGREGATE SURFACE COURSE, TYPE B SHALL BE CRUSHED STONE OR CRUSHED CONCRETE.

20 FEET OF COMBINATION CONCRETE CURB AND GUTTER REMOVAL AND REPLACEMENT HAS BEEN INCLUDED IN THIS CONTRACT. LOCATIONS SHALL BE DETERMINED IN THE FIELD BY THE ENGINEER.

THE EXISTING PAVEMENT SHALL BE PATCHED IN ACCORDANCE WITH SECTION 442 OF THE STANDARD SPECIFICATIONS AND THE SPECIAL PROVISIONS. THE QUANTITY OF PATCHING SHOWN ON THE PLANS IS AN ESTIMATE ONLY AND THE FINAL LOCATIONS AND QUANTITY SHALL BE DETERMINED BY THE ENGINEER IN THE FIELD. ALL PATCHING OPERATIONS SHALL BE COMPLETED BEFORE ANY MILLING OPERATIONS BEGIN.

BITUMINOUS MATERIALS (PRIME COAT) SHALL BE EITHER RC-70 OR AN EMULSIFIED POLYMER PRIME SS-1HP.

THE CONTRACTOR SHALL PROVIDE INTERNET ACCESS TO THE BITUMINOUS PLANT QUALITY CONTROL LAB SO THAT BITUMINOUS PLANT REPORTS CAN BE E-MAILED TO THE DISTRICT HEADQUARTERS. THIS WORK SHALL BE INCLUDED IN THE COST OF ALL BITUMINOUS ITEMS.

THE RESIDENT ENGINEER SHALL BE THE SOLE JUDGE CONCERNING THE CURING TIME FOR THE VARIOUS BITUMINOUS LIFTS.

THE FOLLOWING MIXTURE REQUIREMENTS ARE APPLICABLE FOR THIS PROJECT:

MIXTURE USE: PAVEMENT PATCHING
 PG GRADE: PG 64-22
 RAP %: 15% MAX
 DESIGN AIR VOIDS: 4.0% @ NDESIGN = 70
 MIXTURE COMPOSITION: IL-19.0
 FRICTION AGGREGATE: N/A

MIXTURE USE: LEVEL BINDER - 1"
 PG GRADE: PG 64-22
 RAP %: 10% MAX
 DESIGN AIR VOIDS: 4.0% @ NDESIGN = 90
 MIXTURE COMPOSITION: IL-9.5
 FRICTION AGGREGATE: N/A

MIXTURE USE: SURFACE COURSE - 1.5"
 PG GRADE: PG 64-22
 RAP %: 10% MAX
 DESIGN AIR VOIDS: 4.0% @ NDESIGN = 90
 MIXTURE COMPOSITION: IL-9.5
 FRICTION AGGREGATE: MIXTURE D

MIXTURE USE: BITUMINOUS SHOULDERS
 PG GRADE: PG 58-22
 RAP %: 50% MAX
 DESIGN AIR VOIDS: 3.0% @ NDESIGN = 30
 MIXTURE COMPOSITION: N/A
 FRICTION AGGREGATE: N/A

MIXTURE USE: INCIDENTAL SURFACE MIX
 PG GRADE: PG 64-22
 RAP %: 15% MAX
 DESIGN AIR VOIDS: 4.0% @ NDESIGN = 50
 MIXTURE COMPOSITION: IL-9.5
 FRICTION AGGREGATE: MIXTURE C

THE FOLLOWING RATES OF APPLICATION HAVE BEEN USED IN CALCULATING PLAN QUANTITIES:

AGGREGATE SURFACE COURSE	2.05	TONS/CU YD
AGGREGATE SHOULDERS	2.05	TONS/CU YD
BITUMINOUS MATERIALS (PRIME COAT)	0.10	GAL/SQ YD
AGGREGATE (PRIME COAT)	4	LBS/SQ YD
INCIDENTAL HOT MIX ASPHALT	112	LBS/SQ YD/INCH
HOT-MIX ASPHALT	2.016	TONS/CU YD

INDEX OF SHEETS

SHEET NO.	TITLE
1	COVER SHEET
2	GENERAL NOTES & INDEX OF SHEETS
3	SUMMARY OF QUANTITIES
4-7	TYPICAL SECTIONS & BUTT JOINT DETAILS
8	SCHEDULE OF QUANTITIES
9	ENTRANCE SCHEDULE
10-17	PLAN SHEETS
18-19	TYPICAL APPLICATION OF PAVEMENT MARKINGS

THE FOLLOWING STANDARDS ARE A PART OF THESE PLANS AND ARE INCLUDED AFTER SHEET NO. 19:

STD. NO.	DESCRIPTION
000001-04	STANDARD SYMBOLS, ABBREVIATIONS AND PATTERNS
001006	DECIMAL OF AN INCH AND OF A FOOT
442101-06	CLASS B PATCHES
606001-03	CONCRETE CURB TYPE B AND COMBINATION CONCRETE CURB AND GUTTER
701101-01	OFF-RD OPERATIONS, MULTILANE, 15' TO 24" FROM PAVEMENT EDGE
701426-02	LANE CLOSURE, MULTILANE, INTERMITTENT OR MOVING OPER., FOR SPEEDS >= 45 MPH
701601-04	URBAN LANE CLOSURE, MULTILANE, 1W OR 2W WITH NONTRAVERSABLE MEDIAN (sheet 1 of 2 only)
702001-06	TRAFFIC CONTROL DEVICES
780001-01	TYPICAL PAVEMENT MARKINGS
781001-02	TYPICAL APPLICATIONS RAISED REFLECTIVE PAVEMENT MARKERS

REVISIONS	
NAME	DATE

ILLINOIS DEPARTMENT OF TRANSPORTATION

**GENERAL NOTES
&
INDEX OF SHEETS**

SCALE: VERT.
HORIZ.
DATE

DRAWN BY
CHECKED BY

F.A.P. RTE.	SECTION	COUNTY	TOTAL SHEETS	SHEET NO.
328	.	WAYNE	19	3
STA.		TO STA.		
FED. ROAD DIST. NO.		ILLINOIS FED. AID PROJECT		

SUMMARY OF QUANTITIES

SUMMARY OF QUANTITIES			URBAN 80% FED 20% STATE TOTAL QUANTITIES	CONSTRUCTION TYPE CODE		
CODE NO	ITEM	UNIT		1000	Y025 50% STATE 50% CITY	Y025 100% CITY
40200800	AGGREGATE SURFACE COURSE, TYPE B	TON	45	45		
40600100	BITUMINOUS MATERIALS (PRIME COAT)	GALLON	6485	4667	1818	
40600300	AGGREGATE (PRIME COAT)	TON	130	94	36	
40600645	LEVELING BINDER (MACHINE METHOD), N90	TON	1522	1293	229	
40600895	CONSTRUCTING TEST STRIP	EACH	1	1		
40600982	HOT-MIX ASPHALT SURFACE REMOVAL - BUTT JOINT	SQ YD	412	412		
40600985	PORTLAND CEMENT CONCRETE SURFACE REMOVAL - BUTT JOINT	SQ YD	781	781		
40600990	TEMPORARY RAMP	SQ YD	108	108		
40603345	HOT-MIX ASPHALT SURFACE COURSE, MIX "D", N90	TON	2576	1940	636	
40800050	INCIDENTAL HOT-MIX ASPHALT SURFACING	TON	157	157		
44001700	COMBINATION CONCRETE CURB AND GUTTER REMOVAL AND REPLACEMENT	FOOT	20	20		
44200970	CLASS B PATCHES, TYPE II, 10 INCH	SQ YD	492	482		10
44200974	CLASS B PATCHES, TYPE III, 10 INCH	SQ YD	40	40		
44200976	CLASS B PATCHES, TYPE IV, 10 INCH	SQ YD	27	27		
48101200	AGGREGATE SHOULDERS, TYPE B	TON	202	202		
48203100	HOT-MIX ASPHALT SHOULDERS	TON	24	24		
60300305	FRAMES AND LIDS TO BE ADJUSTED	EACH	11	11		
67000500	ENGINEER'S FIELD OFFICE, TYPE B	CAL MO	3	3		
67100100	MOBILIZATION	L SUM	1	1		
70102630	TRAFFIC CONTROL AND PROTECTION, STANDARD 701601	L SUM	1	1		
70300100	SHORT-TERM PAVEMENT MARKING	FOOT	1713	1713		
70300610	TEMPORARY PAINT PAVEMENT MARKING, LETTERS AND SYMBOLS	SQ FT	140	140		
70300625	TEMPORARY PAINT PAVEMENT MARKING LINE 4"	FOOT	8146	8146		
70300635	TEMPORARY PAINT PAVEMENT MARKING LINE 6"	FOOT	2745	2745		
70300640	TEMPORARY PAINT PAVEMENT MARKING LINE 8"	FOOT	112	112		
70300645	TEMPORARY PAINT PAVEMENT MARKING LINE 12"	FOOT	65	65		
70300660	TEMPORARY PAINT PAVEMENT MARKING LINE 24"	FOOT	142	142		
70301000	WORK ZONE PAVEMENT MARKING REMOVAL	SQ FT	286	286		
* 78000100	THERMOPLASTIC PAVEMENT MARKING - LETTERS AND SYMBOLS	SQ FT	140	140		

SUMMARY OF QUANTITIES			URBAN 80% FED 20% STATE TOTAL QUANTITIES	CONSTRUCTION TYPE CODE		
CODE NO	ITEM	UNIT		1000	Y025 50% STATE 50% CITY	Y025 100% CITY
* 78000200	THERMOPLASTIC PAVEMENT MARKING - LINE 4"	FOOT	8146	8146		
* 78000400	THERMOPLASTIC PAVEMENT MARKING - LINE 6"	FOOT	2745	2745		
* 78000500	THERMOPLASTIC PAVEMENT MARKING - LINE 8"	FOOT	112	112		
* 78000600	THERMOPLASTIC PAVEMENT MARKING - LINE 12"	FOOT	65	65		
* 78000650	THERMOPLASTIC PAVEMENT MARKING - LINE 24"	FOOT	142	142		
* 78100100	RAISED REFLECTIVE PAVEMENT MARKER	EACH	122	122		
78300200	RAISED REFLECTIVE PAVEMENT MARKER REMOVAL	EACH	122	122		
Z0075300	TIE BARS	EACH	23	23		

PLT DATE = #DATE#
 PLOT SCALE = #SCALE#
 USER NAME = #USER#

REVISIONS	
NAME	DATE

ILLINOIS DEPARTMENT OF TRANSPORTATION

SUMMARY OF QUANTITIES

SCALE: VERT. _____
 HORIZ. _____

DATE _____

DRAWN BY _____
 CHECKED BY _____

* SPECIALTY ITEMS

Rev.

F.A.P. RTE.	SECTION	COUNTY	TOTAL SHEETS	SHEET NO.
328	*	WAYNE	19	4
STA.		TO STA.		
FED. ROAD DIST. NO.	ILLINOIS	FED. AID PROJECT		

• (24-2,24)RS-1

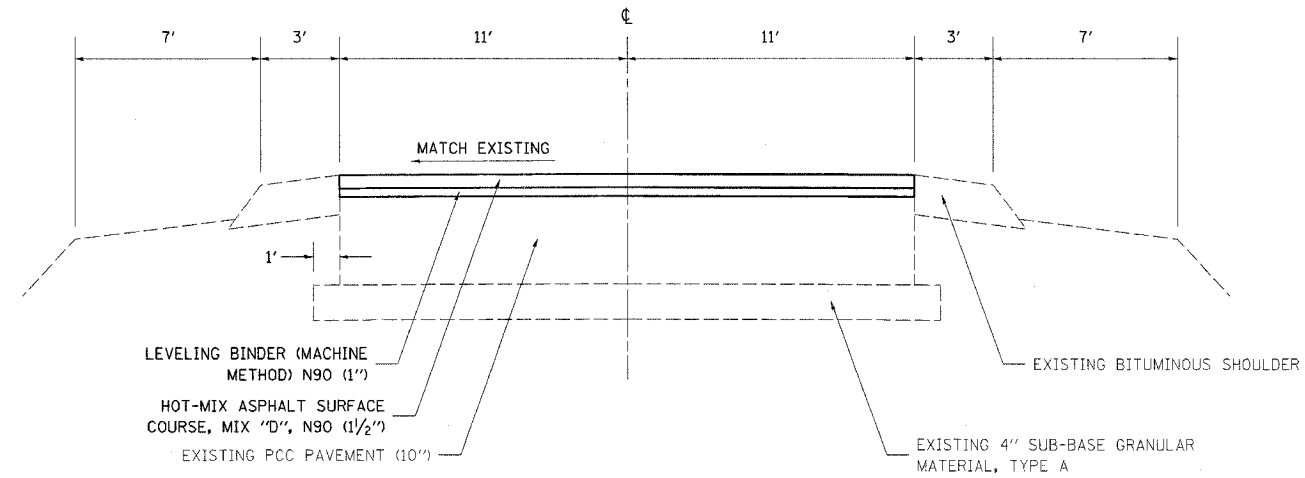

TYPICAL SECTION
STA 0+35 TO STA 0+85

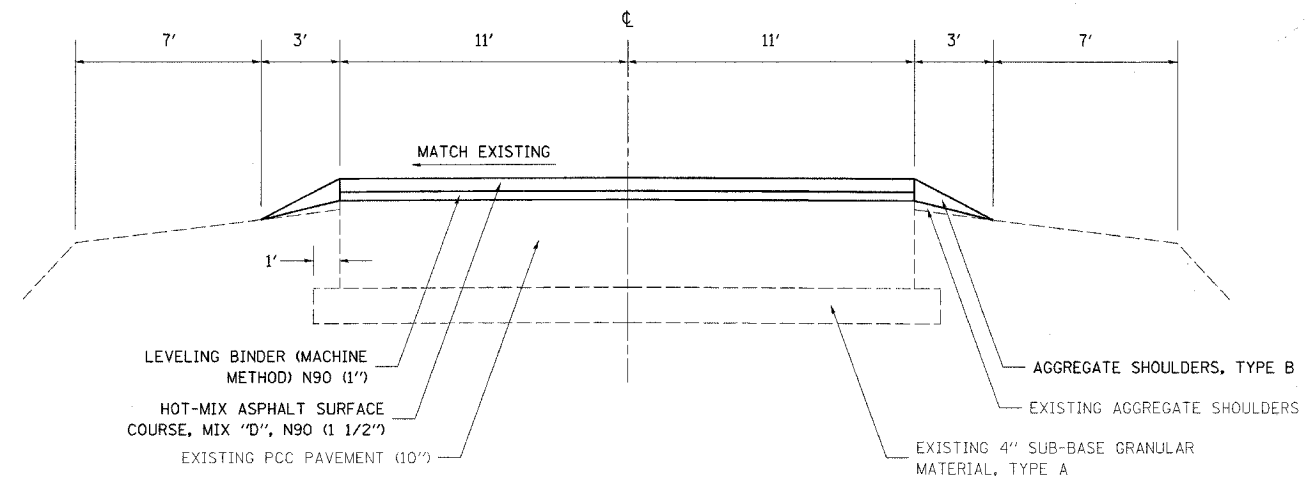

TYPICAL SECTION
STA 0+85 TO STA 2+48
STA 6+35 TO STA 20+50
STA 27+91 TO STA 45+08

PLOT DATE = #DATE#
FILE NAME = #FILE#
PLOT SCALE = #SCALE#
USER NAME = #USER#

REVISIONS	
NAME	DATE

ILLINOIS DEPARTMENT OF TRANSPORTATION

TYPICAL SECTIONS

SCALE: VERT.
HORIZ.
DATE

DRAWN BY
CHECKED BY

F.A.P. RTE.	SECTION	COUNTY	TOTAL SHEETS	SHEET NO.
328	*	WAYNE	19	5
STA.		TO STA.		
FED. ROAD DIST. NO.		ILLINOIS FED. AID PROJECT		

(24-2,24)RS-1

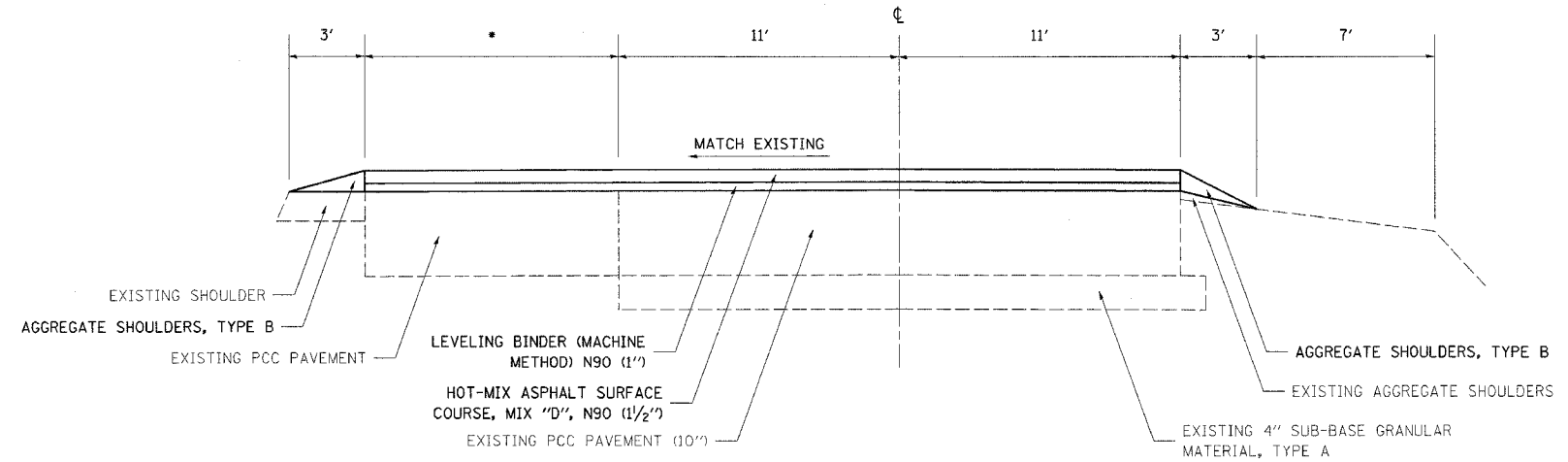

TYPICAL SECTION

STA 2+48 TO STA 6+35

- NOTE: STA 2+48 TO STA 3+80 •=0' -12'
- STA 3+80 TO STA 6+35 •=12'

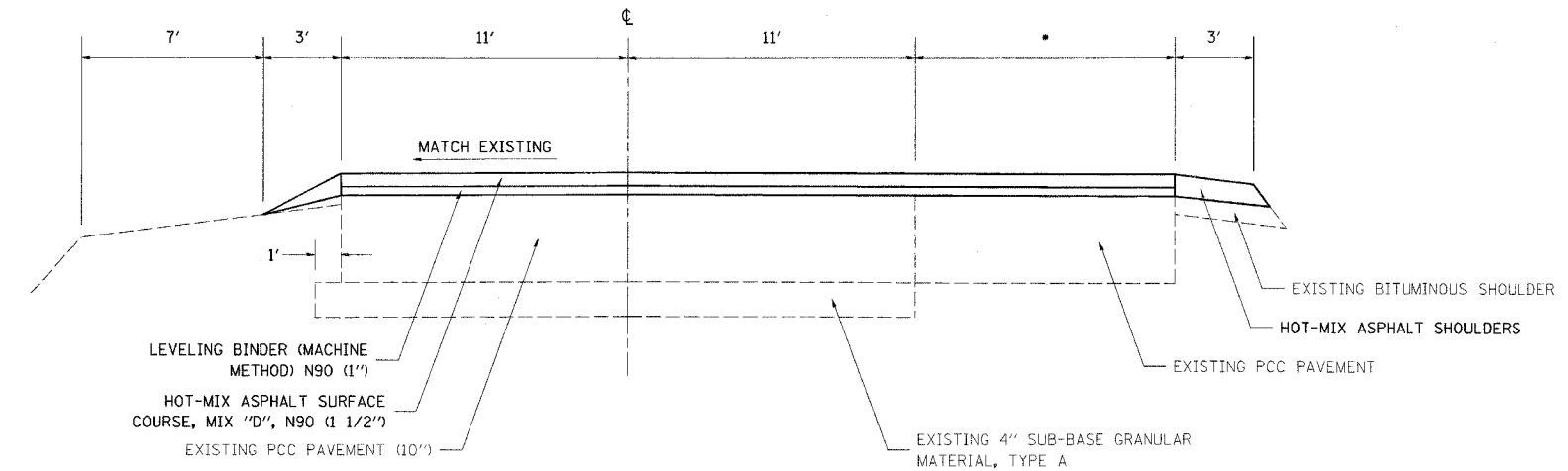

TYPICAL SECTION

STA 20+50 TO STA 27+91

- NOTE: STA 20+50 TO STA 23+04 •=0' -12'
- STA 23+04 TO STA 27+91 •=12'

PLOT DATE * DATE *
FILE NAME * FILEL *
USER NAME * USERN *

REVISIONS	
NAME	DATE

ILLINOIS DEPARTMENT OF TRANSPORTATION

TYPICAL SECTIONS

SCALE: VERT. DRAWN BY
HORIZ. CHECKED BY
DATE

F.A.P. RTE.	SECTION	COUNTY	TOTAL SHEETS	SHEET NO.
328	*	WAYNE	19	6
STA.		TO STA.		
FED. ROAD DIST. NO.	ILLINOIS	FED. AID PROJECT		

• (24-2.24)RS-1

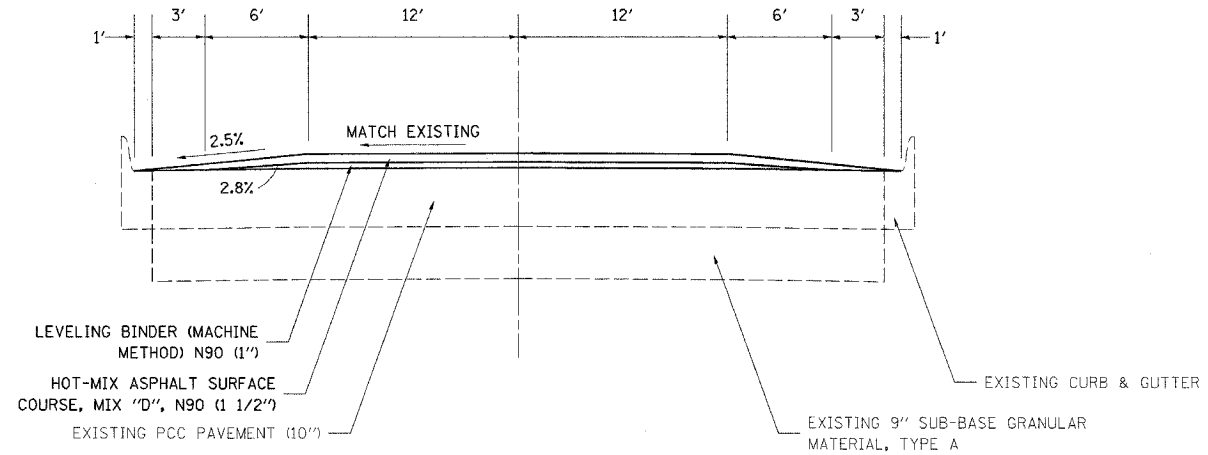

TYPICAL SECTION
STA 45+08 TO STA 85+98

PLOT DATE * DATE *
FILE NAME * FILEL *
SCALE * SCALE *
USER NAME * USERN

REVISIONS	
NAME	DATE

ILLINOIS DEPARTMENT OF TRANSPORTATION

TYPICAL SECTIONS

SCALE: VERT. DRAWN BY
 HORIZ. CHECKED BY
 DATE

F.A.P. RTE.	SECTION	COUNTY	TOTAL SHEETS	SHEET NO.
328		WAYNE	19	7
STA.		TO STA.		
FED. ROAD DIST. NO.		ILLINOIS	FED. AID PROJECT	
(24-2,24Z)RS-1				

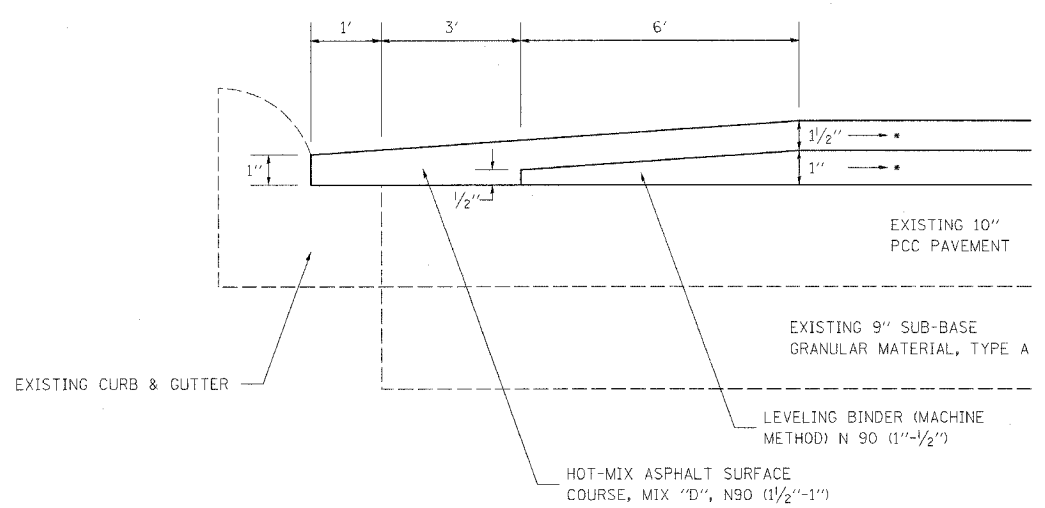

PARKING LANE DETAIL
 BOTH SIDES OF PAVEMENT
 STA 45+08 TO STA 85+98
 • CONSTANT THICKNESS TO CENTERLINE

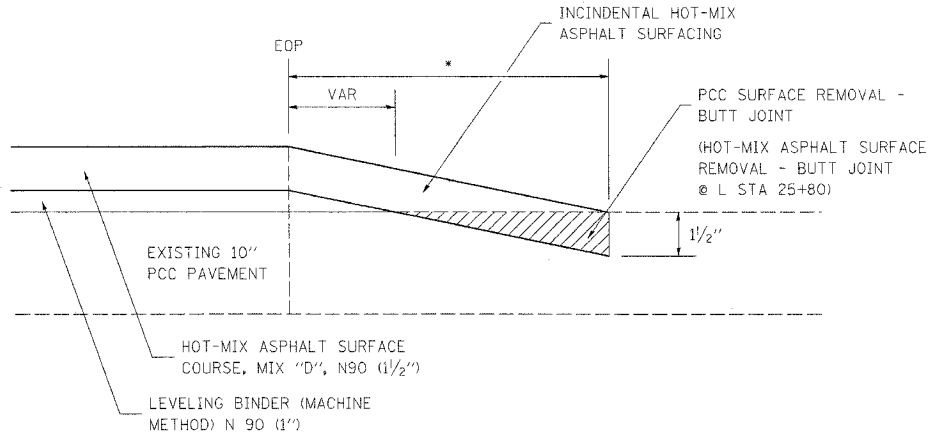

SIDE ROAD BUTT JOINT DETAIL

	PRA	* = (FT)
L STA	5+78	15.0
R STA	5+78	9.0
L STA	15+45	10.0
R STA	15+45	9.5
L STA	25+80	10.0
R STA	25+80	15.0
L STA	44+88	10.0
R STA	44+88	10.0

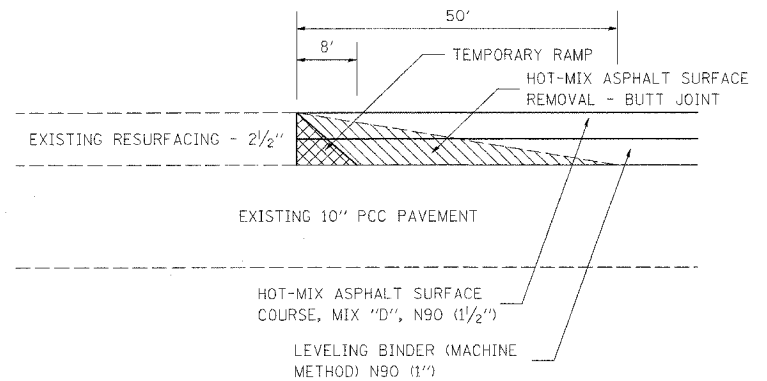

BUTT JOINT DETAIL
 STA 0+35 TO STA 0+85

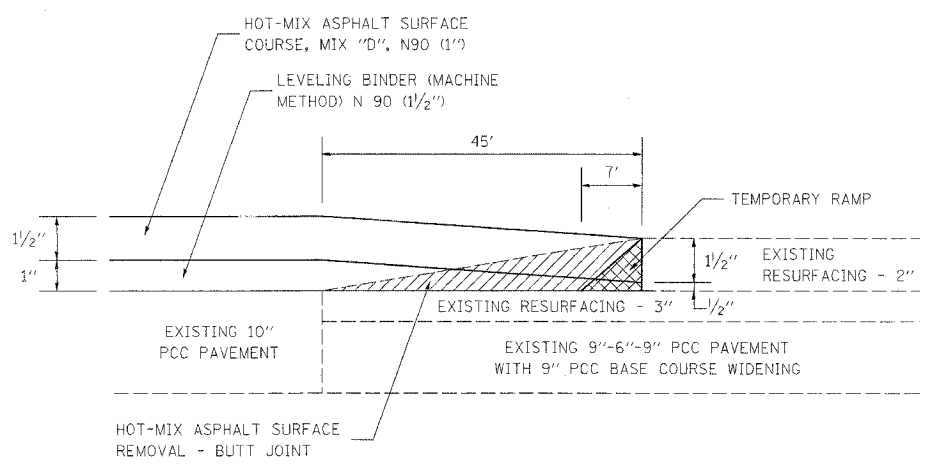

BUTT JOINT DETAIL
 STA 85+53 TO STA 85+98

PLOT DATE = #DATE#
 FILE NAME = #FILE#
 PLOT SCALE = #SCALE#
 USER NAME = #USER#

REVISIONS	
NAME	DATE

ILLINOIS DEPARTMENT OF TRANSPORTATION

BUTT JOINT DETAILS

SCALE: VERT. _____
 HORIZ. _____

DATE _____

DRAWN BY _____
 CHECKED BY _____

F.A.P. RTE.	SECTION	COUNTY	TOTAL SHEETS	SHEET NO.
328	*	WAYNE	19	8
STA.		TO STA.		
FED. ROAD DIST. NO.		ILLINOIS	FED. AID PROJECT	
(24-2.24Z)RS-1				

FRAMES & LIDS TO BE ADJUSTED

STATION	O/S CL	MAN HOLE	WATER VALVE	GAS VALVE
		EACH	EACH	EACH
58+56	21' RT	1		
66+70	5' LT		1	
66+91	3' RT	1		
69+99	2' LT	1		
70+54	3' RT			1
71+23	6' RT	1		
71+58	2' LT	1		
71+86	15' RT		1	
76+47	1' RT	1		
81+31	1' RT	1		
85+08	6' LT	1		
TOTALS:		8	2	1

PAVEMENT SCHEDULE

STATION TO STATION	LENGTH	AVERAGE PAVEMENT WIDTH	AREA	BITUMINOUS MATERIALS (PRIME COAT)	AGGREGATE (PRIME COAT)	LEVELING BINDER (MACHINE METHOD), N90	HOT-MIX ASPHALT SURFACE REMOVAL - BUTT JOINT	PCC SURFACE REMOVAL - BUTT JOINT	TEMPORARY RAMP	HOT-MIX ASPHALT SURFACE COURSE, MIX "D", N90	AGGREGATE SHOULDERS, TYPE B		HOT-MIX ASPHALT SHOULDERS
											TON	TON	
	LIN FT	FEET	SQ YD	GAL	TON	TON	SQ YD	SQ YD	SQ YD	TON	TON	TON	
0+35 TO 0+85	50	22.0	122	24.4	0.5	6.8	122.2		39.1	10.3			
0+85 TO 2+48	163	22.0	398	79.7	1.6	22.3				33.5	10.8		
2+48 TO 3+80	132	28.0	411	82.1	1.6	23.0				34.5	8.8		
3+80 TO 6+35	255	34.0	963	192.7	3.9	53.9		202.8		80.9	10.4		
6+35 TO 20+50	1415	22.0	3459	691.8	13.8	193.7		227.1		290.5	73.3		
20+50 TO 23+04	254	28.0	790	175.0	3.2	44.3				66.4	8.4	8.3	
23+04 TO 27+91	487	34.0	1840	400.4	8.0	103.0	69.4	249.2		154.5	7.2	15.9	
27+91 TO 45+08	1717	22.0	4197	839.4	17.9	235.0		102.2		352.6	82.6		
45+08 TO 85+98	4090	44.0	19996	3999.1	80.0	839.8	220.0		68.4	1552.4			
	8563			6485	130	1522	412	781	108	2576	202	24	

PAVEMENT MARKING SCHEDULE

STATION TO STATION	LENGTH	SHORT TERM PAVEMENT MARKING	WORK ZONE PAVEMENT MARKING REMOVAL	TEMP PAINT PAVT MARK LETTERS & SYMBOLS	TEMP PAINT PAVT MARK-LINE 4"	TEMP PAINT PAVT MARK-LINE 6"	TEMP PAINT PAVT MARK-LINE 8"	TEMP PAINT PAVT MARK-LINE 12"	TEMP PAINT PAVT MARK-LINE 24"	THERMOPLASTIC PAVT MARK LETTERS & SYMBOLS	THERMOPLASTIC PAVT MARK-LINE 4"	THERMOPLASTIC PAVT MARK-LINE 6"	THERMOPLASTIC PAVT MARK-LINE 8"	THERMOPLASTIC PAVT MARK-LINE 12"	THERMOPLASTIC PAVT MARK-LINE 24"	RAISED REFLECTIVE PAVEMENT MARKER	RAISED REFLECTIVE PAVEMENT MARKER REMOVAL
																EACH	EACH
	LIN FT	FOOT	SQ FT	SQ FT	FOOT	FOOT	FOOT	FOOT	FOOT	SQ FT	FOOT	FOOT	FOOT	FOOT	FOOT	EACH	EACH
0+35 TO 3+80	345	69.0	11.5		690.0	86.3					690.0	86.3				4	4
3+80 TO 5+30	150	30.0	5.0	46.8	300.0	187.5				46.8	300.0	187.5				7	7
5+30 TO 23+04	1774	354.8	59.1		3117.0	443.5				12.0	3117.0	443.5				22	22
23+04 TO 25+26	222	44.4	7.4	62.4	444.0	277.5				34.0	444.0	277.5				10	10
25+26 TO 45+08	1982	396.4	66.1		3595.0	495.5	112.0	65.0		28.0	3595.0	495.5	112.0	65.0		25	25
45+08 TO 84+00	3892	778.4	129.7			973.0						973.0				49	49
84+00 TO 84+56	56	11.2	1.9	31.2		70.0				34.0		70.0				4	4
84+56 TO 85+98	142	28.4	4.7			211.5						211.5				2	2
	8563	1713	285	140	8146	2745	112	65	142	140	8146	2745	112	65	142	122	122

PLOT DATE = #DATE*
 FILE NAME = #FILE#*
 PLOT SCALE = #SCALE*
 USER NAME = #USER#

REVISIONS	
NAME	DATE

ILLINOIS DEPARTMENT OF TRANSPORTATION

SCHEDULE OF QUANTITIES

SCALE: VERT. _____
 HORIZ. _____
 DATE _____

DRAWN BY _____
 CHECKED BY _____

F.A.P. RTE.	SECTION	COUNTY	TOTAL SHEETS	SHEET NO.
328		WAYNE	19	9
STA.		TO STA.		
FED. ROAD DIST. NO.	ILLINOIS	FED. AID PROJECT		
(24-2,24Z)RS-1				

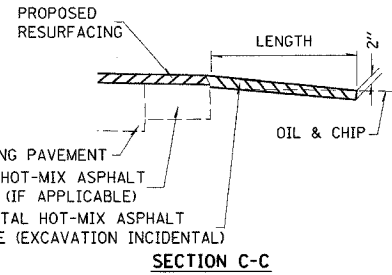
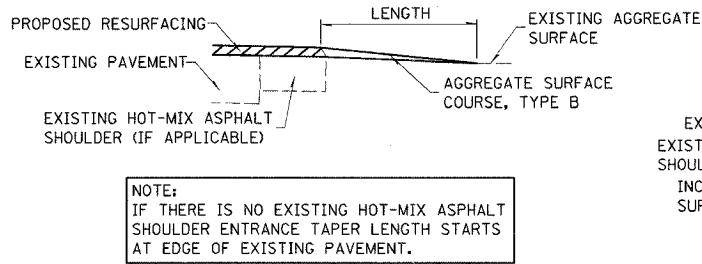
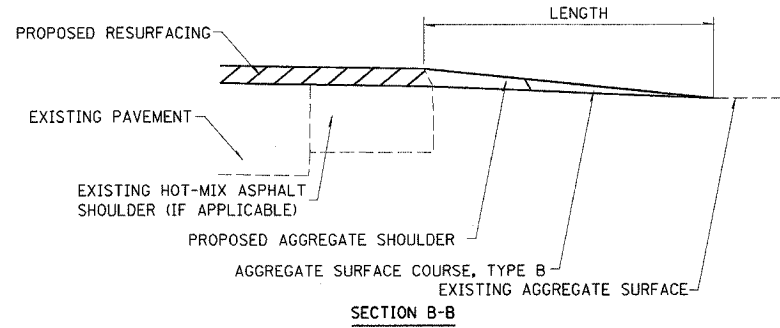
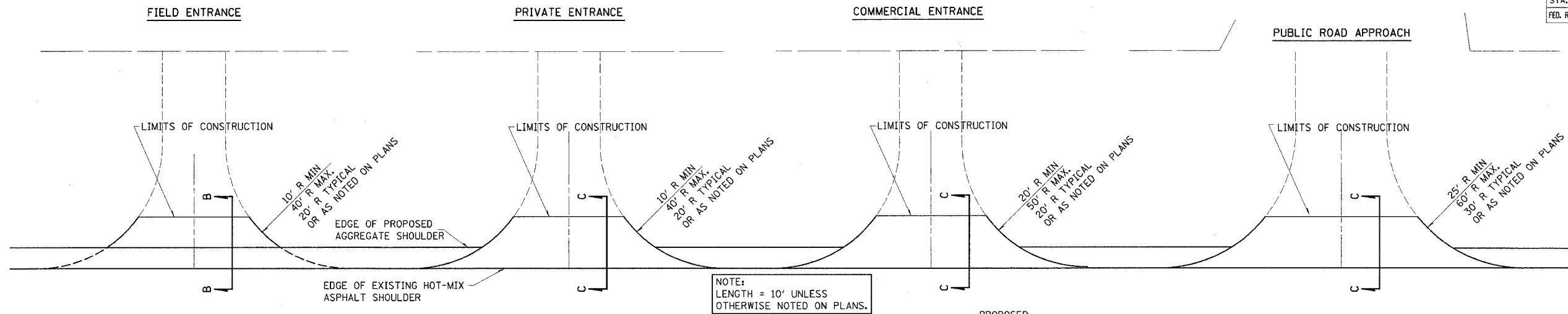

SEE SIDE ROAD BUTT JOINT DETAIL ON SHEET 7.

NOTE: IF THERE IS NO EXISTING HOT-MIX ASPHALT SHOULDER ENTRANCE TAPER LENGTH STARTS AT EDGE OF EXISTING PAVEMENT.

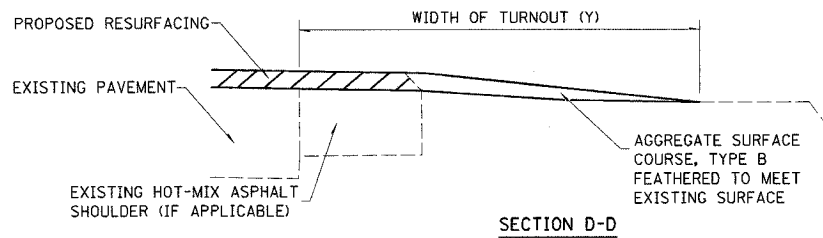

TYPICAL SECTION AT MAILBOX TURNOUT
NOTE: SEE STANDARD 406201 FOR MAILBOX TURNOUT DETAILS

SIDE	STATION	TYPE	INCIDENTAL HOT-MIX ASPHALT SURFACING*		AGGREGATE SURFACE COURSE, TYPE B
			TON	TON	
LT	5+78	PRA	15.2		
RT	5+78	PRA	7.9		
RT	6+96	CE		5.9	
RT	8+60	CE	4.1		
RT	9+90	CE	3.9		
RT	11+59	CE		5.2	
LT	15+45	PRA	6.3		
RT	15+45	PRA	19.5		
LT	19+82	PE		7.2	
RT	20+00	CE		7.6	
LT	25+80	PRA	7.9		
RT	25+80	PRA	28.4		
LT	29+42	CE		4.1	
LT	31+30	PE		2.4	
LT	31+78	CE	3.8		
RT	31+78	CE	3.8		
LT	33+98	CE	5.0		
RT	33+98	CE	5.0		
RT	35+91	PE	5.6		
LT	36+30	CE		6.8	
RT	39+85	CE	6.9		
LT	40+91	CE		5.8	
RT	40+91	CE	5.8		
RT	41+79	CE	3.6		
LT	42+44	CE	7.5		
RT	42+88	CE	5.5		
LT	44+88	PRA	5.9		
RT	44+88	PRA	5.7		

FE - FIELD ENTRANCE PRA - PUBLIC ROAD APPROACH
PE - PRIVATE ENTRANCE MBT - MAILBOX TURNOUT
CE - COMMERCIAL ENTRANCE

*BITUMINOUS MATERIALS AND AGGREGATE (PRIME COAT) FOR ENTRANCES AND PUBLIC ROAD APPROACHES SHALL BE CONSIDERED INCIDENTAL TO INCIDENTAL HOT-MIX ASPHALT SURFACING.

ISSUED: 08-03-99
MODIFIED: 03-13-07

F.A.P. RTE.	SECTION	COUNTY	TOTAL SHEETS	SHEET NO.
328	*	WAYNE	19	10
STA.		TO STA.		
FED. ROAD DIST. NO.		ILLINOIS	FED. AID PROJECT	

• (24-2,24Z)RS-1

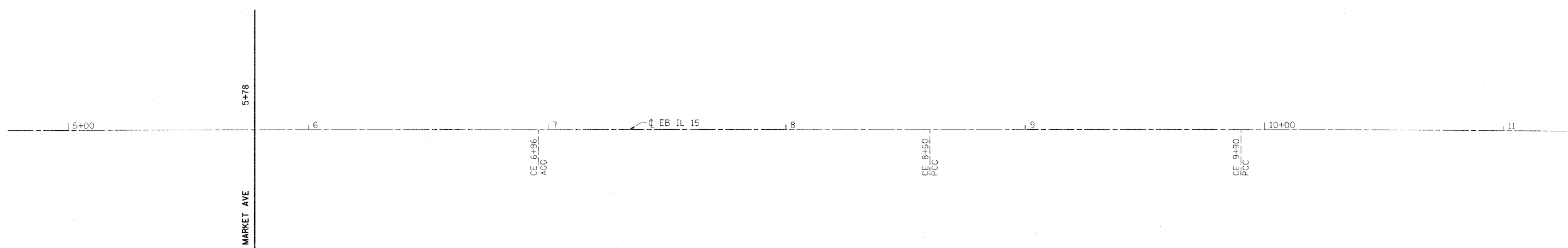
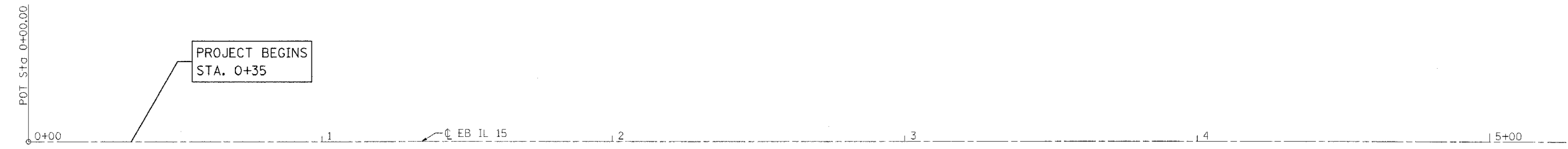

PLOT DATE = #DATE#
 FILE NAME = #FILE#
 PLOT SCALE = #SCALE#
 USER NAME = #USER#

REVISIONS	
NAME	DATE

ILLINOIS DEPARTMENT OF TRANSPORTATION

PLAN SHEET
STA 0+35 TO STA 11+00

SCALE: VERT. _____
 HORIZ. _____

DATE _____ DRAWN BY _____
 CHECKED BY _____

F.A.P. RTE.	SECTION	COUNTY	TOTAL SHEETS	SHEET NO.
328	*	WAYNE	19	11
STA.		TO STA.		
FED. ROAD DIST. NO.	ILLINOIS	FED. AID PROJECT		

• (24-2,24Z)RS-1

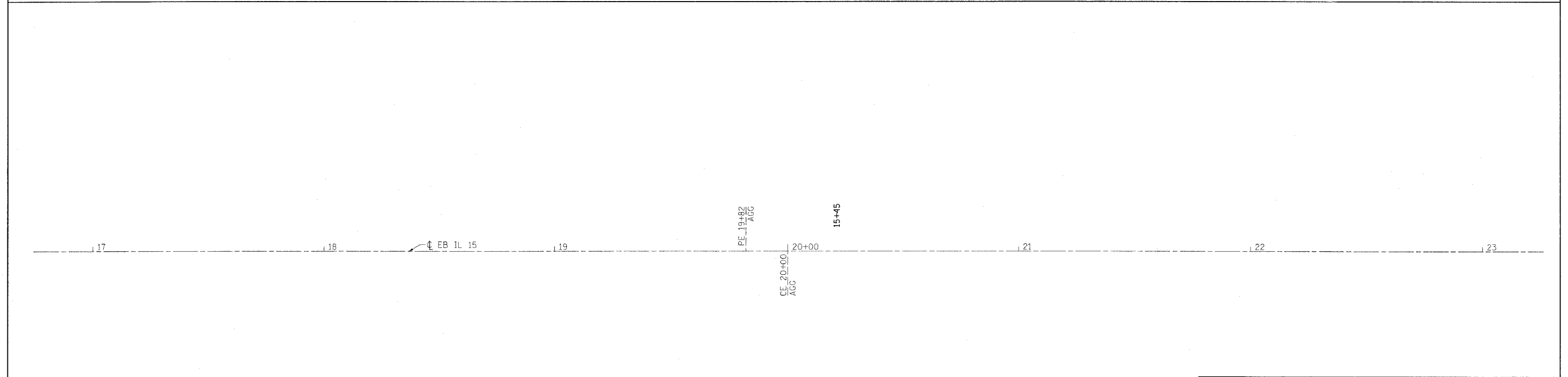
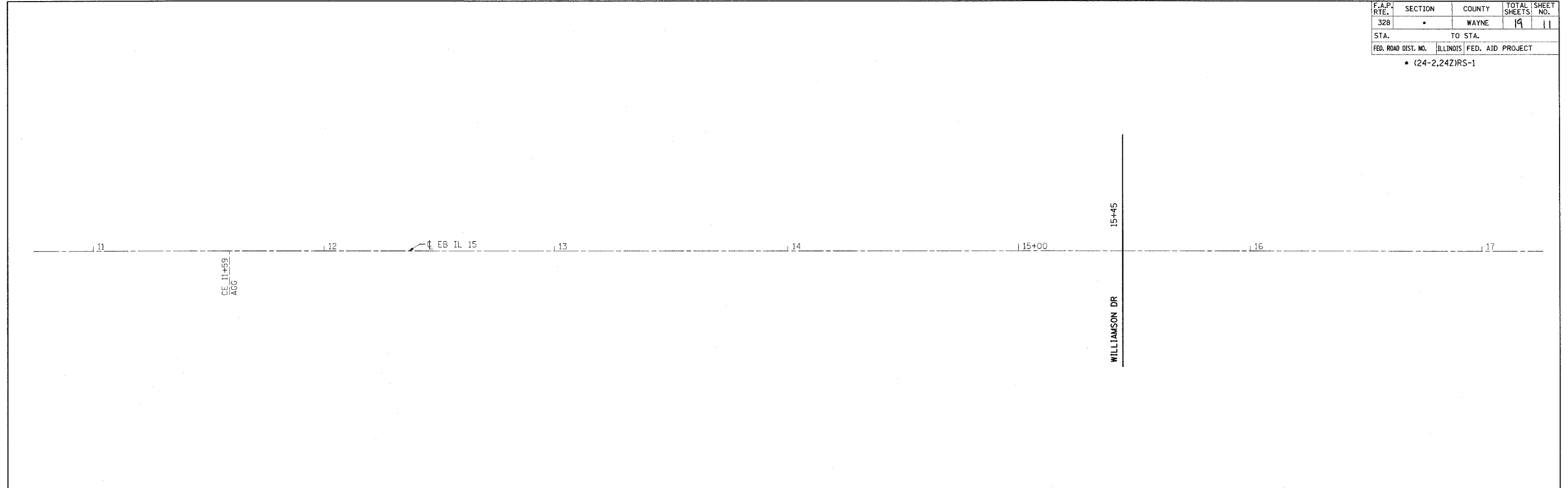

PLOT DATE = *DATE*
 FILE NAME = #FILE#
 USER NAME = #USER#

REVISIONS	
NAME	DATE

ILLINOIS DEPARTMENT OF TRANSPORTATION

PLAN SHEET
STA 11+00 TO STA 23+00

SCALE: VERT. _____
 HORIZ. _____

DATE _____ DRAWN BY _____
 CHECKED BY _____

F.A.P. RTE.	SECTION	COUNTY	TOTAL SHEETS	SHEET NO.
328	•	WAYNE	19	12

STA.		TO STA.	
FED. ROAD DIST. NO.	ILLINOIS	FED. AID PROJECT	
• (24-2,24Z)RS-1			

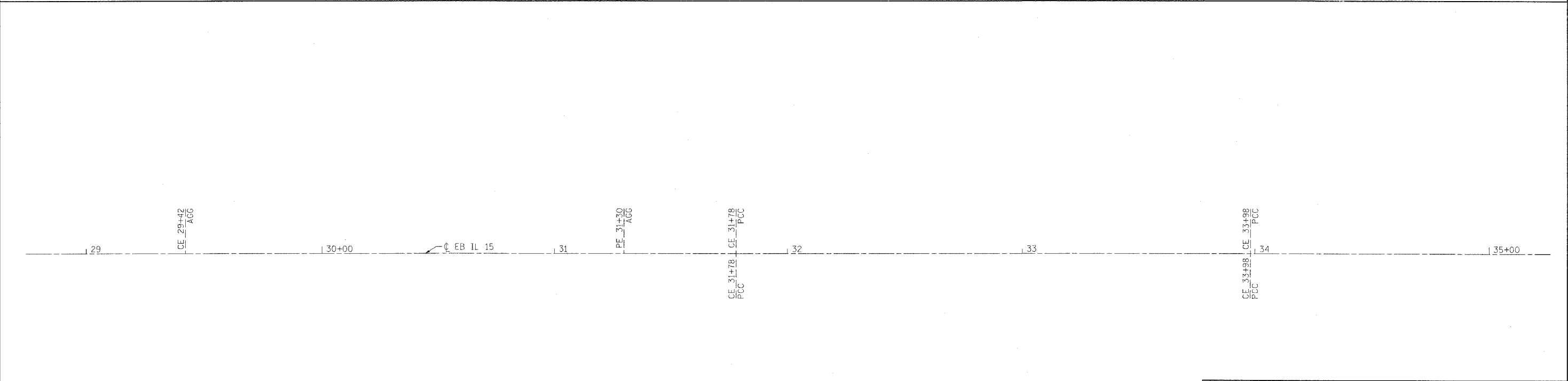
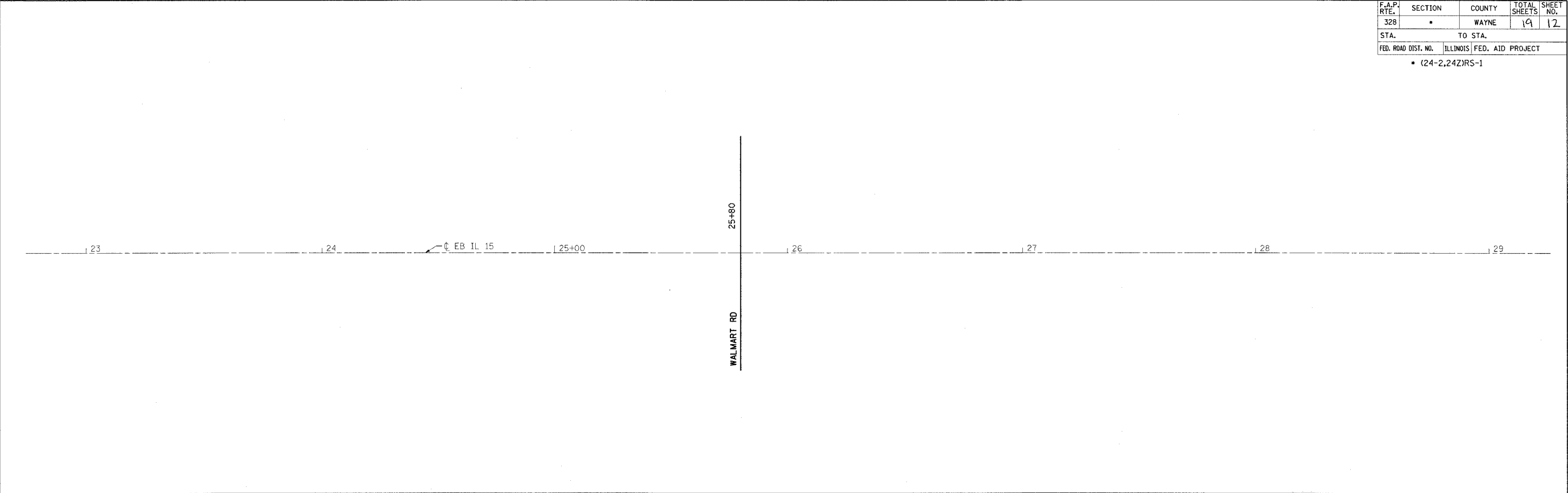

PLOT DATE = *DATE*
 FILE NAME = *FILE*
 PLOT SCALE = *SCALE*
 USER NAME = *USER*

REVISIONS	
NAME	DATE

ILLINOIS DEPARTMENT OF TRANSPORTATION

PLAN SHEET
STA 23+00 TO STA 35+00

SCALE: VERT. _____
 HORIZ. _____

DATE _____ DRAWN BY _____
 CHECKED BY _____

F.A.P. RTE.	SECTION	COUNTY	TOTAL SHEETS	SHEET NO.
328	*	WAYNE	19	13
STA.		TO STA.		
FED. ROAD DIST. NO.		ILLINOIS FED. AID PROJECT		
* (24-2,24)RS-1				

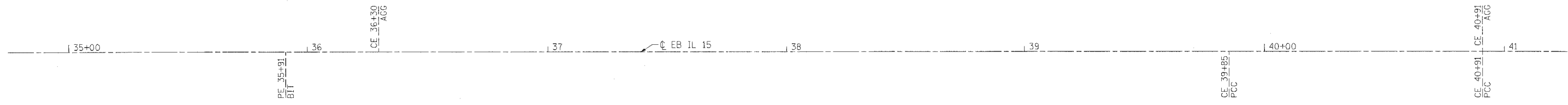

PLOT DATE = #DATE#
 FILE NAME = #FILE#
 PLOT SCALE = #SCALE#
 USER NAME = #USER#

REVISIONS	
NAME	DATE

ILLINOIS DEPARTMENT OF TRANSPORTATION

PLAN SHEET
STA 35+00 TO STA 47+00

SCALE: VERT. _____
 HORIZ. _____

DATE _____ DRAWN BY _____
 CHECKED BY _____

F.A.P. RTE.	SECTION	COUNTY	TOTAL SHEETS	SHEET NO.
328	•	WAYNE	19	14
STA.		TO STA.		
FED. ROAD DIST. NO.		ILLINOIS FED. AID PROJECT		
• (24-2,24Z)RS-1				

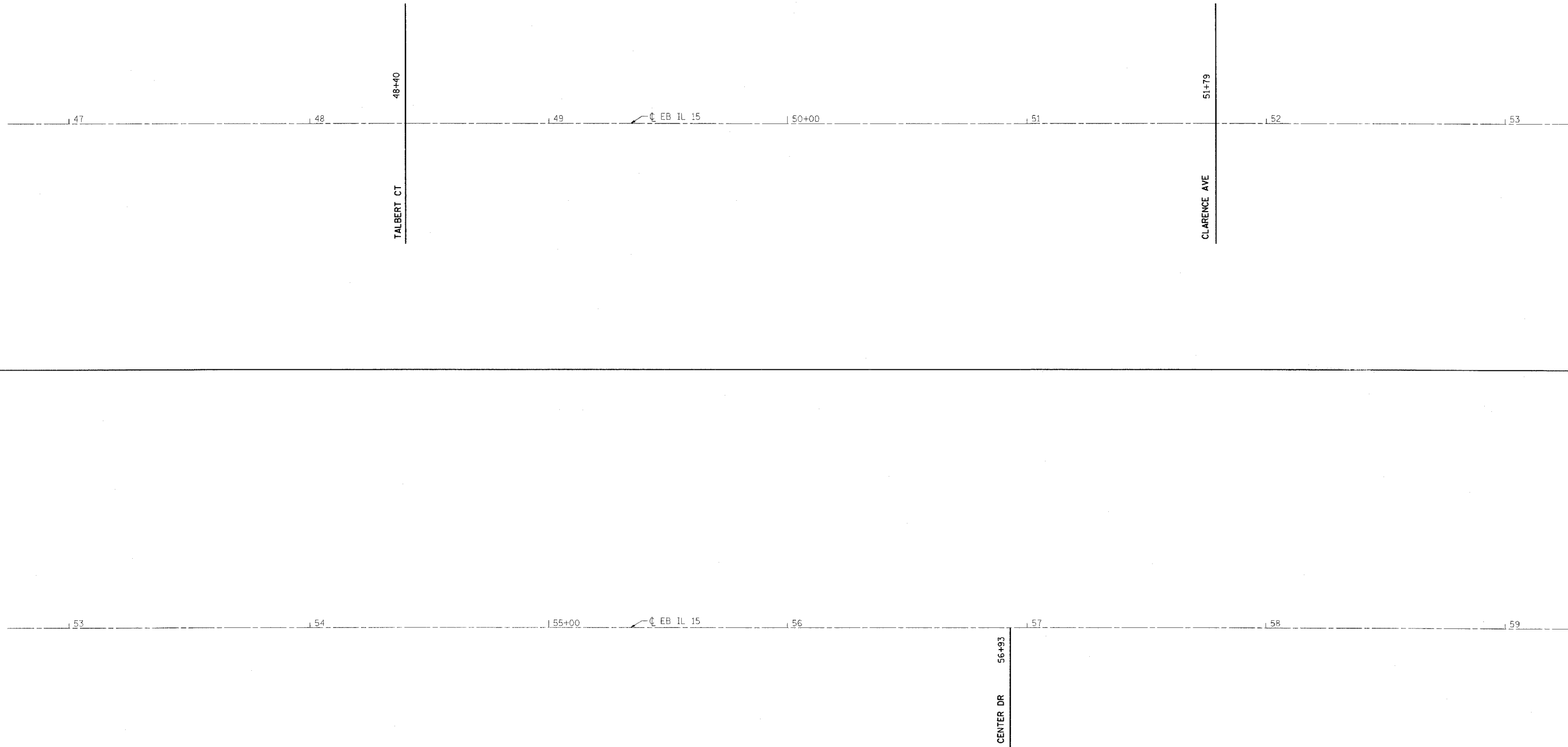

PLOT DATE = #DATE#
 FILE NAME = #FILE#
 PLOT SCALE = #SCALE#
 USER NAME = #USER#

REVISIONS	
NAME	DATE

ILLINOIS DEPARTMENT OF TRANSPORTATION

PLAN SHEET
STA 47+00 TO STA 59+00

SCALE: VERT. _____
 HORIZ. _____

DATE _____ DRAWN BY _____
 CHECKED BY _____

F.A.P. RTE.	SECTION	COUNTY	TOTAL SHEETS	SHEET NO.
328	*	WAYNE	19	15
STA.		TO STA.		
FED. ROAD DIST. NO.	ILLINOIS	FED. AID PROJECT		
• (24-2,24)RS-1				

59 60+00 EB IL 15 61 62 63 64 65+00

WINDSOR LANE 60+13

12TH 63+37

65+00 66 EB IL 15 67 68 69 70+00 71

11TH 67+73

11TH 68+17

PLOT DATE = #DATE#
 FILE NAME = #FILE#
 PLOT SCALE = #SCALE#
 USER NAME = #USER#

REVISIONS	
NAME	DATE

ILLINOIS DEPARTMENT OF TRANSPORTATION

PLAN SHEET
STA 59+00 TO STA 71+00

SCALE: VERT. _____
 HORIZ. _____

DATE _____ DRAWN BY _____
 CHECKED BY _____

F.A.P. RTE.	SECTION	COUNTY	TOTAL SHEETS	SHEET NO.
328	*	WAYNE	19	16
STA.		TO STA.		
FED. ROAD DIST. NO.		ILLINOIS	FED. AID PROJECT	
• (24-2,24Z)RS-1				

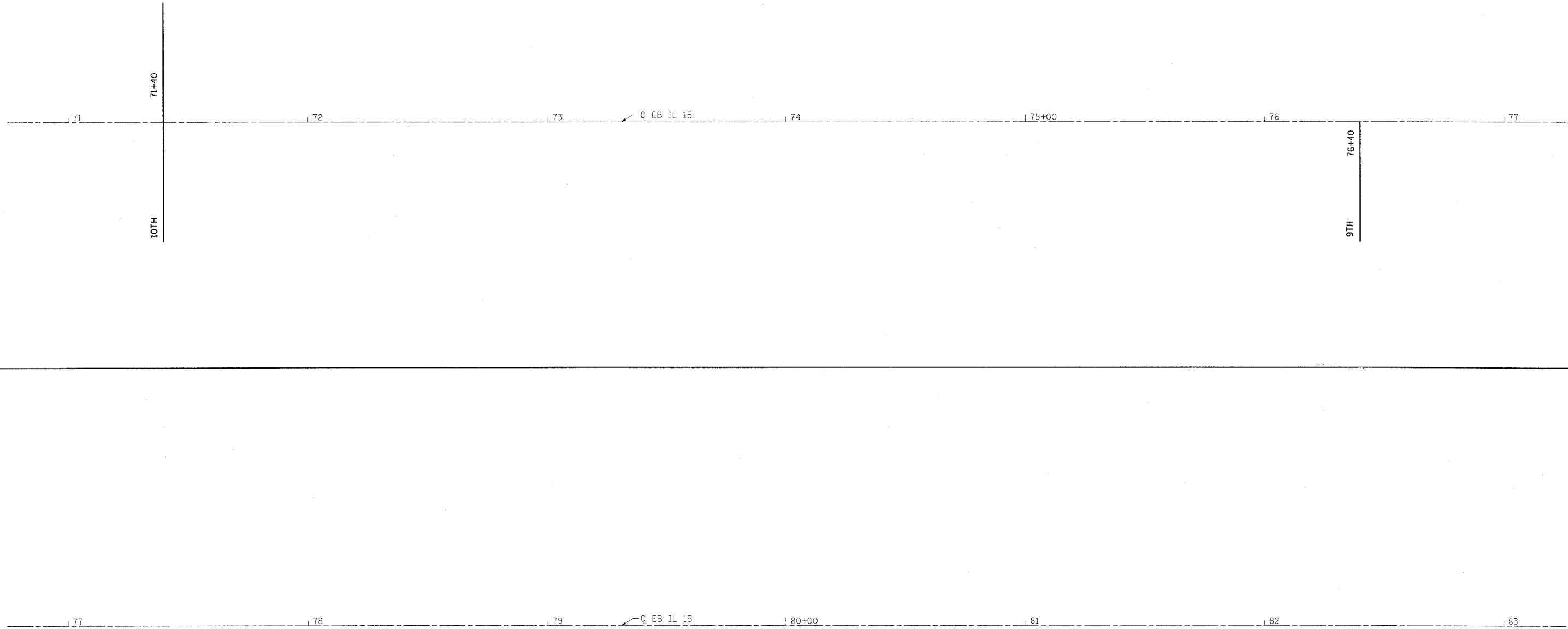

PLOT DATE = #DATE#
 FILE NAME = #FILE#
 PLOT SCALE = #SCALE#
 USER NAME = #USER#

REVISIONS	
NAME	DATE

ILLINOIS DEPARTMENT OF TRANSPORTATION

PLAN SHEET
STA 71+00 TO STA 83+00

SCALE: VERT. _____
 HORIZ. _____

DATE _____ DRAWN BY _____
 CHECKED BY _____

F.A.P. RTE.	SECTION	COUNTY	TOTAL SHEETS	SHEET NO.
328	*	WAYNE	19	17

STA.	TO STA.
FED. ROAD DIST. NO.	ILLINOIS FED. AID PROJECT
• (24-2,24Z)RS-1	

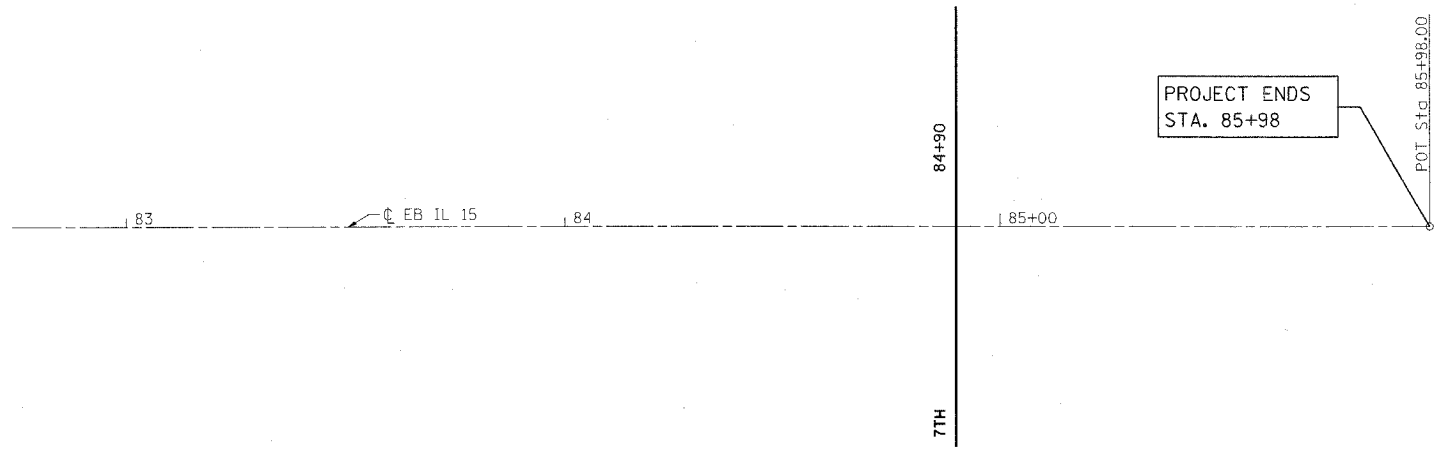

PLOT DATE = *DATE*
 FILE NAME = *FILEL*
 USER NAME = *USER*

REVISIONS	
NAME	DATE

ILLINOIS DEPARTMENT OF TRANSPORTATION

PLAN SHEET
STA 83+00 TO STA 85+98

SCALE: VERT. _____
 HORIZ. _____

DATE _____ DRAWN BY _____
 CHECKED BY _____

F.A.P. RTE.	SECTION	COUNTY	TOTAL SHEETS	SHEET NO.
328		WAYNE	19	18

STA.	TO STA.
FED. ROAD DIST. NO.	ILLINOIS FED. AID PROJECT

• (24-2,24Z)RS-1

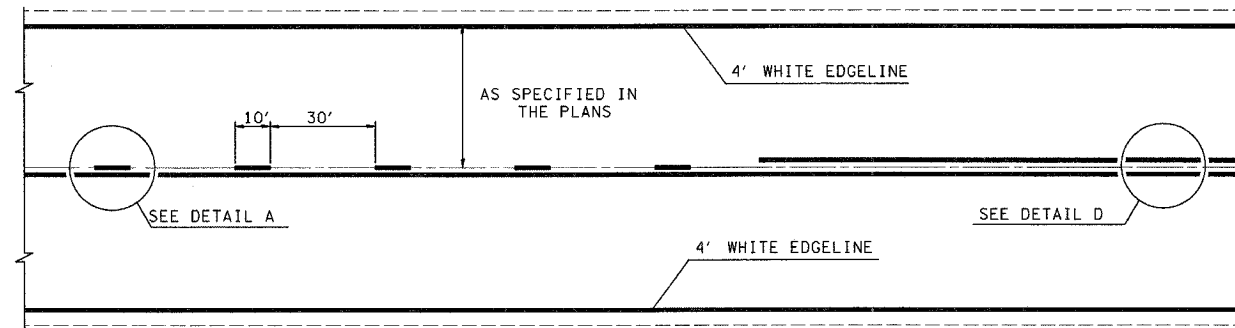

TYPICAL CENTERLINE, NO PASSING ZONE LINE (NPZ) & EDGELINE MARKINGS
2-LANE PAVEMENT

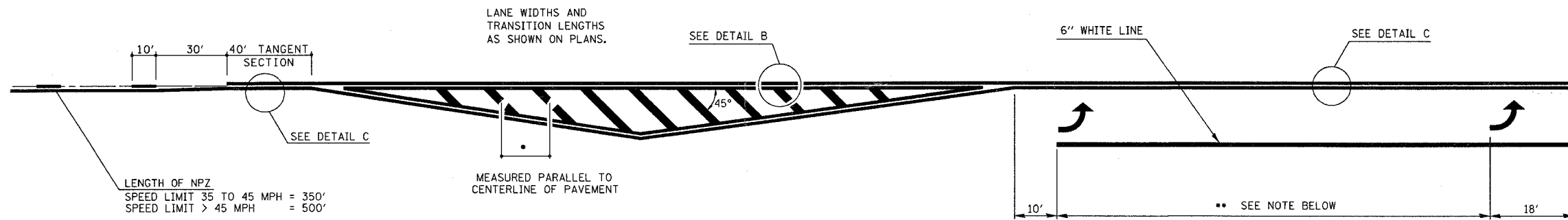

LENGTH OF NPZ
SPEED LIMIT 35 TO 45 MPH = 350'
SPEED LIMIT > 45 MPH = 500'

•DIAGONAL SPACING

SPEED LIMIT	< 30 MPH	= 15'
SPEED LIMIT	30 TO 45 MPH	= 20'
SPEED LIMIT	> 45 MPH	= 30'

** PLACE THE FIRST ARROW EVEN WITH THE BEGINNING OF THE TURN BAY.
PLACE ANOTHER ARROW 18' BACK FROM THE STOP BAR, IF REQUIRED,
ADD ADDITIONAL ARROWS TO MAINTAIN A MAXIMUM OF 80' SPACING.

NOTES:

1. OMIT EDGELINE THRU SIDE ROADS.
2. TAPER RATES, LANE WIDTHS, AND STORAGE LENGTHS AS SHOWN ON THE PLANS.
3. WHEN MEDIANS ARE PRESENT, PLACE A SINGLE YELLOW STRIPE AROUND ITS PERIMETER.

DETAIL A

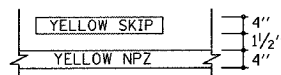

DETAIL B

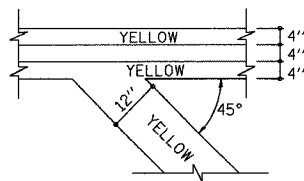

DETAIL C

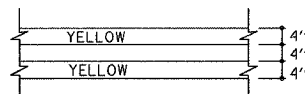

DETAIL D

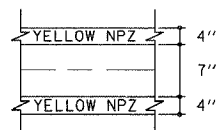

REVISIONS	
NAME	DATE
MMO	12-99
DRM	08-04

NOT TO SCALE

ILLINOIS DEPARTMENT OF TRANSPORTATION
TYPICAL APPLICATION OF PAVEMENT MARKINGS
SHEET 1 OF 2

SCALE: VERT. HORIZ.
DATE

DRAWN BY
CHECKED BY

1 2 3 4 5 6 7 8 9 \$\$\$DATE\$\$\$
10 11 12 13 14 15 16 17 18 *DGN-SPEC*
19 20 21 22 23 24 25 26 27 *MMO REV: 05-06-96
28 29 30 31 32 33 34 35
36 37 38 39 40 41 42 43 44 45
46 47 48 49 50 51 52 53 54
55 56 57 58 59 60 61 62 63
EPMD

PLOT DATE = #DATE#
FILE NAME = #FILE#
USER NAME = #USER#

F.A.P. RTE.	SECTION	COUNTY	TOTAL SHEETS	SHEET NO.
328	*	WAYNE	19	19
STA.		TO STA.		
FED. ROAD DIST. NO.	ILLINOIS	FED. AID PROJECT		

(24-2,24Z)RS-1

1 2 3 4 5 6 7 8 9 \$\$\$DATE\$\$
 10 11 12 13 14 15 16 17 18 *DGN-SPEC*
 19 20 21 22 23 24 25 26 27 *MMO REV: 05-06-96
 28 29 30 31 32 33 34 35 36 EPMD1
 37 38 39 40 41 42 43 44 45
 46 47 48 49 50 51 52 53 54
 55 56 57 58 59 60 61 62 63

** PLACE THE FIRST ARROW EVEN WITH THE BEGINNING OF THE TURN BAY.
 PLACE ANOTHER ARROW 18' BACK FROM THE STOP BAR, IF REQUIRED.
 ADD ADDITIONAL ARROWS TO MAINTAIN A MAXIMUM OF 80' SPACING.

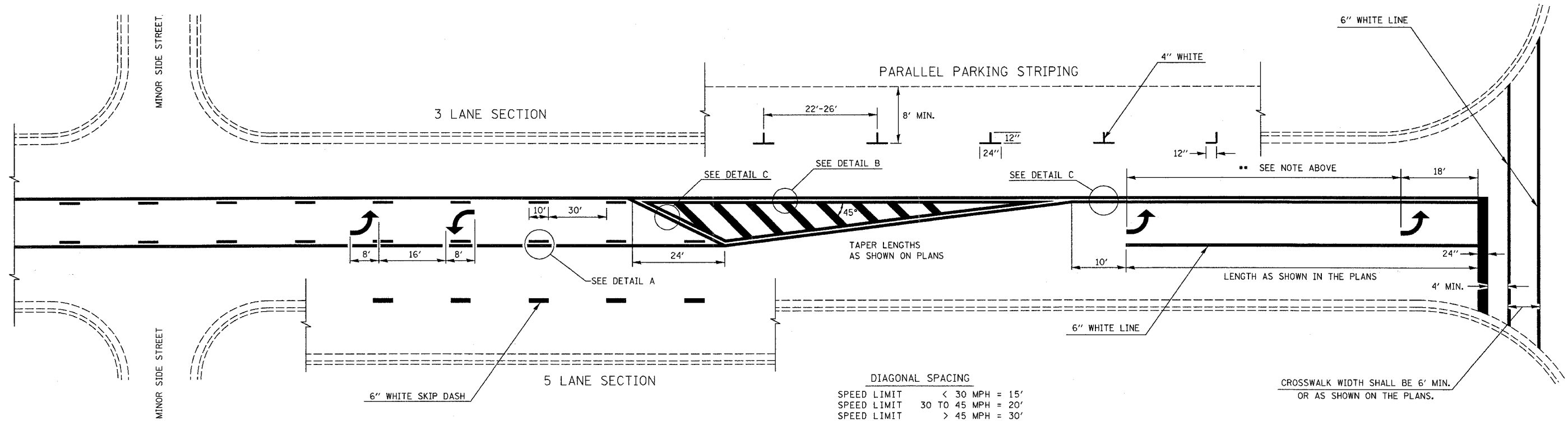

DIAGONAL SPACING

SPEED LIMIT	< 30 MPH	= 15'
SPEED LIMIT	30 TO 45 MPH	= 20'
SPEED LIMIT	> 45 MPH	= 30'

TYPICAL BI-DIRECTIONAL TURN LANE MARKINGS
 (SHOWING TRANSITION TO EXCLUSIVE LEFT TURN LANE)

- NOTES:
1. NO LESS THAN 2 ARROWS SHALL BE USED.
 2. TAPER RATES, LANE WIDTHS, AND STORAGE LENGTHS AS SHOWN ON THE PLANS.
 3. AVOID PLACING BI-DIRECTIONAL ARROWS IN INTERSECTIONS.
 4. BI-DIRECTIONAL ARROWS SHALL BE SPACED A MAXIMUM OF 250'.

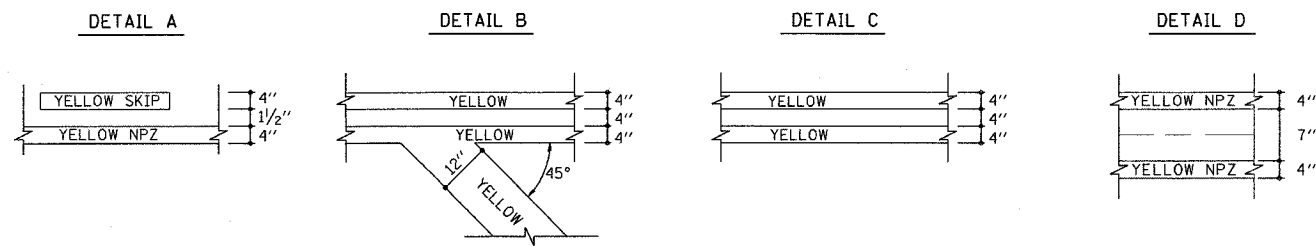

REVISIONS

NAME	DATE
MMO	12-99
DRM	08-04

NOT TO SCALE

ILLINOIS DEPARTMENT OF TRANSPORTATION

TYPICAL APPLICATION OF PAVEMENT MARKINGS

SHEET 2 OF 2

SCALE: VERT. HORIZ.
 DATE

DRAWN BY
 CHECKED BY

PLOT DATE * DATE *
 FILE NAME * FILE *
 USER NAME * USER *