

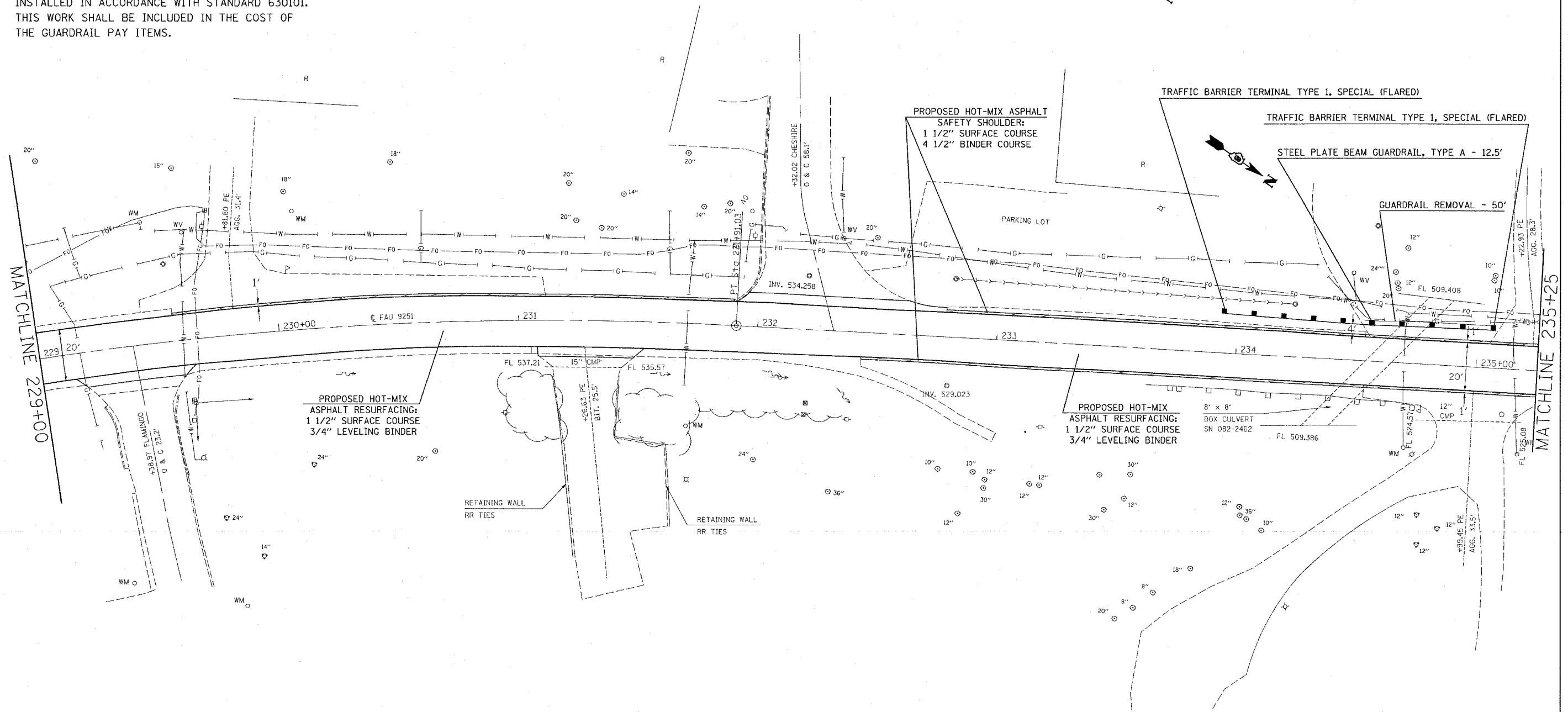

F.A.U. RTE.	SECTION	COUNTY	TOTAL SHEETS	SHEET NO.
9251	28-3RS-1	ST CLAIR	21	11
STA. 229+00		TO STA. 235+25		
FED. ROAD DIST. NO.	ILLINOIS	FED. AID PROJECT		

NOTES:

THE PROPOSED GUARDRAIL SHALL BE ERECTED 4' FROM THE PROPOSED SAFETY SHOULDER.

SHOULD THE EXISTING BOX CULVERT OBSTRUCT INSTALLATION OF THE PROPOSED GUARDRAIL, THE PORTION OF GUARDRAIL AFFECTED SHALL BE INSTALLED IN ACCORDANCE WITH STANDARD 630101. THIS WORK SHALL BE INCLUDED IN THE COST OF THE GUARDRAIL PAY ITEMS.



 EARTH EXCAVATION (FOR PLACEMENT OF SAFETY SHOULDER)

REVISIONS	
NAME	DATE

ILLINOIS DEPARTMENT OF TRANSPORTATION  
**PLAN VIEW**  
 FAU 9251  
 SECTION 28-3RS-1  
 ST CLAIR COUNTY

SCALE: VERT. \_\_\_\_\_  
 HORIZ. \_\_\_\_\_  
 DATE \_\_\_\_\_

DRAWN BY \_\_\_\_\_  
 CHECKED BY \_\_\_\_\_

PLOT DATE = 3/13/2007  
 FILE NAME = c:\pms\jess\w\86807\plan\plan066807.dgn  
 PLOT SCALE = 1"=40'  
 REFERENCE = REF