

F.A.U. RTE.	SECTION	COUNTY	TOTAL SHEETS	SHEET NO.
9251	28-3RS-1	ST CLAIR	21	13
STA. 1241+00		TO STA. 1245+73.9		
FED. ROAD DIST. NO.		ILLINOIS FED. AID PROJECT		

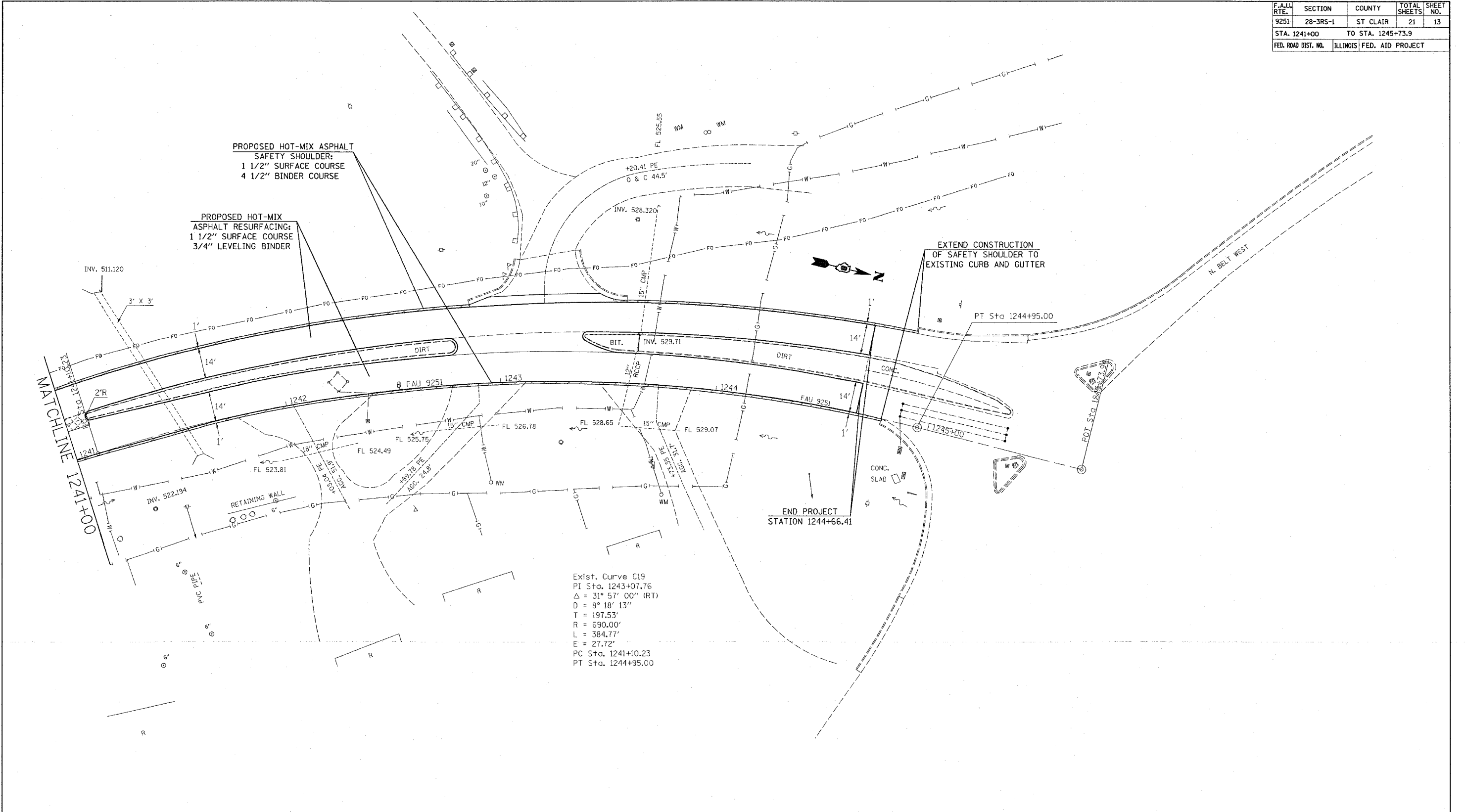

PROPOSED HOT-MIX ASPHALT
SAFETY SHOULDER:
1 1/2" SURFACE COURSE
4 1/2" BINDER COURSE

PROPOSED HOT-MIX
ASPHALT RESURFACING:
1 1/2" SURFACE COURSE
3/4" LEVELING BINDER

EXTEND CONSTRUCTION
OF SAFETY SHOULDER TO
EXISTING CURB AND GUTTER

END PROJECT
STATION 1244+66.41

Exist. Curve C19
PI Sta. 1243+07.76
 $\Delta = 31^\circ 57' 00''$ (RT)
D = 8' 18' 13"
T = 197.53'
R = 690.00'
L = 384.77'
E = 27.72'
PC Sta. 1241+10.23
PT Sta. 1244+95.00

EARTH EXCAVATION (FOR PLACEMENT OF SAFETY SHOULDER)

REVISIONS	
NAME	DATE

ILLINOIS DEPARTMENT OF TRANSPORTATION
PLAN VIEW
FAU 9251
SECTION 28-3RS-1
ST CLAIR COUNTY

SCALE: VERT. DRAWN BY
 HORIZ. CHECKED BY
DATE

PLOT DATE = 3/13/2007
FILE NAME = c:\projects\ed9587\plan\p1_065697.dgn
PLOT SCALE = 28.0000 / 1 IN.
REFERENCE = #REF#