

F.A.U. RTE.	SECTION	COUNTY	TOTAL SHEETS	SHEET NO.
9251	28-3RS-1	ST CLAIR	21	17
STA. 217+75		TO STA. 223+75		
FED. ROAD DIST. NO.		ILLINOIS	FED. AID PROJECT	

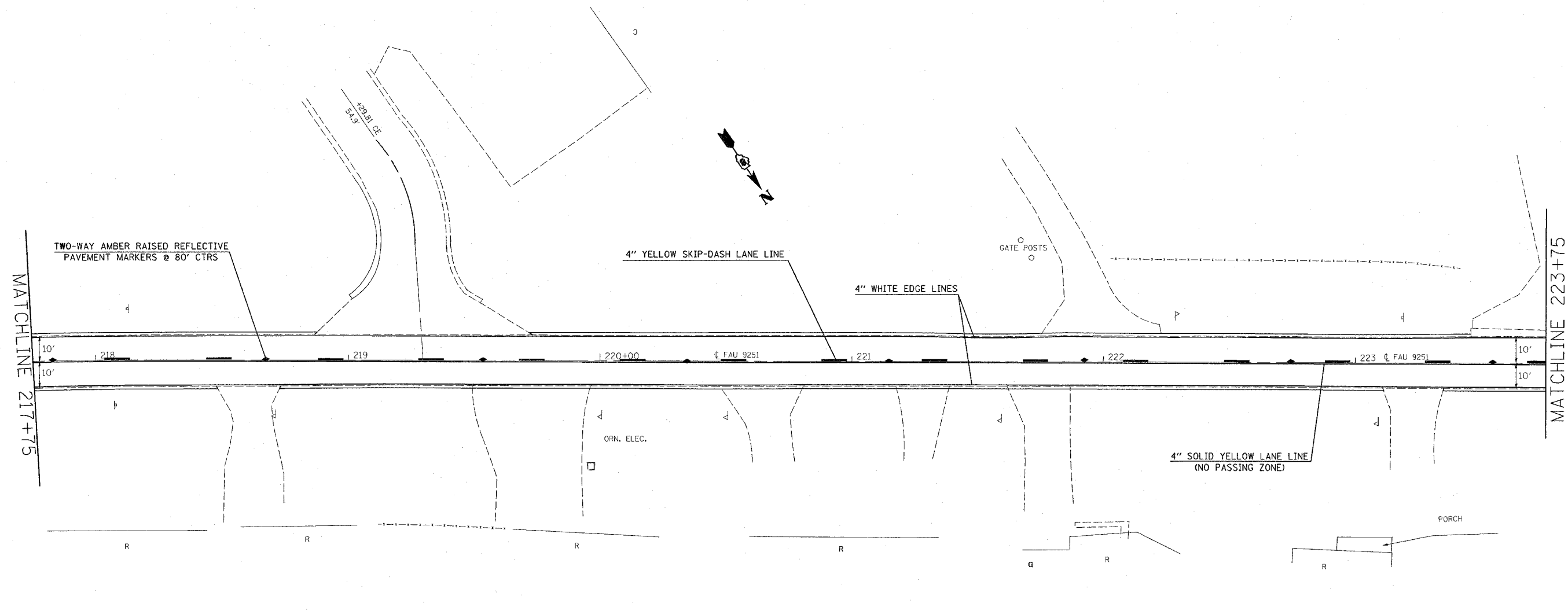

MATCHLINE 217+75

MATCHLINE 223+75

TWO-WAY AMBER RAISED REFLECTIVE PAVEMENT MARKERS @ 80' CTRS

4" YELLOW SKIP-DASH LANE LINE

4" WHITE EDGE LINES

GATE POSTS

4" SOLID YELLOW LANE LINE (NO PASSING ZONE)

ORN. ELEC.

PORCH

PLOT DATE = 3/13/2007
 FILE NAME = c:\pvc\pcta\ed06807\plan\pca06807.dgn
 PLOT SCALE = 28.0000' / IN.
 REFERENCE = REF#

REVISIONS	
NAME	DATE

ILLINOIS DEPARTMENT OF TRANSPORTATION
PAVEMENT MARKING PLAN
 FAU 9251
 SECTION 28-3RS-1
 ST CLAIR COUNTY

SCALE: VERT. _____
 HORIZ. _____
 DATE _____ DRAWN BY _____
 CHECKED BY _____