

EXISTING TOPOGRAPHY

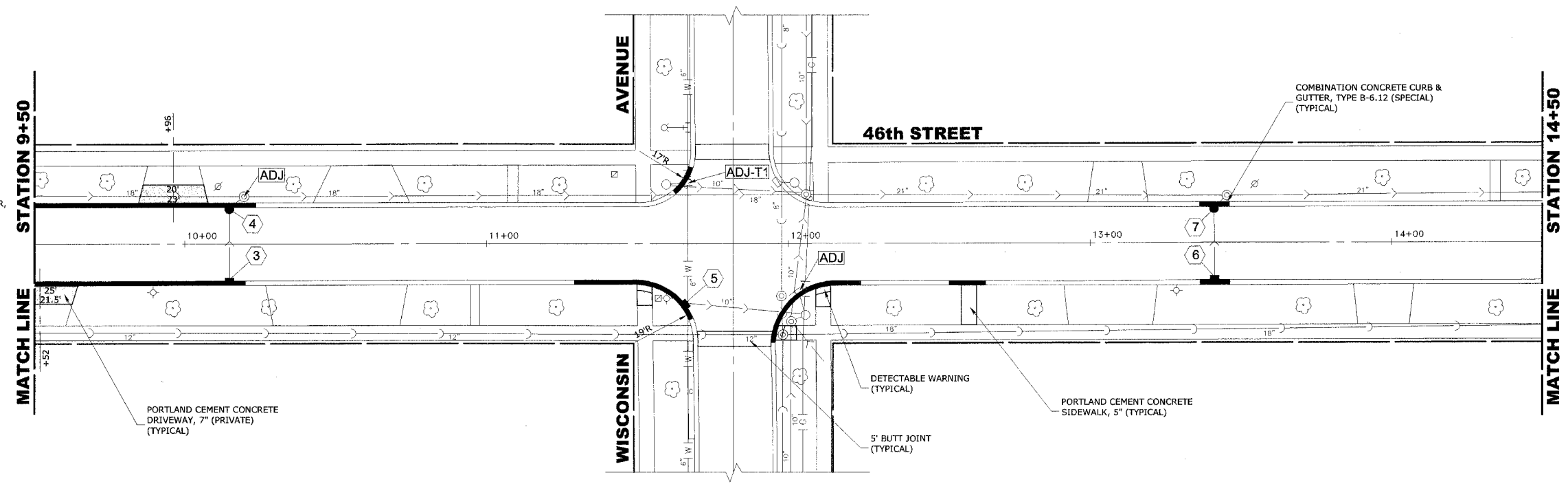

PROPOSED IMPROVEMENT

- 3 STA. 10+15, 12' RT. INLET, TYPE A, WITH TYPE 1 FRAME, OPEN LID RIM ELEV. 589.60 INV. ELEV. 586.98 (N)
- 4 STA. 10+15, 12' LT. R.D. CATCH BASIN, 4' DIAMETER, TYPE 1 FRAME, OPEN LID RIM ELEV. 589.60 INV. ELEV. 586.81 (S, NE)
- 5 STA. 11+66, 20' RT. INLET, TYPE A, WITH TYPE 1 FRAME, OPEN LID RIM ELEV. 590.04 INV. ELEV. 586.92 (E)

- 6 STA. 13+41, 12' RT. INLET, TYPE A, WITH TYPE 1 FRAME, OPEN LID RIM ELEV. 589.74 INV. ELEV. 587.09 (N)
- 7 STA. 13+41, 12' LT. R.D. CATCH BASIN, 4' DIAMETER, TYPE 1 FRAME, OPEN LID RIM ELEV. 589.84 INV. ELEV. 587.06 (S, NE)

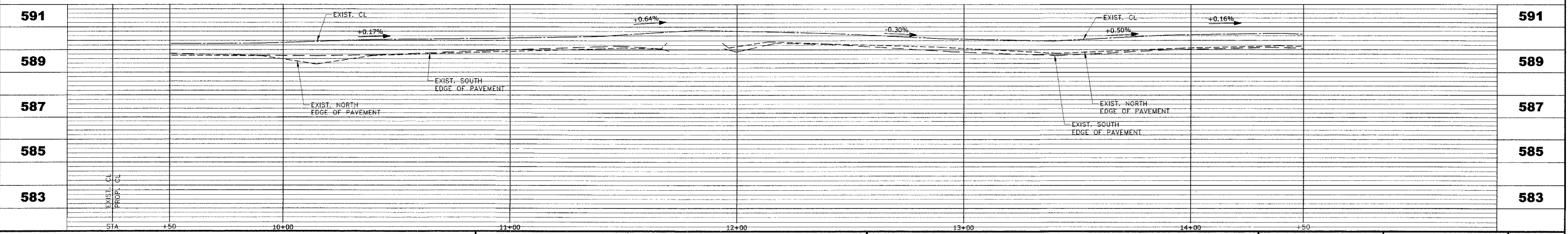

HANCOCK ENGINEERING ♦ Civil Engineers
 ♦ Municipal Consultants
 ♦ Established 1911

9933 Roosevelt Road
 Westchester, Illinois 60154-2780
 Phone: 708/865-0300
 Fax: 708/865-1212

**46th STREET RESURFACING PROJECT
 VILLAGE OF FOREST VIEW, ILLINOIS**

**EXISTING AND PROPOSED
 PAVING, UTILITIES AND DRAINAGE
 PLAN AND PROFILE**

SCALE: 1"=20'H. & 1"=2'V.
 DRAWN BY: MK/DMM/LEV/TSG
 BOOK NO.: SDR33
 DATE: 11-1-06
 E.H.E. NO.: 320-05-35101

SHEET **7** OF **24**

Drawing file: W:\Projects\32005351 - 46th St Resurf & Sewer\46th St Resurf\46th St Resurf.dwg
 Nov 01, 2006 - 2:28pm