

PROFILE SURVEYED BY: DATE: _____
 GRADES CHECKED: _____
 STRUCTURE NOTES: _____
 NO. _____
 SURVEYED BY: DATE: _____
 NOTE BOOK: _____
 ADJUSTED BY: DATE: _____
 NO. _____

CHRISTOPHER B. BURKE ENGINEERING LTD.
 9575 West Higgins Road, Suite 600
 Rosemont, Illinois 60018
 (847) 823-0500



F.A.L. RTE.	SECTION	COUNTY	TOTAL SHEETS	NO.
---	06-00062-00-RS	COOK	41	9
STA. 30+00.00		TO STA. 40+31.75		
FED. ROAD DIST. NO.		ILLINOIS	FED. AID PROJECT	

CONTRACT NO. 83920

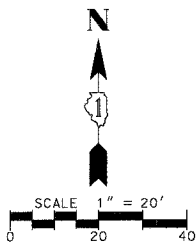
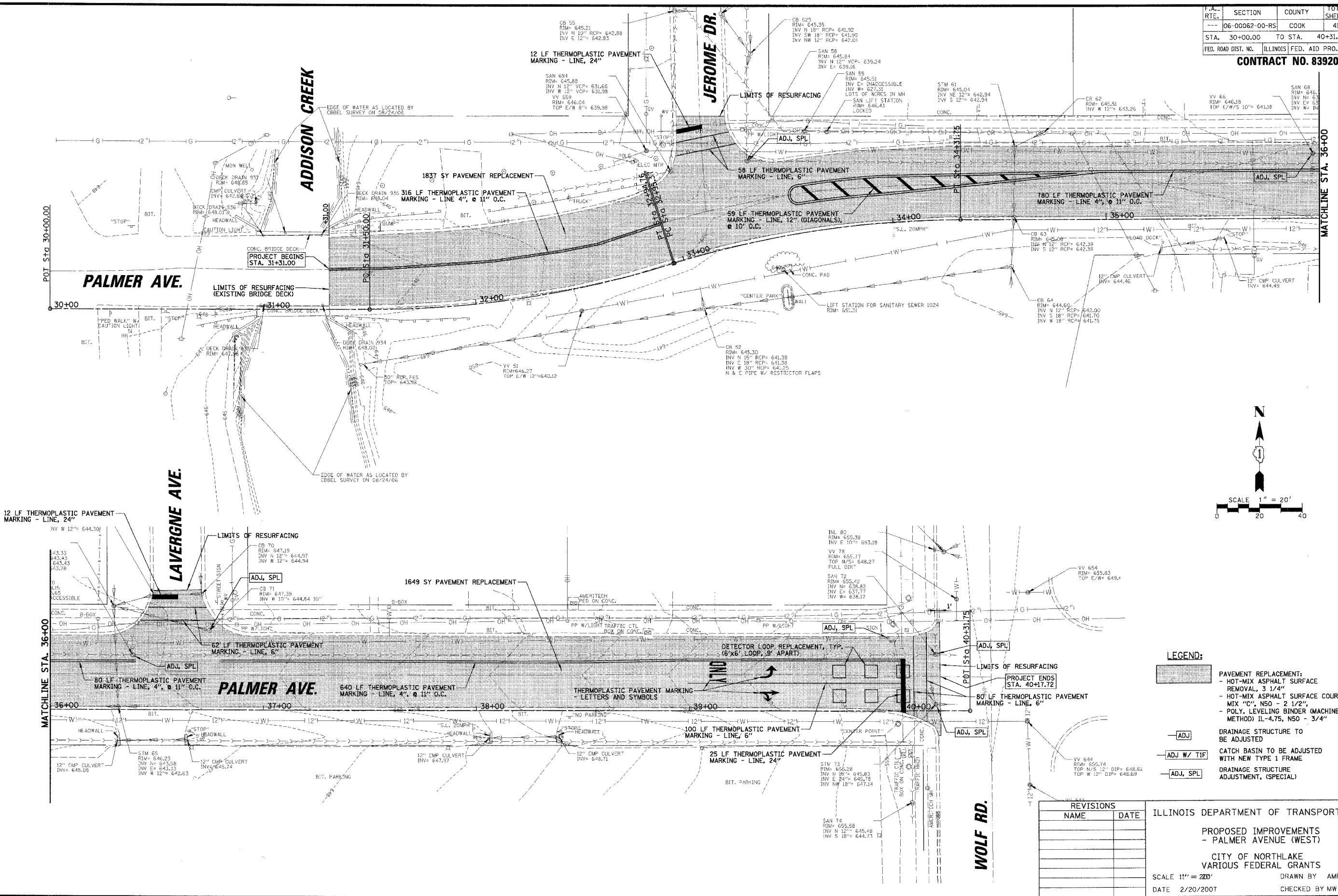

- LEGEND:**
- PAVEMENT REPLACEMENT:
 - HOT-MIX ASPHALT SURFACE REMOVAL, 3 1/4"
 - HOT-MIX ASPHALT SURFACE COURSE MIX "C", N50 - 2 1/2",
 - POLY. LEVELING BINDER (MACHINE METHOD) IL-4.75, N50 - 3/4"
 - DRAINAGE STRUCTURE TO BE ADJUSTED
 - CATCH BASIN TO BE ADJUSTED WITH NEW TYPE 1 FRAME
 - DRAINAGE STRUCTURE ADJUSTMENT, (SPECIAL)

REVISIONS	
NAME	DATE

ILLINOIS DEPARTMENT OF TRANSPORTATION
 PROPOSED IMPROVEMENTS
 - PALMER AVENUE (WEST)
 CITY OF NORTHLAKE
 VARIOUS FEDERAL GRANTS
 SCALE 1" = 20'
 DATE 2/20/2007
 DRAWN BY AMP
 CHECKED BY MW