

DATE: _____ BY: _____
 SURVEYED: _____
 PLAN: _____
 CHECKED: _____
 DATE: _____
 NO. OF MAY CHECKER: _____
 CAD FILE NAME: _____

CHRISTOPHER B. BURKE ENGINEERING LTD.
 9575 West Higgins Road, Suite 600
 Rosemont, Illinois 60018
 (847) 823-0500

DATE: _____ BY: _____
 SURVEYED: _____
 PROFILE: _____
 CHECKED: _____
 DATE: _____
 NO. OF MAY CHECKER: _____
 CAD FILE NAME: _____

F.A. RTE.	SECTION	COUNTY	TOTAL SHEETS	SHEET NO.
---	06-00062-00-RS	COOK	41	21
STA. 160+00.00		TO STA. 173+00.00		
FED. ROAD DIST. NO.	ILLINOIS	FED. AID PROJECT		

CONTRACT NO. 83920

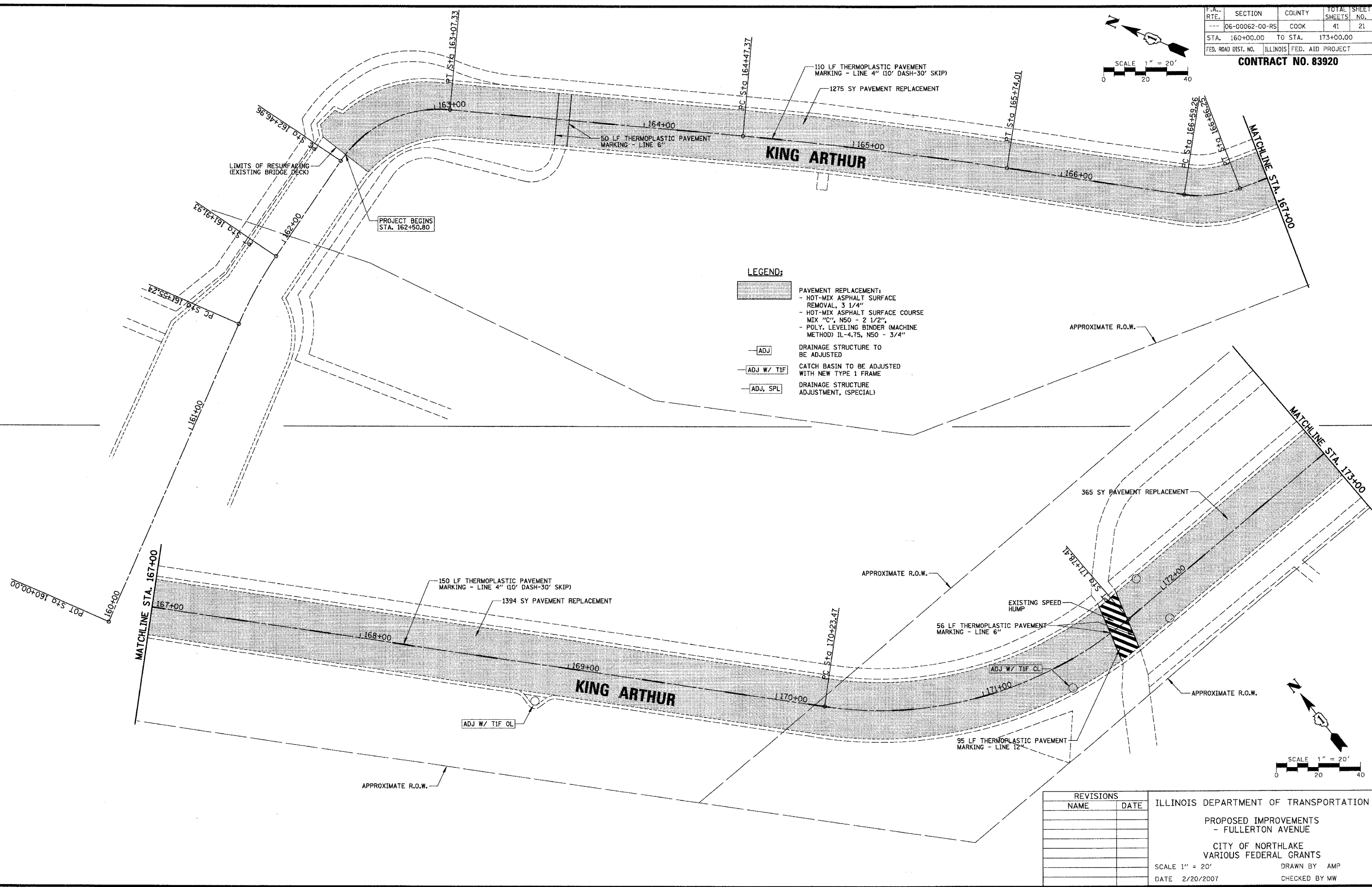
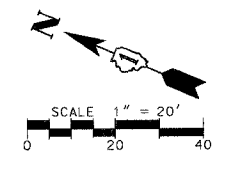

- LEGEND:**
- PAVEMENT REPLACEMENT:
 - HOT-MIX ASPHALT SURFACE REMOVAL, 3 1/4"
 - HOT-MIX ASPHALT SURFACE COURSE MIX "C", N50 - 2 1/2"
 - POLY. LEVELING BINDER (MACHINE METHOD) IL-4.75, N50 - 3/4"
 - DRAINAGE STRUCTURE TO BE ADJUSTED
 - CATCH BASIN TO BE ADJUSTED WITH NEW TYPE 1 FRAME
 - DRAINAGE STRUCTURE ADJUSTMENT, (SPECIAL)

REVISIONS	
NAME	DATE

ILLINOIS DEPARTMENT OF TRANSPORTATION
 - FULLERTON AVENUE
 CITY OF NORTHLAKE
 VARIOUS FEDERAL GRANTS

SCALE 1" = 20' DRAWN BY AMP
 DATE 2/20/2007 CHECKED BY MW