

F.A.S. NO.	SECTION	COUNTY	TOTAL SHEETS
418	04-00069-00-RS	HENDERSON	16
FED. ROAD DIST. NO. ILLINOIS FED. AID PROJECT			

**INDEX OF SHEETS**

- 1 Cover Sheet
- 2 Summary of Quantities / General Notes
- 3 Existing Typical Sections
- 4-7 Proposed Typical Sections
- 8-9 Schedules
- 10 Project Centerline Plan
- 11 Entrance & Mailbox Details
- 12 Butt Joint Details
- 13 Sideroad Details
- 14-15 Intersection Detail Sheets
- 16 Storm Water *Pollution Prevention Plan*

**LIST OF STANDARDS**

- Standard 000001-04 Standard Symbols, Abbreviations and Patterns
- Standard 542306-01 Precast Reinforced Concrete Elliptical Elared End Section
- Standard 630301-04 Shoulder Widening for Type 1 (Special) Guardrail Terminals
- Standard 635006-02 Reflector and Terminal Marker Placement
- Standard 701006-02 Off-Road Operations, 2L, 2W, 4.5 m (15') to 600 mm (24") from Pavement Edge
- Standard 701011-01 Off-Road Moving Operations, 2L, 2W, Day Only
- Standard 701201-02 Lane Closure, 2L, 2W, Day Only, For Speeds > 45 mph
- Standard 701306-01 Lane Closure, 2L, 2W, Slow Moving Operations Day Only, for Speeds > 45 mph
- Standard 701311-02 Lane Closure, 2L, 2W Moving Operations - Day Only
- Standard 702001-06 Traffic Control Devices
- Standard 780001-01 Typical Pavement Markings
- Standard BLR 14-9 Portland Cement Concrete Pavement
- Standard BLR 24-1 Mailbox Turnout for Local Roads

STATE OF ILLINOIS  
DEPARTMENT OF TRANSPORTATION  
DIVISION OF HIGHWAYS  
**PLANS FOR PROPOSED  
LOCAL AGENCY IMPROVEMENT**

**ROADWAY IMPROVEMENTS  
VANTINE ROAD (F.A.S. 418)  
SECTION 04-00069-00-RS  
GLADSTONE ROAD DISTRICT  
HENDERSON COUNTY  
PROJECT NO. RS-0418(110)  
C-94-067-05**

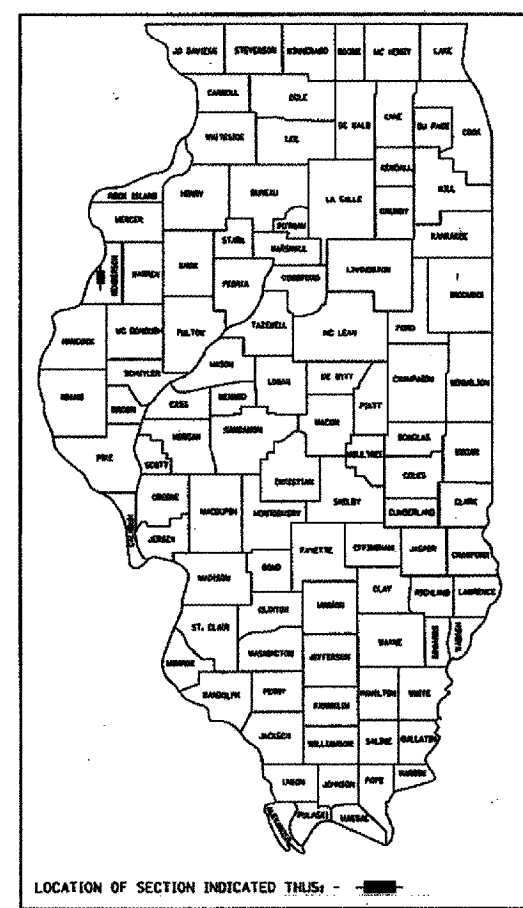

ROADWAY CLASSIFICATION: COLLECTOR  
CURRENT ADT = <750  
DESIGN YEAR ADT = 750  
DESIGN SPEED: 50 MPH  
DESIGN GUIDELINES: 3R  
VARIANCES GRANTED: YES  
COMMITMENTS: NONE

**JOINT UTILITY LOCATING INFORMATION FOR EXCAVATORS**  
J.U.L.I.E. Telephone No. Toll Free 1-800-892-0123

CONTRACT NO. : 89366

**URS**  
345 EAST ASH AVENUE, SUITE B  
DECATUR, ILLINOIS 62526  
PH. 217-875-4800

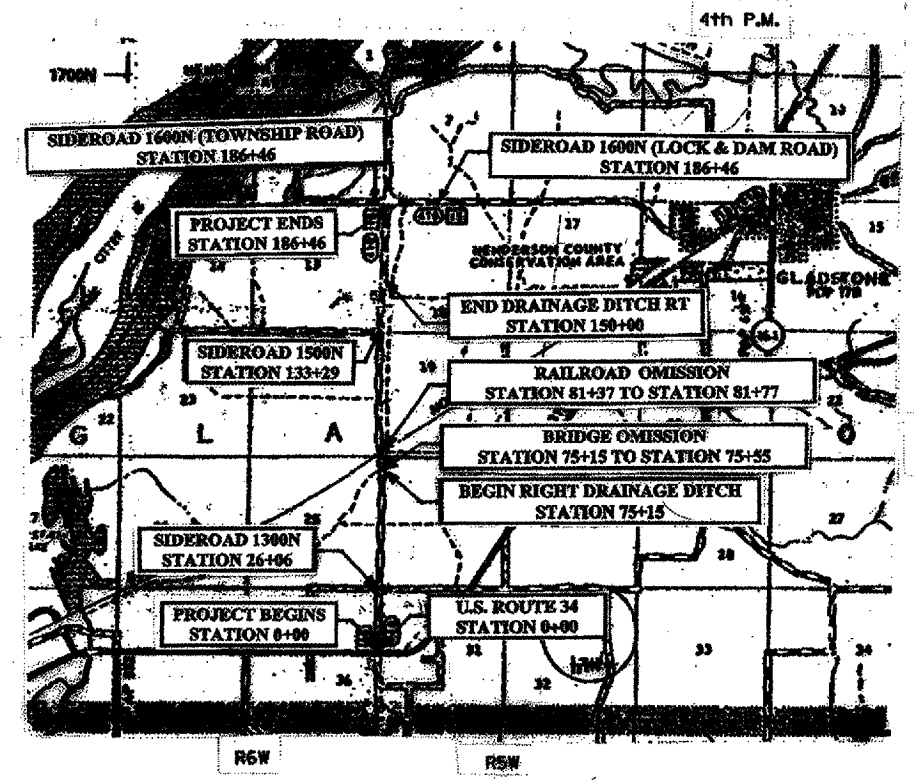

**LAYOUT**

Approximate Scale: miles  
Total and Net Length of Improvement 18,646 Feet = 3.53 Miles

APPROVED 19 Nov 2006 Robert J. Wickman COUNTY ENGINEER

APPROVED \_\_\_\_\_ 20 \_\_\_\_\_ ROAD COMMISSIONER

PASSED 11 JANUARY 2007 John Laballe DISTRICT FOUR ENGINEER OF LOCAL ROADS & STREETS

Releasing For Bid Based on Limited Review 12 January 2007 J.E. Cramer DEPUTY DIRECTOR OF HIGHWAYS, REGION THREE ENGINEER

STATE OF ILLINOIS DEPARTMENT OF TRANSPORTATION

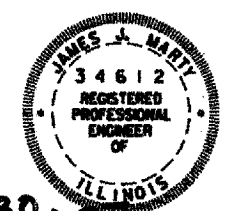

Exp 11-30-07  
J. Martz  
Illinois Professional No. 34612

1-5-07  
Date



F.A.S. RTE.	SECTION	COUNTY	TOTAL SHEETS	SHEET NO.
418	04-00069-00-RS	HENDERSON	15	3
STA.		TO STA.		
FED. ROAD DIST. NO.	ILLINOIS	FED. AID PROJECT		
CONTRACT NO. 09366				

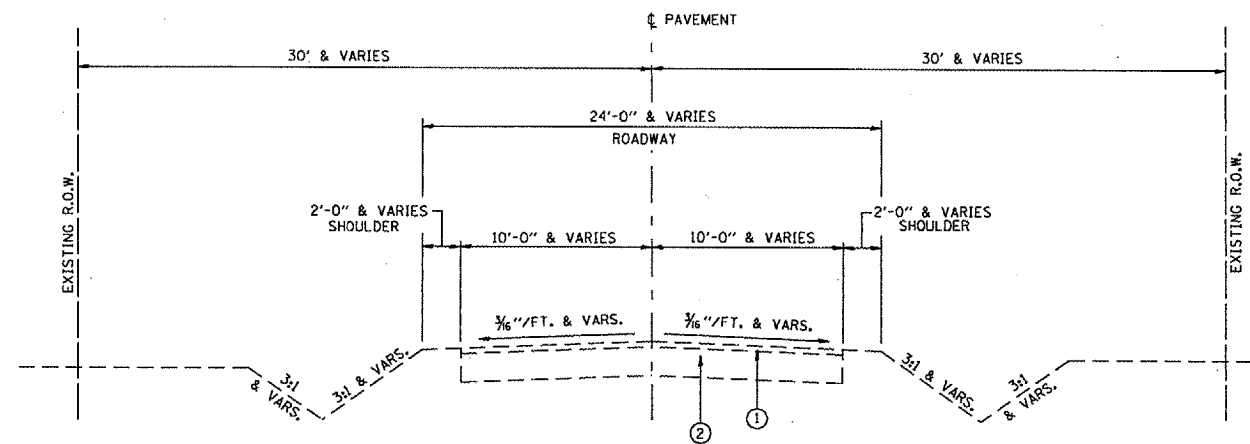

**EXISTING TYPICAL SECTION**

\* STA. 0+00 TO 75+15  
 \*\* STA. 155+00 TO 186+46

- ① OIL & CHIP SURFACE COURSE  
 \* (VARIES FROM 4.0" TO 6.0")  
 \*\* (VARIES FROM 3.0" TO 4.25")
- ② AGGREGATE BASE COURSE  
 \* (VARIES FROM 3.0" TO 5.5")  
 \*\* (VARIES FROM 6.0" TO 9.0")

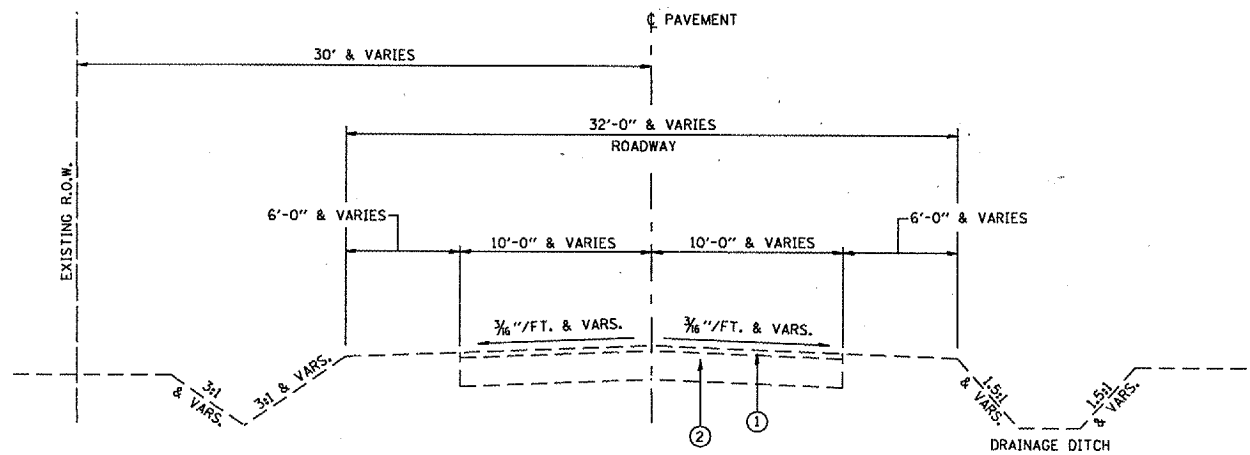

**EXISTING TYPICAL SECTION**

\* STA. 75+15 TO 155+00

- ① OIL & CHIP SURFACE COURSE  
 \* (VARIES FROM 3.0" TO 7.0")
- ② AGGREGATE BASE COURSE  
 \* (VARIES FROM 3.0" TO 7.0")

REVISIONS	
NAME	DATE

ILLINOIS DEPARTMENT OF TRANSPORTATION  
 F.A.S. 418 (VANTINE ROAD)

**EXISTING TYPICAL SECTIONS**

SCALE: N/A  
 DATE: 1-5-07

DRAWN BY CGF  
 CHECKED BY JJM

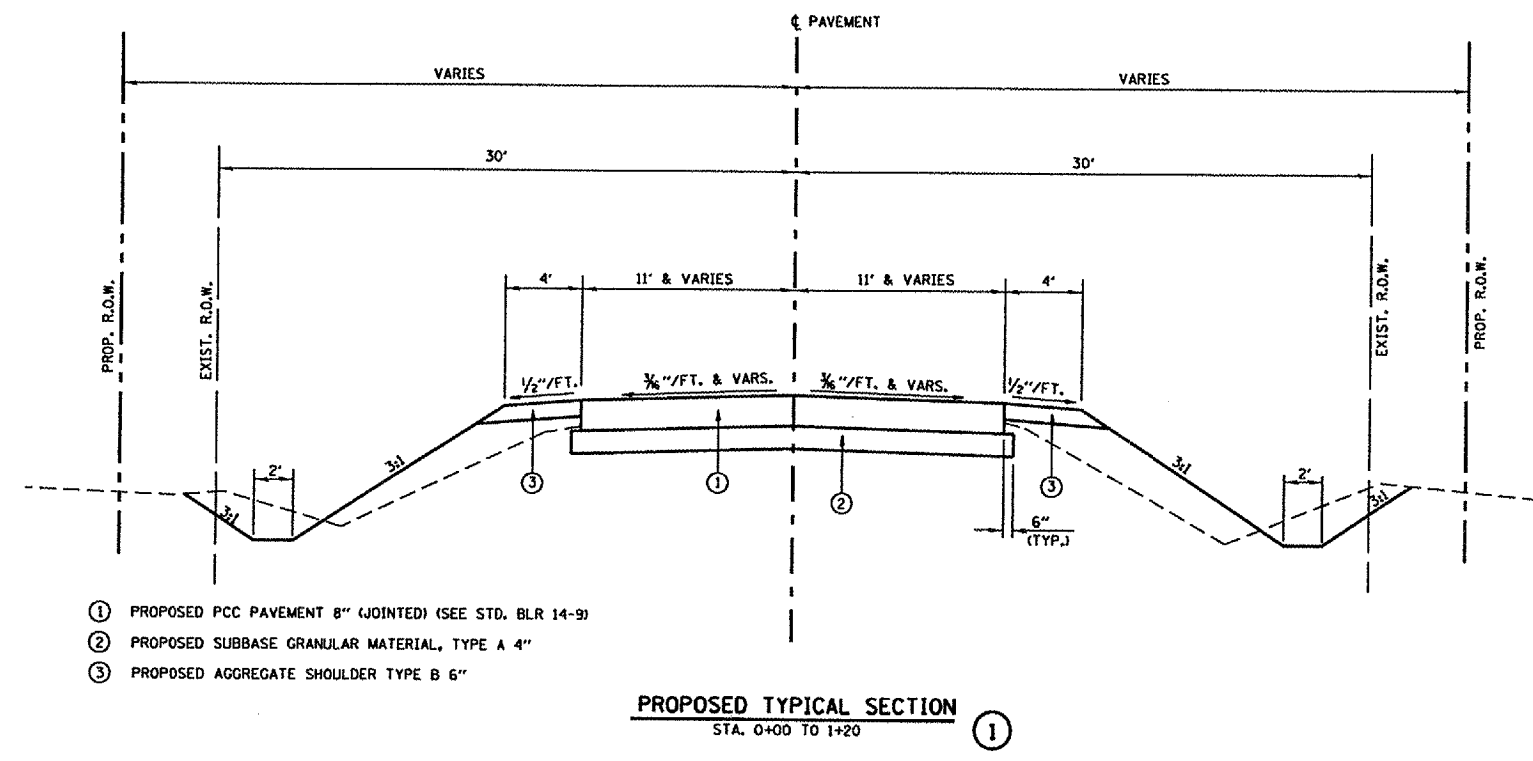

**PAVEMENT DESIGN - RIGID (80,000 LB VEHICLE)**

DP = 20 YR.  
 ADT<sub>(2025)</sub> = 750; PV=660, SU=53, MU=38  
 CLASS III ROAD, E<sub>(RI)</sub> = 3ksi  
 TF<sub>(ACTUAL)</sub> = 0.29  
 TF<sub>(MIN.)</sub> = 0.50

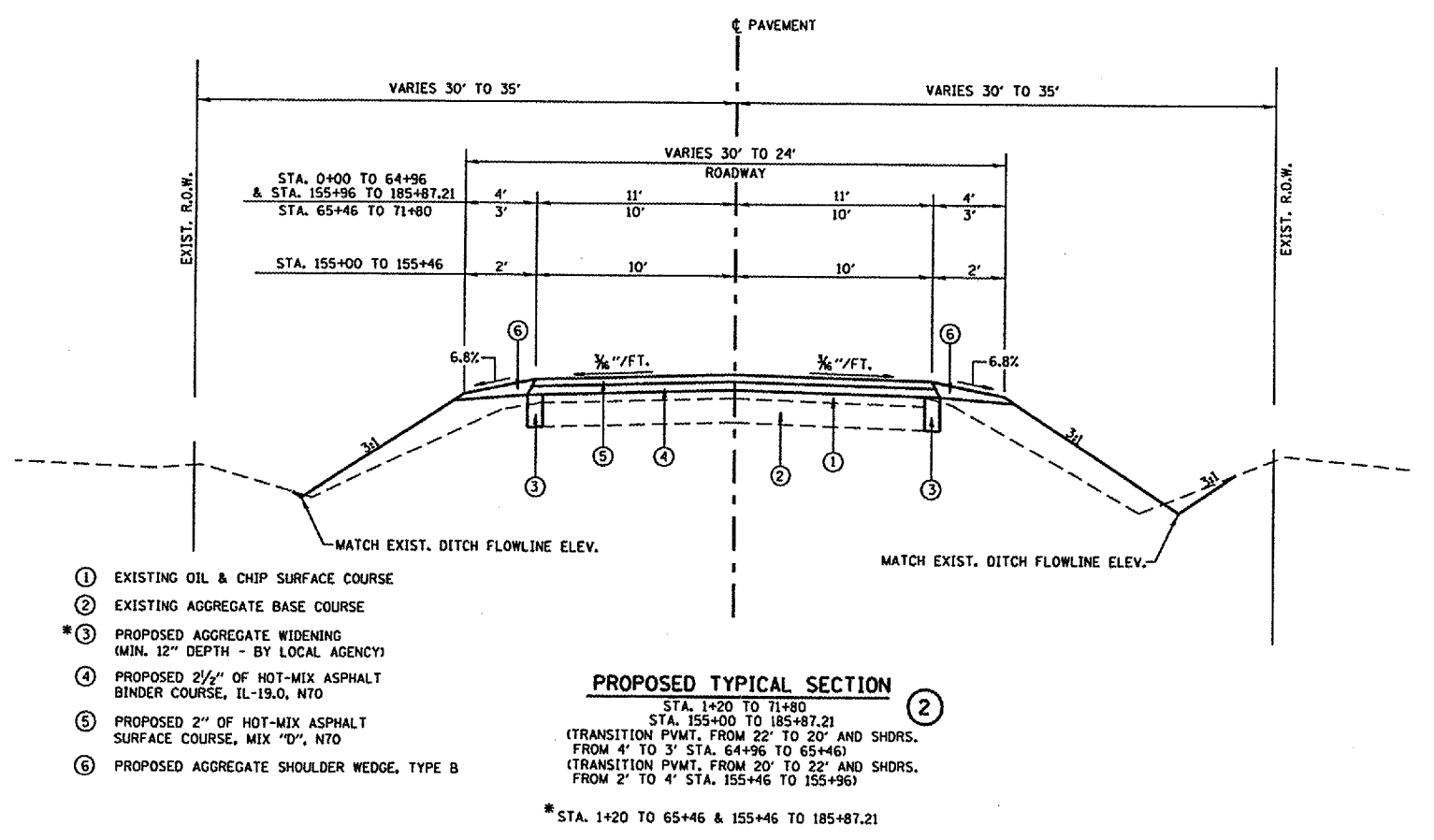

**PAVEMENT DESIGN - FLEXIBLE (80,000 LB VEHICLE)**

DP = 20 YR.  
 ADT<sub>(2025)</sub> = 750; PV=660, SU=53, MU=38  
 CLASS III ROAD, E<sub>(RI)</sub> = 3ksi  
 TF = 0.20

**BITUMINOUS MIXTURE REQUIREMENTS**

LOCATION	FAS 418	FAS 418
MIX USE	BINDER	SURFACE
AC/PG	PG 64-22	PG 64-22
RAP %	15	10
DESIGN VOIDS	4.0 @ N=70	4.0 @ N=70
MIXTURE COMPOSITION (GRAD. MIXTURE)	IL-19.0	IL-9.5 OR IL-12.0
FRICTION	N/A	MIX D (DOLOMITE ONLY)

- ① EXISTING OIL & CHIP SURFACE COURSE
- ② EXISTING AGGREGATE BASE COURSE
- \* ③ PROPOSED AGGREGATE WIDENING (MIN. 12" DEPTH - BY LOCAL AGENCY)
- ④ PROPOSED 2 1/2" OF HOT-MIX ASPHALT BINDER COURSE, IL-19.0, N70
- ⑤ PROPOSED 2" OF HOT-MIX ASPHALT SURFACE COURSE, MIX "D", N70
- ⑥ PROPOSED AGGREGATE SHOULDER WEDGE, TYPE B

**PROPOSED TYPICAL SECTION 2**  
 STA. 1+20 TO 71+80  
 STA. 155+00 TO 185+87.21  
 (TRANSITION PVT. FROM 22' TO 20' AND SHDRS. FROM 4' TO 3' STA. 64+96 TO 65+46)  
 (TRANSITION PVT. FROM 20' TO 22' AND SHDRS. FROM 2' TO 4' STA. 155+46 TO 155+96)  
 \* STA. 1+20 TO 65+46 & 155+46 TO 185+87.21

REVISIONS		ILLINOIS DEPARTMENT OF TRANSPORTATION F.A.S. 418 (VANTINE ROAD)
NAME	DATE	
		PROPOSED TYPICAL SECTIONS

SCALE: N/A  
 DATE: 1-5-07  
 DRAWN BY: CGF  
 CHECKED BY: JJM

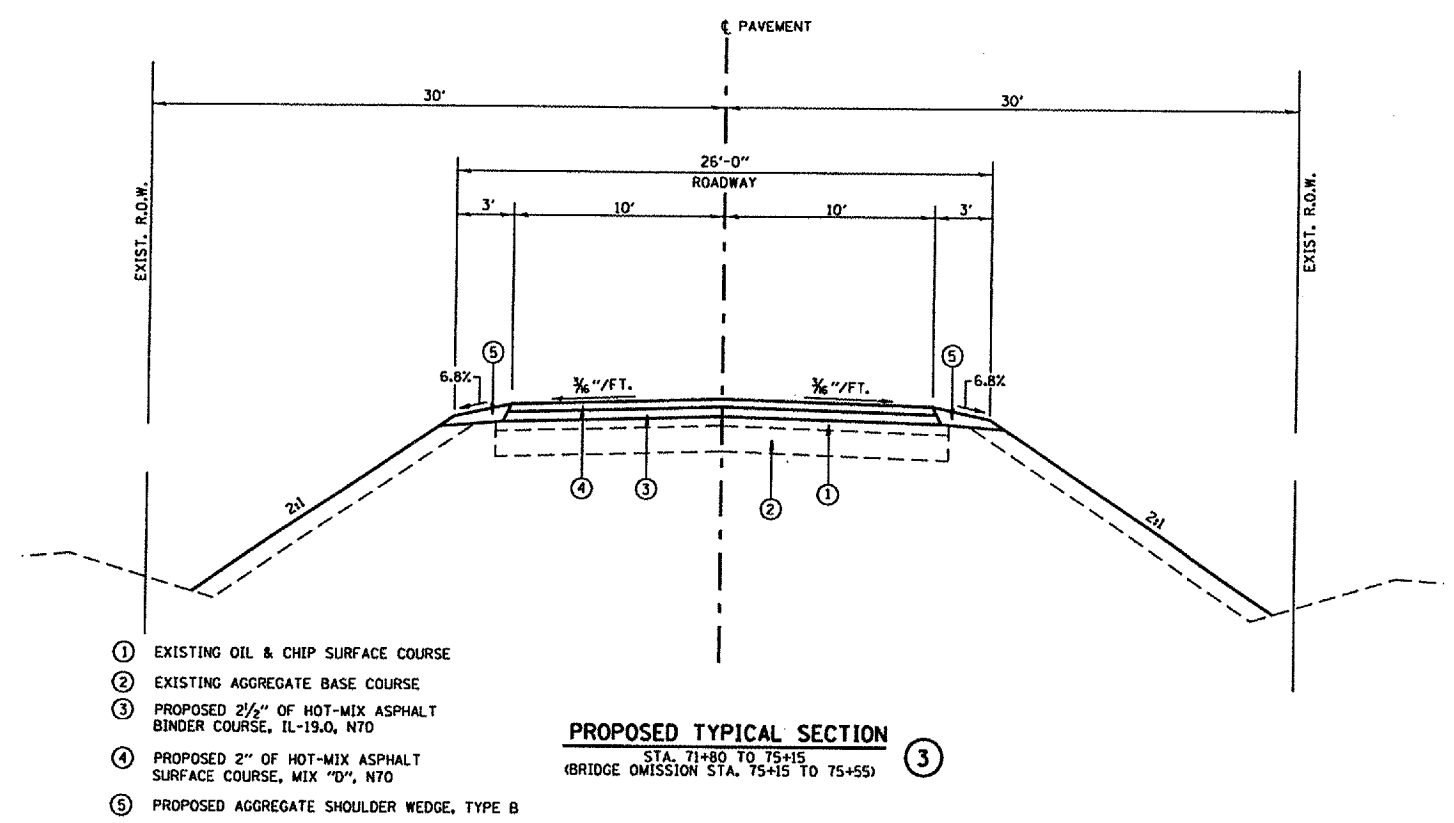

- ① EXISTING OIL & CHIP SURFACE COURSE
- ② EXISTING AGGREGATE BASE COURSE
- ③ PROPOSED 2 1/2" OF HOT-MIX ASPHALT BINDER COURSE, IL-19.0, N70
- ④ PROPOSED 2" OF HOT-MIX ASPHALT SURFACE COURSE, MIX "D", N70
- ⑤ PROPOSED AGGREGATE SHOULDER WEDGE, TYPE B

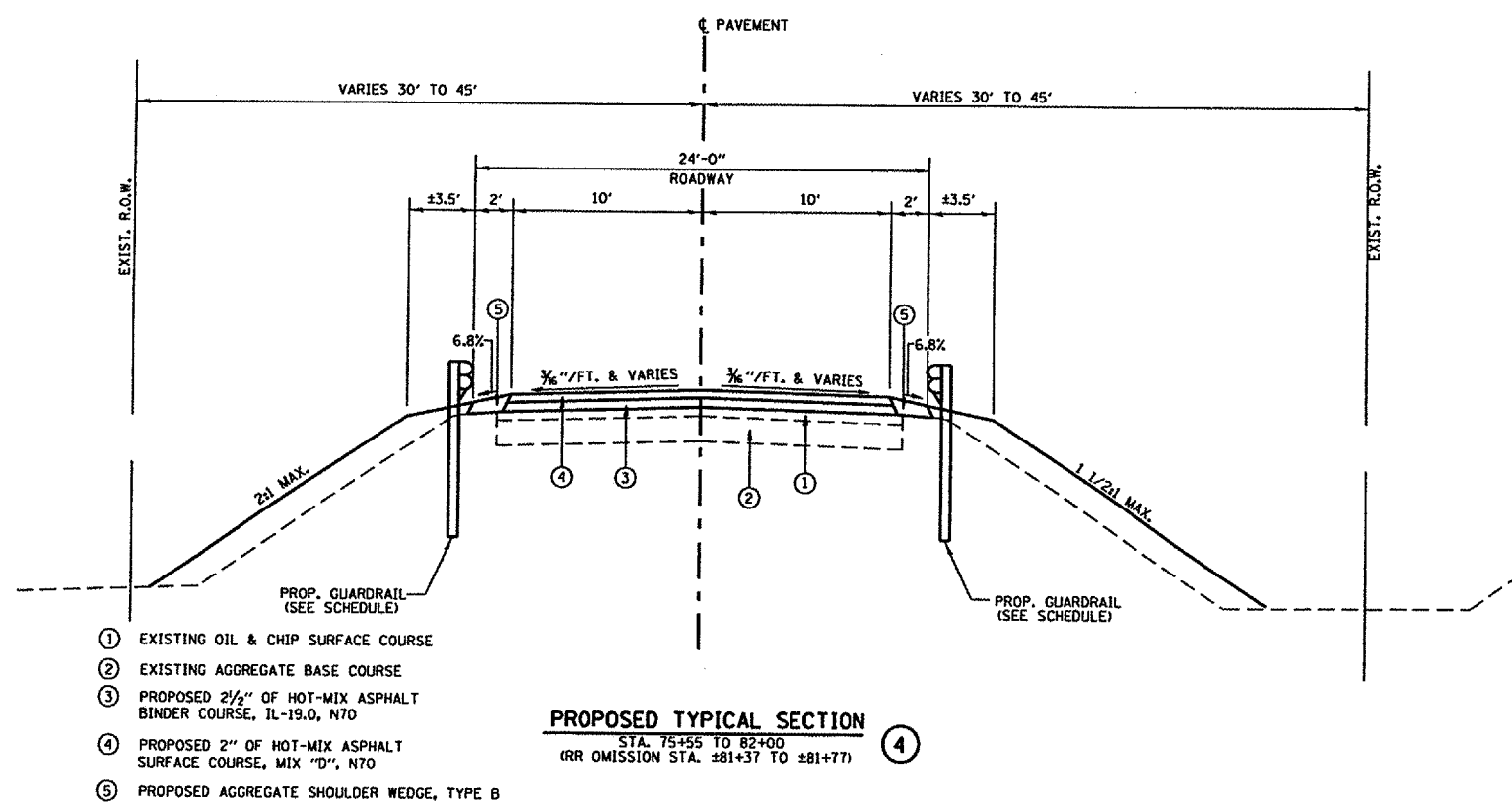

- ① EXISTING OIL & CHIP SURFACE COURSE
- ② EXISTING AGGREGATE BASE COURSE
- ③ PROPOSED 2 1/2" OF HOT-MIX ASPHALT BINDER COURSE, IL-19.0, N70
- ④ PROPOSED 2" OF HOT-MIX ASPHALT SURFACE COURSE, MIX "D", N70
- ⑤ PROPOSED AGGREGATE SHOULDER WEDGE, TYPE B

**PAVEMENT DESIGN - FLEXIBLE (80,000 LB VEHICLE)**  
 DP = 20 YR.  
 ADT(2025) = 750; PV=660, SU=53, MU=38  
 CLASS III ROAD, E<sub>(RI)</sub> = 3ksi  
 TF = 0.20

**BITUMINOUS MIXTURE REQUIREMENTS**

LOCATION	FAS 418	FAS 418
MIX USE	BINDER	SURFACE
AC/PG	PG 64-22	PG 64-22
RAP %	15	10
DESIGN VOIDS	4.0 @ N=70	4.0 @ N=70
MIXTURE COMPOSITION (GRAD. MIXTURE)	IL-19.0	IL-9.5 OR IL-12.0
FRICTION	N/A	MIX D (DOLOMITE ONLY)

REVISIONS	
NAME	DATE

ILLINOIS DEPARTMENT OF TRANSPORTATION  
F.A.S. 418 (VANTINE ROAD)

**PROPOSED TYPICAL SECTIONS**

SCALE: N/A  
DATE: 1-5-07  
DRAWN BY: CGF  
CHECKED BY: JJM

F.A.S. RTE.	SECTION	COUNTY	TOTAL SHEETS	SHEET NO.
418	04-00069-00-RS	HENDERSON	15	6
STA.		TO STA.		
FED. ROAD DIST. NO.	ILLINOIS	FED. AID PROJECT		
CONTRACT NO. B9366				

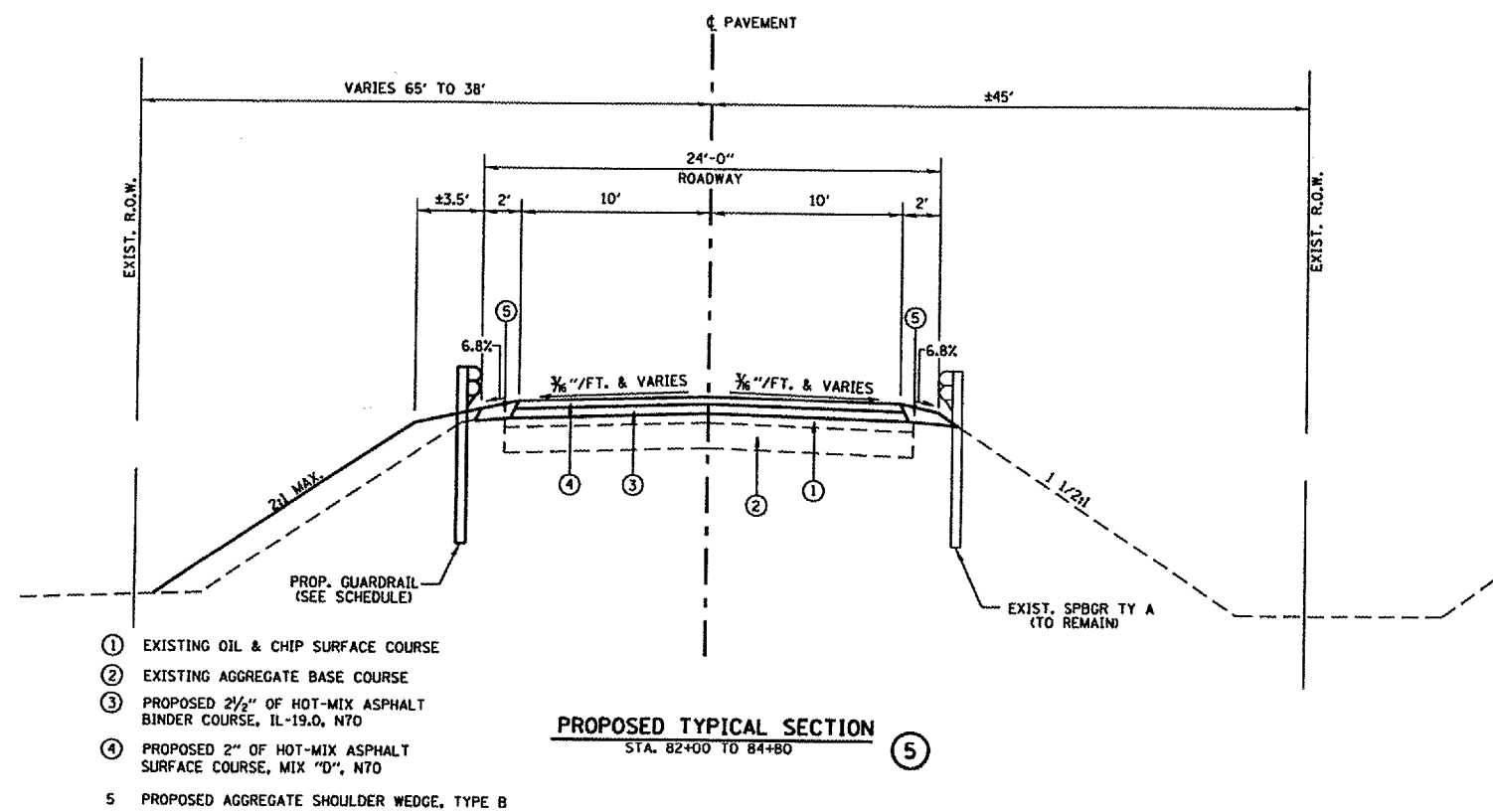

- ① EXISTING OIL & CHIP SURFACE COURSE
- ② EXISTING AGGREGATE BASE COURSE
- ③ PROPOSED 2 1/2" OF HOT-MIX ASPHALT BINDER COURSE, IL-19.0, N70
- ④ PROPOSED 2" OF HOT-MIX ASPHALT SURFACE COURSE, MIX "D", N70
- ⑤ PROPOSED AGGREGATE SHOULDER WEDGE, TYPE B

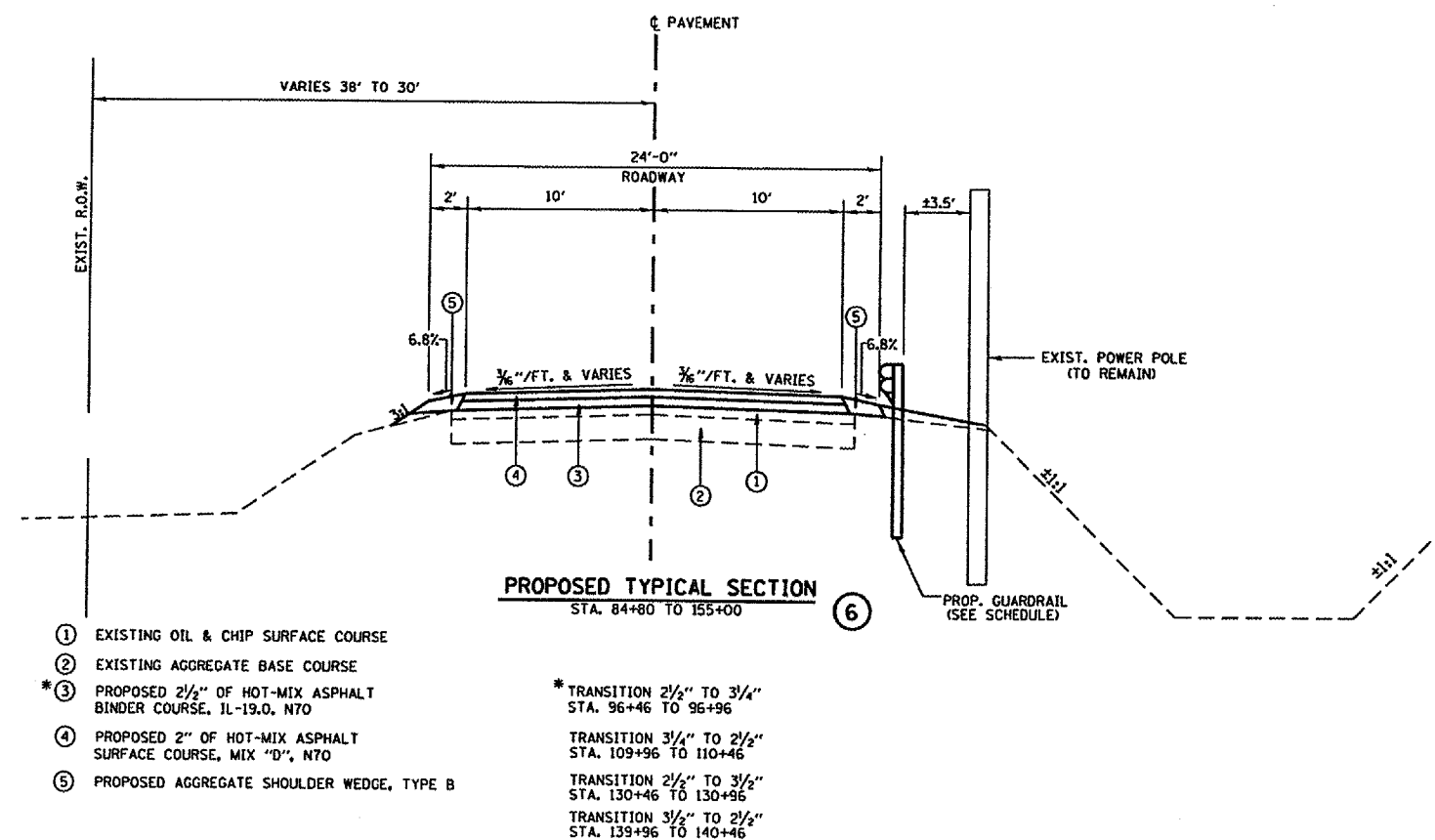

- ① EXISTING OIL & CHIP SURFACE COURSE
- ② EXISTING AGGREGATE BASE COURSE
- \*③ PROPOSED 2 1/2" OF HOT-MIX ASPHALT BINDER COURSE, IL-19.0, N70
- ④ PROPOSED 2" OF HOT-MIX ASPHALT SURFACE COURSE, MIX "D", N70
- ⑤ PROPOSED AGGREGATE SHOULDER WEDGE, TYPE B

\* TRANSITION 2 1/2" TO 3/4"  
STA. 96+46 TO 96+96

TRANSITION 3/4" TO 2 1/2"  
STA. 109+96 TO 110+46

TRANSITION 2 1/2" TO 3/4"  
STA. 130+46 TO 130+96

TRANSITION 3/4" TO 2 1/2"  
STA. 139+96 TO 140+46

**PAVEMENT DESIGN - FLEXIBLE (80,000 LB VEHICLE)**

DP = 20 YR.  
ADT<sub>(2025)</sub> = 750; PV=660, SU=53, MU=38  
CLASS III ROAD, E<sub>(RI)</sub> = 3ksi  
TF = 0.20

**BITUMINOUS MIXTURE REQUIREMENTS**

LOCATION	FAS 418	FAS 418
MIX USE	BINDER	SURFACE
AC/PG	PG 64-22	PG 64-22
RAP %	15	10
DESIGN VOIDS	4.0 @ N=70	4.0 @ N=70
MIXTURE COMPOSITION (GRAD. MIXTURE)	IL-19.0	IL-9.5 OR IL-12.0
FRICTION	N/A	MIX D (DOLOMITE ONLY)

REVISIONS	
NAME	DATE

ILLINOIS DEPARTMENT OF TRANSPORTATION  
F.A.S. 418 (VANTINE ROAD)

**PROPOSED TYPICAL SECTIONS**

SCALE: N/A  
DATE: 1-5-07

DRAWN BY CGF  
CHECKED BY JJM

F.A.S. RITE	SECTION	COUNTY	TOTAL SHEETS	SHEET NO.
418	04-00069-00-RS	HENDERSON	15	7
STA.		TO STA.		
FED. ROAD DIST. NO.	ILLINOIS	FED. AID PROJECT		
CONTRACT NO. B9366				

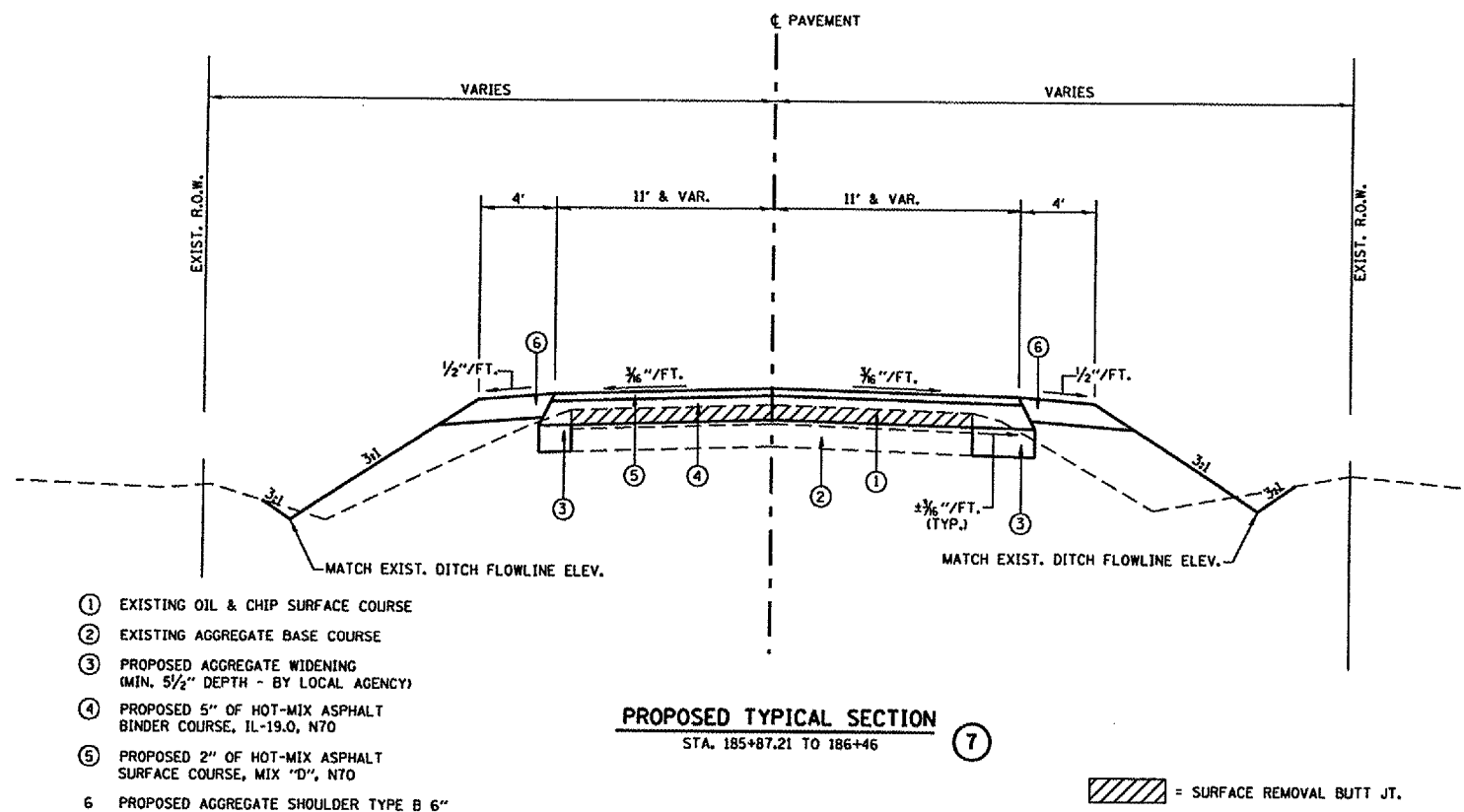

- ① EXISTING OIL & CHIP SURFACE COURSE
- ② EXISTING AGGREGATE BASE COURSE
- ③ PROPOSED AGGREGATE WIDENING (MIN. 5/2" DEPTH - BY LOCAL AGENCY)
- ④ PROPOSED 5" OF HOT-MIX ASPHALT BINDER COURSE, IL-19.0, N70
- ⑤ PROPOSED 2" OF HOT-MIX ASPHALT SURFACE COURSE, MIX "D", N70
- ⑥ PROPOSED AGGREGATE SHOULDER TYPE B 6"

**PROPOSED TYPICAL SECTION**  
STA. 185+87.21 TO 186+46

⑦

= SURFACE REMOVAL BUTT JT.

**PAVEMENT DESIGN - FLEXIBLE (80,000 LB VEHICLE)**

DP = 20 YR.  
ADT(2025) = 750; PV=660, SU=53, MU=38  
CLASS III ROAD, E<sub>(RI)</sub> = 3ksi  
TF = 0.20

**BITUMINOUS MIXTURE REQUIREMENTS**

LOCATION	FAS 418	FAS 418
MIX USE	BINDER	SURFACE
AC/PG	PG 64-22	PG 64-22
RAP %	15	10
DESIGN VOIDS	4.0 @ N=70	4.0 @ N=70
MIXTURE COMPOSITION (GRAD. MIXTURE)	IL-19.0	IL-9.5 OR IL-12.0
FRICTION	N/A	MIX D (DOLOMITE ONLY)

REVISIONS	
NAME	DATE

ILLINOIS DEPARTMENT OF TRANSPORTATION  
F.A.S. 418 (VANTINE ROAD)  
**PROPOSED TYPICAL SECTIONS**  
SCALE: N/A  
DATE: 1-5-07  
DRAWN BY CGF  
CHECKED BY JJM

### MAINLINE SCHEDULE

LOCATION	SUB GRAN MAT A (TON)	BIT MATLS PR CT (GAL)	AGG PR CT (TON)	HMA SURF REM BUTT JT (SQ YD)	HMA BC IL-19.0 N70 (TON)	HMA SC "D" N70 (TON)	PCC PVT 8 JOINTED (SQ YD)	PROTECTIVE COAT (SQ YD)	PAVEMENT REM (SQ YD)	AGGREGATE SHLDS B (TON)
STA 0+00.00 TO 1+20.00	131						556	1112	336	56.1
STA 1+20.00 TO 64+96.00		1337.2	50.2		2235.7	1758.8				925.7
STA 64+96.00 TO 65+46.00		10.1	0.4		16.8	13.2				6.9
STA 65+46.00 TO 74+25.00		168.7	6.3		280.9	220.6				112.4
STA 74+25.00 TO 75+15.00		16.4	0.6		56.6	22.6			240	11.2
STA 75+55.00 TO 76+45.00		16.4	0.6		56.6	22.6			240	8.9
STA 76+45.00 TO 80+47.00		77.2	2.9		128.5	100.9				39.7
STA 80+47.00 TO 81+37.00		16.3	0.6	230	28.7	22.6				8.9
STA 81+77.00 TO 82+57.00		16.4	0.6		56.6	22.6			230	8.9
STA 82+57.00 TO 96+46.00		264.7	10.0		440.6	346.1				136.3
STA 96+46.00 TO 96+96.00		9.6	0.3		18.4	12.5				5.5
STA 96+96.00 TO 109+96.00		250.4	9.4		541.7	326.3				156.9
STA 109+96.00 TO 110+46.00		9.6	0.3		18.4	12.5				5.5
STA 110+46.00 TO 130+46.00		383.9	14.4		639.1	501.9				197.6
STA 130+46.00 TO 130+96.00		9.6	0.4		19.2	12.5				5.7
STA 130+96.00 TO 139+96.00		173.6	6.5		404.3	225.9				99.1
STA 139+96.00 TO 140+46.00		9.6	0.4		19.2	12.5				5.7
STA 140+46.00 TO 155+46.00		287.9	10.9		479.3	376.4				148.2
STA 155+46.00 TO 155+96.00		10.1	0.4		16.8	13.2				6.4
STA 155+96.00 TO 185+87.21		627.3	23.6		1048.9	825.1				439.8
STA 185+87.21 TO 186+46.00		27.5	1.0	248	97.0	38.0				36.0
<b>ADDED QUANTITY FOR RUTTING</b>					630.8	475.8				
<b>TOTALS</b>	<b>131</b>	<b>* 3722.5</b>	<b>* 139.8</b>	<b>* 478</b>	<b>* 7234.1</b>	<b>* 5362.6</b>	<b>556</b>	<b>1112</b>	<b>1046.0</b>	<b>* 2421.4</b>

\* PARTIAL QUANTITY

### ENTRANCE AND MAILBOX TURNOUT SCHEDULE

LOCATION	TYPE	WIDTH	AGG SURF CSE B (TON)	BIT MATLS PR CT (GAL)	AGG PR CT (TON)	HMA BC IL-19.0 N70 (TON)	HMA SC "D" N70 (TON)	DRIVE PAVEMENT REM (SQ YD)
RT STA 53+85.12	P.E. & M.B.T.O.	40	18.2	1.2	0.04	2.1	1.7	
LT STA 53+85.12	P.E.	11	3.8	8.2	0.32	4.1	16.4	117
LT STA 54+89.99	P.E.	14	6.4	0.7	0.03	1.2	1.0	
RT STA 56+99.73	P.E.	12	5.5	0.6	0.03	1.1	0.9	
RT STA 64+86.28	F.E.	20	14.4					
LT STA 64+86.28	F.E.	20	14.4					
RT STA 73+25.26	F.E.	20	16.1					
RT STA 77+61.18	F.E.	20	25.9					
LT STA 77+61.18	F.E.	20	10.7					
LT STA 86+31.98	P.E.	19	7.7	0.5	0.02	0.8	0.6	
LT STA 103+20.80	F.E.	25	13.3					
LT STA 107+95.78	F.E.	20	10.7					
LT STA 122+73.49	F.E.	16	8.7					
RT STA 147+50.38	P.E. & M.B.T.O.	15	6.1	1.3	0.05	2.3	1.9	
RT STA 154+87.39	F.E.	20	10.7					
LT STA 160+13.82	F.E.	21	9.7					
LT STA 160+66.47	F.E.	23	10.5					
<b>TOTALS</b>			<b>192.8</b>	<b>*12.5</b>	<b>* 0.5</b>	<b>* 11.6</b>	<b>*22.5</b>	<b>117</b>

\* PARTIAL QUANTITY

### SIDEROAD SCHEDULE

LOCATION	SIDEROAD	BIT MATLS PR CT (GAL)	AGG PR CT (TON)	HMA SURF REM BUTT JT (SQ YD)	HMA BC IL-19.0 N70 (TON)	HMA SC "D" N70 (TON)	AGGREGATE SHLDS B (TON)
LT STA 26+06.00	1300N	15.4	0.6	123	10.2	35.7	5.0
RT STA 26+06.00	1300N	14.5	0.5	132	10.7	38.1	4.9
LT STA 133+29.00	1500N	26.9	1.0	130	32.1	54.0	10.5
<b>TOTALS</b>		<b>* 56.8</b>	<b>* 2.1</b>	<b>* 385</b>	<b>* 53.0</b>	<b>* 127.8</b>	<b>* 20.4</b>

\* PARTIAL QUANTITY

REVISIONS		ILLINOIS DEPARTMENT OF TRANSPORTATION F.A.S. 418 (VANTINE ROAD)
NAME	DATE	
		SCHEDULE OF QUANTITIES

SCALE: N/A  
DATE: 1-5-07

DRAWN BY: CGF  
CHECKED BY: JJM



### GUARDRAIL SCHEDULE

LOCATION	SPBGR TY A (FT) 63000000	TR BAR TRM T1 SPL TAN (EACH) 63100167	TRAF BAR TERM T5A (EACH) 63100075	TERMINAL MARKER-DA (EACH) 78201000	EXISTING GUARDRAIL (TO REMAIN) (FT)
RT STA 75+55.00 TO 75+68.25			1		
RT STA 75+68.25 TO 76+87.00	118.75			1	
RT STA 76+87.00 TO 77+37.00		1		1	
RT STA 77+87.00 TO 78+37.00		1		1	
RT STA 78+37.00 TO 80+87.00	250.00				
RT STA 80+87.00 TO 81+37.00		1		1	
RT STA 81+37.00 TO 84+80.00					*343
RT STA 84+80.00 TO 146+80.00	6200.00				
RT STA 146+80.00 TO 147+30.00		1		1	
RT STA 147+70.00 TO 148+20.00		1		1	
RT STA 148+20.00 TO 154+20.00	600.00				
RT STA 154+20.00 TO 154+70.00		1		1	
LT STA 77+80.75 TO 78+30.75		1		1	
LT STA 78+30.75 TO 80+87.00	256.25				
LT STA 80+87.00 TO 81+37.00		1		1	
LT STA 81+77.00 TO 82+27.00		1		1	
LT STA 82+27.00 TO 84+52.00	225.00				
LT STA 84+52.00 TO 85+02.00		1		1	
<b>TOTALS</b>	<b>7650</b>	<b>10</b>	<b>1</b>	<b>10</b>	<b>*343</b>

\*ESTIMATED QUANTITY (FOR INFORMATION ONLY - NOT A PAY ITEM)

### PAINT PAVEMENT MARKINGS

LOCATION	TYPE	PT PVT MK LTRS & SYMB (ISO FT) 78001100	PAINT PVT MK LINE 4 (FOOT) 78001110		PAINT PVT MK LINE 24 (FOOT) 78001180
			WHITE	YELLOW	WHITE
STA 0+00.00 TO 186+46.00	30-10 SKIP DASH			3287	
RT STA 81+00.00	LETTERS & SYMBOLS	61			
LT STA 82+00.00	LETTERS & SYMBOLS	61			
LT STA 65+00.00 TO 90+00.00	NO PASSING			2500	30
RT STA 65+00.00 TO 90+00.00	NO PASSING			2500	30
LT STA 135+00.00 TO 165+00.00	NO PASSING			3000	
RT STA 135+00.00 TO 165+00.00	NO PASSING			3000	
LT STA 0+00.00 TO 1+20.00	EDGE LINE		185		
RT STA 0+00.00 TO 1+20.00	EDGE LINE		139		
LT STA 1+20.00 TO 185+87.21	EDGE LINE		18467		
RT STA 1+20.00 TO 185+87.21	EDGE LINE		18467		
LT STA 185+87.21 TO 186+46.00	EDGE LINE		78		
RT STA 185+87.21 TO 186+46.00	EDGE LINE		123		
<b>SUBTOTALS</b>			<b>37459</b>	<b>14287</b>	
<b>TOTALS</b>		<b>122</b>	<b>51746</b>		<b>60</b>

\*\*LOCATIONS HAVE BEEN ESTIMATED. PLACE ACCORDING TO HIGHWAY STANDARD 780001-01.

### SHORT-TERM PAVEMENT MARKINGS

LOCATION	TYPE	SHORT-TERM PAVT MKING (FOOT) 70300100	WORK ZONE PAVT MK REM (ISO FT) 70301000
		YELLOW	
AFTER BINDER COURSE PLACEMENT			
STA 0+00.00 TO 65+00.00	CENTERLINE	592	
STA 65+00.00 TO 90+00.00	NO PASSING ZONE	5000	
STA 90+00.00 TO 135+00.00	CENTERLINE	400	
STA 135+00.00 TO 165+00.00	NO PASSING ZONE	6000	
STA 165+00.00 TO 186+46.00	CENTERLINE	196	
AFTER SURFACE COURSE PLACEMENT			
STA 0+00.00 TO 65+00.00	CENTERLINE	592	197
STA 65+00.00 TO 90+00.00	NO PASSING ZONE	5000	1665
STA 90+00.00 TO 135+00.00	CENTERLINE	400	133
STA 135+00.00 TO 165+00.00	NO PASSING ZONE	6000	1999
STA 165+00.00 TO 186+46.00	CENTERLINE	196	65
<b>TOTALS</b>		<b>24376</b>	<b>4059</b>

### CULVERT REMOVAL SCHEDULE

LOCATION	TYPE	SIZE	REM EXIST CULVERTS (FT) 50105210
STA 0+11.95	CMP	30"	46
<b>TOTAL</b>			<b>46</b>

### TRAFFIC CONTROL

LOCATION	TRAF CONT COMPL (L SUM) 70103700	MOBILIZATION (L SUM) 67100100
STA 0+00.00 TO 186+46.00	1	1
<b>TOTALS</b>	<b>1</b>	<b>1</b>

### EARTHWORK SCHEDULE

LOCATION	EXCAVATION (CUT) (CU YD) 20200100	EXCAVATION (CUT) (ADJUSTED FOR SHRINKAGE) (CU YD)	EMBANKMENT (FILL) (CU YD)	EARTHWORK BALANCE WASTE (+) OR FURNISHED EXCAVATION (-) (CU YD) 20400800
STA. 0+00 TO 186+46 (VANTINE RD.)	278	210	3568	-3358
STA. 98+71.52 TO 99+51.79 (U.S. 34)	54	41	22	19
<b>TOTALS</b>	<b>332</b>	<b>251</b>	<b>3550</b>	<b>-3339</b>

(NOTE: PER BDE MANUAL CH. 64-2.02(g), USE SHRINKAGE FACTOR = 25%)  
 (NOTE: EMBANKMENT IS FOR INFORMATION ONLY & NOT A PAY ITEM)  
 (NOTE: ALL EARTHWORK QUANTITIES HAVE BEEN ESTIMATED)

### CROSSROAD PIPE CULVERT SCHEDULE

LOCATION	P CUL 1 RC-E EORS 30 (FT) 54207165	PRCF END S EL EORS 30 (EACH) 54214725	TRENCH BACKFILL (CU YD) 20800150
0+40.00	52	2	14.9
<b>TOTALS</b>	<b>52</b>	<b>2</b>	<b>14.9</b>

REVISIONS		ILLINOIS DEPARTMENT OF TRANSPORTATION F.A.S. 418 (VANTINE ROAD)
NAME	DATE	
		SCHEDULE OF QUANTITIES
SCALE: N/A	DATE: 1-5-07	DRAWN BY CGF CHECKED BY JUM

F.A.S. RTE.	SECTION	COUNTY	TOTAL SHEETS	SHEET NO.
418	04-00069-00-RS	HENDERSON	15	10
STA.	TO STA.			
FED. ROAD DIST. NO.	ILLINOIS	FED. AID PROJECT		
CONTRACT NO. 89366				

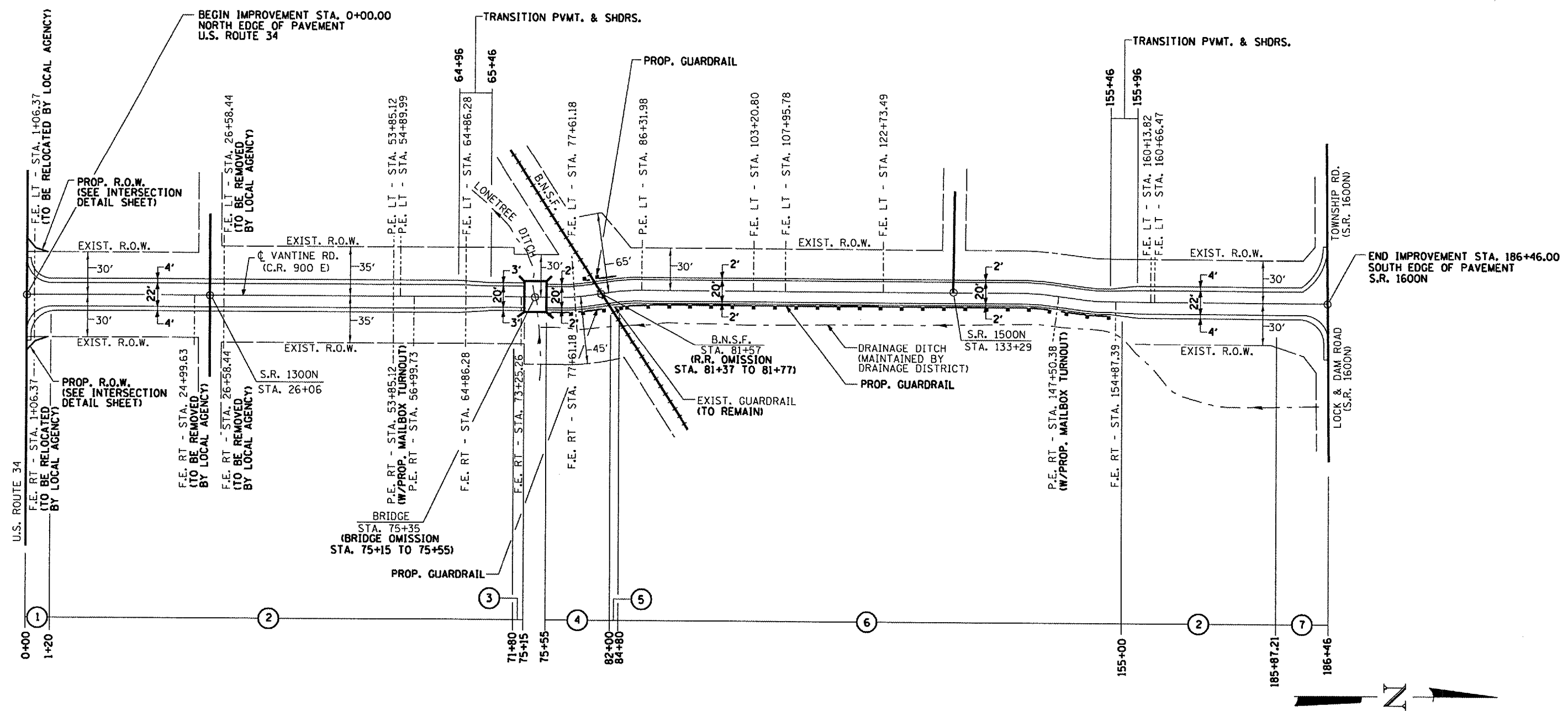

① = TYPICAL SECTION NO.

REVISIONS		NAME	DATE
NO.	DESCRIPTION		

ILLINOIS DEPARTMENT OF TRANSPORTATION  
F.A.S. 418 (VANTINE ROAD)

PROJECT CENTERLINE PLAN

SCALE: N/A  
DATE: 1-5-07

DRAWN BY CGF  
CHECKED BY JJM

F.A.S. RTE.	SECTION	COUNTY	TOTAL SHEETS	SHEET NO.
418	04-00069-00-R5	HENDERSON	15	11
STA.		TO STA.		
FED. ROAD DIST. NO.	ILLINOIS	FED. AID PROJECT		
CONTRACT NO. 89366				

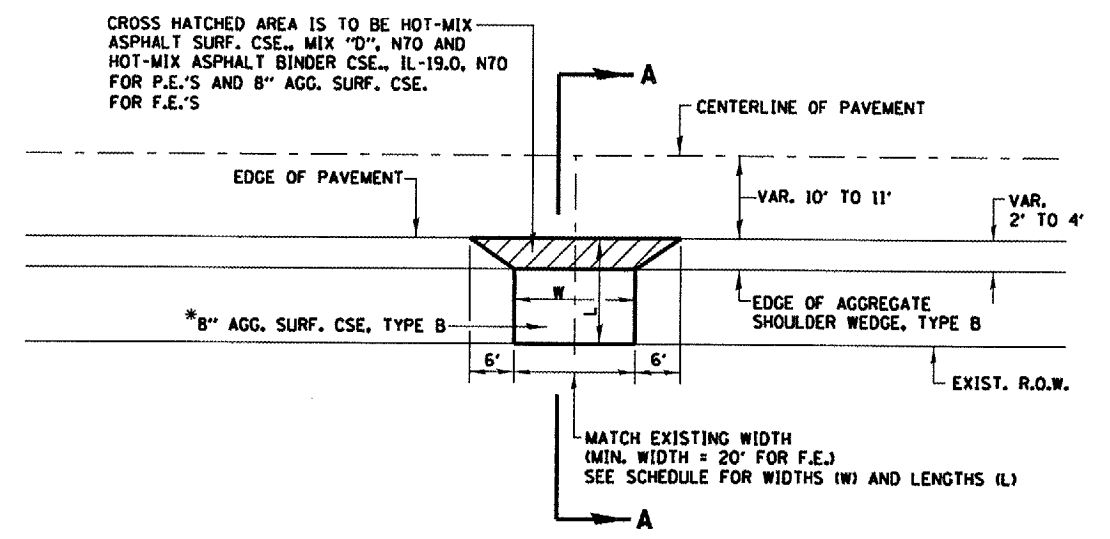

\* P.E. LT STATION 53+85.12 - 6" AGG. BSE CSE, TYPE B WITH 2" HOT-MIX ASPHALT SURF. CSE., MIX "D", N70 (AGG. BSE. CSE., TYPE B SHALL BE PAID FOR AS AGG. SURF. CSE., TYPE B)

TYPICAL PLAN DETAIL OF PRIVATE AND FIELD ENTRANCES

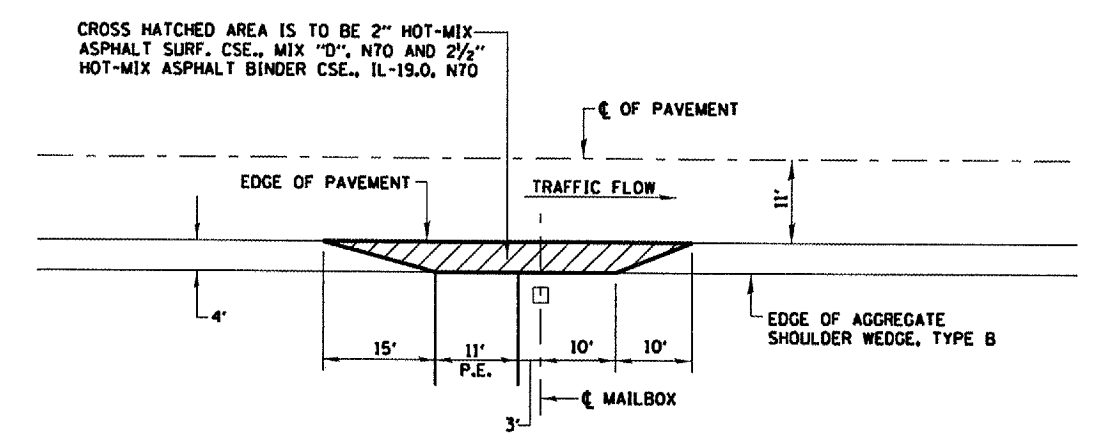

NOTE: MAILBOXES SHALL BE MOUNTED SUCH THAT THE FACE OF THE MAILBOX IS 6" TO 12" AND THE POST A MINIMUM OF 24" FROM THE EDGE OF THE TURNOUT SURFACING.

TYPICAL PLAN DETAIL OF MAILBOX TURNOUT

P.E. RT. STA. 53+85.12

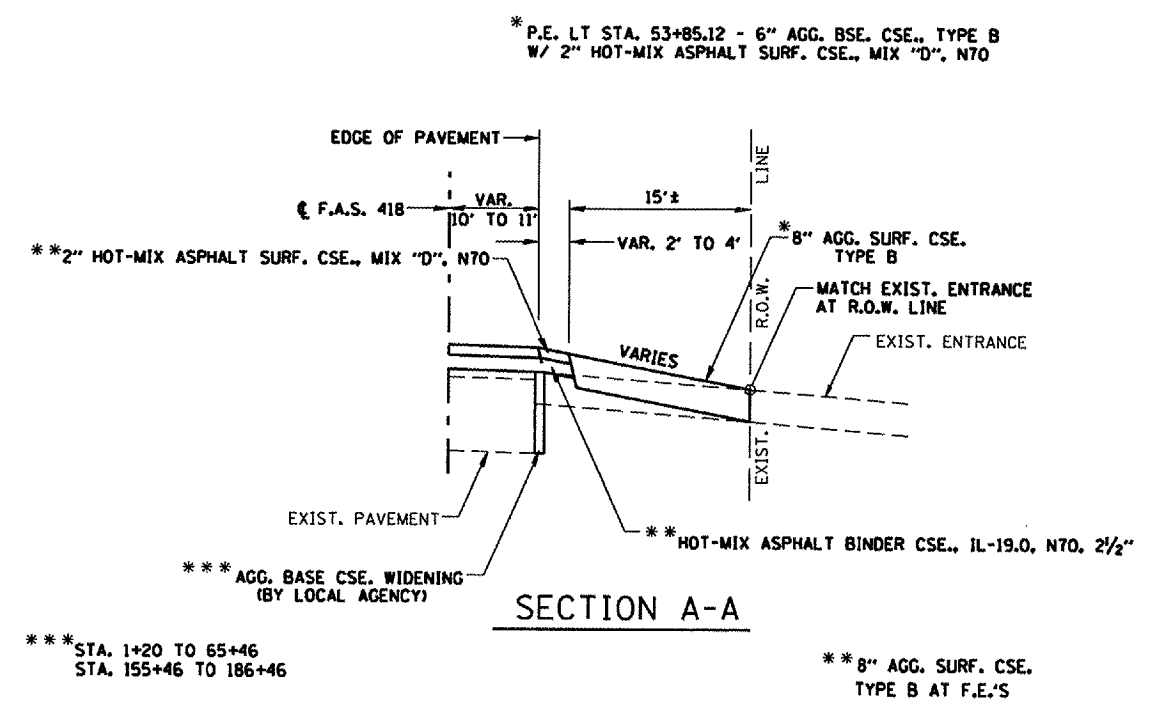

\*\*\* STA. 1+20 TO 65+46  
STA. 155+46 TO 186+46

\*\* 8" AGG. SURF. CSE. TYPE B AT F.E.'S

TYPICAL DETAIL OF PRIVATE AND FIELD ENTRANCES

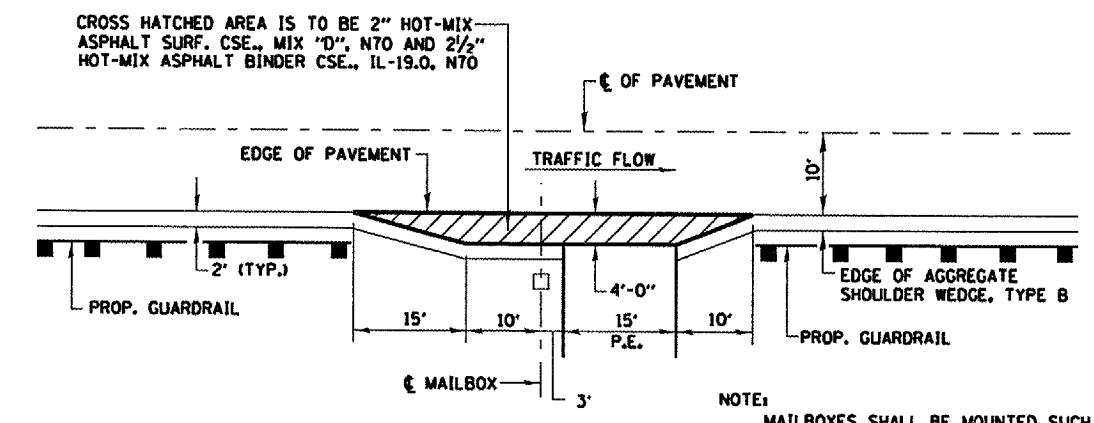

NOTE: MAILBOXES SHALL BE MOUNTED SUCH THAT THE FACE OF THE MAILBOX IS 6" TO 12" AND THE POST A MINIMUM OF 24" FROM THE EDGE OF THE TURNOUT SURFACING.

TYPICAL PLAN DETAIL OF MAILBOX TURNOUT

P.E. RT. STA. 147+50.38

REVISIONS	
NAME	DATE

ILLINOIS DEPARTMENT OF TRANSPORTATION  
F.A.S. 418 (VANTINE ROAD)

ENTRANCE & MAILBOX TURNOUT  
DETAILS

SCALE: N/A  
DATE: 1-5-07

DRAWN BY CGF  
CHECKED BY JMM

F.A.S. RTE.	SECTION	COUNTY	TOTAL SHEETS	SHEET NO.
418	04-00069-00-RS	HENDERSON	15	12
STA.		TO STA.		
FED. ROAD DIST. NO.		ILLINOIS FED. AID PROJECT		
CONTRACT NO. 89366				

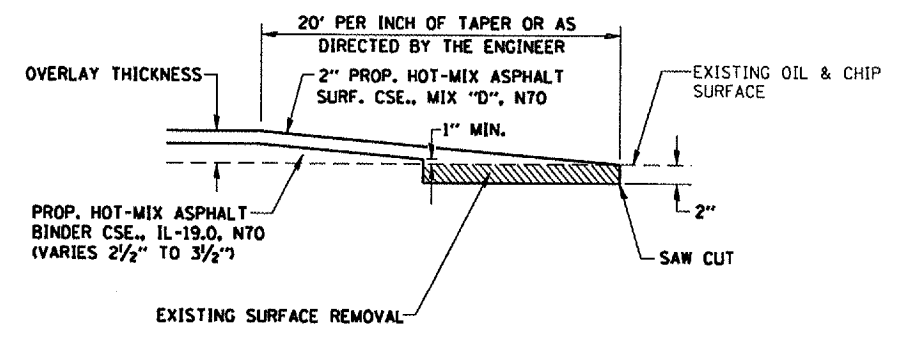

ELEVATION

LOCATION	BEGIN	END	OVERLAY THICKNESS
S.R. 1300N (W. LEG) - STA. 26+06	11' LT.	101' LT.	4 1/2"
S.R. 1300N (E. LEG) - STA. 26+06	11' RT.	101' RT.	4 1/2"
S.R. 1500N - STA. 133+29	10' LT.	120' LT.	5 1/2"

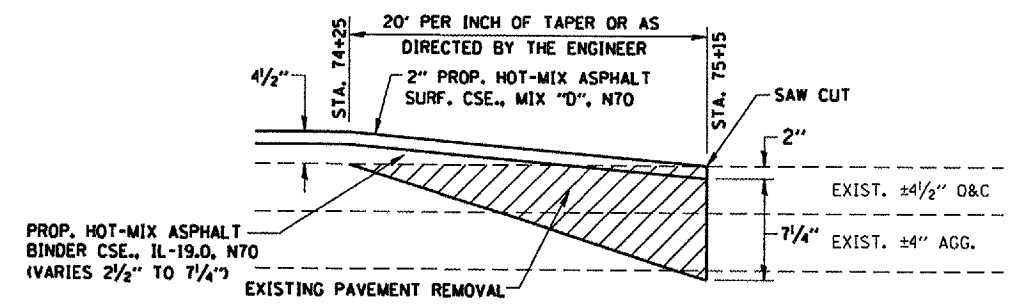

ELEVATION (S. OF BRIDGE)

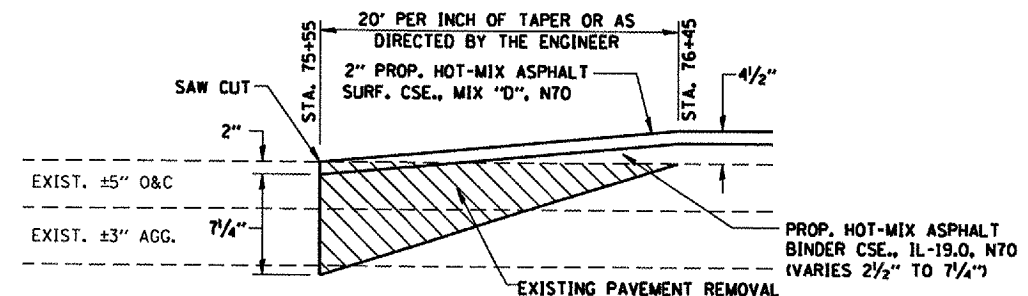

ELEVATION (N. OF BRIDGE)

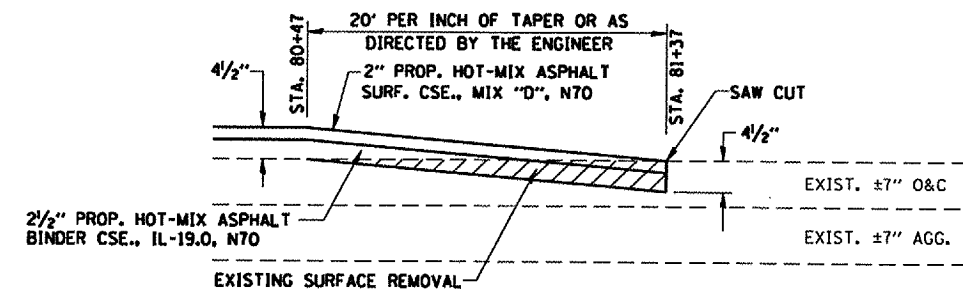

ELEVATION (S. OF R.R. TRACKS)

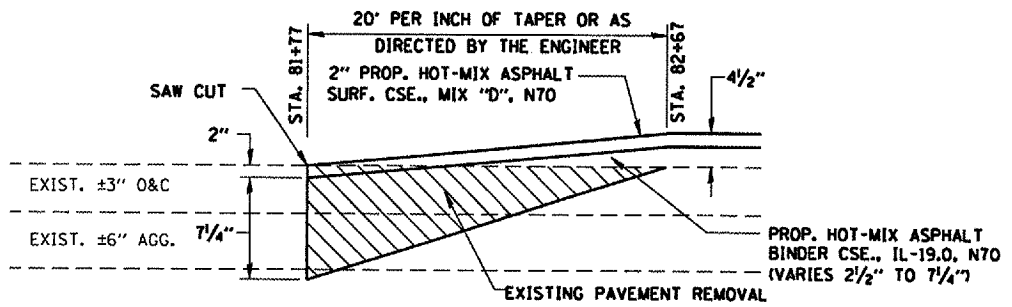

ELEVATION (N. OF R.R. TRACKS)

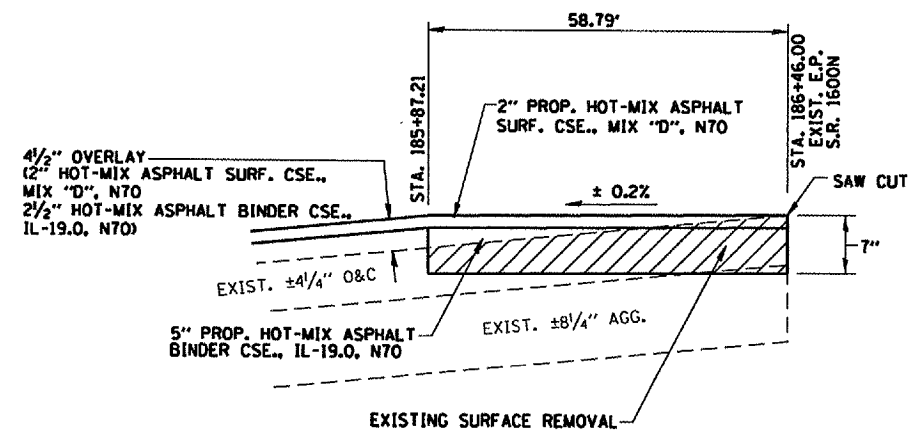

ELEVATION (S.R. 1600N)

REVISIONS	
NAME	DATE

ILLINOIS DEPARTMENT OF TRANSPORTATION  
F.A.S. 418 (VANTINE ROAD)

BUTT JOINT DETAILS

SCALE: N/A  
DATE: 1-5-07  
DRAWN BY: CGF  
CHECKED BY: JJM

F.A.S. RTE.	SECTION	COUNTY	TOTAL SHEETS	SHEET NO.
418	04-00069-00-RS	HENDERSON	15	13
STA.		TO STA.		
FED. ROAD DIST. NO.	ILLINOIS	FED. AID PROJECT		
CONTRACT NO. 89366				

SIDEROAD	R1	R2
1300N	25'(SW) 30'(NE)	35'(NW) 25'(SE)

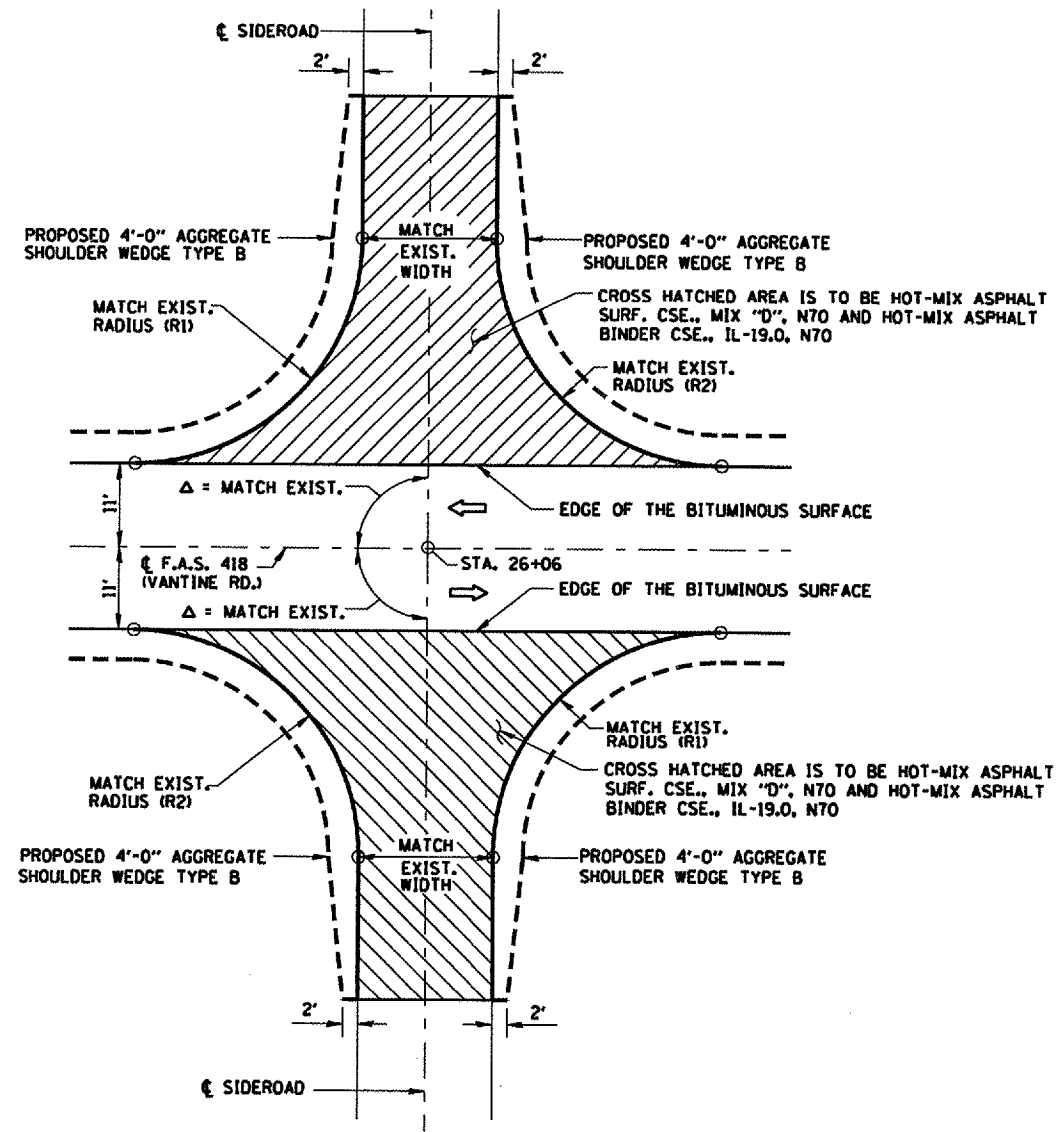

PLAN  
S.R. 1300N

SIDEROAD	R1	R2
1500N	40'(SW) 70'(NW)	70'(NW)

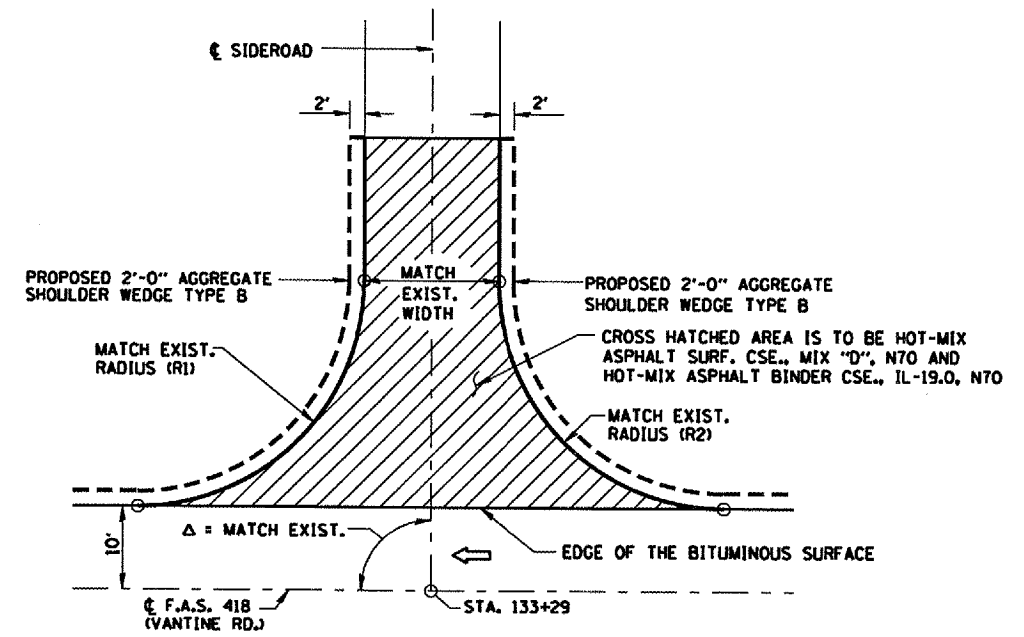

PLAN  
S.R. 1500N

REVISIONS	
NAME	DATE

ILLINOIS DEPARTMENT OF TRANSPORTATION  
F.A.S. 418 (VANTINE ROAD)

SIDEROAD DETAILS

SCALE: N/A  
DATE: 1-5-07  
DRAWN BY: CGF  
CHECKED BY: JJM

F.A.S. RTE.	SECTION	COUNTY	TOTAL SHEETS	SHEET NO.
418	04-00069-00-RS	HENDERSON	15	14
STA. N/A		TO STA. N/A		
FED. ROAD DIST. NO.	ILLINOIS	FED. AID PROJECT		
CONTRACT NO. 89366				



STA. 186+46.00 (C VANTINE ROAD) =  
 STA. 200+00.00 (SOUTH E.O.P. S.R. 1600N)  
 ELEV. 100.44

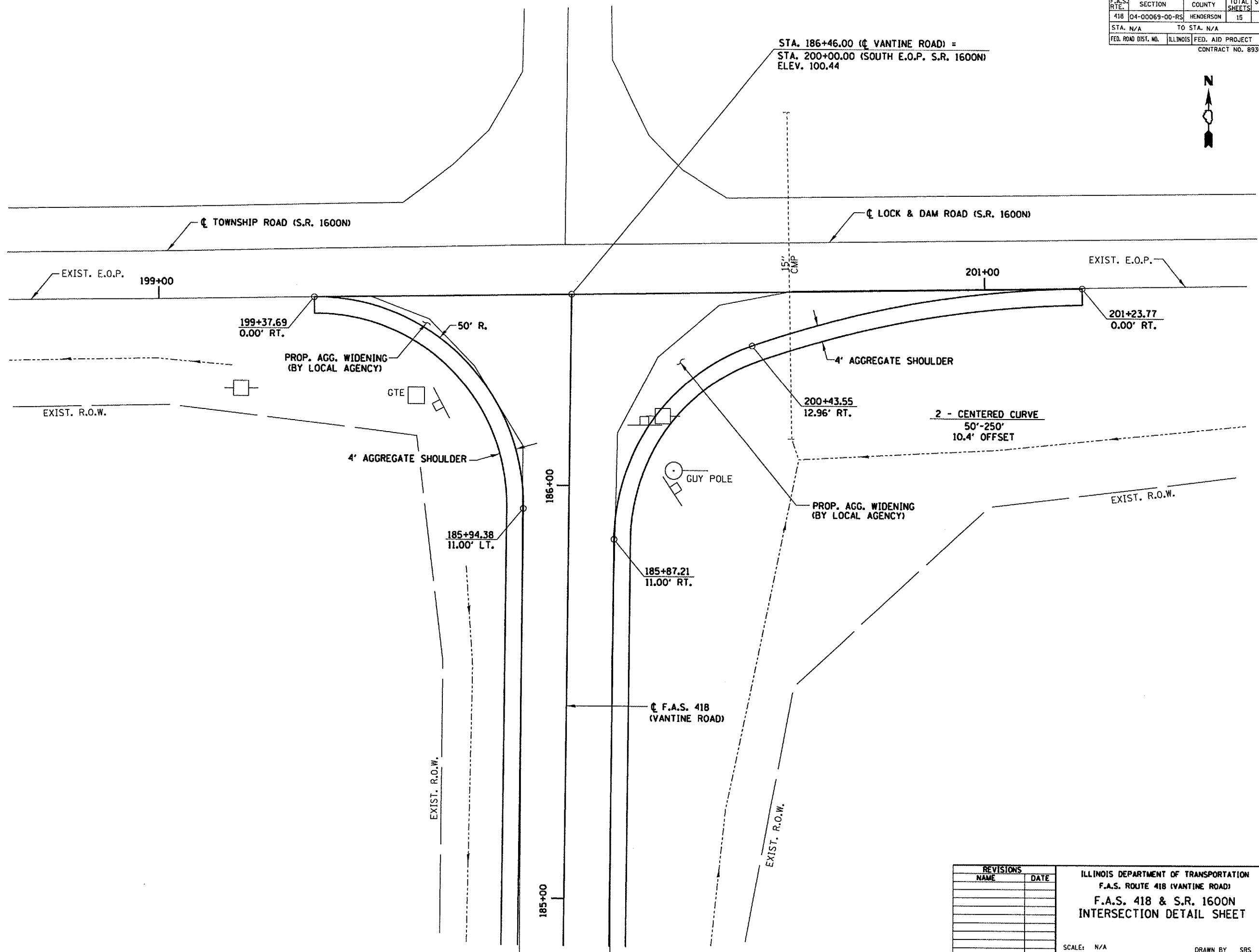

REVISIONS	
NAME	DATE

ILLINOIS DEPARTMENT OF TRANSPORTATION  
 F.A.S. ROUTE 418 (VANTINE ROAD)  
 F.A.S. 418 & S.R. 1600N  
 INTERSECTION DETAIL SHEET

SCALE: N/A  
 DATE: 1-5-07  
 DRAWN BY: SRS  
 CHECKED BY: JJM



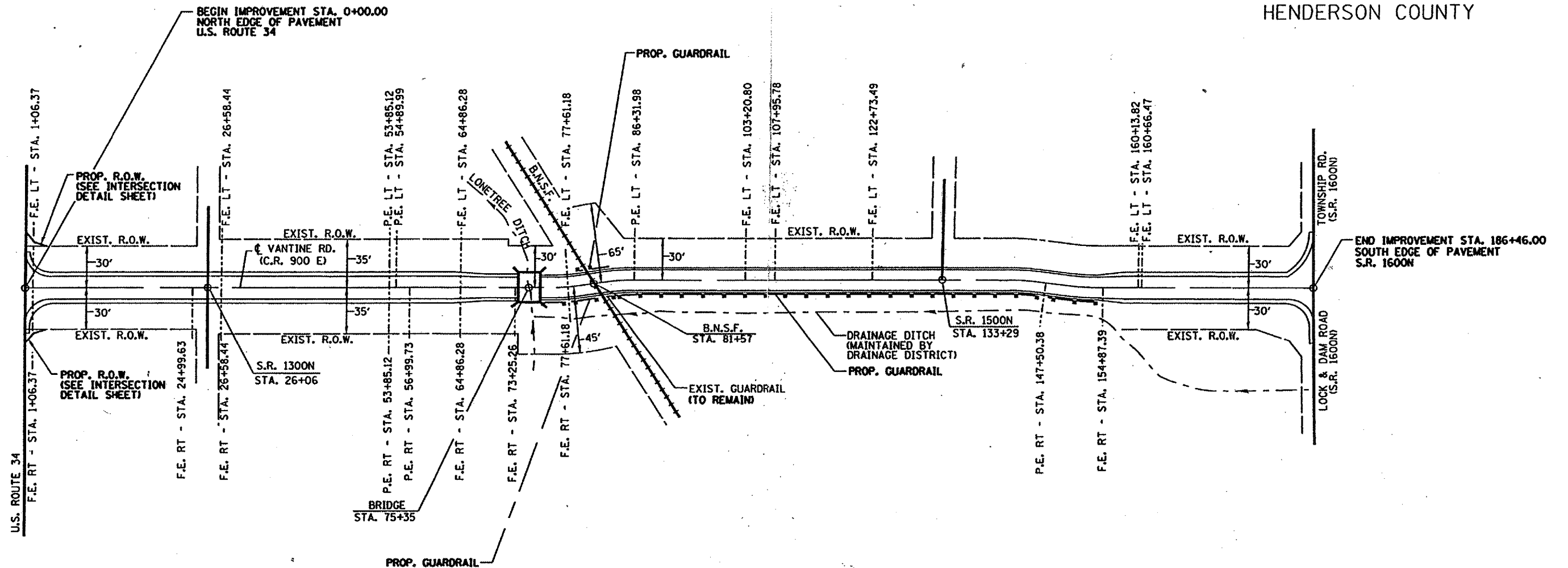

### STORM WATER POLLUTION PREVENTION PLAN

#### DESCRIPTION OF INTENDED SEQUENCE FOR MAJOR CONSTRUCTION ACTIVITIES:

1. GRADE THE EXISTING FRONT SLOPES.
2. NECESSARY EMBANKMENT WILL BE PLACED ALONG THE ENTIRE LENGTH OF THE JOB FOR THE PROPOSED ROADWAY.
3. PLACEMENT, MAINTENANCE, REMOVAL AND PROPER CLEAN-UP OF TEMPORARY EROSION CONTROL ITEMS, SUCH AS TEMPORARY SEEDING AND OTHER MISCELLANEOUS EROSION CONTROL MEASURES, IF NECESSARY, AS DIRECTED BY THE RESIDENT ENGINEER.
4. PLACEMENT OF PERMANENT EROSION CONTROL ITEMS, INCLUDING RIPRAP AND SEEDING.
5. FINAL GRADING AND OTHER MISCELLANEOUS ITEMS.

**NOTES:** ALL TEMPORARY EROSION CONTROL ITEMS, IF NECESSARY, WILL BE HANDLED BY THE LOCAL AGENCY AS DIRECTED BY THE ENGINEER.

ALL PERMANENT EROSION CONTROL ITEMS WILL BE HANDLED BY THE LOCAL AGENCY AS DIRECTED BY THE ENGINEER.

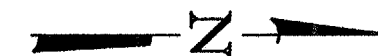

LENGTH OF OVERLAY = 18,646 FT. (3.53 MILES)  
 (NOT TO SCALE)

