

SEC. 26, T.24 N., R.2 E., 3rd P.M.
MCLEAN COUNTY, ILLINOIS

F.A.U. SECTION COUNTY TOTAL SHEETS SHEET NO.
6352 02-00218-00-SP MCLEAN 35 14
STA. TO STA.
ILLINOIS FED. AID PROJECT

CONTRACT NO. 91363

INLET FILTERS = 2 EACH
PLACED AT ALL DRAINAGE STRUCTURES WITHIN PAVED AREAS WITH OPEN LIDS OR GRATES.

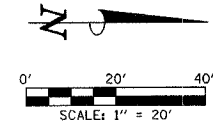

- LEGEND**
- PROPOSED PORTLAND CEMENT CONCRETE PAVEMENT, 8" (JOINTED)
 - PROPOSED INCIDENTAL HOT-MIX ASPHALT SURFACING, 8"
 - PROPOSED PCC DRIVEWAY PAVEMENT 8" FOR C.E.
 - DETECTABLE WARNINGS (SEE DETAIL)

**BEGIN IMPROVEMENTS
TOWANDA AVE.
STA. 395+53.26
(MATCH EXISTING)**

MATCH LINE STA. 398+50

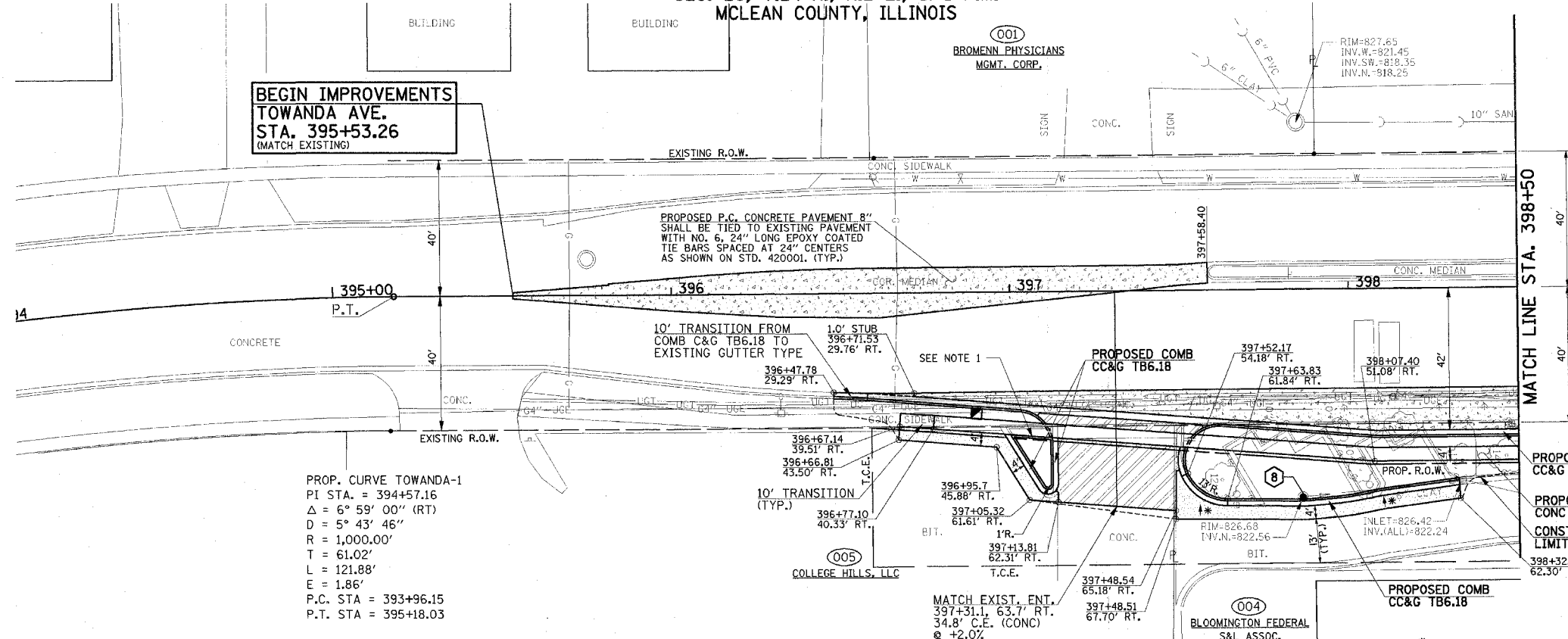

PROP. CURVE TOWANDA-1
PI STA. = 394+57.16
Δ = 6° 59' 00" (RT)
D = 5° 43' 46"
R = 1,000.00'
T = 61.02'
L = 121.88'
E = 1.86'
P.C. STA = 393+96.15
P.T. STA = 395+18.03

NOTES:
1. CONSTRUCT CONCRETE CURB MONOLITHIC WITH SIDEWALK, FROM STA. 397+01.00, 42.89' RT. TO 397+11.63, 43.77' RT. CURB HEIGHT SHALL BE 6" AND BE 6" IN WIDTH. THE COST OF THE CURB SHALL BE INCLUDED IN THE CONTRACT UNIT PRICE FOR P.C. CONCRETE SIDEWALK 6".

STORM SEWER STRUCTURE SCHEDULE

STR. NO.	STRUCTURE TYPE	OFF-SET SIDE	STA. OF C/L 2 FT. OPENING	OFFSET OF C/L 2 FT. OPENING	STA. OF C/L STR.	OFFSET OF C/L STR.	EX. T/O FRAME/GRATE ELEV.	PR. T/O FRAME/GRATE ELEV.	PR. T/O FLAT SLAB TOP ELEV.	INVERT IN ELEV.	U.S. STR. NO.	INVERT OUT ELEV.	D.S. STR. NO.
8*	MAN ADJ NEW T15F&L	RT	397+86.13	61.49	---	---	826.68	827.09	---	---	---	822.56	10A

*FIELD VERIFY LOCATION AND ELEVATIONS.

**END IMPROVEMENTS
TOWANDA AVE.
STA. 404+16.55
(MATCH EXISTING)**

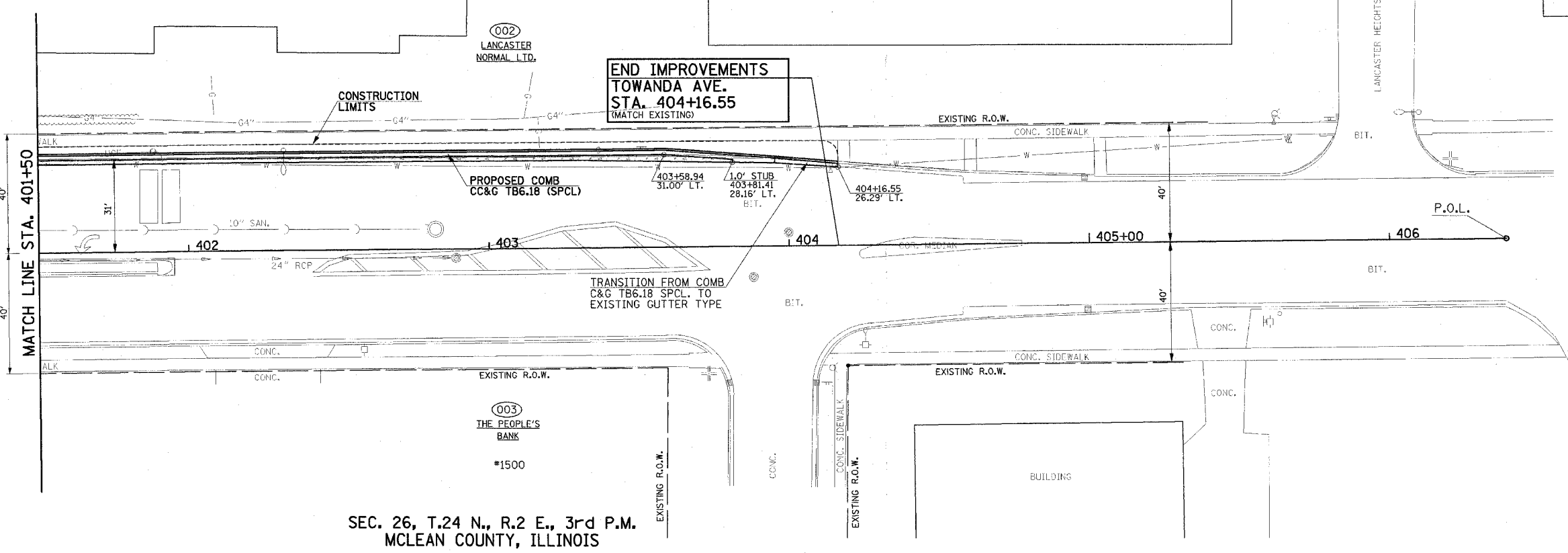

SEE REMOVALS/RELOCATIONS PLAN FOR ADDITIONAL INFORMATION

SEE HORIZONTAL ALIGNMENT LAYOUT AND CONTROL SHEET AND INTERSECTION DETAILS FOR ADDITIONAL INFORMATION.

SEE SCHEDULE OF QUANTITIES FOR TYPICAL SECTION PAVEMENT PAY ITEMS AND THEIR LOCATIONS.

SEE THE MAINTENANCE OF TRAFFIC PLAN FOR SUGGESTED CONSTRUCTION SEQUENCES.

ILLINOIS DEPARTMENT OF TRANSPORTATION

PLAN - TOWANDA AVENUE

SCALE: 1"=20'
DATE: 3-07
DRAWN BY: S.M.W.
CHECKED BY: J.T.P.