

F.A.U. SECTION	COUNTY	TOTAL SHEETS	SHEET NO.
02-00218-00-SP	MCLEAN	35	15
STA.	TO STA.		
ILLINOIS FED. AID PROJECT			

CONTRACT NO. 91363

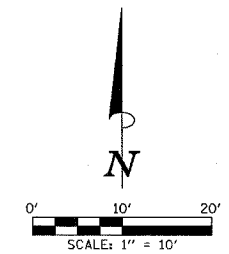

**NOTES:**

1. SPOT ELEVATIONS AT RADIUS RETURNS ARE PROVIDED AT 10' INTERVALS MEASURED ALONG RADIUS, STARTING AT POINT (A) AND ENDING AT POINT (B).
2. SOME OF THE 10' INTERVALS ARE NOT SHOWN DUE TO VARIOUS POINTS OF INTEREST BEING NEARBY, SUCH AS HIGH POINTS, LOW POINTS, AND/OR SIDEWALK RAMPS.
3. PROPOSED TRAFFIC SIGNAL EQUIPMENT IS SHOWN FOR INFORMATION PURPOSES ONLY, SEE TRAFFIC SIGNAL PLANS FOR ACTUAL EQUIPMENT LOCATIONS AND ADDITIONAL INFORMATION.

**LEGEND**

- 
- 
- 
- 
- 
- 

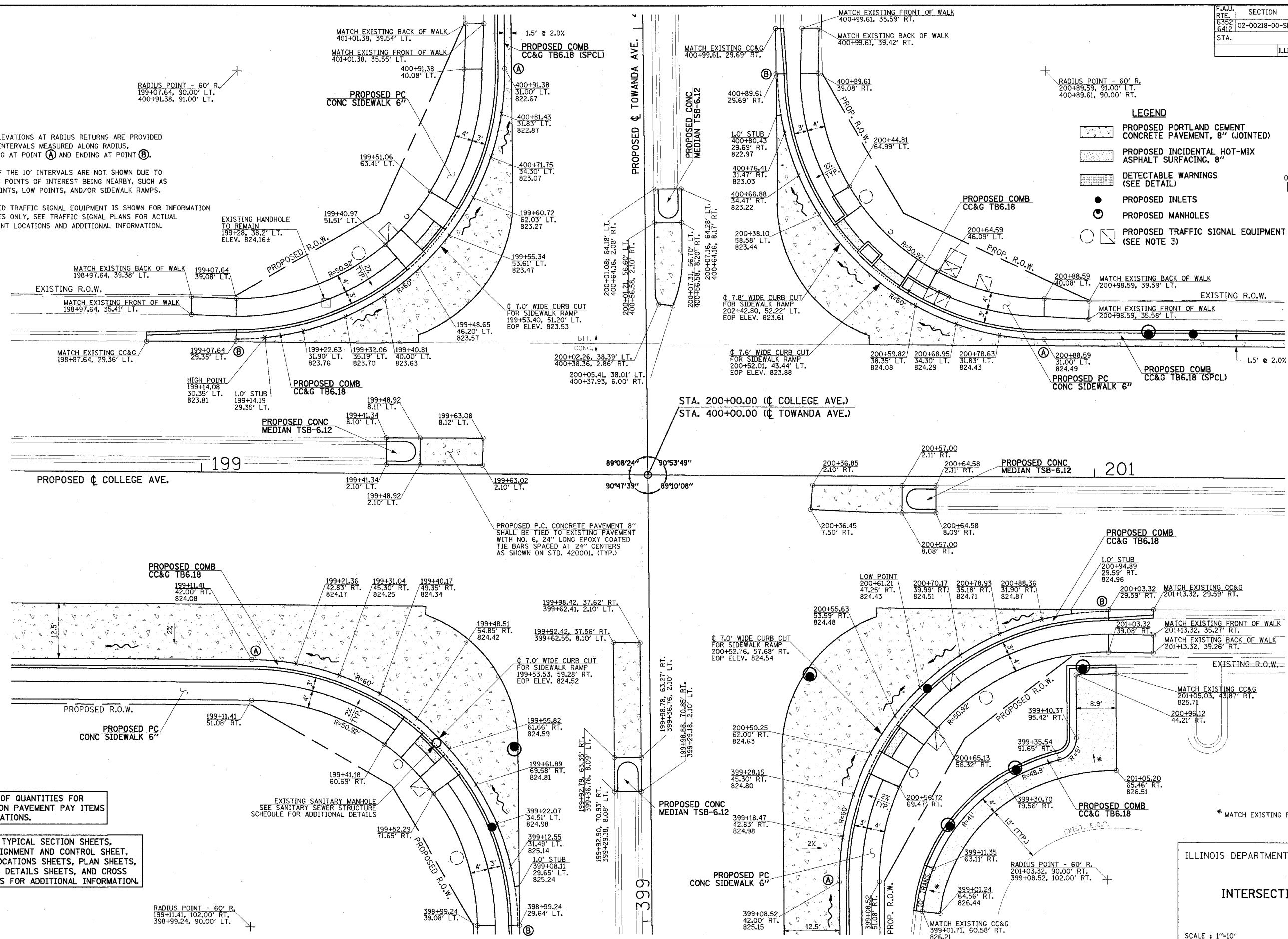

SEE SCHEDULE OF QUANTITIES FOR TYPICAL SECTION PAVEMENT PAY ITEMS AND THEIR LOCATIONS.

SEE PROPOSED TYPICAL SECTION SHEETS, HORIZONTAL ALIGNMENT AND CONTROL SHEET, REMOVALS/RELOCATIONS SHEETS, PLAN SHEETS, MISCELLANEOUS DETAILS SHEETS, AND CROSS SECTION SHEETS FOR ADDITIONAL INFORMATION.

ILLINOIS DEPARTMENT OF TRANSPORTATION

**INTERSECTION DETAIL**

DATE: 3-07  
DRAWN BY: S.M.W.  
CHECKED BY: J.T.P.

SCALE: 1"=10'