

BILL OF MATERIALS

ITEM	UNIT	QUANTITY
SERVICE INSTALLATION, TYPE A	EACH	1
CONDUIT IN TRENCH, 2" DIA., GALVANIZED STEEL	FOOT	122
CONDUIT IN TRENCH, 2" DIA., PVC	FOOT	19
CONDUIT IN TRENCH, 2 1/2" DIA., PVC	FOOT	69
CONDUIT IN TRENCH, 5" DIA., PVC	FOOT	10
CONDUIT PUSHED, 2" DIA., GALVANIZED STEEL	FOOT	346
CONDUIT PUSHED, 4" DIA., PVC	FOOT	232
CONDUIT PUSHED, 5" DIA., PVC	FOOT	96
HANDHOLE, PORTLAND CEMENT CONCRETE	EACH	3
DOUBLE HANDHOLE, PORTLAND CEMENT CONCRETE	EACH	1
ELECTRIC CABLE IN CONDUIT, 600V (XLP-TYPE USE) 1/C NO. 6	FOOT	1,350
TRENCH AND BACKFILL WITH SCREENINGS OR SAND	FOOT	220
LUMINAIRE, SODIUM VAPOR, HORIZONTAL MOUNT, PHOTO-CELL CONTROL, 250 WATT	EACH	4
ELECTRIC CABLE IN CONDUIT, SERVICE, NO. 6 2C	FOOT	80
FULL-ACTUATED CONTROLLER AND TYPE IV CABINET, SPECIAL	EACH	1
ELECTRIC CABLE IN CONDUIT, SIGNAL, NO. 14 2C	FOOT	1,250
ELECTRIC CABLE IN CONDUIT, SIGNAL, NO. 14 3C	FOOT	1,325
ELECTRIC CABLE IN CONDUIT, SIGNAL, NO. 14 5C	FOOT	3,175
ELECTRIC CABLE IN CONDUIT, SIGNAL, NO. 14 7C	FOOT	700
ELECTRIC CABLE IN CONDUIT, GROUNDING, NO. 6 1C	FOOT	600
TRAFFIC SIGNAL POST, GALVANIZED STEEL 16 FT.	EACH	2
PEDESTRIAN PUSH-BUTTON POST, GALVANIZED STEEL, TYPE II	EACH	2
STEEL COMBINATION MAST ARM ASSEMBLY AND POLE 42 FT.	EACH	1
STEEL COMBINATION MAST ARM ASSEMBLY AND POLE 48 FT.	EACH	3
CONCRETE FOUNDATION, TYPE A	FOOT	6
CONCRETE FOUNDATION, TYPE D	FOOT	4
CONCRETE FOUNDATION, TYPE E 36-INCH DIAMETER	FOOT	52
SIGNAL HEAD, POLYCARBONATE, LED, 1-FACE, 3-SECTION, BRACKET MOUNTED	EACH	4
SIGNAL HEAD, POLYCARBONATE, LED, 1-FACE, 3-SECTION, MAST ARM MOUNTED	EACH	12
SIGNAL HEAD, POLYCARBONATE, LED, 1-FACE, 5-SECTION, BRACKET MOUNTED	EACH	2
SIGNAL HEAD, POLYCARBONATE, LED, 1-FACE, 5-SECTION, MAST ARM MOUNTED	EACH	2
PEDESTRIAN SIGNAL HEAD, POLYCARBONATE, LED, 1-FACE, BRACKET MOUNTED	EACH	8
TRAFFIC SIGNAL BACKPLATE, LOUVERED, FORMED PLASTIC	EACH	20
PEDESTRIAN PUSH-BUTTON	EACH	8
WIDE AREA VIDEO DETECTION SYSTEM COMPLETE	EACH	1
UNINTERRUPTIBLE POWER SUPPLY	EACH	1

** CONDUIT USED FOR POWER AND LIGHTING.

TRAFFIC SIGNAL LEGEND

- CONDUIT PUSHED (SIGNALS)
 - CONDUIT IN TRENCH (SIGNALS)
 - CONDUIT PUSHED (LIGHTING)
 - CONDUIT IN TRENCH (LIGHTING)
 - STEEL COMBINATION MAST ARM ASSEMBLY AND POLE
 - TRAFFIC SIGNAL POST
 - SIGNAL HEAD WITH BACKPLATE
 - CONTROLLER CABINET
 - CONCRETE HANDHOLE
 - CONCRETE DOUBLE HANDHOLE
 - SERVICE INSTALLATION
 - PEDESTRIAN SIGNAL HEAD
 - PEDESTRIAN PUSH-BUTTON
 - LUMINAIRE, PHOTO-CELL CONTROL
 - WIDE AREA VIDEO DETECTION UNIT
- CONDUIT LENGTH
 50'-T CONDUIT PUSHED (P) OR CONDUIT IN TRENCH (T)
 2" GS GALVANIZED STEEL (IF NOTED)
 ○ CONDUIT SIZE

PHASE DESIGNATION DIAGRAM LEGEND

- ⊕ DUAL ENTRY PHASE * NUMBER REFERS TO ASSOCIATED PHASE
- ⊕ PEDESTRIAN PHASE
- ⊕ RIGHT TURN OVERLAP
A=2+3-26
D=8+1-8C

PHASE DESIGNATION DIAGRAM
NO SCALE

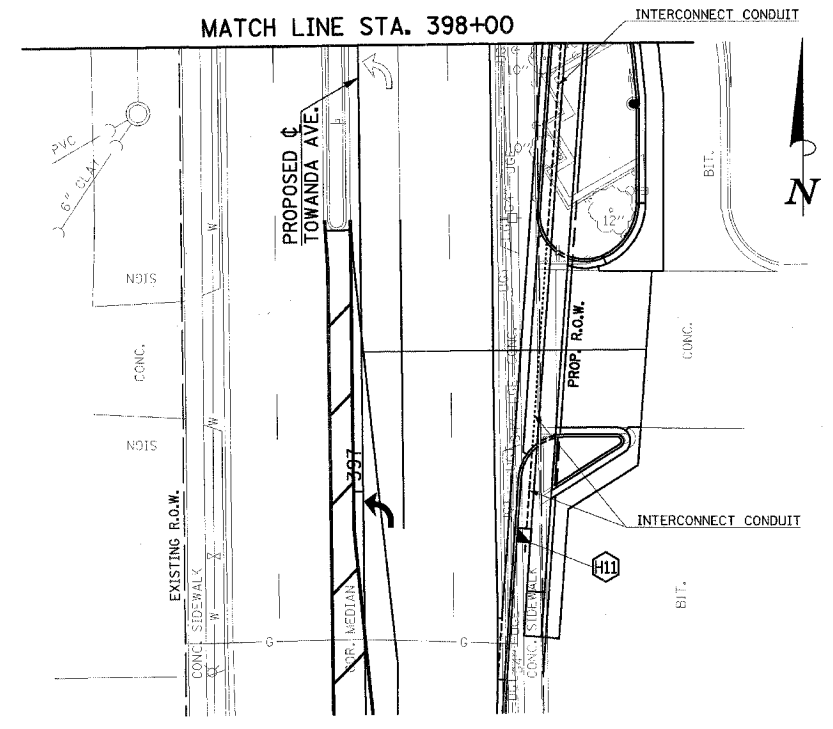
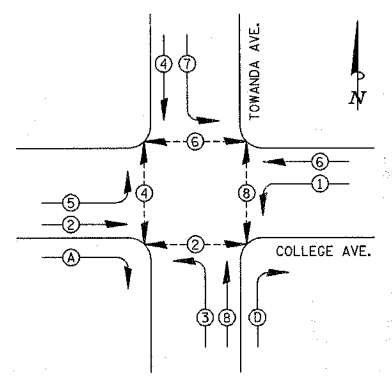

SEE INTERCONNECT PLAN FOR LOCATIONS AND DETAILS OF THE PROPOSED INTERCONNECT SYSTEM.

ILLINOIS DEPARTMENT OF TRANSPORTATION

TRAFFIC SIGNAL PLANS
TRAFFIC SIGNAL LAYOUT/
PHASE DESIGNATION DIAGRAM/
BILL OF MATERIALS

DATE : 3-07
DRAWN BY : S.M.W.
CHECKED BY : J.T.P.

SCALE : 1"=20'