

RTE.	PROJECT NO.	COUNTY	TOTAL SHEETS	SHEET NO.
05-00218-00-PV	VERMILION	57	27	
STA. 00+00.00 TO STA. 335+39.18				
*F.A.P. 729 & F.A.U. 6999 CONTRACT NO. 91367				

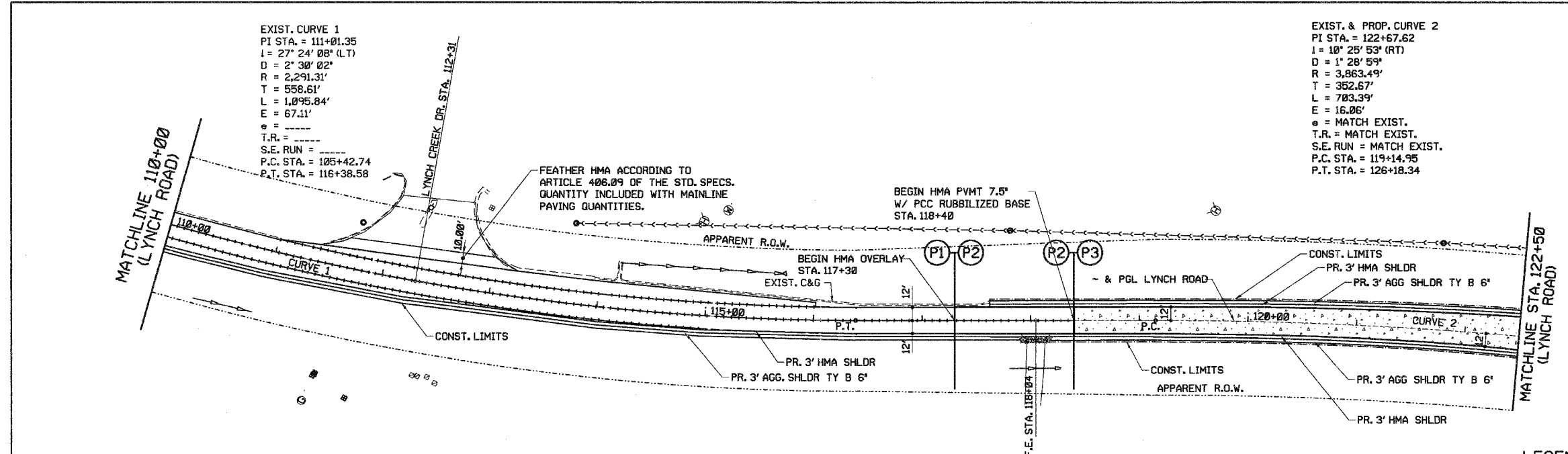

EXIST. CURVE 1  
 PI STA. = 111+01.35  
 I = 27° 24' 08" (LT)  
 D = 2' 30" 02"  
 R = 2,291.31'  
 T = 558.61'  
 L = 1,095.84'  
 E = 67.11'  
 e = ----  
 T.R. = ----  
 S.E. RUN = ----  
 P.C. STA. = 105+42.74  
 P.T. STA. = 116+38.58

EXIST. & PROP. CURVE 2  
 PI STA. = 122+67.62  
 I = 10° 25' 53" (RT)  
 D = 1' 28' 59"  
 R = 3,863.49'  
 T = 352.67'  
 L = 703.39'  
 E = 16.06'  
 e = MATCH EXIST.  
 T.R. = MATCH EXIST.  
 S.E. RUN = MATCH EXIST.  
 P.C. STA. = 119+14.95  
 P.T. STA. = 126+18.34

**LEGEND**

- HMA FULL DEPTH PVMT 7 1/2" W/ PCC RUBBLIZED BASE
- PCC BASE COURSE 10" W/ AGG. BASE COURSE 4"
- HMA BASE COURSE 4" W/ AGG. BASE COURSE 4"
- PCC BASE COURSE WIDENING 10" W/ AGG. BASE COURSE 4"
- BASE COURSE WIDENING 4" W/ AGG. BASE COURSE 4"
- CRACK ROUTING & SEALING

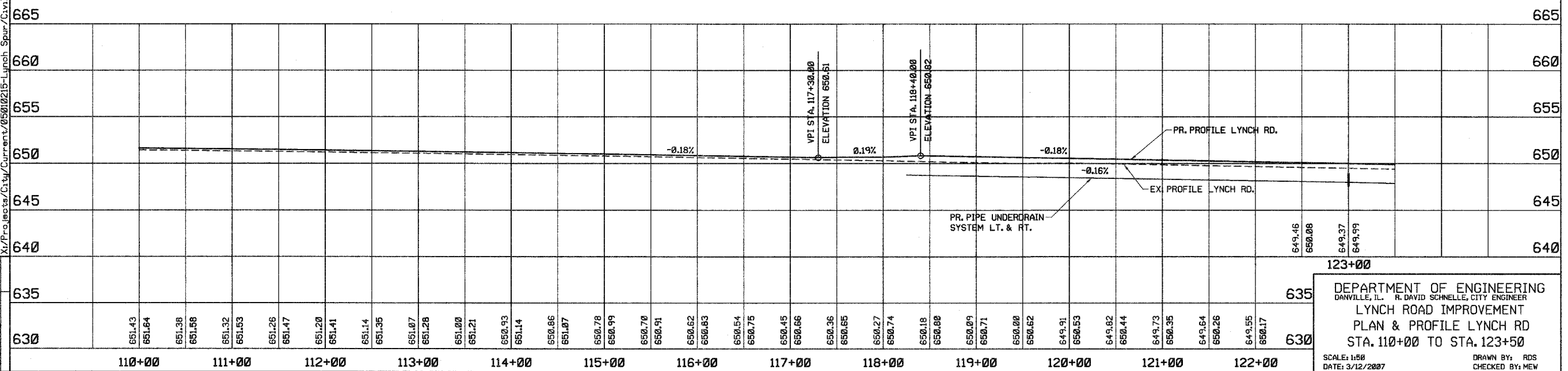

REVISIONS	DATE

123+00

635

630

DEPARTMENT OF ENGINEERING  
 DANVILLE, ILL. R. DAVID SCHNELLE, CITY ENGINEER  
 LYNCH ROAD IMPROVEMENT  
 PLAN & PROFILE LYNCH RD  
 STA. 110+00 TO STA. 123+50

SCALE: 1/8" = 1'-0"  
 DATE: 3/12/2007

DRAWN BY: RDS  
 CHECKED BY: MEW

X:\Projects\Cty\Current\05010215-Lynch\_Spur\C.v1\DGN\PNP002.dgn