

RTE.	PROJECT NO.	COUNTY	TOTAL SHEET NO.
05-00218-00-PV	VERMILION	57	33
STA. 287+00 TO STA. 302+00			
*F.A.P. 729 & F.A.U. 6999 CONTRACT NO. 91367			

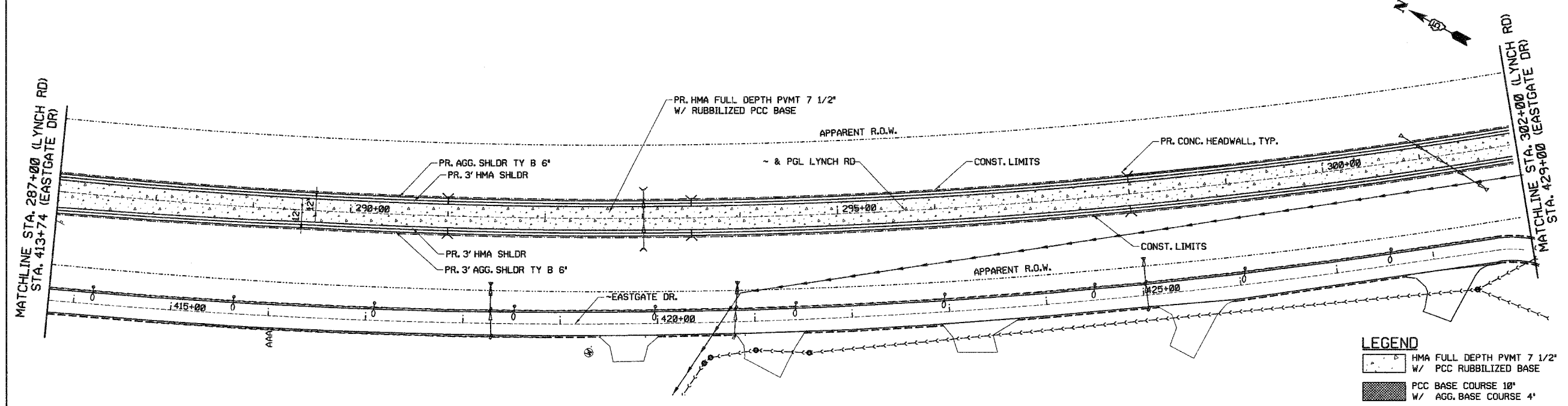

**LEGEND**

- HMA FULL DEPTH PVT 7 1/2' W/ PCC RUBBLIZED BASE
- PCC BASE COURSE 10' W/ AGG. BASE COURSE 4'
- HMA BASE COURSE 4' W/ AGG. BASE COURSE 4'
- PCC BASE COURSE WIDENING 10' W/ AGG. BASE COURSE 4'
- BASE COURSE WIDENING 4' W/ AGG. BASE COURSE 4'
- CRACK ROUTING & SEALING

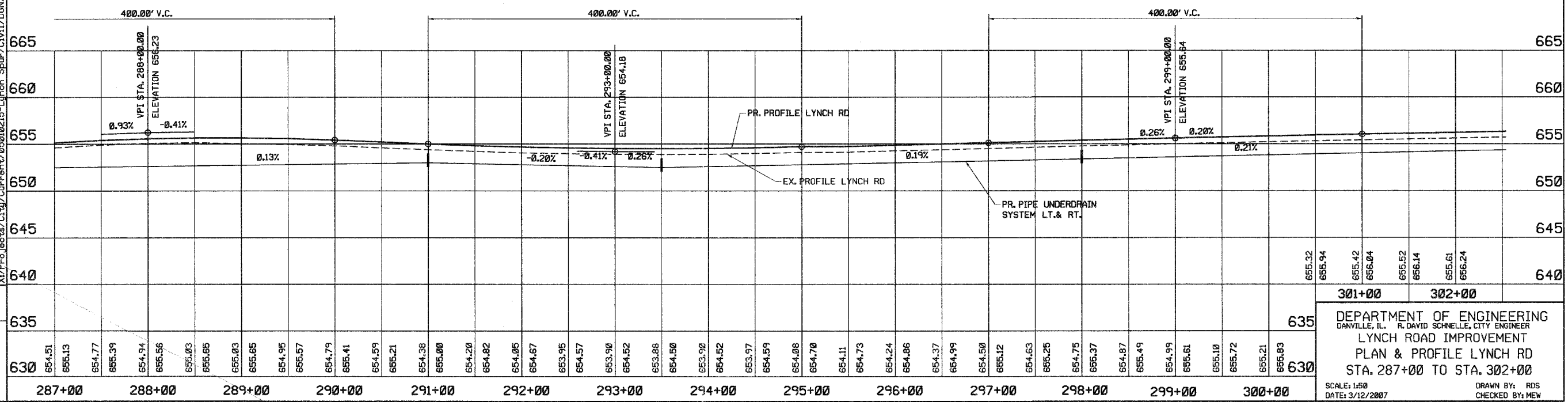

**dam/linets**  
 CITY OF DANVILLE, MISSOURI  
 100 WEST MAIN STREET  
 DANVILLE, MISSOURI 64002

DATE	REVISIONS	NAME																																	
630	631	632	633	634	635	636	637	638	639	640	641	642	643	644	645	646	647	648	649	650	651	652	653	654	655	656	657	658	659	660	661	662	663	664	665

301+00      302+00

DEPARTMENT OF ENGINEERING  
 DANVILLE, ILL.    R. DAVID SCHNELLE, CITY ENGINEER  
 LYNCH ROAD IMPROVEMENT  
 PLAN & PROFILE LYNCH RD  
 STA. 287+00 TO STA. 302+00

SCALE: 1"=50'  
 DATE: 3/12/2007

DRAWN BY: RDS  
 CHECKED BY: MEW