

RTE.	PROJECT NO.	COUNTY	TOTAL SHEETS	SHEET NO.
05-00218-00-PV	VERMILION	57	35	
STA. 00+00.00 TO STA. 335+39.18				
*F.A.P. 729 & F.A.U. 6999 CONTRACT NO. 91367				

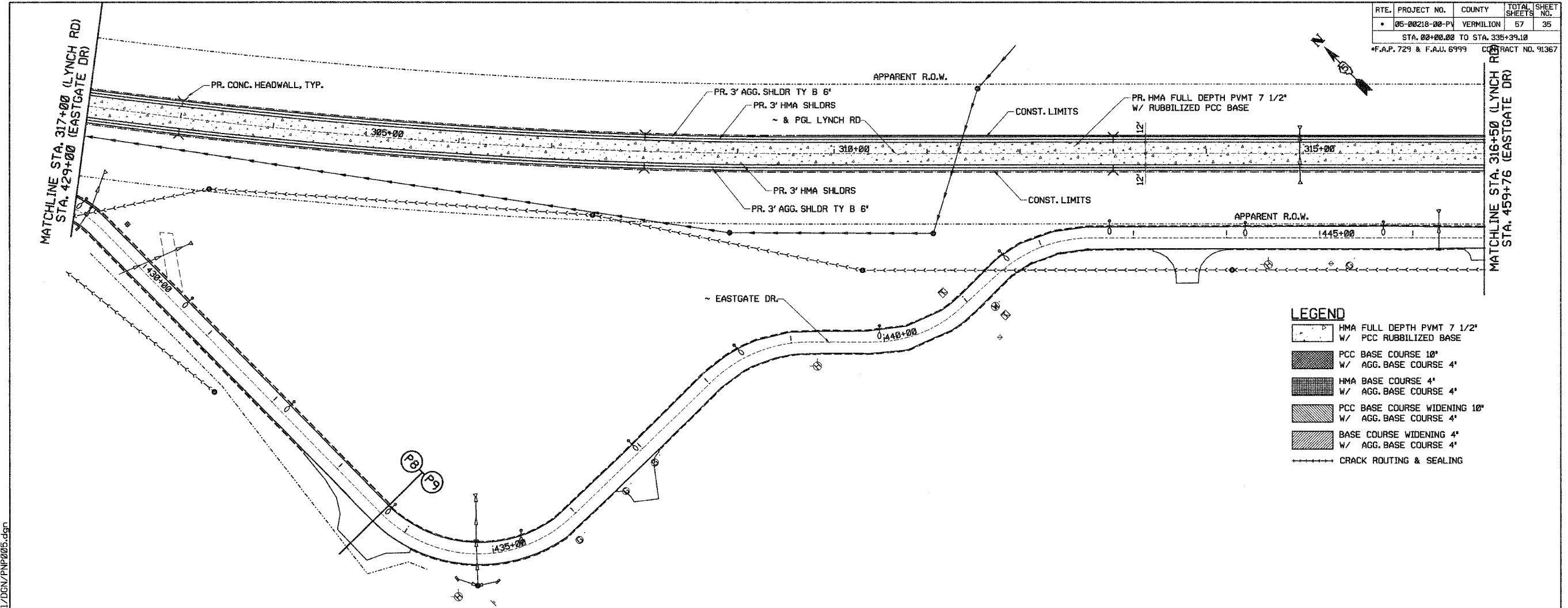

LEGEND

- HMA FULL DEPTH PVMT 7 1/2\"/> W/ PCC RUBBILIZED BASE
- PCC BASE COURSE 10\"/> W/ AGG. BASE COURSE 4\"/>
- HMA BASE COURSE 4\"/> W/ AGG. BASE COURSE 4\"/>
- PCC BASE COURSE WIDENING 10\"/> W/ AGG. BASE COURSE 4\"/>
- BASE COURSE WIDENING 4\"/> W/ AGG. BASE COURSE 4\"/>
- CRACK ROUTING & SEALING

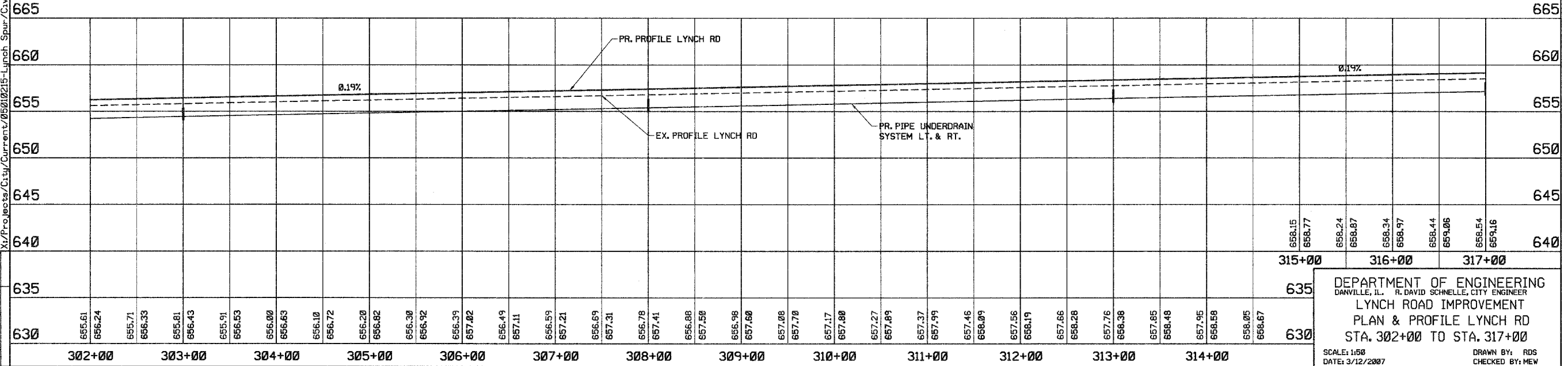

REVISIONS	DATE	NAME
630	655.61	
	656.24	
	655.71	
	656.33	
	655.81	
	656.43	
	655.91	
	656.53	
	656.00	
	656.63	
	656.10	
	656.72	
	656.20	
	656.82	
	656.30	
	656.92	
	656.39	
	657.02	
	656.49	
	657.11	
	656.59	
	657.21	
	656.69	
	657.31	
	656.78	
	657.41	
	656.88	
	657.50	
	656.98	
	657.60	
	657.08	
	657.70	
	657.17	
	657.80	
	657.27	
	657.89	
	657.37	
	657.99	
	657.46	
	658.09	
	657.56	
	658.19	
	657.66	
	658.28	
	657.76	
	658.38	
	657.85	
	658.48	
	657.95	
	658.58	
	658.05	
	658.67	
	658.15	
	658.77	
	658.24	
	658.87	
	658.34	
	658.97	
	658.44	
	659.06	
	658.54	
	659.16	

DEPARTMENT OF ENGINEERING
 DANVILLE, IL. R. DAVID SCHNELLE, CITY ENGINEER
 LYNCH ROAD IMPROVEMENT
 PLAN & PROFILE LYNCH RD
 STA. 302+00 TO STA. 317+00

SCALE: 1:50
 DATE: 3/12/2007
 DRAWN BY: RDS
 CHECKED BY: MEW

X:\Projects\Civil\Current\05010215-Lynch Spur-C.v11\DCN\PNP\005.dgn