

RTE.	PROJECT NO.	COUNTY	TOTAL SHEETS	SHEET NO.
•	05-00218-00-PV	VERMILION	57	39
STA. 00+00.00 TO STA. 335+39.10				
*F.A.P. 729 & F.A.U. 6999 CONTRACT NO. 91367				

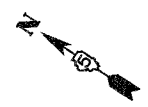

EXIST. & PROP. CURVE 4
 PI STA. = 326+85.73
 I = 14° 55' 06" (RT)
 D = 1' 00' 49"
 R = 5,652.26'
 T = 740.03'
 L = 1,471.69'
 E = 48.24'
 e = 0.02 & MATCH EXIST.
 T.R. = MATCH EXIST.
 S.E. RUN = MATCH EXIST.
 P.C. STA. = 320+67.40
 P.T. STA. = 335+39.10

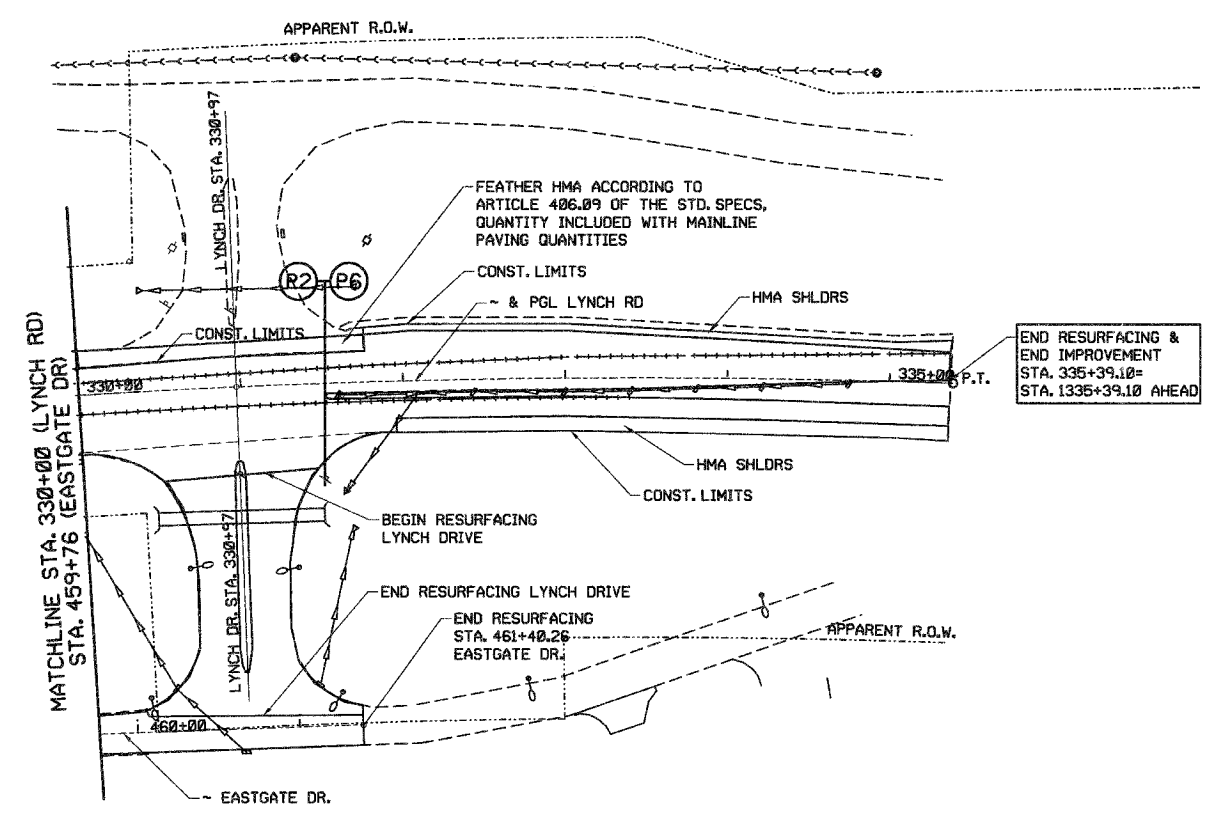

- LEGEND**
- HMA FULL DEPTH PVT 7 1/2" W/ PCC RUBBILIZED BASE
 - PCC BASE COURSE 10" W/ AGG. BASE COURSE 4"
 - HMA BASE COURSE 4" W/ AGG. BASE COURSE 4"
 - PCC BASE COURSE WIDENING 10" W/ AGG. BASE COURSE 4"
 - BASE COURSE WIDENING 4" W/ AGG. BASE COURSE 4"
 - CRACK ROUTING & SEALING

X:\Projects\Civil\Current\0510215-Lynch Spur\Civil\DN\PNP007.dgn

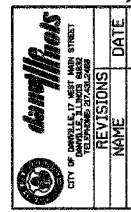
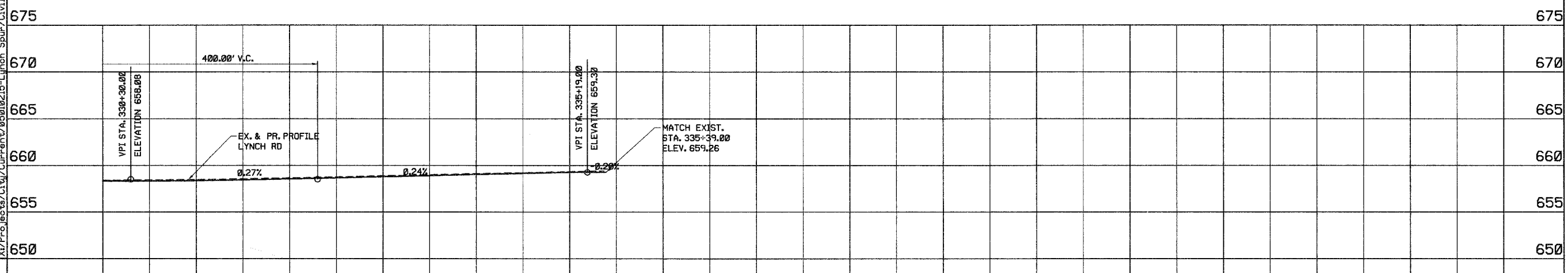

REVISIONS	NAME	DATE
640	658.23 658.31 658.24 658.32 658.29 658.37 658.36 658.44 658.46 658.54 658.69 658.67 658.70 658.78 658.82 658.90 658.94 659.02 659.06 659.14 659.17 659.26	330+00 331+00 332+00 333+00 334+00 335+00

645

640

DEPARTMENT OF ENGINEERING
 DANVILLE, IL R. DAVID SCHNELLE, CITY ENGINEER
 LYNCH ROAD IMPROVEMENT
 PLAN & PROFILE LYNCH RD
 STA. 330+00 TO STA. 335+36.70

SCALE: 1"=50'
 DATE: 3/12/2007

DRAWN BY: RDS
 CHECKED BY: MEW