

COUNTY	ROUTE	SECTION	TOTAL SHEETS	SHEET NO.
ADAMS	FAS 584	06-00198-00-RS	7	4

STATION 46+25 TO STATION 70+00

PROJECT NO. RS-584(109)

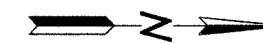
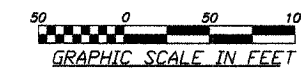

EQUATION:
 STA. 173+77.82 (02-00180-00-PV)=
 STA. 41+34.83 (TR 440A)=
 STA. 41+34.83 (06-00198-00-RS)

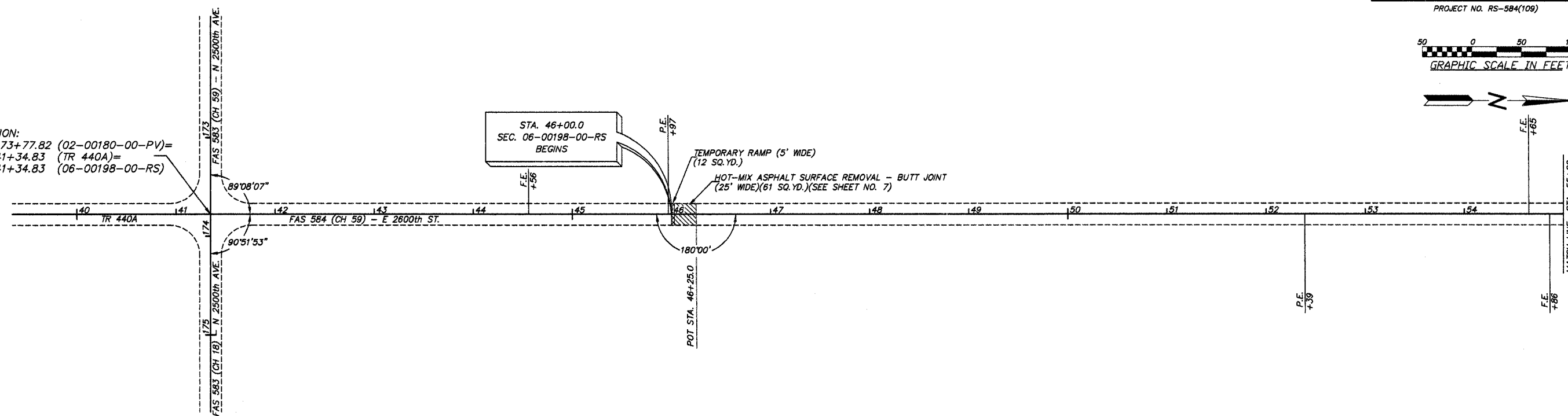

STA. 46+00.0
 SEC. 06-00198-00-RS
 BEGINS

TEMPORARY RAMP (5' WIDE)
 (12 SQ. YD.)
 HOT-MIX ASPHALT SURFACE REMOVAL - BUTT JOINT
 (25' WIDE)(61 SQ. YD.)(SEE SHEET NO. 7)

