

# PLAN VIEW

7680 / S. 19<sup>TH</sup> ST.

CITY OF MATTOON  
SECTION 06-00144-00-RS  
ROUTE: 7680 / S. 19<sup>TH</sup> ST.  
COLES COUNTY  
SHEET 20 OF 35

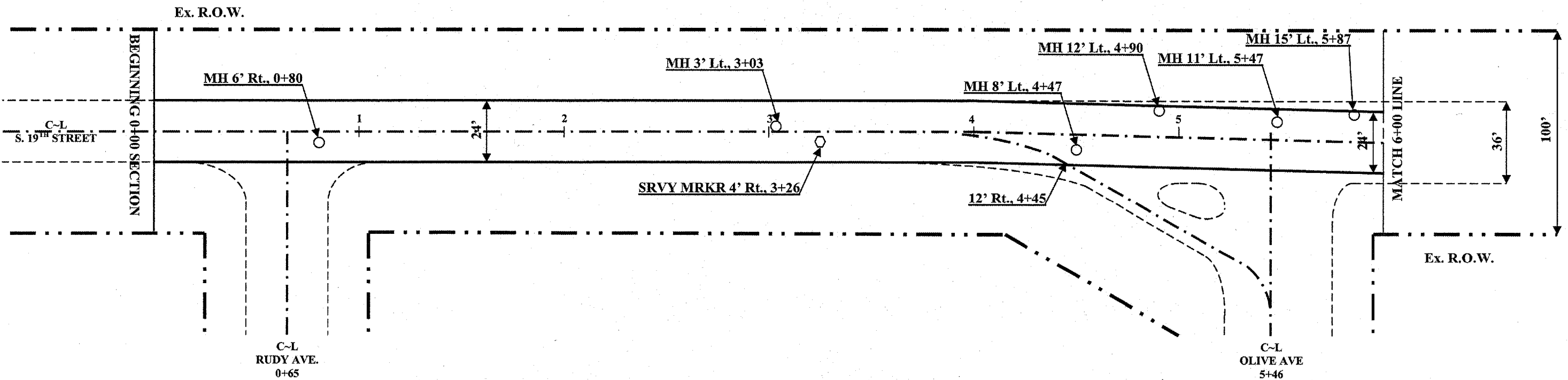

**60300350 MANHOLE FRAMES TO ADJUST**

6' Rt., 0+80	=1 EACH
3' Lt., 3+03	=1 EACH
8' Lt., 4+47	=1 EACH
12' Lt., 4+90	=1 EACH
11' Lt., 5+47	=1 EACH
15' Lt., 5+87	=1 EACH
<b>TOTAL</b>	<b>=6 EACH</b>

**44201769 CLASS D PATCH TYPE 3 10"**

CL. ~ 12.5' Rt., 3+02 ~ 3+14	=16.7 SQ. YD.
<b>TOTAL</b>	<b>=16.7 SQ. YD.</b>

**66700105 PERMANENT SURVEY MARKER (SPECIAL)**

4' Rt., 3+26	=1 EACH
<b>TOTAL</b>	<b>=1 EACH</b>

**40600982 HOT MIX ASPHALT SURF REMOVAL BUTT JOINT**

12' Lt. ~ Rt., 0+00 ~ 0+25	=67.0 SQ. YD.
<b>TOTAL</b>	<b>=67.0 SQ. YD.</b>

CONTRACT: 95501  
JOB: C-97-043-07  
PROJECT: M-5042(16)  
SCALE: 1" = 50'