

CL CURVE DATA ILL. RTE. III

R.	= 450'
L.	= 293.64'
T.	= 152.26'
CH.	= 288.46'
Δ	= 37°23'13.8"

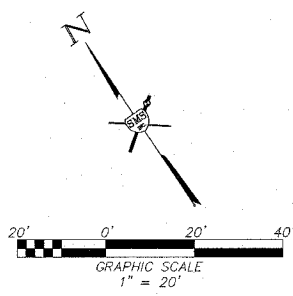

NOTE: SEE SHEET 22 FOR ADDITIONAL CONCRETE MEDIAN SURFACE REMOVAL AND REPLACEMENT

**\*NON-SPECIAL WASTE DISPOSAL**  
 ALL DISTURBED OR EXCAVATED EARTH LOCATED FROM STA. 77+23 RT. (EDWARDSVILLE RD.) TO STA. 98+18 LT. (ILL. RTE. 111) SHALL BE CONSIDERED "NON-SPECIAL WASTE DISPOSAL" AND SHALL BE DISPOSED OF ACCORDING TO SECTION 609 OF THE STANDARD SPECIFICATIONS AND ALL LOCAL, STATE AND FEDERAL REGULATIONS.

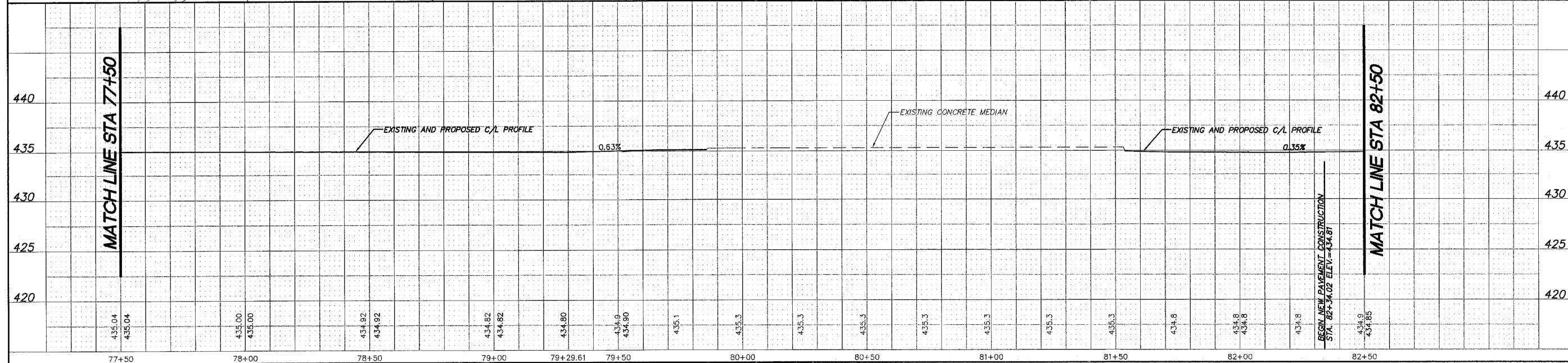

REVISIONS

**SMS** Sheppard, Morgan & Schwaab, Inc.  
 CONSULTING ENGINEERS AND LAND SURVEYORS  
 3115 Market Street, P.O. Box E, Wood River, IL 62451  
 101 Central Industrial Drive, Granite City, IL 62040  
 618.987.9700 Fax: 618.987.9700 Email: mail@smsmorganschwab.com  
 DESIGN FIRM # 184-000992

**EDWARDSVILLE ROAD PHASE II (FAU 8980)**  
**SECTION 05-00043-02-WR**  
**WOOD RIVER, ILLINOIS**  
**PLAN PROFILE**

DWG. NO.	Edwardsville road phase II PP3.dwg
REF. BK.	FG
JOB NO.	286614
DSM. BY:	CLA
CHK. BY:	CDP-jmk
DATE:	JANUARY, 2007
SCALE:	HORZ: 1"=20' VERT: 1"=5'
SHEET	14 OF 31