

F.A.U. RTE.	SECTION	COUNTY	TOTAL SHEETS	SHEET NO.
9276	05-00029-02-RS	CAHOKIA	10	9
STA. 29+00.00		TO STA. 35+00.00		
FED. ROAD DIST. NO.		ILLINOIS	FED. AID PROJECT	
CONTRACT NO. 97311				

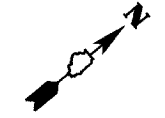

DATE	BY

DATE	BY

PLOT DATE = #DATE#  
 FILE NAME = #FILE#  
 USER NAME = #USER#

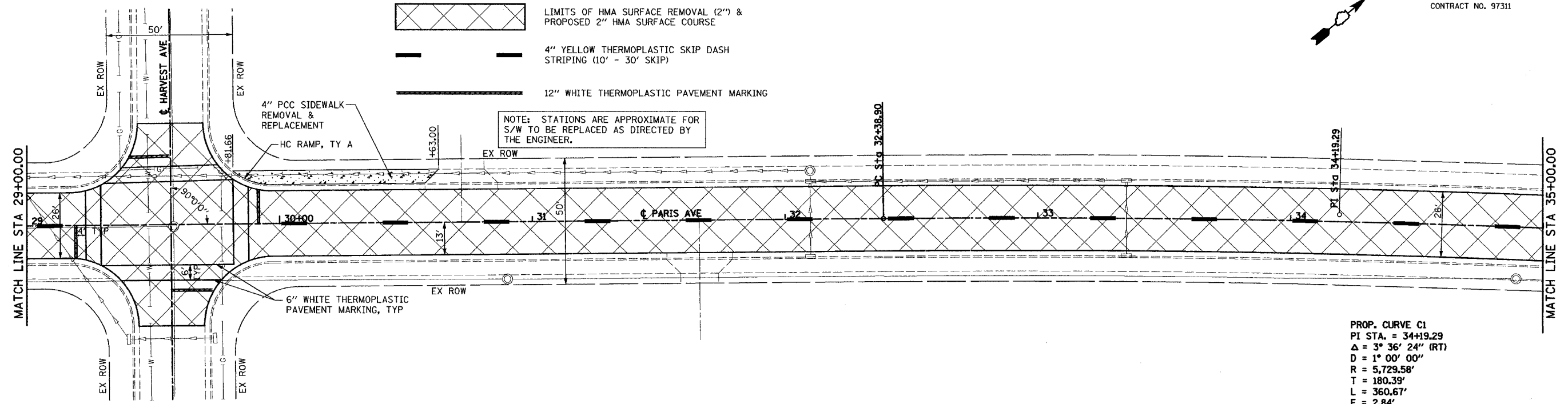

PROP. CURVE C1  
 PI STA. = 34+19.29  
 $\Delta = 3^\circ 36' 24''$  (RT)  
 D = 1° 00' 00"  
 R = 5,729.58'  
 T = 180.39'  
 L = 360.67'  
 E = 2.84'  
 e = NC  
 T.R. = NA  
 S.E. RUN = NA  
 P.C. STA = 32+38.90  
 P.T. STA = 35+99.57

