

F.A.I. SECTION	COUNTY	TOTAL SHEETS	SHEET NO.
57 0X1-6-2H8K	WILLIAMSON	272	21
STA.	TO STA.		
FED. ROAD DIST. NO. 9 ILLINOIS FED. AID PROJECT			

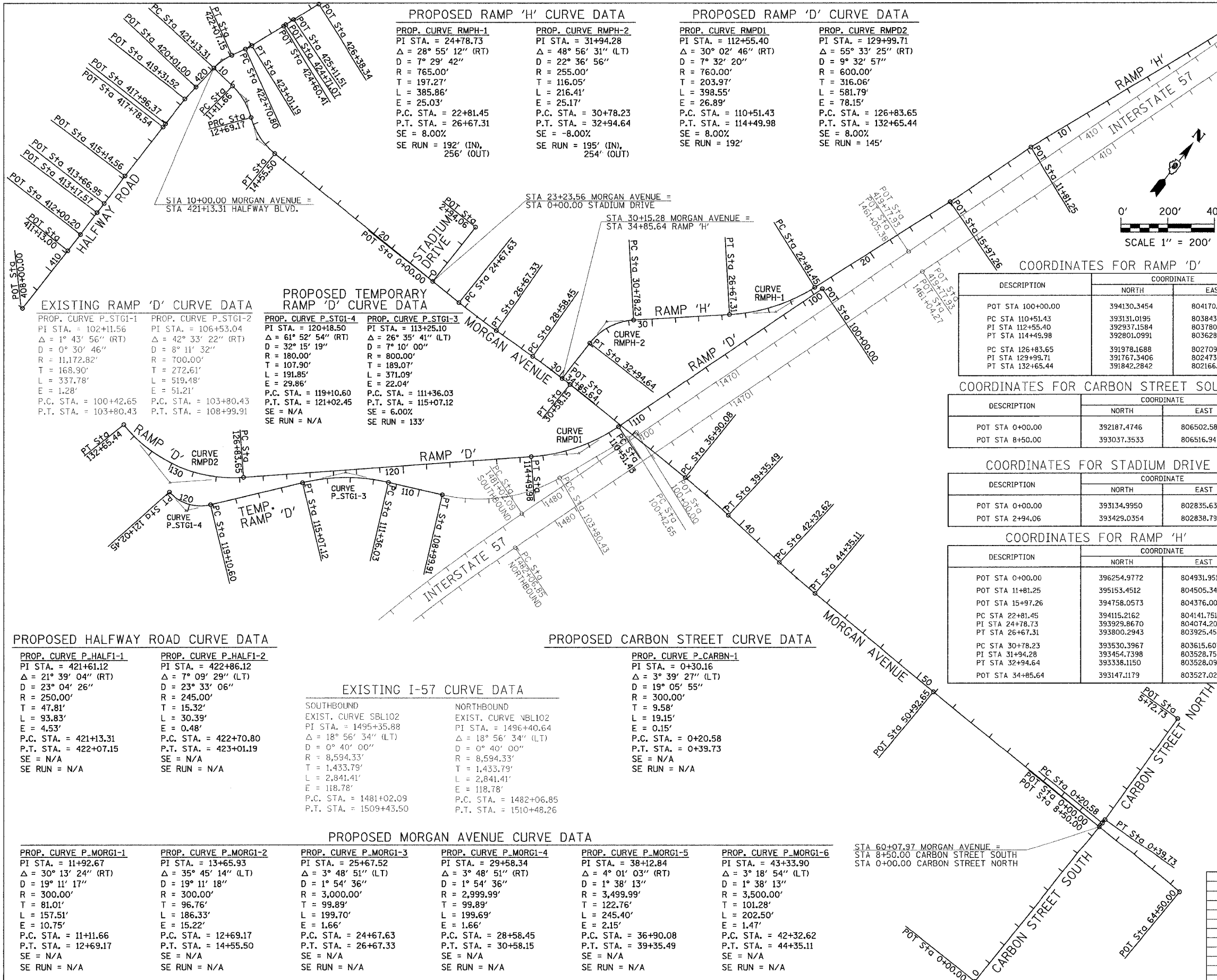

**PROPOSED RAMP 'H' CURVE DATA**

<b>PROP. CURVE RMPH-1</b>	<b>PROP. CURVE RMPH-2</b>
PI STA. = 24+78.73	PI STA. = 31+94.28
$\Delta = 28^\circ 55' 12''$ (RT)	$\Delta = 48^\circ 56' 31''$ (LT)
D = 28' 29' 42"	D = 22' 36' 56"
R = 765.00'	R = 255.00'
T = 197.27'	T = 116.05'
L = 385.86'	L = 216.41'
E = 25.03'	E = 25.17'
P.C. STA. = 22+81.45	P.C. STA. = 30+78.23
P.T. STA. = 26+67.31	P.T. STA. = 32+94.64
SE = 8.00%	SE = -8.00%
SE RUN = 192' (IN), 256' (OUT)	SE RUN = 195' (IN), 254' (OUT)

**PROPOSED RAMP 'D' CURVE DATA**

<b>PROP. CURVE RMPD1</b>	<b>PROP. CURVE RMPD2</b>
PI STA. = 112+55.40	PI STA. = 129+99.71
$\Delta = 30^\circ 02' 46''$ (RT)	$\Delta = 55^\circ 33' 25''$ (RT)
D = 7' 32' 20"	D = 9' 32' 57"
R = 760.00'	R = 600.00'
T = 203.97'	T = 316.06'
L = 385.86'	L = 581.79'
E = 26.89'	E = 78.15'
P.C. STA. = 110+51.43	P.C. STA. = 126+83.65
P.T. STA. = 114+49.98	P.T. STA. = 132+65.44
SE = 8.00%	SE = 8.00%
SE RUN = 192'	SE RUN = 145'

**EXISTING RAMP 'D' CURVE DATA**

<b>PROP. CURVE P-STG1-1</b>	<b>PROP. CURVE P-STG1-2</b>
PI STA. = 102+11.56	PI STA. = 106+53.04
$\Delta = 1^\circ 43' 56''$ (RT)	$\Delta = 42^\circ 33' 22''$ (RT)
D = 0' 30' 46"	D = 8' 11' 32"
R = 11,172.82'	R = 700.00'
T = 168.90'	T = 272.61'
L = 337.78'	L = 519.48'
E = 1.28'	E = 51.21'
P.C. STA. = 100+42.65	P.C. STA. = 103+80.43
P.T. STA. = 103+80.43	P.T. STA. = 108+99.91

**PROPOSED TEMPORARY RAMP 'D' CURVE DATA**

<b>PROP. CURVE P-STG1-4</b>	<b>PROP. CURVE P-STG1-3</b>
PI STA. = 120+18.50	PI STA. = 113+25.10
$\Delta = 61^\circ 52' 54''$ (RT)	$\Delta = 26^\circ 35' 41''$ (LT)
D = 32' 15' 19"	D = 7' 10' 00"
R = 180.00'	R = 800.00'
T = 107.90'	T = 189.07'
L = 191.85'	L = 371.09'
E = 29.86'	E = 22.04'
P.C. STA. = 119+10.60	P.C. STA. = 111+36.03
P.T. STA. = 121+02.45	P.T. STA. = 115+07.12
SE = N/A	SE = 6.00%
SE RUN = N/A	SE RUN = 133'

**PROPOSED HALFWAY ROAD CURVE DATA**

<b>PROP. CURVE P-HALF1-1</b>	<b>PROP. CURVE P-HALF1-2</b>
PI STA. = 421+61.12	PI STA. = 422+86.12
$\Delta = 21^\circ 39' 04''$ (RT)	$\Delta = 7^\circ 09' 29''$ (LT)
D = 23' 04' 26"	D = 23' 33' 06"
R = 250.00'	R = 245.00'
T = 47.81'	T = 15.32'
L = 93.83'	L = 30.39'
E = 4.53'	E = 0.48'
P.C. STA. = 421+13.31	P.C. STA. = 422+70.80
P.T. STA. = 422+07.15	P.T. STA. = 423+01.19
SE = N/A	SE = N/A
SE RUN = N/A	SE RUN = N/A

**EXISTING I-57 CURVE DATA**

<b>SOUTHBOUND</b>	<b>NORTHBOUND</b>
EXIST. CURVE SBL102	EXIST. CURVE NBL102
PI STA. = 1495+35.88	PI STA. = 1496+40.64
$\Delta = 18^\circ 56' 34''$ (LT)	$\Delta = 18^\circ 56' 34''$ (LT)
D = 0' 40' 00"	D = 0' 40' 00"
R = 8,594.33'	R = 8,594.33'
T = 1,433.79'	T = 1,433.79'
L = 2,841.41'	L = 2,841.41'
E = 118.78'	E = 118.78'
P.C. STA. = 1481+02.09	P.C. STA. = 1482+06.85
P.T. STA. = 1509+43.50	P.T. STA. = 1510+48.26

**PROPOSED MORGAN AVENUE CURVE DATA**

<b>PROP. CURVE P-MORG1-1</b>	<b>PROP. CURVE P-MORG1-2</b>	<b>PROP. CURVE P-MORG1-3</b>	<b>PROP. CURVE P-MORG1-4</b>	<b>PROP. CURVE P-MORG1-5</b>	<b>PROP. CURVE P-MORG1-6</b>
PI STA. = 11+92.67	PI STA. = 13+65.93	PI STA. = 25+67.52	PI STA. = 29+58.34	PI STA. = 38+12.84	PI STA. = 43+33.90
$\Delta = 30^\circ 13' 24''$ (RT)	$\Delta = 35^\circ 45' 14''$ (LT)	$\Delta = 3^\circ 48' 51''$ (LT)	$\Delta = 3^\circ 48' 51''$ (RT)	$\Delta = 4^\circ 01' 03''$ (RT)	$\Delta = 3^\circ 18' 54''$ (LT)
D = 19' 11' 17"	D = 19' 11' 18"	D = 1' 54' 36"	D = 1' 54' 36"	D = 1' 38' 13"	D = 1' 38' 13"
R = 300.00'	R = 300.00'	R = 3,000.00'	R = 2,999.99'	R = 3,499.99'	R = 3,500.00'
T = 81.01'	T = 99.89'	T = 99.89'	T = 99.89'	T = 122.76'	T = 101.28'
L = 157.51'	L = 186.33'	L = 199.70'	L = 199.69'	L = 245.40'	L = 202.50'
E = 10.75'	E = 15.22'	E = 1.66'	E = 1.66'	E = 2.15'	E = 1.47'
P.C. STA. = 11+11.66	P.C. STA. = 12+69.17	P.C. STA. = 24+67.63	P.C. STA. = 28+58.45	P.C. STA. = 36+90.08	P.C. STA. = 42+32.62
P.T. STA. = 12+69.17	P.T. STA. = 14+55.50	P.T. STA. = 26+67.33	P.T. STA. = 30+58.15	P.T. STA. = 39+35.49	P.T. STA. = 44+35.11
SE = N/A	SE = N/A	SE = N/A	SE = N/A	SE = N/A	SE = N/A
SE RUN = N/A	SE RUN = N/A	SE RUN = N/A	SE RUN = N/A	SE RUN = N/A	SE RUN = N/A

**COORDINATES FOR HALFWAY ROAD**

DESCRIPTION	COORDINATE	
	NORTH	EAST
POT STA 408+00.00	391970.8896	801519.7502
POT STA 411+13.00	392283.8787	801522.2697
POT STA 412+00.20	392371.0768	801522.5730
POT STA 413+17.57	392488.4371	801521.1799
POT STA 413+66.95	392537.8164	801521.3180
POT STA 415+14.56	392685.4249	801519.5548
POT STA 417+78.54	392949.3991	801520.1701
POT STA 417+96.37	392967.2303	801520.3137
POT STA 419+31.52	393102.3747	801521.4020
POT STA 420+01.00	393171.5193	801528.1774
PC STA 421+13.31	393283.4510	801537.4627
PI STA 421+61.12	393330.9692	801542.6969
PT STA 422+07.15	393373.2036	801565.0939
PC STA 422+70.80	393429.4379	801594.9150
PI STA 422+86.12	393442.9760	801602.0943
PT STA 423+01.19	393457.3031	801607.5306
POT STA 424+60.41	393606.1676	801664.0168
POT STA 424+71.07	393616.2675	801667.4053
POT STA 425+11.51	393654.6678	801680.0885
POT STA 426+38.34	393773.6008	801724.1573

**COORDINATES FOR RAMP 'D'**

DESCRIPTION	COORDINATE	
	NORTH	EAST
POT STA 100+00.00	394130.3454	804170.6762
PC STA 110+51.43	393131.0195	803843.7855
PI STA 112+55.40	392937.1584	803780.3714
PT STA 114+49.98	392801.0991	803628.4130
PC STA 126+83.65	391978.1688	802709.3198
PI STA 129+99.71	391767.3406	802473.8557
PT STA 132+65.44	391842.2842	802166.8127

**COORDINATES FOR CARBON STREET SOUTH**

DESCRIPTION	COORDINATE	
	NORTH	EAST
POT STA 0+00.00	392187.4746	806502.5862
POT STA 8+50.00	393037.3533	806516.9471

**COORDINATES FOR CARBON STREET NORTH**

DESCRIPTION	COORDINATE	
	NORTH	EAST
POT STA 0+00.00	393037.3533	806516.9471
PC STA 0+20.58	393057.9236	806517.4638
PI STA 0+30.16	393067.4993	806517.7043
PT STA 0+39.73	393077.0709	806517.3335
POT STA 5+72.73	393609.6734	806496.7000

**COORDINATES FOR STADIUM DRIVE**

DESCRIPTION	COORDINATE	
	NORTH	EAST
POT STA 0+00.00	393134.9950	802835.6317
POT STA 2+94.06	393429.0354	802838.7929

**COORDINATES FOR MORGAN AVENUE**

DESCRIPTION	COORDINATE	
	NORTH	EAST
POT STA 10+00.00	393283.4517	801537.4571
PC STA 11+11.66	393270.4826	801648.3633
PI STA 11+92.67	393261.0734	801728.8269
PRC STA 12+69.17	393212.4400	801793.6166
PI STA 13+65.93	393154.3512	801871.0029
PT STA 14+55.50	393152.4272	801967.7461
PC STA 24+67.63	393132.3015	802979.6734
PI STA 25+67.52	393130.3151	803079.5471
PT STA 26+67.33	393134.9770	803179.3318
PC STA 28+58.45	393143.8962	803370.2424
PI STA 29+58.34	393148.5578	803470.0226
PT STA 30+58.15	393146.5719	803569.8917
PC STA 36+90.08	393134.0079	804201.7031
PI STA 38+12.84	393131.5673	804324.4354
PT STA 39+35.49	393120.5340	804446.6952
PC STA 42+32.62	393093.8284	804843.4905
PI STA 43+33.90	393084.7253	804843.4905
PT STA 44+35.11	393081.4705	804944.7189
POT STA 11+57.20	393060.3394	805601.9113
POT STA 15+97.30	393026.2527	806958.8405

**COORDINATES FOR RAMP 'H'**

DESCRIPTION	COORDINATE	
	NORTH	EAST
POT STA 0+00.00	396254.9772	804931.9519
POT STA 11+81.25	395153.4512	804505.3455
POT STA 15+97.26	394758.0573	804376.0077
PC STA 22+81.45	394115.2162	804141.7513
PI STA 24+78.73	393929.8670	804074.2085
PT STA 26+67.31	393800.2943	803925.4562
PC STA 30+78.23	393530.3967	803615.6077
PI STA 31+94.28	393454.7398	803528.7519
PT STA 32+94.64	393338.1150	803528.0972
POT STA 34+85.64	393147.1179	803527.0250

**COORDINATES FOR TEMP. RAMP 'D'**

DESCRIPTION	COORDINATE	
	NORTH	EAST
POT STA 100+00.00	393158.4510	803919.9280
PC STA 100+42.65	393118.4190	803905.2110
PI STA 102+11.56	392960.7174	803844.7243
PT STA 103+80.43	392804.9162	803779.4982
PC STA 103+80.43	392804.9162	803779.4982
PI STA 106+53.04	392553.4542	803674.2238
PT STA 108+99.91	392439.4214	803426.6104
PC STA 111+36.03	392340.6537	803212.1437
PI STA 113+25.10	392261.5642	803040.4068
PT STA 115+07.12	392113.9600	803922.2470
PC STA 119+10.60	391798.9706	802670.0925
PI STA 120+18.50	391714.7345	802602.6600
PT STA 121+02.45	391734.5083	802496.5853

**REVISIONS**

NAME	DATE

**ILLINOIS DEPARTMENT OF TRANSPORTATION**

**ALIGNMENT PLAN**

MORGAN AVENUE INTERCHANGE  
FAI ROUTE 57 WITH FAI ROUTE 9718  
WILLIAMSON COUNTY

SCALE: 1" = 200'  
DATE: 3-19-2007

DRAWN BY: DH  
CHECKED BY: RD

PLOT DATE = 3/20/2007  
FILE NAME = P:\48880\dm\8068\morga01.dgn  
PLOT SCALE = 200.0000 / 1 IN.  
USER NAME = gboerner