

F.A.I. RTE.	SECTION	COUNTY	TOTAL SHEETS	SHEET NO.
57	0X1-6-2HBK	WILLIAMSON	272	38
STA. 117+00		TO STA. 132+00		
FED. ROAD DIST. NO. 9 ILLINOIS FED. AID PROJECT				

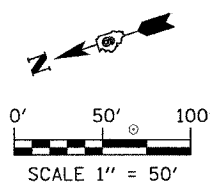

PROP. CURVE P-STG1-4
 PI STA. = 120+18.50
 $\Delta = 61^\circ 52' 54''$ (RT)
 $D = 32^\circ 15' 19''$
 $R = 180.00'$
 $T = 107.90'$
 $L = 191.85'$
 $E = 29.86'$
 $e = N/A$
 S.E. RUN = N/A
 P.C. STA. = 119+10.60
 P.T. STA. = 121+02.45

SEE STAGE CONSTRUCTION PLANS FOR REMOVAL DETAILS OF EXISTING RAMP 'D' AND GENERAL SEQUENCE OF CONSTRUCTION NOTES.

SEE STAGE CONSTRUCTION PLANS FOR DETAILS AND GENERAL SEQUENCE OF CONSTRUCTION NOTES.

PROPOSED CULVERT (SEE RAMP 'D' DRAINAGE PLANS)

SEE RAMP 'D' ROADWAY AND DRAINAGE PLAN/PROFILE SHEETS

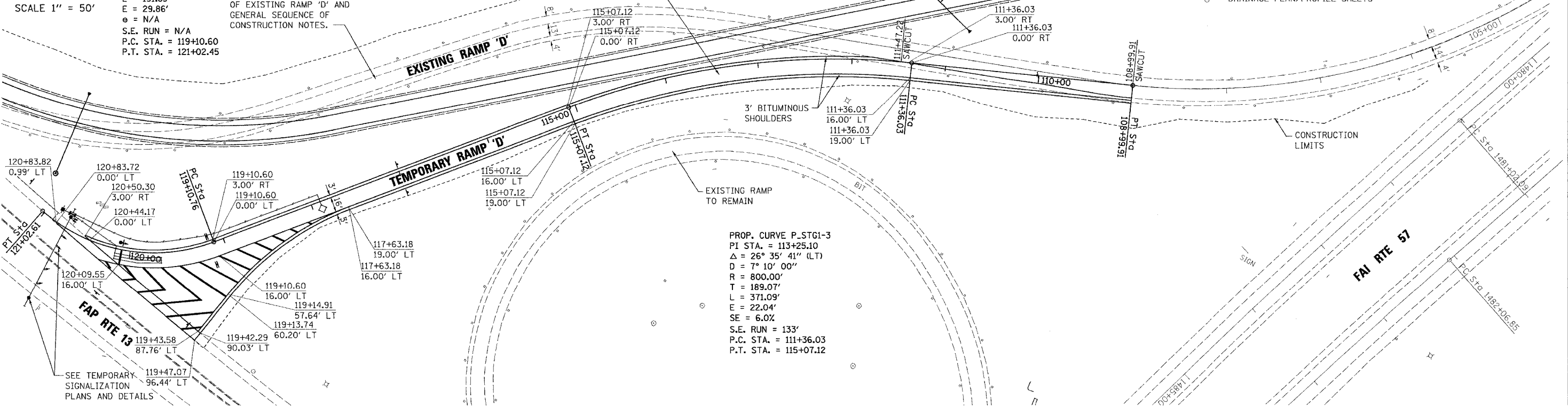

PROP. CURVE P-STG1-3
 PI STA. = 113+25.10
 $\Delta = 26^\circ 35' 41''$ (LT)
 $D = 7^\circ 10' 00''$
 $R = 800.00'$
 $T = 189.07'$
 $L = 371.09'$
 $E = 22.04'$
 $SE = 6.0\%$
 S.E. RUN = 133'
 P.C. STA. = 111+36.03
 P.T. STA. = 115+07.12

DATE	BY	REVISION

PLAN
 SURVEYED
 ALIGNED
 CHECKED
 NO. 1
 DATE

DATE	BY	REVISION

PROFILE
 SURVEYED
 GRADES CHECKED
 NO. 1
 DATE

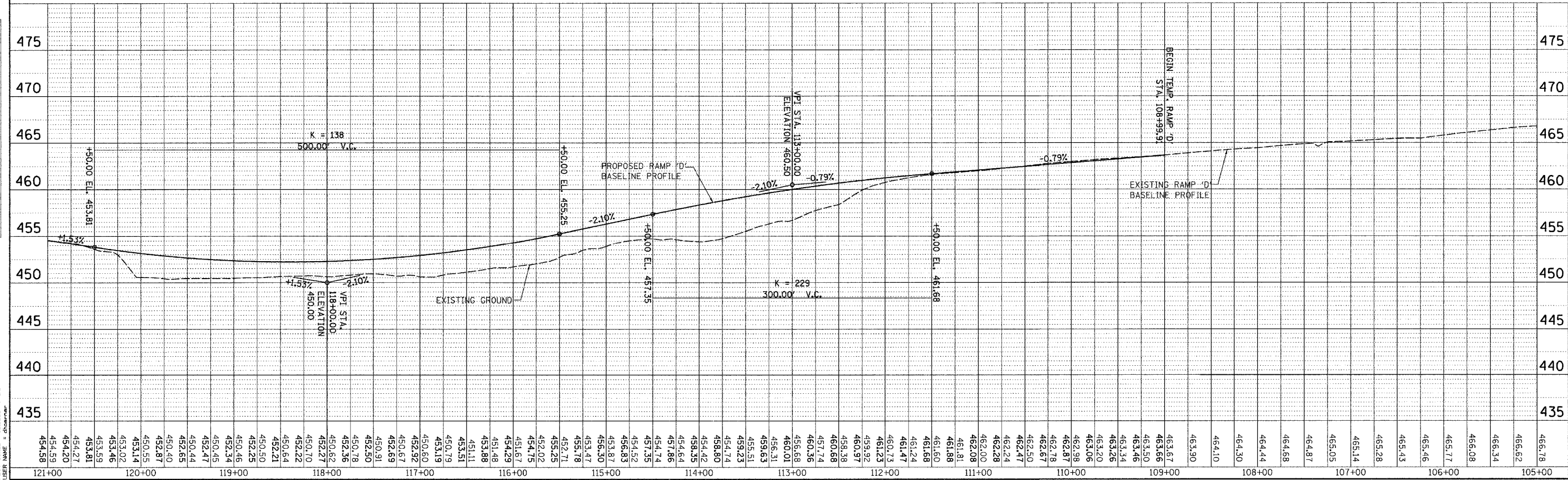

TEMPORARY RAMP "D" PLAN & PROFILE STA 105+00 TO 120+00