

F.A.I. RTE.	SECTION	COUNTY	TOTAL SHEETS	SHEET NO.
57	0X1-6-2HKB	WILLIAMSON	272	86
STA. 265+00		TO STA. 295+00		
FED. ROAD DIST. NO. 9		ILLINOIS	FED. AID PROJECT	

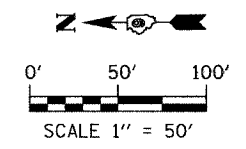

NOTES:
 1. ALL SIGN LOCATIONS ARE PROVIDED AT THE CENTER OF THE PROPOSED AND/OR RELOCATED SIGNS.
 2. REFER TO BREAK-AWAY SIGN STRUCTURE ELEVATION VIEWS AND BREAK-AWAY WIDE FLANGE STEEL SIGN POST DETAILS.

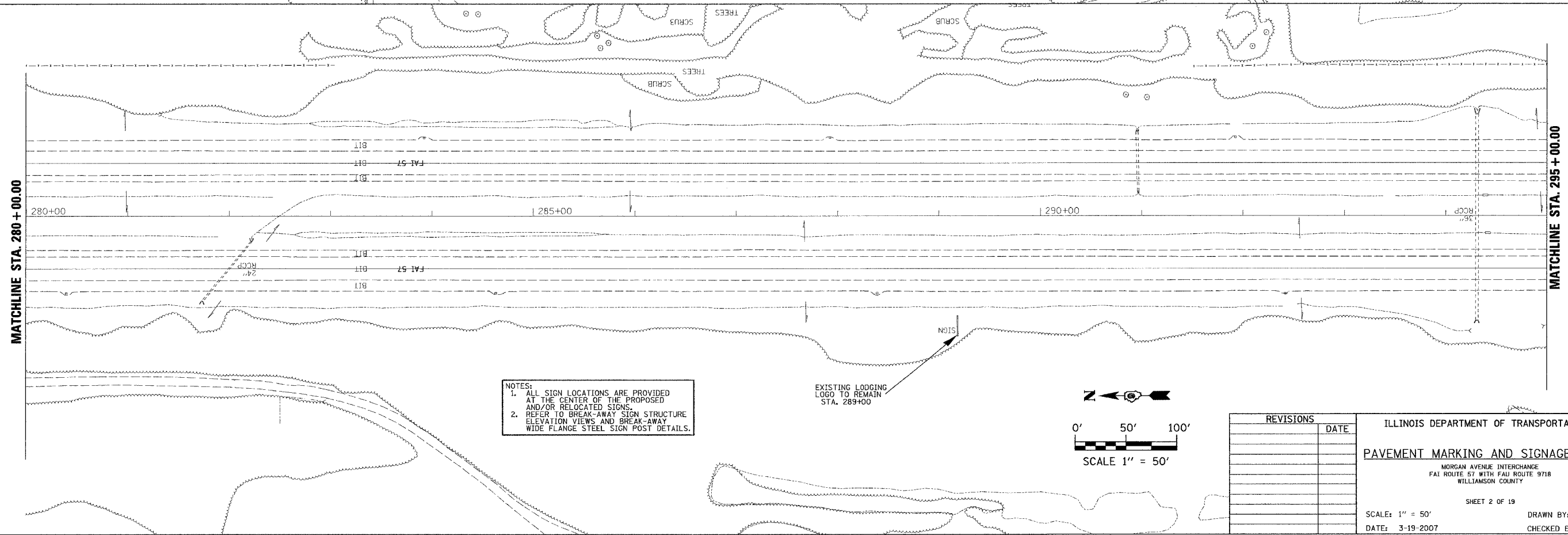
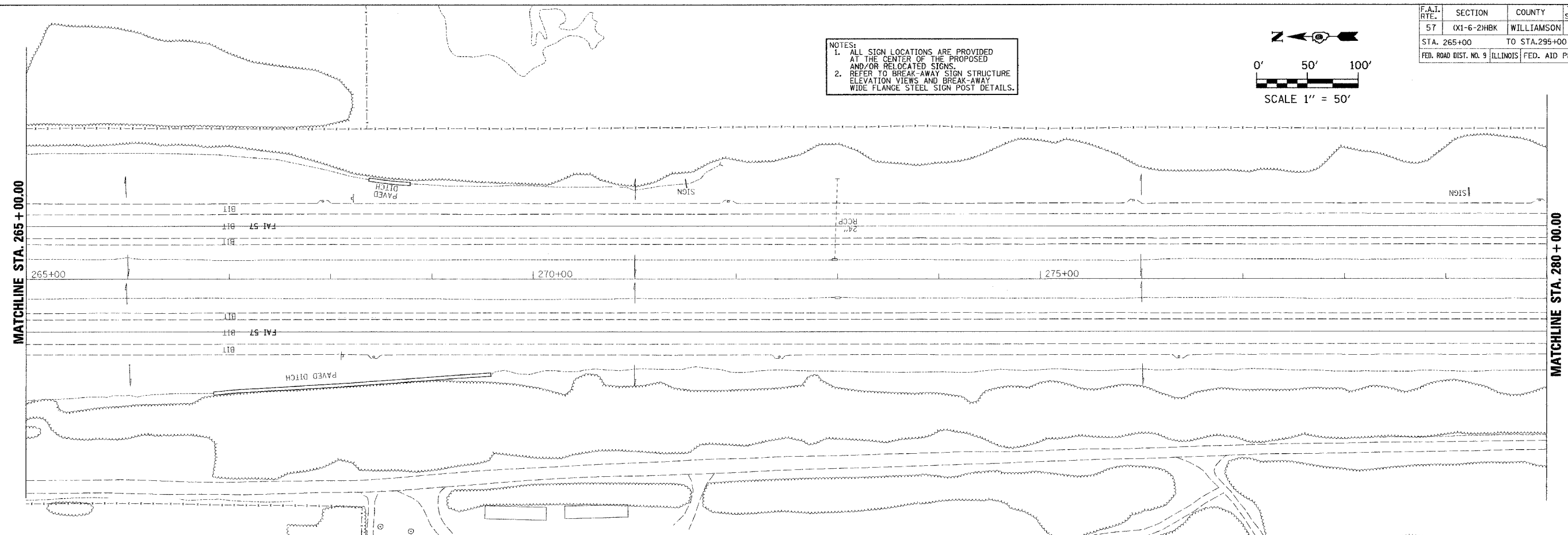

NOTES:
 1. ALL SIGN LOCATIONS ARE PROVIDED AT THE CENTER OF THE PROPOSED AND/OR RELOCATED SIGNS.
 2. REFER TO BREAK-AWAY SIGN STRUCTURE ELEVATION VIEWS AND BREAK-AWAY WIDE FLANGE STEEL SIGN POST DETAILS.

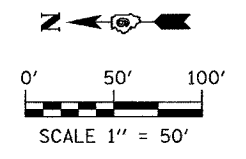

REVISIONS	DATE

ILLINOIS DEPARTMENT OF TRANSPORTATION
PAVEMENT MARKING AND SIGNAGE PLANS
 MORGAN AVENUE INTERCHANGE
 FAI ROUTE 57 WITH FAU ROUTE 9718
 WILLIAMSON COUNTY
 SHEET 2 OF 19
 SCALE: 1" = 50'
 DATE: 3-19-2007
 DRAWN BY: DH
 CHECKED BY: RD

PLOT DATE = 3/19/2007
 FILE NAME = P:\98994\98994.dgn
 PLOT SCALE = 1/8" = 1' / IN.
 USER NAME = dcherry