

F.A.I. RTE.	SECTION	COUNTY	TOTAL SHEETS	SHEET NO.
57	(X1-6-2)HBK	WILLIAMSON	272	88
STA. 325+00 TO STA. 356+00				
FED. ROAD DIST. NO. 9 ILLINOIS			FED. AID PROJECT	

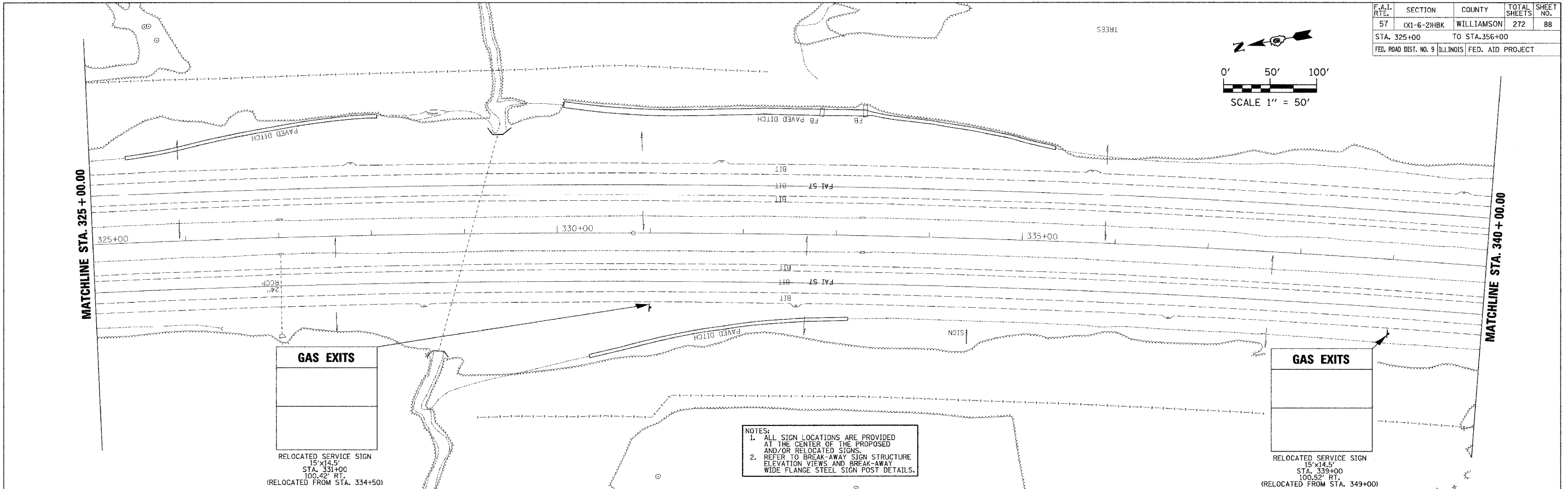
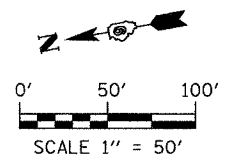

NOTES:
 1. ALL SIGN LOCATIONS ARE PROVIDED AT THE CENTER OF THE PROPOSED AND/OR RELOCATED SIGNS.
 2. REFER TO BREAK-AWAY SIGN STRUCTURE ELEVATION VIEWS AND BREAK-AWAY WIDE FLANGE STEEL SIGN POST DETAILS.

GAS EXITS

RELOCATED SERVICE SIGN
 15'x14.5'
 STA. 331+00
 100.42' RT.
 (RELOCATED FROM STA. 334+50)

GAS EXITS

RELOCATED SERVICE SIGN
 15'x14.5'
 STA. 339+00
 100.52' RT.
 (RELOCATED FROM STA. 349+00)

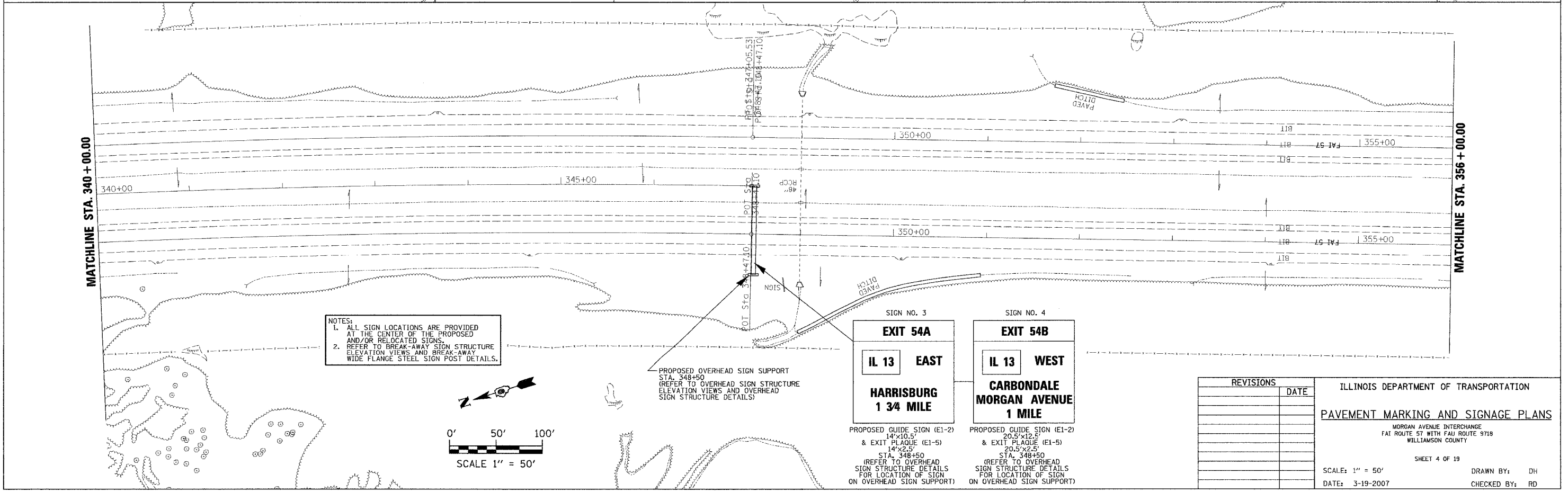

NOTES:
 1. ALL SIGN LOCATIONS ARE PROVIDED AT THE CENTER OF THE PROPOSED AND/OR RELOCATED SIGNS.
 2. REFER TO BREAK-AWAY SIGN STRUCTURE ELEVATION VIEWS AND BREAK-AWAY WIDE FLANGE STEEL SIGN POST DETAILS.

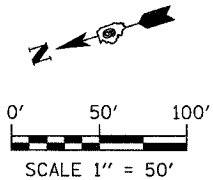

SIGN NO. 3
EXIT 54A
IL 13 EAST
HARRISBURG
1 3/4 MILE

PROPOSED GUIDE SIGN (E1-2) 14'x10.5' & EXIT PLAQUE (E1-5) 14'x2.5' STA. 348+50 (REFER TO OVERHEAD SIGN STRUCTURE DETAILS FOR LOCATION OF SIGN ON OVERHEAD SIGN SUPPORT)

SIGN NO. 4
EXIT 54B
IL 13 WEST
CARBONDALE
MORGAN AVENUE
1 MILE

PROPOSED GUIDE SIGN (E1-2) 20.5'x12.5' & EXIT PLAQUE (E1-5) 20.5'x2.5' STA. 348+50 (REFER TO OVERHEAD SIGN STRUCTURE DETAILS FOR LOCATION OF SIGN ON OVERHEAD SIGN SUPPORT)

PROPOSED OVERHEAD SIGN SUPPORT STA. 348+50 (REFER TO OVERHEAD SIGN STRUCTURE ELEVATION VIEWS AND OVERHEAD SIGN STRUCTURE DETAILS)

REVISIONS	DATE

ILLINOIS DEPARTMENT OF TRANSPORTATION
PAVEMENT MARKING AND SIGNAGE PLANS
 MORGAN AVENUE INTERCHANGE
 FAI ROUTE 57 WITH FAU ROUTE 9718
 WILLIAMSON COUNTY
 SHEET 4 OF 19
 SCALE: 1" = 50'
 DATE: 3-19-2007
 DRAWN BY: DH
 CHECKED BY: RD

PLOT DATE = 3/19/2007
 FILE NAME = P:\0448900\sign\04060809.mxd
 PLOT SCALE = 50.0000 / IN.
 USER NAME = drcermer