

STATE OF ILLINOIS
DEPARTMENT OF TRANSPORTATION

ROUTE NO.	SECTION	COUNTY	TOTAL SHEETS	SHEET NO.
FAI 57	(X1-6-2)HBK	Williamson	272	142
FED. ROAD DIST. NO. 7		ILLINOIS	FED. AID PROJECT:	

Contract # 98994

SHEET NO. 7
33 SHEETS

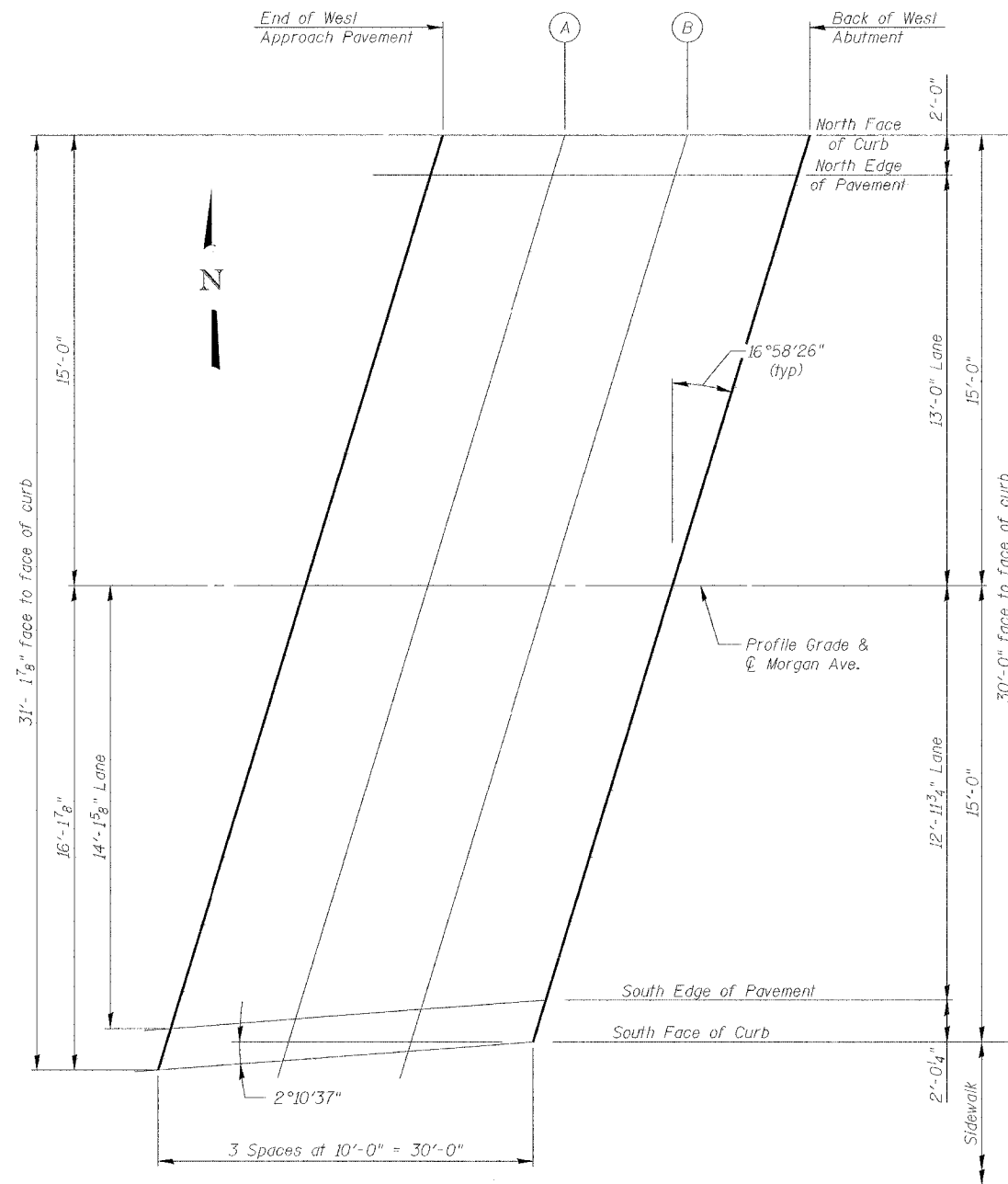

PLAN

THOUVENOT, WADE & MOERCHEN, INC.



DESIGNED	ALN
CHECKED	BWP
DRAWN	KBF
CHECKED	ALN/BWP

NORTH FACE OF CURB

Location	Station	Offset	Theoretical Grade Elevations
END W. APPR. PAV'T.	32+59.79	-15.000	491.122
A	32+69.79	-15.000	491.262
B	32+79.79	-15.000	491.398
BK. W. ABUT.	32+89.79	-15.000	491.528

NORTH EDGE OF PAVEMENT

Location	Station	Offset	Theoretical Grade Elevations
END W. APPR. PAV'T.	32+59.18	-13.000	491.144
A	32+69.18	-13.000	491.285
B	32+79.18	-13.000	491.421
BK. W. ABUT.	32+89.18	-13.000	491.552

☉ & PROFILE GRADE

Location	Station	Offset	Theoretical Grade Elevations
END W. APPR. PAV'T.	32+55.210	0.000	491.290
A	32+65.210	0.000	491.433
B	32+75.210	0.000	491.571
BK. W. ABUT.	32+85.210	0.000	491.703

SOUTH EDGE OF PAVEMENT

Location	Station	Offset	Theoretical Grade Elevations
END W. APPR. PAV'T.	32+50.896	14.135	491.006
A	32+61.014	13.750	491.159
B	32+71.132	13.365	491.306
BK. W. ABUT.	32+81.249	12.979	491.449

SOUTH FACE OF CURB

Location	Station	Offset	Theoretical Grade Elevations
END W. APPR. PAV'T.	32+50.279	16.156	490.966
A	32+60.397	15.769	491.115
B	32+70.514	15.385	491.266
BK. W. ABUT.	32+80.632	15.000	491.409

TOP OF WEST APPROACH
MORGAN AVE. OVER I-57
FAI ROUTE 57- SECTION (X1-6-2)HBK
WILLIAMSON COUNTY
STATION 34+69.21
STRUCTURE NO. 100-0092