

F.A.I. RTE.	SECTION	COUNTY	TOTAL SHEETS	SHEET NO.
57	0X1-6-2HBK	WILLIAMSON	272	211
STA. 109+70.00		TO STA. 110+00.00		
FED. ROAD DIST. NO. 9		ILLINOIS FED. AID PROJECT		

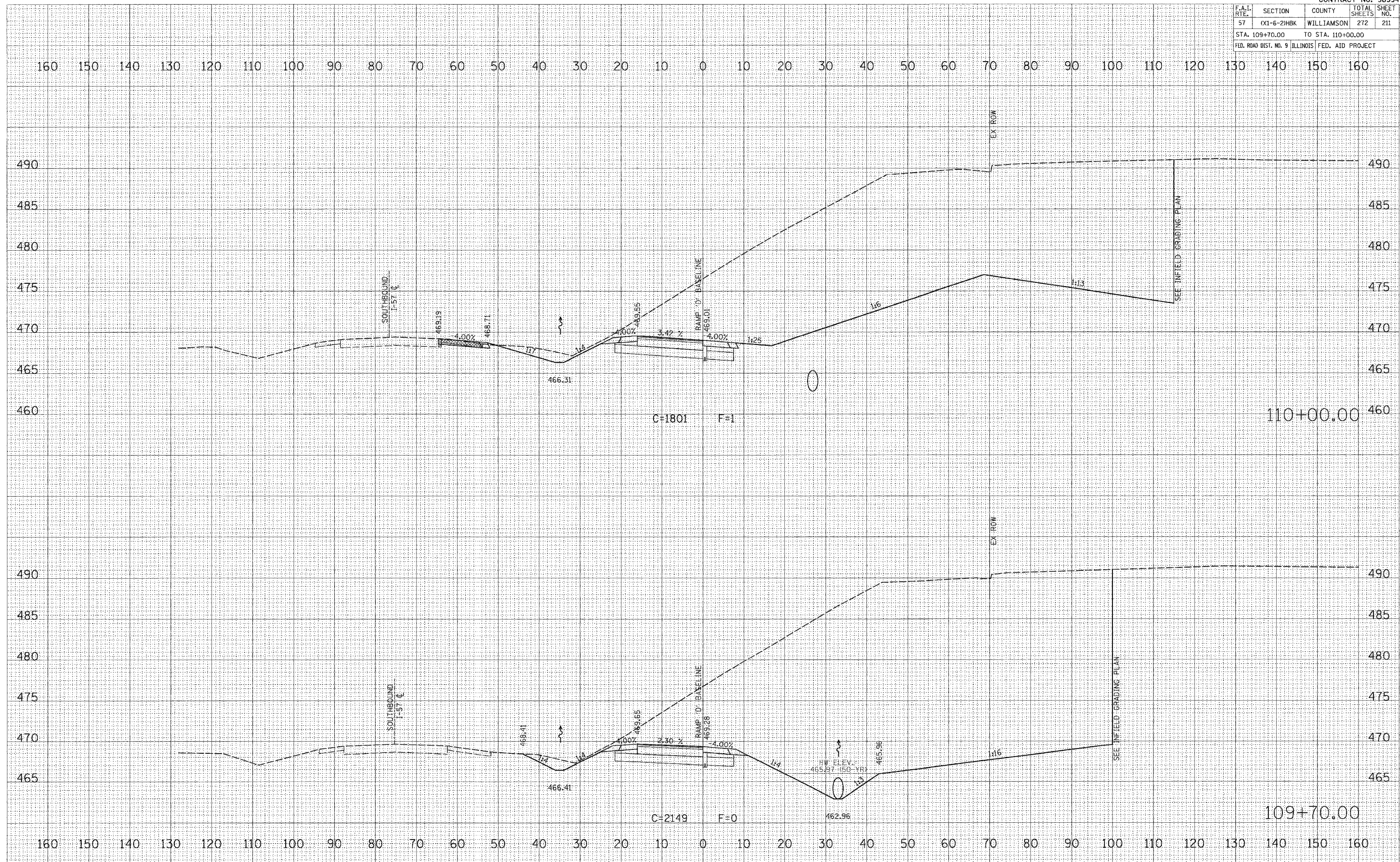

RAMP "D" CROSS SECTIONS

DATE	BY

SUPPLIED SURVEY
 TEMPLATE
 AREAS CHECKED

DATE	BY

ORIGINAL SURVEY
 WHITE BOOK
 AREAS CHECKED

PLOT DATE = 3/20/2007
 FILE NAME = P:\048900\fig\048900-mod\h\c\white book
 PLOT SCALE = 12.0000 / IN.
 USER NAME = dhaner