

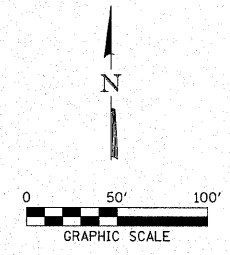

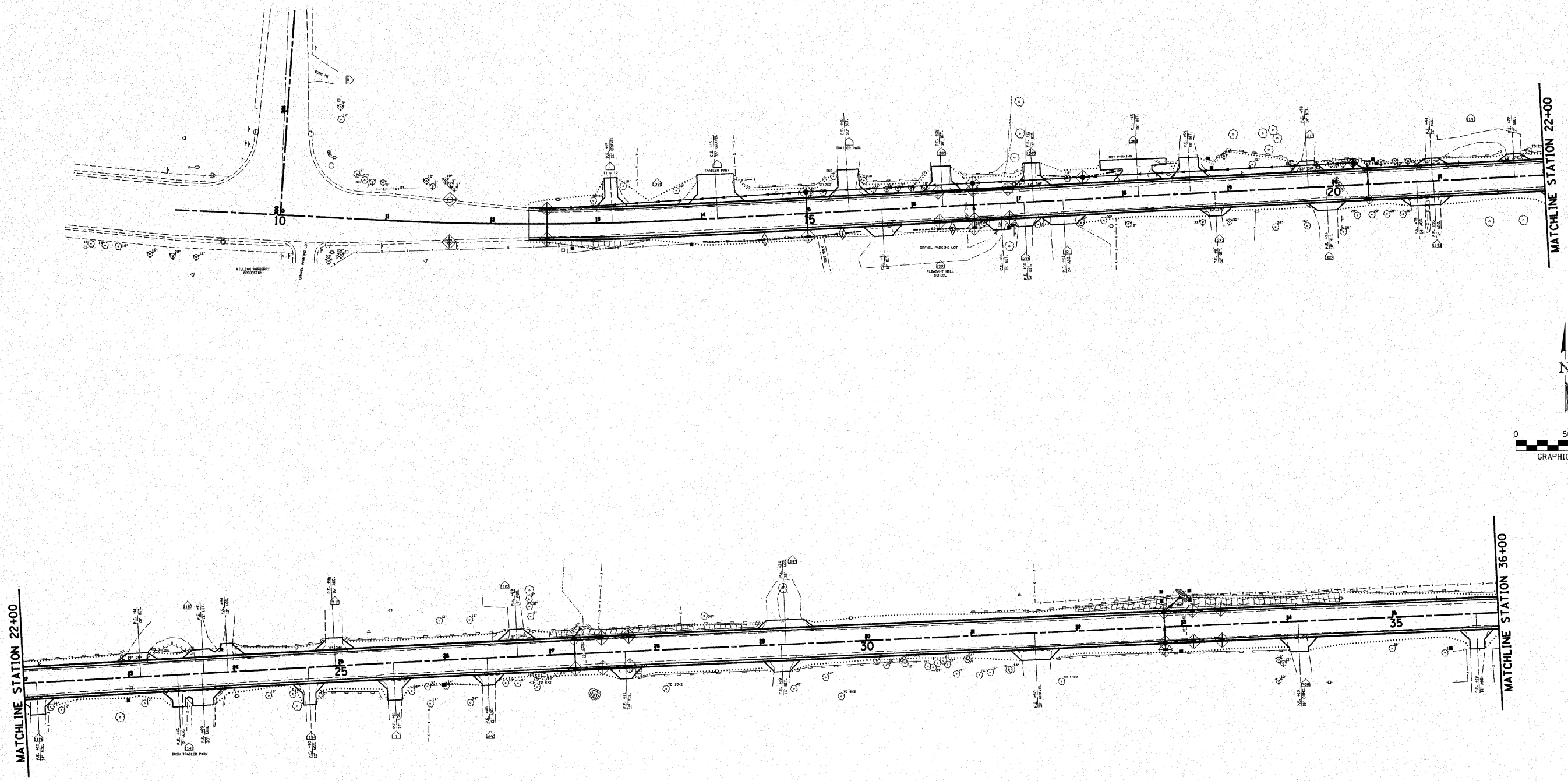



|                     |                |                            |              |           |
|---------------------|----------------|----------------------------|--------------|-----------|
| ROUTE               | SECTION        | COUNTY                     | TOTAL SHEETS | SHEET NO. |
| FAU 9713            | 99-02118-00-FP | JACKSON                    | 122          | 46        |
| FED. ROAD DIST. NO. |                | ILLINOIS FED. AID PROJECT- |              |           |
| CONTRACT NO. 99219  |                |                            |              |           |



- LEGEND**
-  EROSION CONTROL BLANKET
  -  HEAVY DUTY EXCELSIOR BLANKET
  -  AGGREGATE DITCH
  -  PERIMETER EROSION BARRIER
  -  TEMPORARY DITCH CHECK
  -  INLET AND PIPE PROTECTION

**HLR**  
 Rice, Berry and Associates  
 A Division of Hampton, Lenzini and Renwick, Inc.  
 Civil & Structural Engineers  
 801 S. Durkin Drive  
 Springfield, Illinois 62704  
 217-546-3400

Account Number: 03-47-0001-1  
 Date: 03-19-07  
 DESIGNED: L.F.S. | CHECKED: S.W.M. | DRAWN: W.J.S.

**EROSION CONTROL PLAN**  
 SECTION 99-02118-00-FP  
 F.A.U. 9713 / EAST PLEASANT HILL ROAD  
 JACKSON COUNTY